

**ALMO CAPITAL CORP.**  
603 East 30<sup>th</sup> Avenue, Vancouver, BC, V5V 2V7

Symbol TSX-V: APT

News Release Dated May 25, 2007

**INDUCED POLARIZATION SURVEY OF THE MOORE PROPERTY NOW**

**RECEIVED**

The Company has only one type of share and has only issued 4,790,696 common shares. Almo Capital Corp. is actively engaged in mineral exploration for copper, nickel, cobalt, platinum, palladium, gold, silver, magnesium and other economic minerals in various mineral properties. Almo Capital Corp. has an equity position of 100% of the MOORE PROPERTY and it was acquired originally by investors around 1985 through Ram Vallabh, President of Almo Capital Corp., for \$ 130,000 cash.

The property is located in the Kamloops Mining Division of British Columbia in an area with many large and small mineral deposits. The property has two or more sulfide zones (mineralized) which are hosted within a minimum of approximately +/-500 meter thick metamorphosed andesite and rhyolite rocks of the Eagle Bay Assemblage. Please see the geological report dated September 10, 2004 on [www.sedar.com](http://www.sedar.com). 124,000 tonnes of copper have been estimated, with the rock containing approximately 0.35 % copper over 64.5 meters, with additional gold, silver, zinc and lead mineralization not determined yet due to the then low prices of these commodities in the 1970's. The report is not in compliance with the 43-101 F1 Technical Report regulations, because of the age of the data.

“The main purpose of the [Induced Polarization survey] was to determine the response to the known mineralization and then to explore for extensions of the known mineralization as well as to locate new zones.”

Unlike the Induced Polarization survey conducted during the 1970's which only covered a depth of appx. 3 meters, a 2006 IP survey in the Moore Property, done by another, independent P.Geo., covered this area to a depth of at least 360 meters (1300 feet), and the depth of mineralization, based on the chargeability and resistivity of the rock, has been increased to 360 meters (1300 feet). Therefore, Almo Capital is very pleased with the results of the 2006 IP survey.

The old confines of the Moore Property, consisting of 24 claims and 2300 x 1900 meters, have been expanded to 5300 x 4600 meters, because of the potential of mineralization of the property. Diamond drilling will start as soon as possible, and the drill core samples will be assayed for copper, gold, silver, zinc and lead. Due to an extreme shortage of diamond drillers, the drilling has not commenced yet. Diamond drilling of the Moore Property is expected to commence as soon as a suitable driller is lined up. The funds are ready for the drilling project. The starting time will depend on the availability of a suitable driller; the shareholders will be informed when the drilling starts. On the basis of

2006 IP survey results in areas to the northeast and southwest of the 2300 x 1900 meter area, anomalous targets indicating likely continued mineralization have been outlined. The geophysicist has identified a total of 32 drilling targets. Previous geophysical work has indicated targets in the same area, and they were drilled and showed copper at appx. 0.35 %. It is not a matter of sheer coincidence only that IP anomalies are in the same places after a lapse of many decades, but it can be concluded that the anomalies are only in places which are geologically significant.

The new 2006 Induced Polarization survey geophysical report is enclosed in an unabridged form.

On behalf of the Board of Directors

*“Ram Vallabh”*

Ram Vallabh  
President  
Almo Capital Corp.  
Fax 604-681-3601, Phone 604-873-8168

Contact person: R. Vallabh at 604-681-3601

Disclaimer: The TSX Venture Exchange has neither reviewed nor accepts responsibility for the adequacy or accuracy of this news release.

**GEOPHYSICAL REPORT**  
**ON**  
**IP and RESISTIVITY SURVEYS**  
**OVER**  
**THE MOORE MINING PROPERTY**  
**(BASE and PRECIOUS METALS)**  
**NORTH BARRIERE LAKE, BARRIERE AREA**  
**KAMLOOPS MINING DIVISION, B.C.**

---

PROPERTY LOCATION	30 km N75°E(75°E) of the town of Barriere, B.C. Latitude:, 51° 19' 00" N Latitude Longitude: 119° 47' 00"W Longitude N.T.S. – 82M/05
WRITTEN FOR	<b>ALMO CAPITAL CORP</b> 603 – East 30 <sup>th</sup> Avenue Vancouver, British Columbia V5V 2V7
WRITTEN BY	David G. Mark, P.Geo. <b>GEOTRONICS CONSULTING INC</b> 6204 – 125 <sup>th</sup> Street Surrey, British Columbia, V6C 2Z4 January 2, 2007

## TABLE OF CONTENTS

<i>SUMMARY</i> .....	<i>i</i>
<i>CONCLUSIONS</i> .....	<i>ii</i>
<i>RECOMMENDATIONS</i> .....	<i>i</i>
<b>INTRODUCTION and GENERAL REMARKS</b> .....	<b>1</b>
<b>PROPERTY AND OWNERSHIP</b> .....	<b>2</b>
<b>LOCATION AND ACCESS</b> .....	<b>4</b>
<b>PHYSIOGRAPHY</b> .....	<b>4</b>
<b>HISTORY OF PREVIOUS WORK</b> .....	<b>4</b>
<b>GEOLOGY</b> .....	<b>6</b>
(a) Regional .....	6
(b) Property .....	6
(c) Mineralization .....	6
<b>Instrumentation</b> .....	<b>7</b>
<b>Theory</b> .....	<b>7</b>
<b>Survey Procedure</b> .....	<b>8</b>
<b>Compilation of Data</b> .....	<b>9</b>
<b>INVERSION INTERPRETATION</b> .....	<b>10</b>
<b>DISCUSSION OF RESULTS</b> .....	<b>10</b>
<i>SELECTED BIBLIOGRAPHY</i> .....	<i>14</i>
<i>GEOPHYSICIST'S CERTIFICATE</i> .....	<i>15</i>
<i>AFFIDAVIT OF EXPENSES</i> .....	<i>16</i>

## LIST OF ILLUSTRATIONS

<u>MAPS - At Back</u>	<u>Scale</u>	<u>Map (figure) #</u>
BC Location Map	1:9,192,400	1
Local Location Map	1:188,666	2
Claim Map	1:55,470	3
Claim Map (Orthophoto Version)	1:54,600	4
Grid Location Map	1:40,000	5
Survey Plan Map	1:25,000	6
 <b>IP and Resistivity 3-D Inversions (UBC Software)</b>		
View from Northeast	as shown	GP-46
View from Southeast	as shown	GP-47
Plane View	as shown	GP-48
 <b><u>MAPS – In Pocket</u></b>		
 <b>IP and Resistivity Pseudosections</b>		
Line 100S	1:5,000	GP-1
Line 100N	1:5,000	GP-2
Line 300N	1:5,000	GP-3
Line 500N	1:5,000	GP-4
Line 700N	1:5,000	GP-5
Line 900N	1:5,000	GP-6
Line 1100N	1:5,000	GP-7
Line 1300N	1:5,000	GP-8
Line 1400N	1:5,000	GP-9
Line 1500N	1:5,000	GP-10
Line 1700N	1:5,000	GP-11
Line 1900N	1:5,000	GP-12
Line 2100N	1:5,000	GP-13
Line 1E	1:5,000	GP-14
Line 1W	1:5,000	GP-15

### **IP and Resistivity 2-D Inversions (Geotomo Software)**

Line 100S	1:5,000	GP-16
Line 100N	1:5,000	GP-17
Line 300N	1:5,000	GP-18
Line 500N	1:5,000	GP-19
Line 700N	1:5,000	GP-20
Line 900N	1:5,000	GP-21
Line 1100N	1:5,000	GP-22
Line 1300N	1:5,000	GP-23
Line 1400N	1:5,000	GP-24
Line 1500N	1:5,000	GP-25
Line 1700N	1:5,000	GP-26
Line 1900N	1:5,000	GP-27
Line 2100N	1:5,000	GP-28
Line 1E	1:5,000	GP-29
Line 1W	1:5,000	GP-30

### **IP and Resistivity 2-D Inversions (UBC Software)**

Line 100S	1:5,000	GP-31
Line 100N	1:5,000	GP-32
Line 300N	1:5,000	GP-33
Line 500N	1:5,000	GP-34
Line 700N	1:5,000	GP-35
Line 900N	1:5,000	GP-36
Line 1100N	1:5,000	GP-37
Line 1300N	1:5,000	GP-38
Line 1400N	1:5,000	GP-39
Line 1500N	1:5,000	GP-40
Line 1700N	1:5,000	GP-41
Line 1900N	1:5,000	GP-42
Line 2100N	1:5,000	GP-43
Line 1E	1:5,000	GP-44
Line 1W	1:5,000	GP-45

**Note:** The maps in pocket, were produced at a 1:5,000 scale. However, reproduction of the maps within this report has been reduced to fit an 11 by 17 page.

## SUMMARY

Induced polarization (IP) and resistivity surveys were carried out during June and July 2006 over a gridded area within the Moore Property. The work also included road clearing and line cutting.

The main purpose of the geophysical surveys was to determine the response to the known mineralization and then to explore for extensions of the known mineralization as well as to locate new zones. A secondary purpose was to aid in the geological mapping for which resistivity surveys are especially useful.

The IP and resistivity surveys were carried out using a BRGM Elrec 6 multi-channel receiver operating in the time-domain mode. The transmitter used was a BRGM VIP 4000, which was powered by a 6.5 kW Honda generator. The dipole length chosen was the 50-meter dipole read to six levels. The total amount of surveying carried out was 29.0 km along 15 lines.

The results were plotted both in pseudosection, and contoured. Two different 2-D inversion interpretations were also carried out along each of the IP lines. The first inversion was a rapid least squares method produced by Geotomo Software and the second was the UBC method designed by the geophysics department and was carried out to gain greater depth. A plan map was drawn of the results. In addition, a test 3-D UBC inversion was carried out on lines 1300N, 1400N, and 1500N.

## CONCLUSIONS

1. The IP survey encountered a strong response over much of the survey area within the Moore Property. The response, as interpreted by inversion, has been categorized into eight anomalous zones and anomalies that are labeled by the upper case letters, A to H.
2. Anomalous zone A contains the main zone of mineralization and much of the historical drilling. It strikes northerly, is up to 950 m wide and has a strike length of at least 1,700 m being open to the north. It correlates very well with the results of the historical drilling and shows more optimum drilling targets.
3. The likely causative source of the anomalies within A is sulphides of economic interest. However, a zone of graphitic shale containing pyrite strikes northerly through the western part of zone A. It would appear the graphitic shale is related to the mineralization of economic interest.
4. Anomaly B occurs to the east of A striking north-northwesterly. It has a minimum strike length of 1100 m being open to the north and has a width of up to 300 m. Drilling within this zone indicates the causative source is likely sulphides of economic interest. The south end of B occurs at depth but because of its size and correlation with resistivity results, is a strong target.
5. Anomalous zone C occurs within the northwest corner of the survey area and probably strikes northerly with a minimum strike length of 600 meters. Its width is up to 700 meters. No drilling is known to have been done in this area and thus the geology is mostly unknown. However, because of its correlation with a higher resistivity response, it is considered to be of exploration interest.
6. Anomaly D occurs within the southern part of the grid area to the immediate east of and to the immediate south of anomalous zone A. It strikes northerly with a minimum strike length of 1,000 m being open to the south and has a width of up to 280 meters. This anomaly is also considered to be an exploration target.
7. Anomalies E, F, and G are essentially one-line anomalies since no lines were done on either side. They are of exploration interest but additional IP surveying should be carried out on either side of each of these anomalies.
8. Anomaly H occurs within the southeastern part of the survey area striking northerly. It is interpreted to be caused by pyrite in granite and thus is of low exploration interest.
9. The 3-D inversion of lines 1300N, 1400N, and 1500N agrees quite well with the 2-D inversion of the same lines. However, an additional advantage is that it shows the shape and continuity between the lines and thus can lead to more accurate drilling.

## RECOMMENDATIONS

1. It is recommended to diamond drill the inversion IP anomalies as shown in the following table. These targets are a collaboration between the writer and Mr. David Bridge, P.Geo. The target depth as shown is the vertical depth to the center of the inversion IP anomaly. The priority is based on the strength of the IP anomaly, its correlation with the resistivity results as well as known mineralization in the area. In addition, the drill targets on line 2100N are given low priority due to poor access. Drill collars and angles of the holes are not given and will depend on access.

	<b>LINE</b>	<b>STATION</b>	<b>TARGET DEPTH (meters)</b>	<b>PRIORITY</b>	<b>KNOWN MINERALIZATION</b>
1	100S	50W	75	Medium	None
2	100S	550W	75	Medium	None
3	100N	230W	75	Medium	None
4	100N	390W	150	Low	None
5	300N	205W	120	Medium	None
6	500N	225W	75	Medium	None
7	700N	200W	50	Medium	None
8	700N	370W	65	Low	None
9	1100N	200E	220	High	None
10	1100N	230W	80	Low	None
11	1100N	410W	75	High	None
12	1300N	110W	120	High	Yes
13	1300N	270W	85	High	Yes
14	1400N	650E	60	Medium	None
15	1400N	220E	160	Medium	None
16	1400N	280W	60	High	Yes
17	1400N	750W	60	Low	None
18	1500N	230E	40	High	Yes
19	1500N	335W	70	High	Yes
20	1500N	1130W	125	Medium	None
21	1700N	335E	60	Low	None
22	1700N	120E	100	High	Yes
23	1700N	130W	65	High	Yes
24	1700N	545W	90	High	Yes
25	1700N	800W	100	Low	None
26	1700N	1170W	200	Medium	None
27	1900N	0	140	Low	None
28	1900N	270W	70	Medium	None
29	1900N	1050W	150	Low	None
30	2100N	80E	80	Low	None
31	2100N	180W	105	Low	None
32	2100N	570W	80	Low	None

2. The IP and resistivity surveying will need to be expanded in all four directions. It is also recommended to reduce the line spacing to 100 meters.

**GEOPHYSICAL REPORT**  
**ON**  
**IP and RESISTIVITY SURVEYS**  
**OVER**  
**THE MOORE MINING PROPERTY**  
**(BASE and PRECIOUS METALS)**  
**NORTH BARRIERE LAKE, BARRIERE AREA**  
**KAMLOOPS MINING DIVISION, B.C.**

---

**INTRODUCTION AND GENERAL REMARKS**

This report discusses survey procedure, compilation of data, interpretation methods, and the results of induced polarization (IP), resistivity, and self potential (SP), surveys carried out over the Moore Property. The property is located within the northern part of the Kamloops Mining Division to the east of Barriere, a small town north of Kamloops within the province of British Columbia.

The road clearing and line cutting began on June 22<sup>nd</sup>, 2006 and were finished on July 20<sup>th</sup>. The IP and resistivity surveys were started on July 1<sup>st</sup> and were finished on July 26<sup>th</sup>. Exploration on the property is under the supervision of David Bridge, P.Geo, geologist for Almo Capital.

The purpose of the geophysics was to determine the response of each to the known mineralization on the property and thence to determine if and where the known mineralization extends, as well as to locate any possible new zones. The secondary purpose, especially resistivity survey, was to assist in the mapping of the geology of the property. More specifically, the purpose of each survey was as follows:

**IP (chargeability):** The general purpose of IP is to respond to sulphide mineralization especially that which occurs as fracture-filling and/or disseminated. The size of the IP anomaly is directly related to the surface area of the sulphides and thus fracture-filling and disseminated sulphides give a much higher anomalous reading than massive sulphides do. It was thus expected that the IP method would give the best results to the known mineralization

on this property since it was expected that all the mineralization occurred as or was associated with disseminated or fracture-filling sulphides.

Moreover, an IP survey had been completed in 1970 within the present IP survey area of the property and thus IP was known to respond very well to the known mineralization. However, it was done at only one electrode separation, which was common at that time, and thus was limited in depth extent and gave little information on the shape of the causative sources. Therefore, the purpose of re-doing the IP survey was to explore to at least 200 meters and to more accurately delineate the location and shape of the causative sources. This was to be aided by carrying out an inversion interpretation on the data.

**Resistivity:** The purpose of the resistivity surveying was to reflect the mineral zones by responding as lows to any geological structure and/or alteration, or as highs to silicification and/or calcification any of which may be associated with it. For geological mapping, the resistivity method is particularly adept at mapping lithology since all rock types have their own resistivities, i.e., intrusives usually respond as resistivity highs and argillites usually respond as resistivity lows. Also, as indicated above, the resistivity method is particularly proficient at mapping geologic structure.

**Self Potential:** Self potential, or SP, is essentially a by-product of carrying out IP/resistivity surveying. (It needs to be nulled out in order to measure the IP value.) Therefore it is not a prime exploration tool for this property. However, it is possible that it may respond to the mineralization and therefore prove to be quite useful. SP surveying usually has the best response to more massive sulphide mineralization such as vein-type.

The description of the property as written in the next few sections is taken from David Bridge's report on the property dated August 25, 2004..

## **PROPERTY AND OWNERSHIP**

The property is staked within the Kamloops Mining Division of British Columbia and consists of 32 contiguous claims as shown below in the table and as shown on figure #2, which is taken from BC government's "Map Place" web site with the claim information being taken from the BC government's "Mineral Titles Online" web site. The 32 claims consist of 12 older ground-staked claims and 20 newer computer-staked claims. The newer claims expanded the property as well as replaced many of the older claims

The claims are being optioned to Almo Capital Corp. of Vancouver B. C. by S. Krishan of Richmond, B.C. However, they are registered with Mineral Titles of the B.C. government in the name of Ram Vallabh, the company president.

<u>Tenure Number</u>	<u>Claim Name</u>	<u>Map Number</u>	<u>Good To Date</u>	<u>Area</u>	<u>Tag Number</u>
217448	Red Fox #3	082M032	2009/Jul/02	25	394668M
217450	Bat #1	082M032	2011/Jul/02	25	394670M
217451	Bat #2	082M032	2011/Jul/02	25	394671M
217452	Bat #3	082M032	2011/Jul/02	25	394672M
217453	Bat #4	082M032	2011/Jul/02	25	394673M
217460	Lynx #2	082M032	2009/Jul/18	25	532107M
378581	Bhalu 3	082M032	2009/Jul/05	25	696133M
378582	Bhalu 4	082M032	2011/Jul/05	25	696134M
378585	Bhalu 7	082M032	2009/Jul/05	25	696137M
395113	Moore #3	082M032	2010/Jul/06	225	234408
395114	Moore #4	082M032	2010/Jul/06	25	698401M
395115	Moore #5	082M032	2010/Jul/06	25	698402M
517040	Moore #8	082M	2009/Jul/12	80.782	
517082	Moore #9	082M	2009/Jul/12	121.173	
517119	Moore #10	082M	2009/Jul/12	80.8	
517140	Moore #11	082M	2009/Jul/12	60.597	
517168	Moore #12	082M	2009/Jul/12	80.804	
517184	Moore #13	082M	2009/Jul/12	60.614	
518010	Moore #16	082M	2009/Jul/19	60.614	
525230	RV21	082M	2009/Jan/13	121.222	
525244	RV22	082M	2009/Jan/13	60.619	
525269	RV23	082M	2009/Jan/13	60.608	
525283	RV24	082M	2009/Jan/13	60.597	
525293	RV25	082M	2009/Jan/13	60.592	
543434	AP#2	082M	2007/Oct/17	121.232	
543435	AP#3	082M	2007/Oct/17	121.254	
543436	AP#4	082M	2007/Oct/17	121.281	
543439	AP#5	082M	2007/Oct/17	60.651	
543441	AP#7	082M	2007/Oct/17	60.657	
543640	AP#8	082M	2007/Oct/19	40.391	
543641	AP#9	082M	2007/Oct/19	80.829	
543643	AP#10	082M	2007/Oct/19	101.023	
			<b>TOTAL HECTARES</b>	<b>2116.34</b>	

## **LOCATION AND ACCESS**

The property is located on the ridge between North Barriere Lake and East Barriere Lake about 30 km easterly of the town of Barriere, B.C., which is about 60 km north of the city of Kamloops, British Columbia.

The geographical coordinates of the center of the property are 51° 19' 00" north latitude and 119° 47' 00" west longitude. It is located within NTS map area 82M/05W.

The property is accessed by a series of paved and gravel roads from Barriere, B.C. taking about 45 minutes.

## **PHYSIOGRAPHY**

The Moore Mineral Property is located within the Shuswap Highlands which is a physiographic division of the Interior Plateau System within south-central British Columbia. The property terrain is typical of the Shuswap Highlands with the ridge top between the two Barriere Lakes being rounded and gentle to quite moderate. However, the slope drops steeply into North Barriere Lake as well as down into East Barriere Lake. Both of these terrain features are caused by glaciation which rounds off and softens the upland relief and yet steepens the valley sides as well as deepens the valley floor.

The elevation varies from 627 meters above sea level on East Barriere Lake and 640 meters on North Barriere Lake to above 1500 meters along the northwest side of the property. The relief is therefore almost 900 meters.

There are no major creeks within the property area. The main water sources would be the two lakes, North Barriere and East Barriere. A small lake occurs on the Bhalu 7 claim. There are also a number of swamps within the center of the claims though often these will dry up in the summer.

The climate in the property area is typical of the south-central Interior with cold winters and warm to hot summers. The snow begins to accumulate in mid-October and melts in May during a typical fall to spring cycle. One can usually begin field work in May and continue to October, and perhaps later.

## **HISTORY OF PREVIOUS WORK**

David Bridge gives a thorough description of the previous exploration work including a discussion of the results done in the area and on the property. The following is a summary of his description.

The property was discovered in the early to mid '60's when mineralized float was traced north from East Barriere Lake by George and Tom Moore. They optioned the property to Scurry Rainbow Oils in 1966 that established 80 km of grid and partially covered it with magnetic and electromagnetic surveys. The Gourlay and Moore brothers restaked the

property and drilled 5 short packsack drill holes apparently encountering 0.5 m (1.5 feet) massive sulphides with silver mineralization.

The property was later optioned to Royal Canadian Ventures Ltd. who completed 48 km of magnetic and geochemical surveys in 1969. The soil geochemistry survey revealed a large copper anomaly, 370 m by 550 m, with correlating silver values and an adjacent zinc anomaly. The anomaly suggested the causative source to be striking northwesterly. A magnetic survey was also carried out and it showed a north-northwesterly trend with a magnetic high correlating with outcrops of pyrrhotite-magnetite-chalcopyrite zones in skarny amphibolite. They also drilled five holes returning the following values:

1. EBL 69-1: 0.30% copper over 36.89 meters
2. EBL 69-2: 0.30% copper over 24.39 meters
3. EBL 69-4: 0.44% copper over 18.90 meters

During 1970, Royal Canadian carried out an IP/resistivity survey along 41.6 km of lines using single dipole separations, and therefore no pseudosections. A large significant anomaly was outlined. Later that year additional soil sampling and geological mapping was carried out as well as percussion drilling, which returned several significant intersections of copper mineralization. Later that year additional magnetic surveying was carried out.

In 1971 and 1972, Noranda Exploration carried out soil sampling and magnetic surveying with emphasis on the northern part of the property with the steep slope into North Barriere Lake. A significant copper anomaly was outlined containing anomalous values in zinc as well. Craigmont Mines later conducted an IP survey which revealed an anomaly of size 1220 meters long by 122 meters wide.

In 1973, an airborne magnetic and electromagnetic survey was carried out over the property and revealed two anomalies.

In 1976, Kennco Explorations carried a limited soil sample survey in the area of skarn mineralization.

In 1978, Esso Resources conducted electromagnetic, magnetic, and soil surveys and then drilled one diamond drill hole.

In the years 1981 to 1986, K. E. Northcote (on behalf of the owner, George Moore?) did thin section work and re-examined some of the drill core. He also supervised a hand-trenching, blasting, and sampling program along newly-constructed logging roads as well as carried out limited VLF-EM and magnetic surveying and soil sampling.

In 1987, Mr. Ram Vallabh with other investors acquired the property. Some soil sampling and geological mapping was carried out in 1987, 1994, and 2001.

In 1993, Agate Bay Resources, because of over staking of the Moore property, carried out limited soil sampling and Genie EM surveys in an attempt to locate the source of mineralized boulders. Some follow-up trenching was done but no assay results are known.

## **GEOLOGY**

The following is taken from Bridge's report.

### **(a) Regional**

The regional geology is described by Schiarizza and Preto (1987) whose paper on the area indicate that the property is underlain by the Cambrian to Mississippian Eagle Bay Assemblage of the Kootenay Terrane, otherwise described as rock unit EBQ, which consists of micaceous quartzite, grit, phyllite, and quartz mica schist. Upper portions of this unit consist of chlorite schist, limestone, calcareous phyllite, calc-silicate schist and amphibolite. Unit EBQ overlies orthogneiss exposed southeast of the property, and it is bounded to the west by the northeast-dipping Birk Creek thrust fault.

The Cretaceous granodiorite Baldy batholith intrudes the Eagle Bay Assemblage to the east of the property. The contact is exposed near Kozy Lake roughly 4 km east of the property.

### **(b) Property**

“The geology of the Moore Property is dominated by an interbedded package of green chlorite schist with schistose argillite and quartz sericite. Small lenses of marble and skarn occur throughout the interbedded package. This package of rocks may represent bimodal volcanism in an aqueous environment. Towards the east and north of the center of the property the schistose rocks are replaced by biotite orthogneiss which underlies the schists. The metamorphic grade increases from greenschist in the west to amphibolite in the east. Notes from the examination of drill holes by Northcote (1981) indicate the schistose rocks are cut by foliated quartz diorite dykes.”

“Two relatively undeformed quartz diorite stocks are exposed in the southeastern part of the property where they host white quartz veins. These intrusions are thought to be related to the Cretaceous granodiorite Baldy batholith. Feldspar porphyry dykes have been identified in drill core and are thought to represent a dyke swarm from the Baldy batholith. Feldspar porphyry dykes have been identified in drill core and are thought to represent a dyke swarm from the Baldy batholith (Baird, 1970). Fine-grained basaltic dykes have been also observed in drill core and are thought to be Tertiary in age (Baird, 1970).

“The structure of the interbedded schists is complex with many overturned isoclinal folds, and is not yet fully understood as yet. The foliation generally strikes to the northwest with a 25° to 45° dip to the southwest. In the north-central part of the property, the schists have a crenulation cleavage striking northeasterly.”

### **(c) Mineralization**

Mineralization on the property is hosted by the Eagle Bay Assemblage.

“There are two styles of mineralization on the Moore Property: (i) Kuroko volcanogenic massive sulphide copper veins and (ii) skarn pyrrhotite – magnetite – chalcopyrite masses.”

Red Fox #1 to #2 [now Moore #10] mineral claims and on surface in the Bat #2 mineral claim. The mineralization is hosted by chlorite schists and argillites as pyrite and/or chalcopyrite – quartz veins. The mineralization deepens towards the south. Minor amounts of gold occur with metamorphosed quartz diorite dykes intruding the chlorite schists. This mineralization has a possible strike length of 3200 meters and has up to 65 meters of apparent thickness which is open at depth.”

“Skarn mineralization is known to occur on the Lynx #1 to #4, Red Fox#3 to #4, Bhalu(, Ram #10 to #15, and Moore 2 mineral claims [now the Moore #8, #9, #13, and #16 cells]. The skarn occurs in chloritic rock or chlorite schist with quartz, epidote, garnet injected by narrow quartz-rich dykes. The skarn is mineralized with pyrite, pyrrhotite, magnetite, and chalcopyrite as scattered blebs, irregular wisps and disseminated to massive throughout the rock matrix. Massive magnetite outcrop has been identified within the property.”

## **INSTRUMENTATION**

The transmitter used was a BRGM model VIP 4000. It was powered by a Honda 6.5 kW motor generator. The receiver used was a six-channel BRGM model Elrec-6. This is state-of-the-art equipment, with software-controlled functions, programmable through a keyboard located on the front of the instrument. It can measure up to 10 chargeability windows and store up to 2,500 measurements within the internal memory.

## **THEORY**

When a voltage is applied to the ground, electrical current flows, mainly in the electrolyte-filled capillaries within the rock. If the capillaries also contain certain mineral particles that transport current by electrons (mostly sulphides, some oxides and graphite), then the ionic charges build up at the particle-electrolyte interface, positive ones where the current enters the particle and negative ones where it leaves. This accumulation of charge creates a voltage that tends to oppose the current flow across the interface. When the current is switched off, the created voltage slowly decreases as the accumulated ions diffuse back into the electrolyte. This type of induced polarization phenomena is known as electrode polarization.

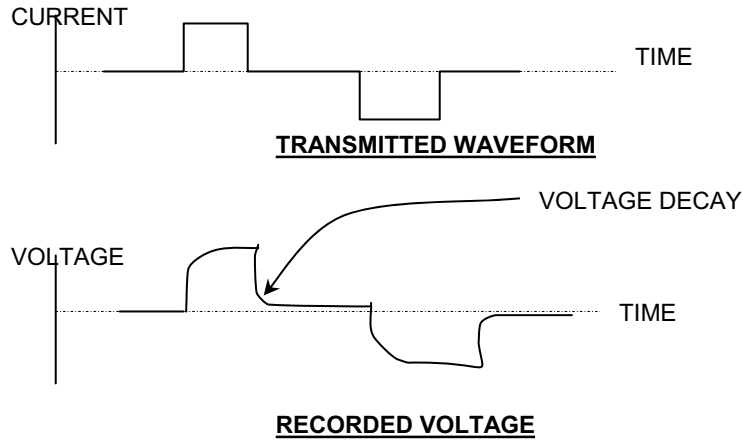
A similar effect occurs if clay particles are present in the conducting medium. Charged clay particles attract oppositely-charged ions from the surrounding electrolyte; when the current stops, the ions slowly diffuse back to their equilibrium state. This process is known as membrane polarization and gives rise to induced polarization effects even in the absence of metallic-type conductors.

Most IP surveys are carried out by taking measurements in the “time-domain” or the “frequency-domain”.

Time-domain measurements involve sampling the waveform at intervals after the current is switched off, to derive a dimensionless parameter, the chargeability “M”, which is a measure of the strength of the induced polarization effect. Measurements in the frequency domain are

based on the fact that the resistance produced at the electrolyte-charged particle interface decreases with increasing frequency. The difference between apparent resistivity readings at a high and low frequency is expressed as the percentage frequency effect, or “PFE”.

The quantity, apparent resistivity,  $\rho_a$ , computed from electrical survey results is only the true earth resistivity in a homogenous sub-surface. When vertical (and lateral) variations in electrical properties occur, as they almost always will, the apparent resistivity will be influenced by the various layers, depending on their depth relative to the electrode spacing. A single reading, therefore, cannot be attributed to a particular depth.



The ability of the ground to transmit electricity is, in the absence of metallic-type conductors, almost completely dependent on the volume, nature and content of the pore space. Empirical relationships can be derived linking the formation resistivity to the pore water resistivity, as a function of porosity. Such a formula is Archie’s Law, which states (assuming complete saturation) in clean formations:

$$R_o = O^{-2} R_w$$

Where:  $R_o$  is formation resistivity  
 $R_w$  is pore water resistivity  
 $O$  is porosity

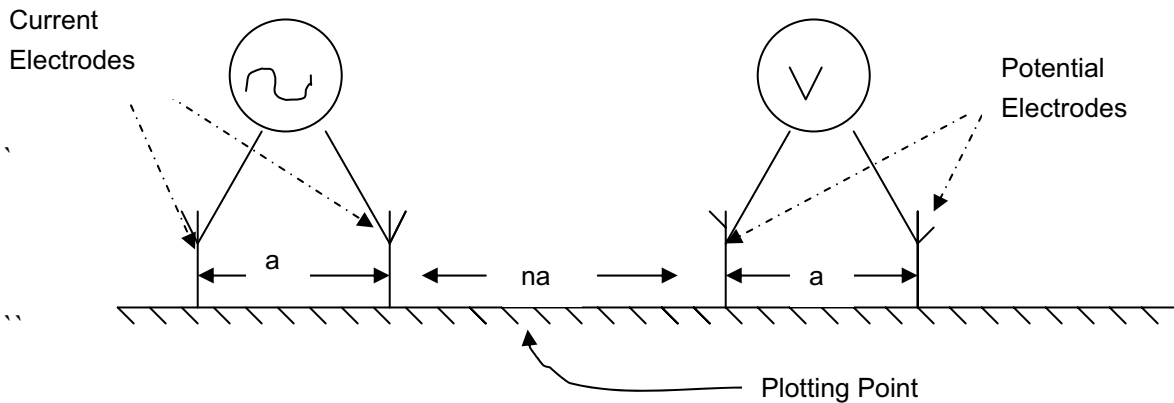
## SURVEY PROCEDURE

In preparation for the IP/resistivity survey, the lines were cut out, which involved removing brush and downfallen trees. In addition, several kilometers of road were brushed out to gain access to the property.

The IP and resistivity measurements were taken in the time-domain mode using an 8-second square wave charge cycle (2-seconds positive charge, 2-seconds off, 2-seconds negative charge, 2-seconds off). The delay time used after the charge shuts off was 80 milliseconds and the integration time used was 1,760 milliseconds divided into 10 windows.

The array chosen was the dipole-dipole, shown as follows:

## DIPOLE-DIPOLE ARRAY



The reading interval and electrode separation chosen was 50 meters carried out on lines 200 meters apart. The exception was line 1400N which is an in-between line to lines 1300N and 1500N, reducing the line interval in this area to 100 meters. The purpose was to gain extra information due to known mineralization in the area as well as to carry out 3-D inversion interpretation using these three lines. A 200-meter line separation was considered to be too wide to effectively do 3-D inversion on this property.

Stainless steel stakes were used for current electrodes as well as for the potential electrodes.

The stations were then marked by a combination of blaze orange flagging and blue flagging once the electrodes and wires were emplaced. The terrain was also surveyed with a hand-held clinometer.

The amount of IP and resistivity surveyed was 29.0 km, which was carried out over six lines of 2.6 km length, seven lines of 1.6 km length, and two lines of 1.1 km length

## COMPILATION OF DATA

All the data were reduced by a computer software program developed by Geosoft Inc. of Toronto, Ontario. Parts of this program have been modified by Geotronics Surveys Inc. for its own applications. The computerized data reduction included the resistivity calculations, pseudosection plotting, survey plan plotting and contouring.

The chargeability (IP) values are read directly from the instrument and no data processing is therefore required prior to plotting. The resistivity values are derived from current and voltage readings taken in the field. These values are combined with the geometrical factor appropriate for the dipole-dipole array to compute the apparent resistivities.

All the data have been plotted in pseudosection form at a scale of 1:2,500. One map has been plotted for each of the 15 lines and these are numbered GP-1 to GP-15, respectively.

The pseudosection is formed by each value being plotted at a point formed from the intersection of a line drawn from the mid-point of each of the two dipoles. The result of this method of plotting is that the farther the dipoles are separated, the deeper the reading is plotted. The resistivity pseudosection is plotted on the upper part of the map for each of the lines, and the chargeability pseudosection is plotted on the lower part.

All pseudosections were contoured at an interval of 5 milliseconds for the chargeability results, and at an interval of logarithmic to the base 10 for the resistivity results.

The self-potential (SP) data from the IP and resistivity survey was plotted and profiled above the IP and resistivity pseudosections for each line. It is not expected that the SP data will be important in the exploration of the property but considering that the data was taken anyway it was plotted and profiled because of the possibility it may contain useful information that may enhance the property's exploration potential.

## **INVERSION INTERPRETATION**

A 2-D inversion interpretation was carried out on the IP and resistivity data using computer software produced by Geotomo Software. This purpose of inversion interpretation is to eliminate the electrode effect that is endemic with IP and resistivity data and thus locate the causative sources more accurately. The Geotomo inversion is a rapid method that uses the least squares interpretation. However because of this, it interprets to about half of the exploration depth and thus it was decided to redo the inversion using the method developed by the UBC geophysical department.

The two resulting 2-D interpretations agree in general other than the UBC method interprets to twice the depth. This provides some confidence in the inversion interpretation, especially for the purpose of drilling the inversion targets.

In addition to the 2-D inversion of all 15 lines, a 3-D inversion was carried out on lines 1300N, 1400N, and 1500N for the purpose of testing whether 3-D inversion would give additional information especially in regard to drilling targets.

## **DISCUSSION OF RESULTS**

The IP survey, as interpreted by 2-D inversion, shows that much, if not most, of the survey area contains anomalous IP results. This indicates that much of the survey area contains sulphides. The writer has therefore attempted to sort out the anomalous responses into eight different anomalous zones or anomalies and these have been labeled by the upper case letters, A to H, for ease of discussion.

However, there are two difficulties with categorizing the anomalous responses. Firstly, this has been done using the threshold IP value of 25 msec. But if the threshold limit is lowered to 20, a value that is anomalous within most IP survey areas, than most of the northern part of the survey area is anomalous and thus this would not be helpful in trying to understand how the mineralization occurs. Nevertheless, on parts of the property, a lower threshold

value may be important, perhaps because of different geology. For this reason two of the anomalies are defined using the lower threshold value. Secondly, in some cases, it is difficult to determine the continuity of anomalies from one line to the other because of the 200-meter line separation. Thus the writer cautions the reader that as exploration continues on the property, and therefore, as knowledge is gained, the number, shape, as well as the characteristics of the anomalous zones probably will change.

In the following discussion, David Bridge, P.Geol, consulting geologist to Almo, assisted the writer because of his geologic knowledge of the property.

**IP anomalous zone A** contains the main mineral zone as well as most of the historical drilling. This zone strikes northerly, is up to 950 meters wide, and has a minimum strike length of 1,700 meters, being open to the north.

The correlation of the known drill results with the IP inversion results is excellent. That is, IP highs correlate directly with known mineralization, such as in hole 70-9. And where drill holes did not encounter mineralization, such as in hole 70-7, the IP inversion shows that the drill holes missed the target.

Most of A reflects pyrite, chalcopyrite, and other sulphides within a schist, or possibly a breccia (as indicated by float found within the area of the zone). However, part of the anomalous zone to the west appears to be reflecting pyrite within graphitic shale. This has a geophysical signature of a strong IP high correlating with a strong resistivity low. The graphitic shale appears to be extending from line 500N to 1900N, a distance of 1400 meters. It may also extend to line 2100N where it may be shifted to the west, possibly through faulting. The width varies from 120 meters to 250 meters.

**IP anomaly B** occurs to the east of 'A' and strikes north-northwesterly. It has a minimum strike length of 1100 meters, also being open to the north. Its width varies from 100 meters on line 1700N to 300 meters on line 1100N.

There are three historical drill holes within this zone, all encountering mineralization. However, within two of the holes, the mineralization petered out and this agrees with the IP inversion results at these holes which also indicates that drilling to the east or to the west should have encountered a greater amount of mineralization

The IP inversion results at the southern end of B on line 1100N show a much bigger and deeper anomaly than along the rest of B to the north. It is possible, therefore, that this causative source on line 1100N is different from the rest of the causative source. However, it is considered to be a strong drilling target.

**IP anomalous zone C** occurs to the west of A. It probably strikes northerly, has a minimum strike length of 600 meters, and a width of up to 700 meters on line 1900N, or 1000 meters on line 2100N if the non-anomalous areas are included.

There are no known historical drill holes within C and thus the underlying rock-type is unknown except at 1300W on line 2100N. Here Bridge noted an outcropping of a gneissic rock with minor pyrite.

**IP anomaly D** occurs to the east of and to the south of anomalous zone A. It strikes northerly, and has a minimum strike length of 1000 meters being open to the south. Its width varies from 80 meters on line 500N to 280 meters on line 300N. On lines 100N and 100S, it may split into two or three anomalies. The underlying geology is unknown. However, the correlating resistivity response is mostly a high and thus the host rock is probably a schist.

**IP anomaly E** is a single line anomaly occurring on line 1W, having a width (?) of 380 meters, and correlating with a moderate resistivity response. It is therefore considered to be reflecting sulphides and thus is a target. However, before targets can be located for drilling purposes, additional IP surveying in this area would need to be carried out.

**IP anomaly F** occurs on line 1400N as well as on line 1E which crosses 1400N. It appears to be 200 meters wide and correlates with a resistivity high. It probably reflects sulphides, though whether they are of economic interest is unknown because of the unknown host rock-type.

**IP anomaly G** is also a one-line anomaly located on line 1E and having a line width of 270 meters. The underlying rock-type is also unknown but it correlates with a moderate resistivity response. This anomaly has a lower threshold of 20 msec but may be of economic interest.

**IP anomaly H** occurs within the southeast corner on the survey area striking northerly, and has a minimum strike length of 700 meters, being open to the south. This anomaly consists mostly of a moderate IP response of 20 msec, except on line 100S where the IP response is much stronger. In addition, it correlates with a strong resistivity high. From known geology in the area, this anomaly is probably reflecting pyrite within a granite host rock. It is therefore considered to be of low exploration interest.

### **Resistivity**

The results of the resistivity survey have mainly been discussed above with the IP results. However some of its main features are as follows:

1. A large resistivity high occurs within the northwestern part of the survey grid and may be reflecting a highly siliceous shale as is known to occur on line 1300N. However, diorite and a gneissic rock-type are also known to occur to the north.
2. A resistivity high occurs within the southeastern part of the survey area and here very likely reflects granite.

### **Self Potential**

The self potential results, for the most part, are quite noisy. However, a few anomalies stand out and correlate quite well with IP highs indicating that the causative sources are sulphide

bodies. Three of the more prominent ones are located at (700N, 960W), (1500N, 130E), and (1900N, 1100W). In addition, a strong SP anomaly occurs at (100S, 900W) but this one does not correlate with an IP high but rather with the boundary between a resistivity high and a resistivity low. Possibly the cause of the SP anomaly is related to a lithological contact. It is also possible that the causative source is a sulphide body, but with little associated disseminated sulphides that would otherwise give an IP high.

### **3-D Inversion**

The 3-D inversion of lines 1300N, 1400N, and 1500N agrees quite well with the 2-D inversion of the same lines. Its advantage, however, is that it shows the shape and continuity between the lines and thus can lead to more accurate drilling.

## **SELECTED BIBLIOGRAPHY**

Bridge, David J., M.Sc., P.Geo, Summary Report on the Moore Base and Precious Metal Mineral Property, Kamloops Mining Division, Central British Columbia, for Almo Capital Corp., August 25, 2004

Bridge, David J., M.Sc, P.Geo, Personal Communication,

David Bridge gives a thorough table of references in his report that are pertinent to the Moore Property.

## **GEOPHYSICIST'S CERTIFICATE**

I, DAVID G. MARK, of the City of Vancouver, in the Province of British Columbia, do hereby certify that:

I am registered as a Professional Geoscientist with the Association of Professional Engineers and Geoscientists of the Province of British Columbia.

I am a Consulting Geophysicist of Geotronics Consulting Inc., with offices at 6204-125<sup>th</sup> Street, Surrey, British Columbia.

I further certify that:

1. I am a graduate of the University of British Columbia (1968) and hold a B.Sc. degree in Geophysics.
2. I have been practicing my profession for the past 38 years, and have been active in the mining industry for the past 41 years.
3. This report is compiled from data obtained from IP and resistivity surveys carried out over a portion of the Moore Property from July 1<sup>st</sup> to the July 26<sup>th</sup>, 2006 under my direct supervision.
4. I do not hold any interest in Almo Capital Corp, nor in the property discussed within this report, nor in any properties associated with Almo, nor do I expect to receive any interest as a result of writing this report.

David G. Mark, P.Ge.  
Geophysicist

January 2, 2007

## **AFFIDAVIT OF EXPENSES**

Road clearing, line cutting and grid preparation as well as follow-up I.P., resistivity, and self potential surveys, were carried out over the Moore Property situated near the town of Barriere within the Kamloops MD, BC, from June 22<sup>nd</sup> to July 26<sup>th</sup>, 2006, to the value of the following:

### **LINECUTTING and ROAD CLEARING**

#### **Mob-demob (at cost)**

6-man crew, 2 days @ \$1,000/day	\$2,000.00	
Truck rental and gas for two trucks	590.00	
Room and Board	<u>575.00</u>	
SUB-TOTAL	\$3,165.00	

#### **Field**

6-man crew, 26 days @ \$2,100/day	<u>\$54,600.00</u>	
(includes room board, 2 trucks, and 4 chainsaws)		
<u>TOTAL</u>	\$57,765.00	\$57,765.00

### **IP and RESISTIVITY SURVEYS**

#### **Mob-demob (at cost)**

6-man crew, 2 days @ \$1,200/day	\$2,400.00	
Truck rental and gas for one truck	295.00	
Room and Board	<u>575.00</u>	
SUB-TOTAL	\$3,270.00	

#### **Field**

6-man crew, 20.5 days @ \$2,100/day, all inclusive	\$43,050.00	
<u>TOTAL</u>	\$46,320.00	\$46,320.00

#### **Data Reduction & Report:**

Senior geophysicist, 120 hrs. @ \$50/hr.	\$6,000.00	
Inversion of IP/Resistivity data	7,200.00	
Computer-aided data reduction & drafting, 40 hrs. @ \$60/hr.	1,000.00	
Printing, photocopying, compilation	<u>750.00</u>	
<u>TOTAL</u>	\$14,950.00	\$14,950.00

### **GRAND TOTAL**

**\$119,035.00**

Please note that \$20,000 of this work was carried out before July 2<sup>nd</sup>, 2006 and the remaining amount of \$99,035.00 was carried out after this date.

Respectfully submitted,  
**GEOTRONICS CONSULTING INC.**

David G. Mark, P.Geo.,  
Geophysicist

# Moore Property Location Map

-  Moore Property Location
- Topographic Layers**
  -  Lakes 1:6M
  -  Rivers 1:6M
- BC Border Layers**
  -  BC Border 1:6M



Map Center: 54.4781N 124.7082W

SCALE 1 : 9,192,395



Fig #1



# Moore Property Local Location Map

## Mineral Titles Layers

- Moore Property Tenure

## BC Administrative Area Layers

- Cities
- BC Communities
  - City
  - Town
  - Village
- Resort Municipality
- Settlement
- Community
- District Municipality

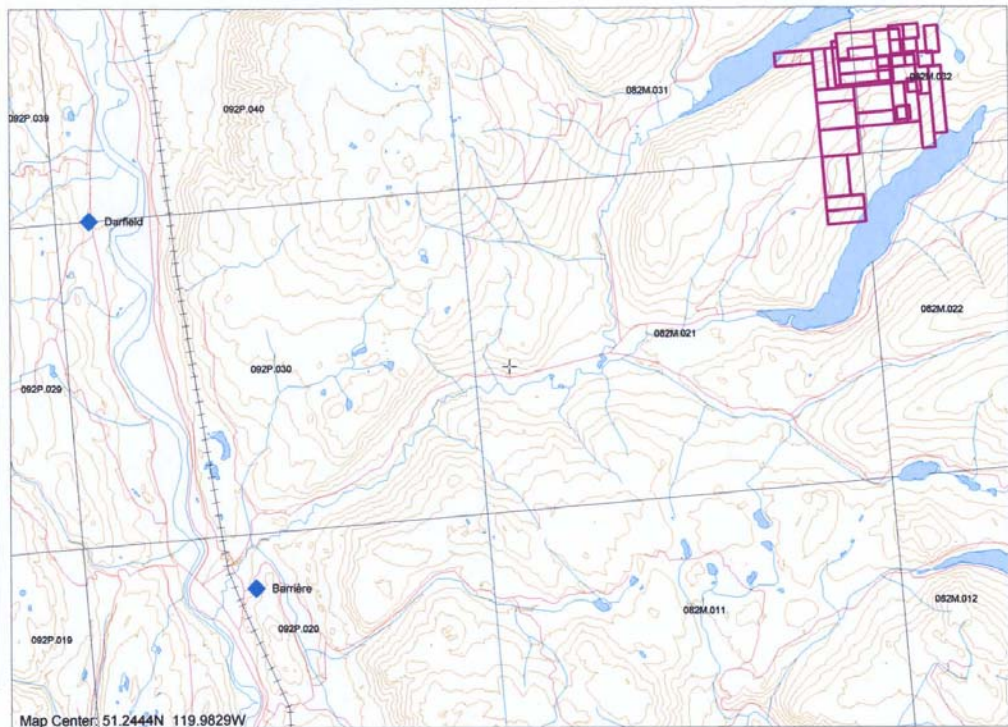
## BC Municipality labels

## Topographic Layers

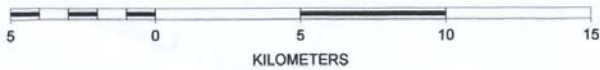
- Railways 1:6M
- Roads 1:250K
- Contours with Labels 1:20K (<50K)
- Lakes 1:50K
- Rivers 1:250K

## Grid Layers

- Grid 1:20K - labels
- Grid 1:20K - outline



SCALE 1 : 188,666

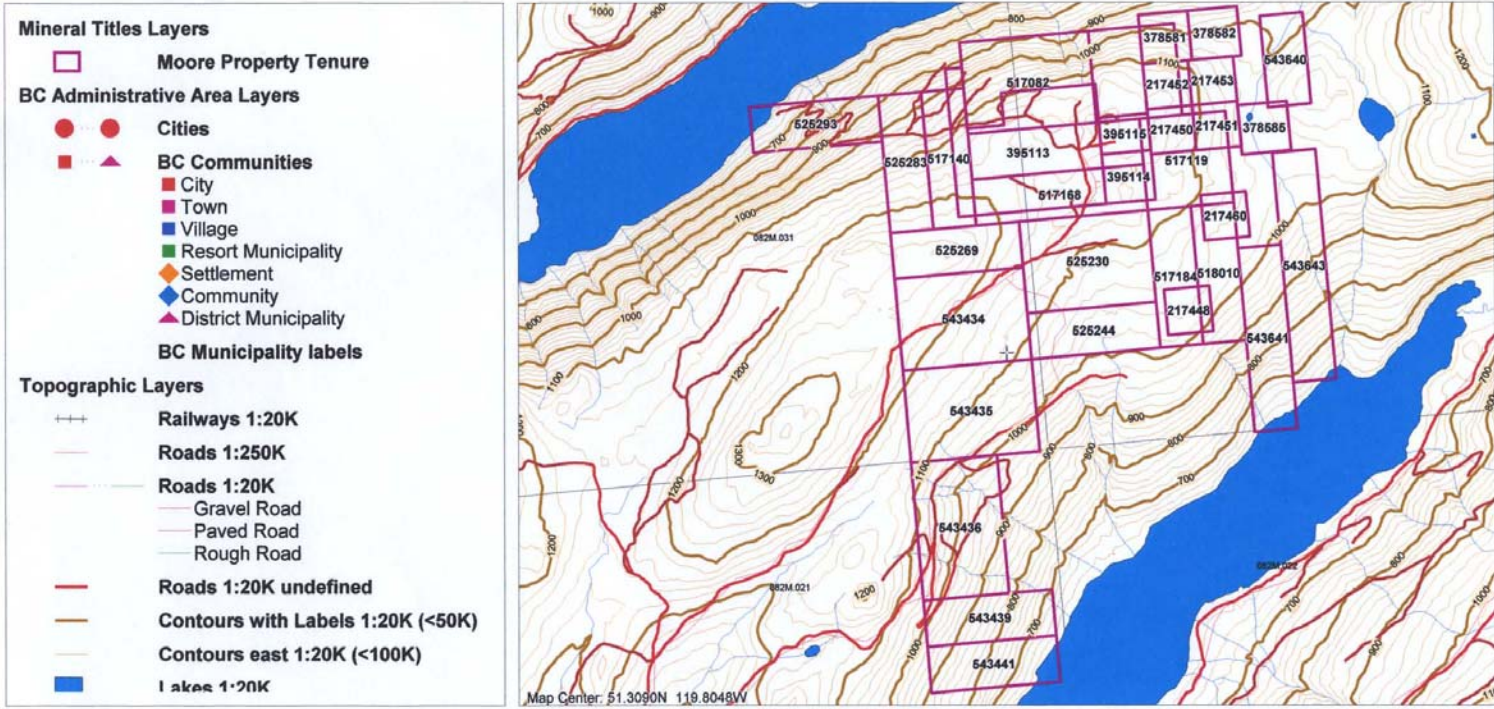


N

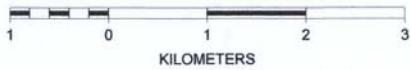


Fig #2

# Moore Property Claim Map



SCALE 1 : 55,470



N



Fig # 3

# Moore Property Claim Map (Orthophoto Version)

## Mineral Titles Layers

□ Moore Property Tenure

## BC Administrative Area Layers

- ● Cities
- ▲ BC Communities
  - City
  - Town
  - Village
  - Resort Municipality
  - ◆ Settlement
  - ◆ Community
  - ◆ District Municipality

## BC Municipality labels

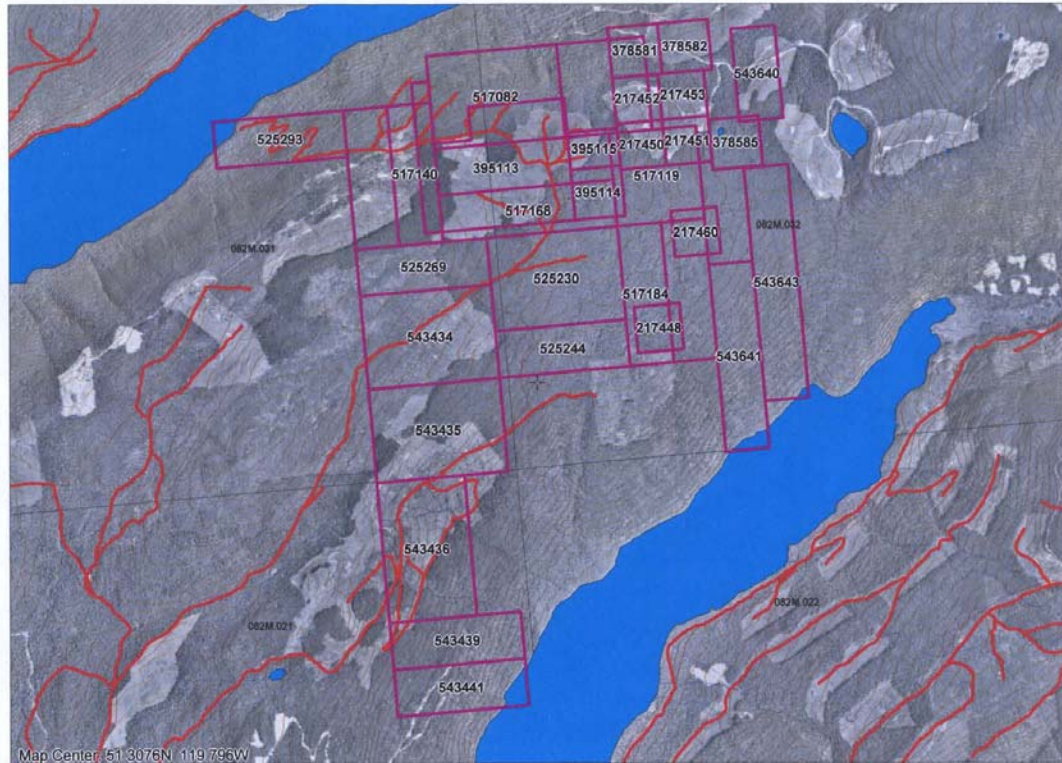
## Topographic Layers

- +++ Railways 1:20K
- Roads 1:250K
- Roads 1:20K undefined
- Contours east 1:20K (<100K)
- Lakes 1:20K
- Rivers 1:20K

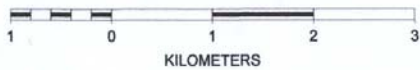
## Grid Layers

- Grid 1:20K - labels
- Grid 1:20K - outline

## Raster Layers



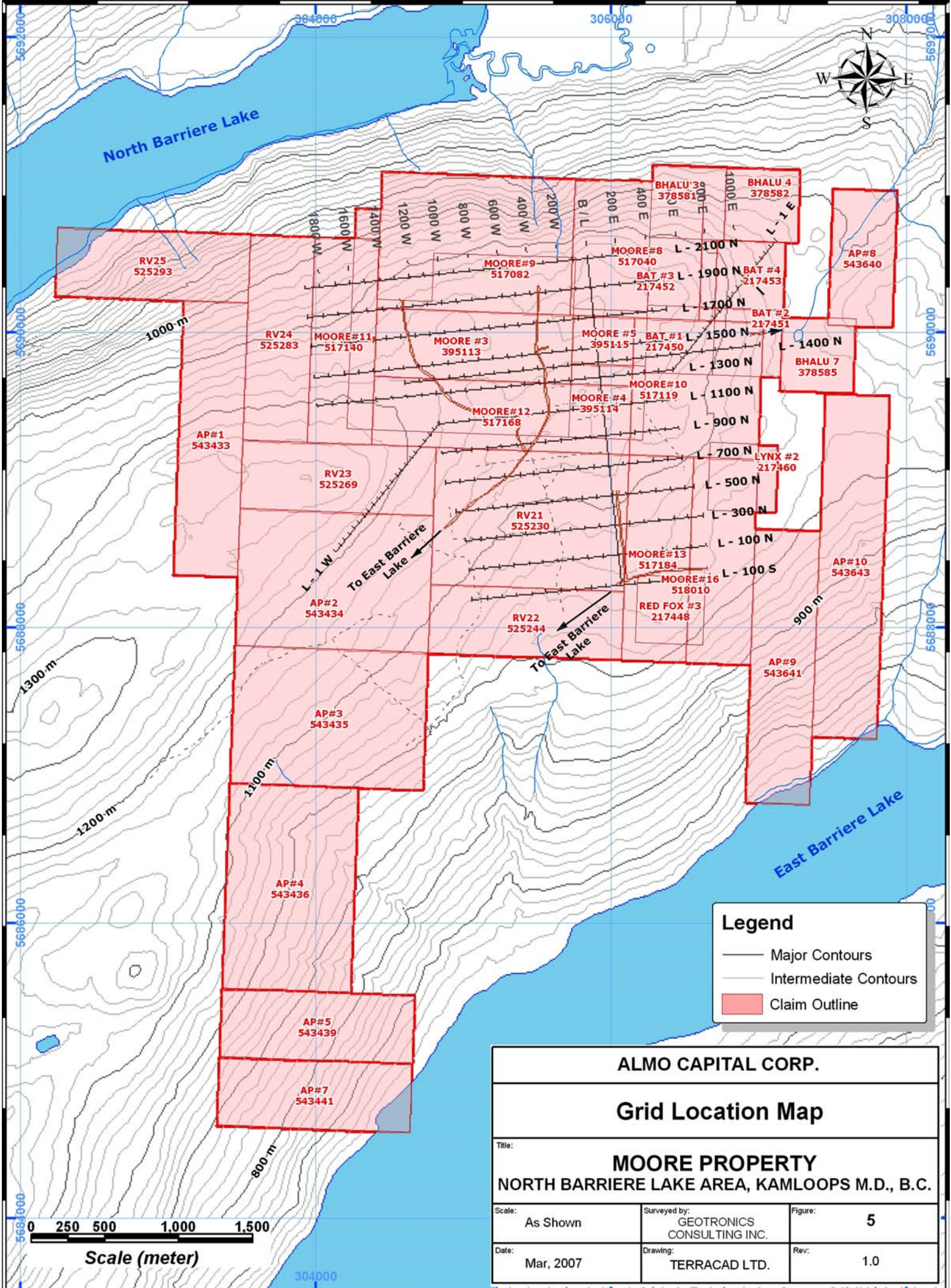
SCALE 1 : 54,601



N



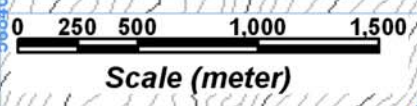
Fig #4

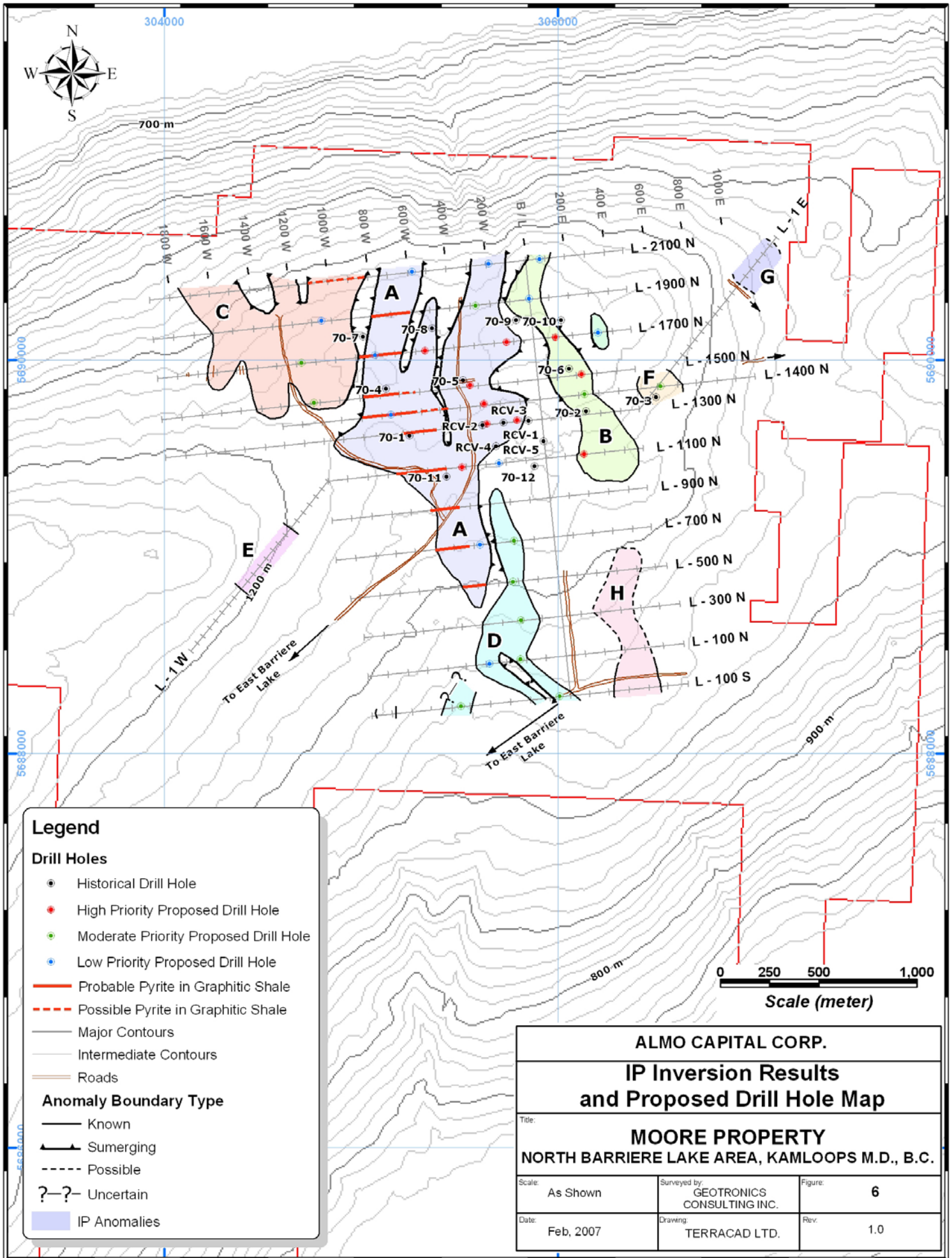


**Legend**

- Major Contours
- Intermediate Contours
- Claim Outline

<b>ALMO CAPITAL CORP.</b>		
<b>Grid Location Map</b>		
Title:		
<b>MOORE PROPERTY</b>		
NORTH BARRIERE LAKE AREA, KAMLOOPS M.D., B.C.		
Scale:	Surveyed by:	Figure:
As Shown	GEOTRONICS CONSULTING INC.	5
Date:	Drawing:	Rev:
Mar, 2007	TERRACAD LTD.	1.0





**Legend**

**Drill Holes**

- Historical Drill Hole
- High Priority Proposed Drill Hole
- Moderate Priority Proposed Drill Hole
- Low Priority Proposed Drill Hole

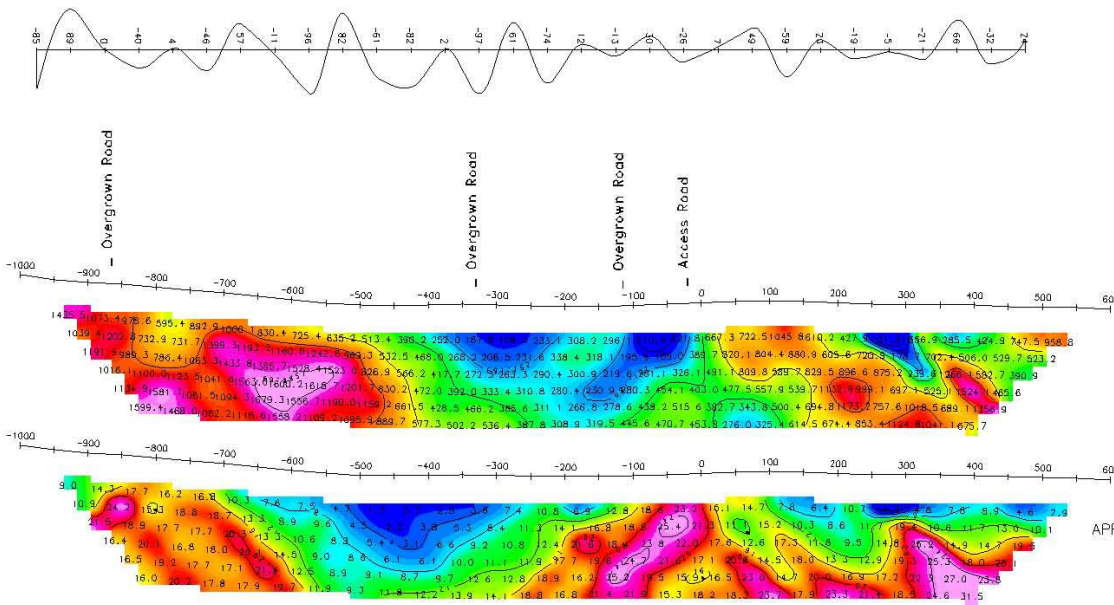
- Probable Pyrite in Graphitic Shale
- - - Possible Pyrite in Graphitic Shale
- Major Contours
- - - Intermediate Contours
- Roads

**Anomaly Boundary Type**

- Known
- Sumerging
- - - Possible
- ?-?- Uncertain
- IP Anomalies

<b>ALMO CAPITAL CORP.</b>		
<b>IP Inversion Results and Proposed Drill Hole Map</b>		
Title:		
<b>MOORE PROPERTY</b>		
NORTH BARRIERE LAKE AREA, KAMLOOPS M.D., B.C.		
Scale:	Surveyed by:	Figure:
As Shown	GEOTRONICS CONSULTING INC.	<b>6</b>
Date:	Drawing:	Rev:
Feb, 2007	TERRACAD LTD.	1.0

Survey Direction: 265 degrees East



SELF POTENTIAL (SP)

APPARENT RESISTIVITY

APPARENT CHARGEABILITY (IP)

**LEGEND**

**CONTOUR INTERVALS**

Resistivity: log base 10 ohm-metres  
 Chargeability: 4 milliseconds

**INSTRUMENTATION**

IP Receiver: BRGM PPS ELREC 8  
 IP Transmitter: BRGM VP 4000  
 IP Generator: S.S. Kistoff Honda

**IP SURVEY PARAMETERS**

Survey Mode: Time Domain  
 Array: Dipole-Dipole  
 Dipole Length: 30 metres (104-feet)  
 Dipole separation: n=1 to n=12  
 Delay Time: 240 milliseconds  
 Integration Time: 1800 milliseconds  
 Charge Cycle: 8 second square wave

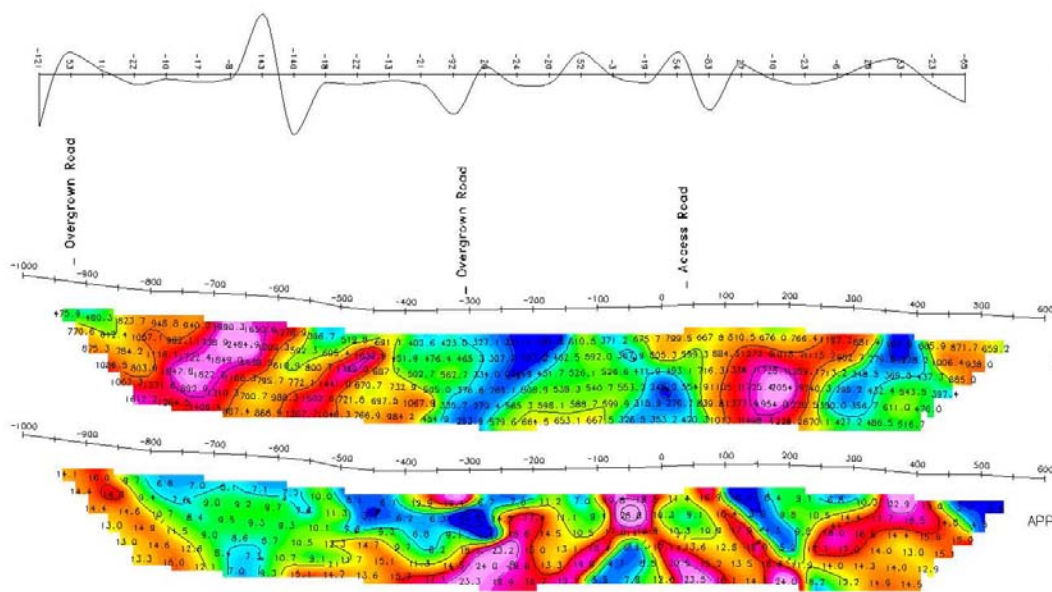


**GEOTRONICS CONSULTING INC**  
**SURREY BC.**

Survey date: July 2006

GEOTRONICS CONSULTING INC			
ALMO CAPITAL CORP			
MOORE PROPERTY			
NORTH BARRIERE LAKE AREA, KAMLOOPS MD.			
<b>IP &amp; RESISTIVITY PSEUDOSECTION</b>			
WITH SELF POTENTIAL PROFILE			
<b>LINE 100S</b>			
Drawn by:	Job No.:	NTS:	Date:
BGM	06-08	82M/05	July 06

Survey Direction: 265 degrees East



**LEGEND**

**CONTOUR INTERVALS**

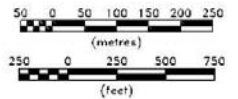
Resistivity: 10 ohm-metres  
 Chargeability: 4 milliseconds

**INSTRUMENTATION**

IP Receiver: BRUNNERS EUREC 6  
 IP Transmitter: BRUNNERS VP-4000  
 IP Generator: 8 D WetCell Mains

**IP SURVEY PARAMETERS**

Survey Mode: Time Domain  
 Array: Dipole-Dipole  
 Dipole Length: 80 metres (164 feet)  
 Dipole separation:  $n=1$  to  $n=12$   
 Delay Time: 240 milliseconds  
 Integration Time: 1600 milliseconds  
 Charge Cycle: 8 second square wave



**GEOTRONICS CONSULTING INC**  
 SURREY BC.

Survey date: July 2006

GEOTRONICS CONSULTING INC				
ALMO CAPITAL CORP				
MOORE PROPERTY				
NORTH BARRIER LAKE AREA, KAMLOOPS BC, BC				
<b>IP &amp; RESISTIVITY PSEUDOSECTIONS</b>				
WITH SELF POTENTIAL PROFILE				
<b>LINE 100N</b>				
Drawn by:	Job No:	NTS:	Date:	Fig No:
DCM	06-08	82M/05	July 06	GP-2

Survey Direction: 265 degrees East



**LEGEND**

**CONTOUR INTERVALS**

Resistivity: log from 10 ohm-metres  
 Chargeability: 1 milliseconds

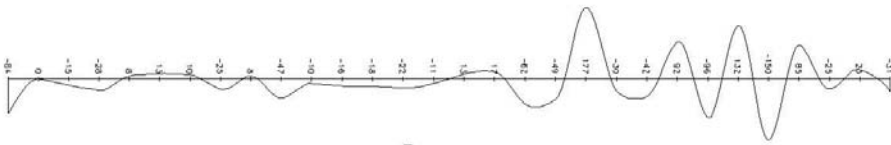
**INSTRUMENTATION**

IP Receiver: BRUN INE ELITE 6  
 IP Transmitter: BRUN VP 4000  
 IP Generator: 0.5 kHz Honda

**IP SURVEY PARAMETERS**

Survey Mode: Time Domain  
 Array: Dipole-Dipole  
 Dipole Length: 50 meters (164 feet)  
 Dipole separation: 1m/1.5m=12  
 Delay Time: 240 milliseconds  
 Integration Time: 1800 milliseconds  
 Charge Cycle: 8 second square wave

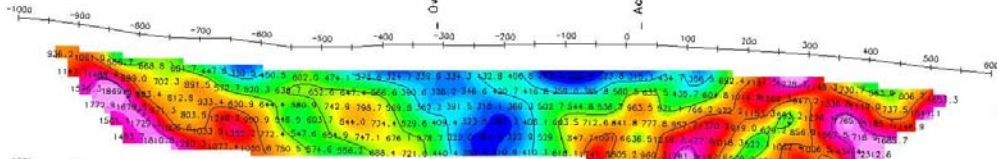
SELF POTENTIAL (SP)



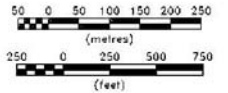
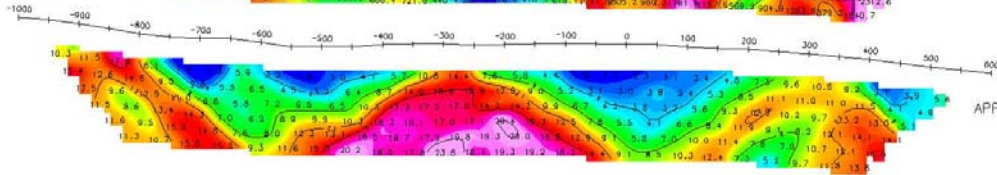
Overgrown Road

Access Road

APPARENT RESISTIVITY



APPARENT CHARGEABILITY (IP)

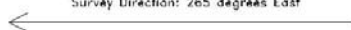


**GEOTRONICS CONSULTING INC**  
 SURREY BC.

Survey date: July 2006

GEOTRONICS CONSULTING INC			
ALMO CAPITAL CORP			
MOORE PROPERTY			
NORTH BARRIÈRE LAKE AREA, KAMLOOPS B.C.			
<b>IP &amp; RESISTIVITY PSEUDOSECTIONS</b>			
WITH SELF POTENTIAL PROFILE			
<b>LINE 300N</b>			
Drawn by: DOM	Job No: 06-08	NTS: 82M/05	Date: July 06
			Fig No: QP-3

Survey Direction: 265 degrees East



**LEGEND**

**CONTOUR INTERVALS**  
 Resistivity: log base 10 ohm-metres  
 Chargeability: 4 milliseconds

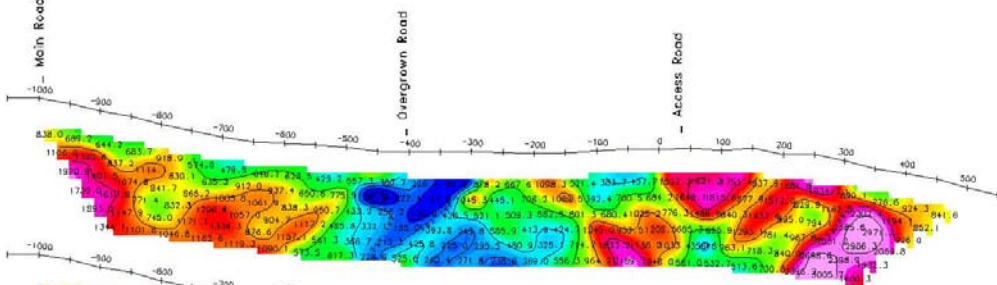
**INSTRUMENTATION**  
 IP Receiver: BRUNNERS ELRUC 6  
 IP Transmitter: BRUNN VP 4000  
 IP Generator: 8 2 Watt Wards

**IP SURVEY PARAMETERS**  
 Survey Mode: Time Domain  
 Array: Dipole-Dipole  
 Dipole Length: 60 metres (194 feet)  
 Dipole Separators: 1m : 1m : 12  
 Delay Time: 540 milliseconds  
 Integration Time: 1000 milliseconds  
 Charge Cycle: 8 second square wave

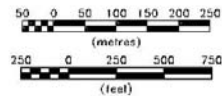
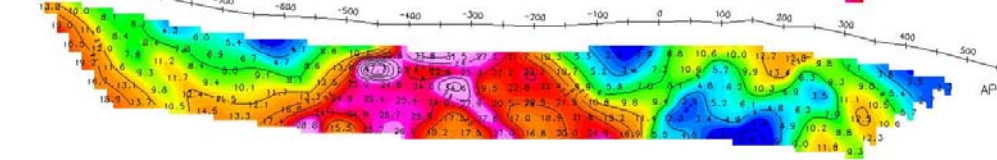
SELF POTENTIAL (SP)



APPARENT RESISTIVITY



APPARENT CHARGEABILITY (IP)



**GEOTRONICS CONSULTING INC**  
 SURREY BC.

Survey date: July 2006

GEOTRONICS CONSULTING INC				
ALMO CAPITAL CORP				
MOORE PROPERTY				
NORTH BARRIE LAKE AREA, KAMLOOPS B.C.				
<b>IP &amp; RESISTIVITY PSEUDOSECTIONS</b>				
WITH SELF POTENTIAL PROFILE				
<b>LINE 500N</b>				
Drawn by:	Job No.	NTS.	Date:	Fig No.
DCM	06-08	82M/05	July 06	07-4

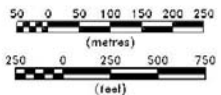
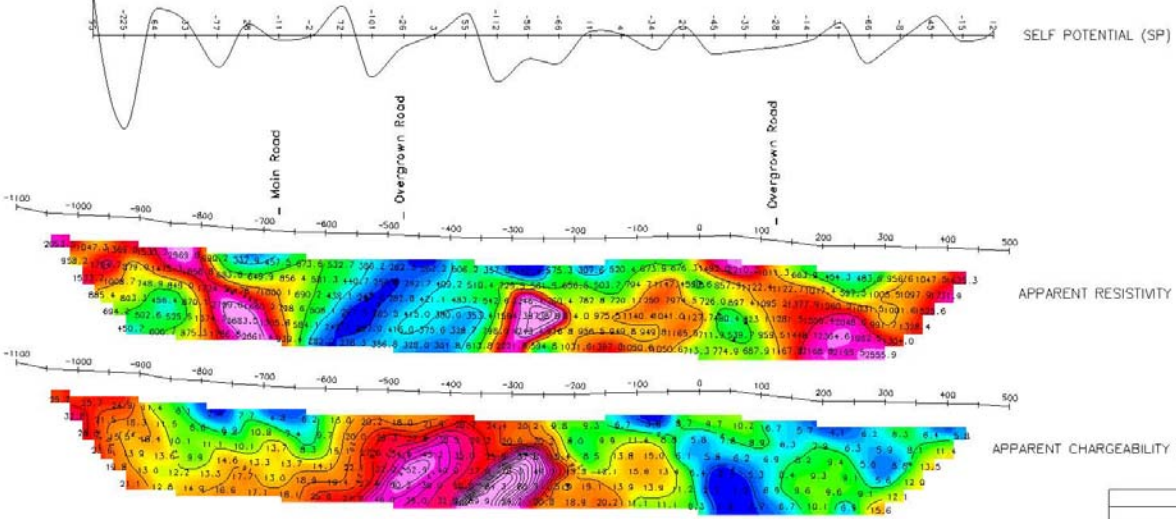
Line Direction: 085 degrees East

**LEGEND**

**CONTOUR INTERVALS**  
 Resistivity: by base 10 ohm-metres  
 Chargeability: 1 millivolt

**INSTRUMENTATION**  
 IP Receiver: IRON RES ELREC 8  
 IP Transmitter: IRON VP 4000  
 IP Generator: 8.5 kHz/1kV

**IP SURVEY PARAMETERS**  
 Survey Mode: Time Domain  
 Area: Dipole-Dipole  
 Dipole Length: 80 metres (184 feet)  
 Dipole separation: m=1 to n=12  
 Delay Time: 240 milliseconds  
 Integration Time: 1400 milliseconds  
 Charge Cycle: 8 second square wave



**GEOTRONICS CONSULTING INC**  
 SURREY BC.

Survey date: July 2006

GEOTRONICS CONSULTING INC			
ALMO CAPITAL CORP			
MOORE PROPERTY			
NORTH BARRIERE LAKE AREA, KAMLOOPS, BC			
<b>IP &amp; RESISTIVITY PSEUDOSECTIONS</b>			
WITH SELF POTENTIAL PROFILE			
<b>LINE 700N</b>			
Drawn by:	Job No:	NTS:	Date:
DGM	06-08	B2M/05	July 06
			Fig No:
			GP-5

Line Direction: 085 degrees East

**LEGEND**

**CONTOUR INTERVALS**

Resistivity: log base 10 ohm-metres  
 Chargeability: 4 milliseconds

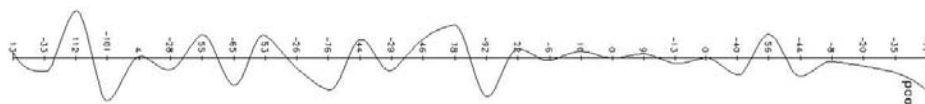
**INSTRUMENTATION**

IP Receiver: SHIMADZU DJR30 6  
 IP Transmitter: SHIMADZU 4000  
 IP Generator: S.S. Model Heads

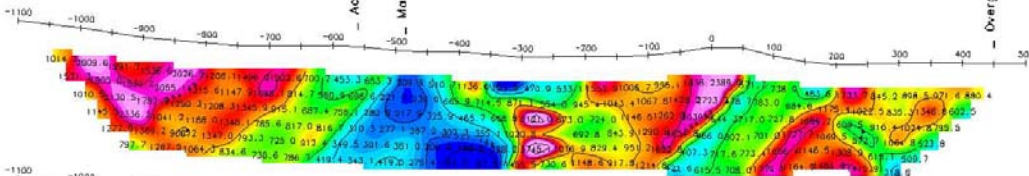
**IP SURVEY PARAMETERS**

Survey Mode: Time Domain  
 Array: Dipole-Dipole  
 Dipole Length: 50 metres (164 feet)  
 Dipole separation:  $rn=1$  to  $rn=12$   
 Delay Time: 240 milliseconds  
 Integration Time: 1800 milliseconds  
 Charge Cycle: 8 second square wave

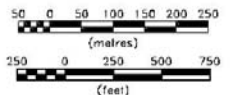
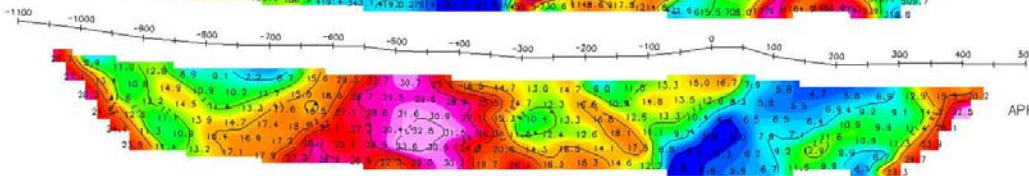
SELF POTENTIAL (SP)



APPARENT RESISTIVITY



APPARENT CHARGEABILITY (IP)

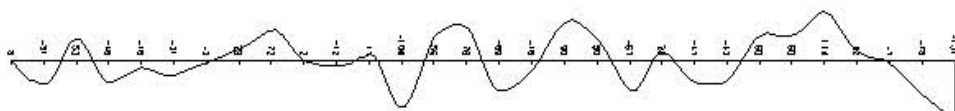


**GEOTRONICS CONSULTING INC**  
 SURREY BC.

Survey date: July 2006

GEOTRONICS CONSULTING INC				
ALMO CAPITAL CORP				
MOORE PROPERTY				
NORTH BARRIER LAKE AREA, KAMLOOPS, B.C.				
<b>IP &amp; RESISTIVITY PSEUDOSECTIONS</b>				
WITH SELF POTENTIAL PROFILE				
<b>LINE 900N</b>				
Drawn by:	Job No:	NTS:	Date:	Fig No:
DGM	06-08	82M/05	July 06	GP-6

Line Direction: 085 degrees East



SELF POTENTIAL (SP)

**LEGEND**

**CONTOUR INTERVALS**

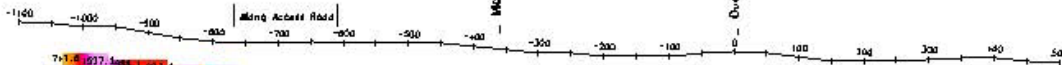
Resistivity: 100 mV/100 m (1000) + 1000000

**INSTRUMENTATION**

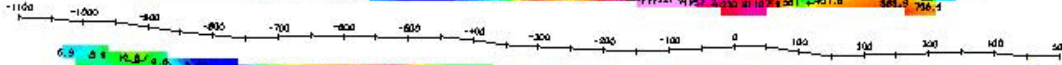
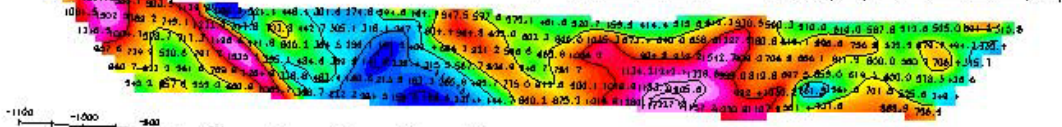
IP Receiver: 8000 800 0000 4  
 IP Transmitter: 8000 400 444  
 IP Detector: 4 1 1000 0000

**IP SURVEY PARAMETERS**

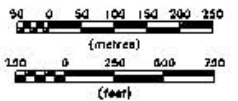
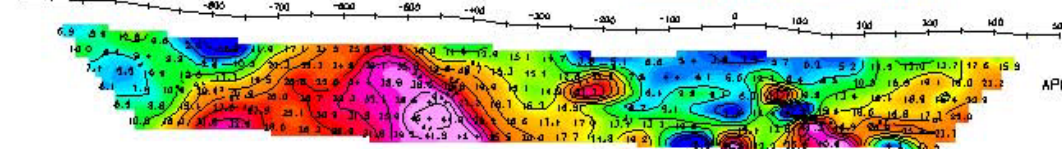
Survey Area: 1000 0000  
 Area: 10000000  
 Area Range: 50 mV (100 feet)  
 Area Expansion: n=1 to n=2  
 Data File: 100 0000000  
 Integration Time: 1000 milliseconds  
 Charge Cycle: 5 second square wave



APPARENT RESISTIVITY



APPARENT CHARGEABILITY (IP)



GEOTRONICS CONSULTING INC  
 SURREY, BC.

Survey date: July 2006

GEOTRONICS CONSULTING INC.				
ALMO CAPITAL CORP				
MOORE PROPERTY				
NORTH BARRIE LAKE AREA, KAMLOOPS, BC				
<b>IP &amp; RESISTIVITY PSEUDOSECTIONS</b>				
<b>WITH SELF POTENTIAL PROFILE</b>				
<b>LINE 1100N</b>				
Drawn by:	Job No:	NIS:	Date:	Fig. No:
DGN	06-06	8/28/05	July 06	GP-7

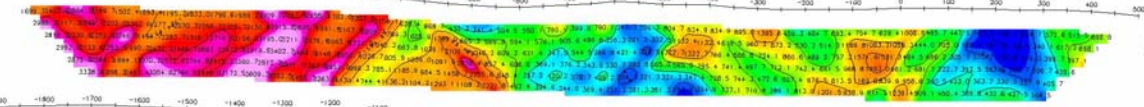
Survey Direction: 265 degrees East



SELF POTENTIAL (SP)

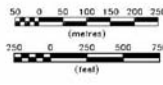



APPARENT RESISTIVITY



APPARENT CHARGEABILITY (IP)

- LEGEND**
- CONTOUR INTERVALS**  
 Resistivity: 10 ohm-meters  
 Chargeability: 1 millivolt
- INSTRUMENTATION**  
 IP Receiver: BETA 100 ELECT II  
 IP Transmitter: BETA VP 4000  
 IP Generator: G.S. 6042 Model
- IP SURVEY PARAMETERS**  
 Survey Mode: Time Domain  
 Area: Open-Open  
 Spacing: 50 meters (1/4 cell)  
 Splice separation: 1m to 1/2  
 Delay Time: 100 milliseconds  
 Integration Time: 100 milliseconds  
 Charge Cycle: 8 second square wave



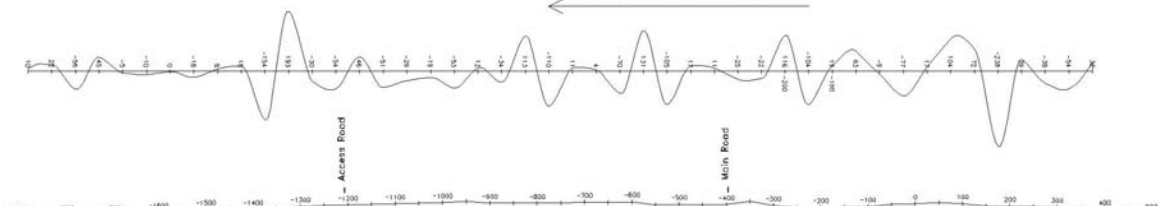
 **GEOTRONICS CONSULTING INC**  
SURREY BC.

Survey date: July 2006

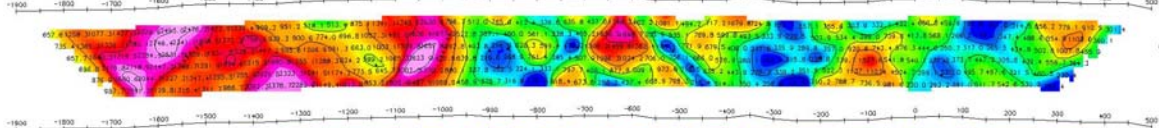
GEOTRONICS CONSULTING INC			
ALMO CAPITAL CORP			
MOORE PROPERTY			
NORTH BARRIE LINE (M.B.) VANCOUVER, BC			
<b>IP &amp; RESISTIVITY PSEUDOSECTIONS</b>			
WITH SELF POTENTIAL PROFILE			
<b>LINE 1300N</b>			
Drawn by:	Job No:	NTS:	Fig No:
SDM	06-08	8206/05	027-B
Date:	July 06		



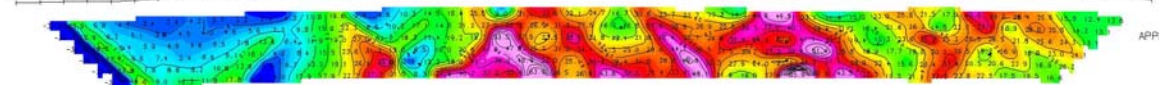
Survey Direction: 265 degrees East



SELF POTENTIAL (SP)



APPARENT RESISTIVITY



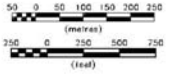
APPARENT CHARGEABILITY (IP)


**LEGEND**

**CONTOUR INTERVALS**  
 Resistivity: 10 millivolts  
 Chargeability: 4 millivolts

**INSTRUMENTATION**  
 IP Receiver: 8900 RS 6300 #  
 IP Transmitter: 8900 IP 4000  
 IP Generator: 8.2 Volt Hand

**IP SURVEY PARAMETERS**  
 Survey Mode: True Double  
 Array: Dipole-Dipole  
 Dipole Length: 60 meters (194 feet)  
 Dipole separation: 1m to 1m:18  
 Delay Time: 200 milliseconds  
 Integration Time: 1000 milliseconds  
 Charge Cycle: 8 second square wave

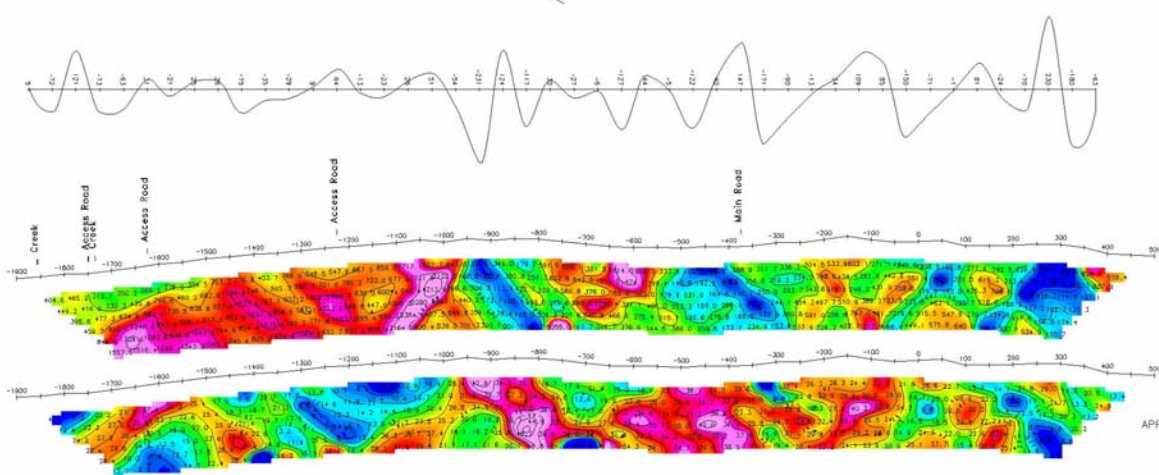


 **GEOTRONICS CONSULTING INC**  
 SURREY, BC.

Survey date: July 2006

GEOTRONICS CONSULTING INC				
ALMO CAPITAL CORP				
MOORE PROPERTY				
NORTH BARRIER LAKE AREA, KAMLOOPS, BC				
<b>IP &amp; RESISTIVITY PSEUDOSECTIONS</b>				
<b>WITH SELF POTENTIAL PROFILE</b>				
<b>LINE 1500N</b>				
Drawn By:	Job No:	NTS:	Date:	Fig No:
DCM	06-05	82%/05	July 06	0P-10

Survey Direction: 265 degrees East

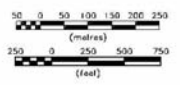


**LEGEND**

**CONTOUR INTERVALS**  
 Contour Interval: 4 mV/m  
 Resolution: 1 mV/m

**INSTRUMENTATION**  
 IP Receiver: BSM IP 6000  
 IP Transmitter: BSM IP 6000  
 IP Generator: 4.5 kHz tone

**IP SURVEY PARAMETERS**  
 Survey Mode: Time Domain  
 Array: Dipole-Dipole  
 Spacing Length: 50 meters (164 feet)  
 Dipole separation: 1m to 1m (1)  
 Delay Time: 340 milliseconds  
 Integration Time: 1000 milliseconds  
 Charge Cycle: 8 second square wave



**Geotronics**  
 GEOTRONICS CONSULTING INC  
 SURREY BC.

Survey date: July 2006

GEOTRONICS CONSULTING INC			
ALMO CAPITAL CORP			
MOORE PROPERTY			
NORTH BARRIER LAKE AREA, KAMLOOPS, BC			
<b>IP &amp; RESISTIVITY PSEUDOSECTIONS</b>			
WITH SELF POTENTIAL PROFILE			
<b>LINE 1700N</b>			
Drawn by:	Job No:	N/S:	Date:
DCM	06-05	82M/05	July 06
			Fig No:
			SP-11

Survey Direction: 269 Degree East



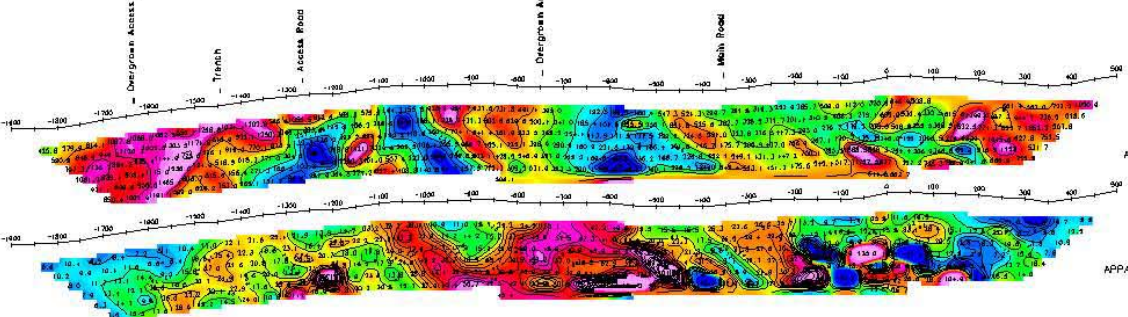
SELF POTENTIAL (SP)

**LEGEND**

**CONTOUR INTERVALS**  
 Resistivity: 100 ohm m (200-ohm/m)  
 Chargeability: 0.05 ohm m

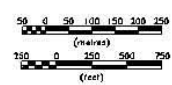
**INSTRUMENTATION**  
 IP Receiver: 050A (DC/AC) &  
 IP Transmitter: 050A (IP 1000)  
 IP Generator: 6.3 (1000 Hz)

**IP SURVEY PARAMETERS**  
 Survey Name: Test Station  
 Area: 50m x 50m  
 Dipole Length: 50 meters (150' 000)  
 Dipole Separation: 100 m ± 1%  
 Data Time: 300 milliseconds  
 Integration Time: 1000 milliseconds  
 Filter Cycle: 0.5 seconds



APPARENT RESISTIVITY

APPARENT CHARGEABILITY (IP)

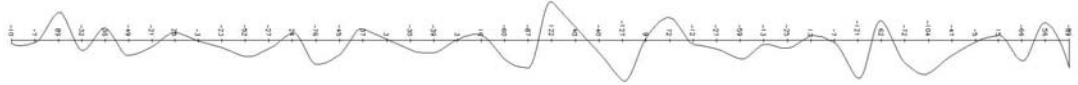


 GEOTRONICS CONSULTING INC.  
SURREY, BC.

Survey date July 2006

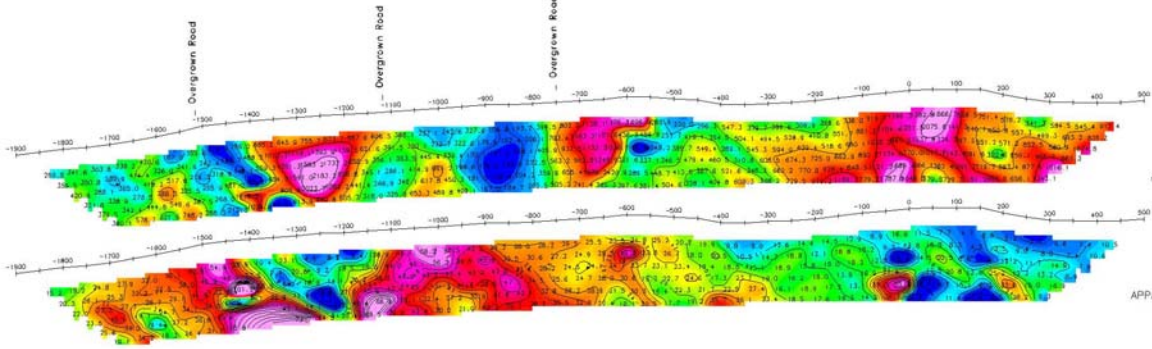
GEOTRONICS CONSULTING INC.			
ALMO CAPITAL CORP.			
MOORE PROPERTY			
NORTH BRIDGE LANE AREA, LAMBTON'S BLDG., BC			
<b>IP &amp; RESISTIVITY SUBSECTIONS</b>			
<b>WITH SELF POTENTIAL PROFILE</b>			
<b>LINE 1900N</b>			
Drawn by:	Job No:	NTS	Date:
024	00-08	8/26/05	July 06
			Fig. No:
			SP-11

Survey Direction: 265 degrees East



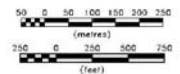
SELF POTENTIAL (SP)


- LEGEND**
- CONTOUR INTERVALS**  
 Resistivity: 50 mhos/m @ 100 mV  
 Chargeability: 0.1 mhos/m
- INSTRUMENTATION**  
 IP Number: 0004 000 0000 0  
 IP Transmitter: 0004 IP 4000  
 IP Receiver: 0.5 mV/m mode
- IP SURVEY PARAMETERS**  
 Survey Mode: Time Domain  
 Array: Dipole-Dipole  
 Dipole Length: 30 meters (100 feet)  
 Dipole separation: 1m to 1m+12  
 Duty Time: 240 milliseconds  
 Integration Time: 1000 milliseconds  
 Charge Cycle: 8 second square wave



APPARENT RESISTIVITY

APPARENT CHARGEABILITY (IP)



 **GEOTRONICS CONSULTING INC**  
 SURREY BC.

Survey date: July 2006

GEOTRONICS CONSULTING INC			
ALMO CAPITAL CORP			
MOORE PROPERTY			
NORTH BARRIE LAKE AREA, KAMLOOPS, BC			
<b>IP &amp; RESISTIVITY PSEUDOSECTIONS</b>			
<i>WITH SELF POTENTIAL PROFILE</i>			
<b>LINE 2100N</b>			
Drawn By:	Job No.:	Rev.:	Date:
DCM	06-08	02M/05	July 06
			Fig No.:
			SP-13

Line Direction: 040 degrees East

**LEGEND**

**CONTOUR INTERVALS**

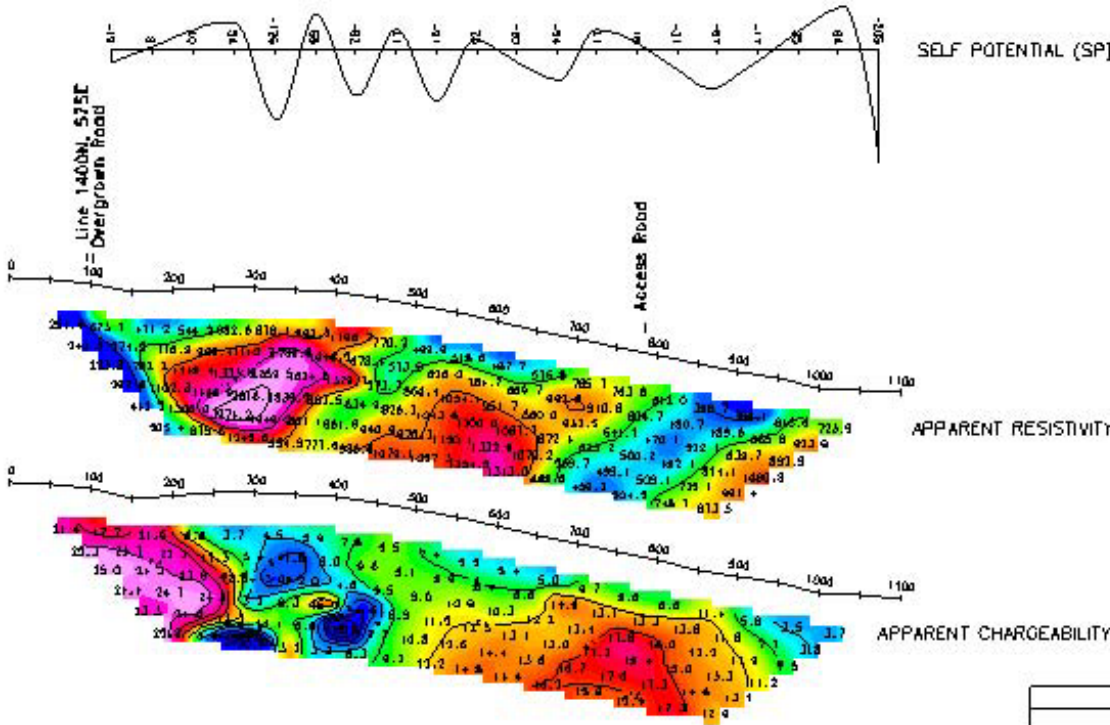
Resistivity: log scale 10 increments  
 Chargeability: + to increase

**INSTRUMENTATION**

IP Receiver: 8800 and 2000 2  
 IP Transmitter: 8800 and 1000  
 IP Generator: 0.5 meter noise

**IP SURVEY PARAMETERS**

Survey Mode: Time Domain  
 Style: Dipole-Dipole  
 Dipole Length: 50 meters (164 feet)  
 Dipole Separation: 1:1 to 1:13  
 Data Type: 340 measurements  
 Integration Time: 1000 milliseconds  
 Charge Cycle: 2 seconds square wave

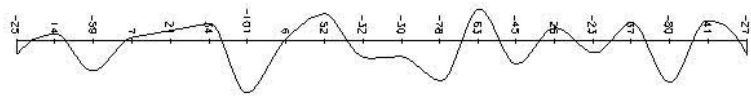


GEOTRONICS CONSULTING INC  
 SURREY, BC.

Survey date: July 2008

GEOTRONICS CONSULTING INC			
ALMO CAPITAL CORP			
MOORE PROPERTY			
NORTH BARRIER LAKE AREA, KANLOOPS MO., BC			
<b>IP &amp; RESISTIVITY PSEUDOSECTIONS</b>			
<b>WITH SELF POTENTIAL PROFILE</b>			
<b>LINE 1E</b>			
Drawn by: DCM	Job No: 06-C6	NTS: 82N/05	Date: July 06
			Fig. No.: CP-15

Survey Direction: 240 degrees East



SELF POTENTIAL (SP)

**LEGEND**

**CONTOUR INTERVALS**

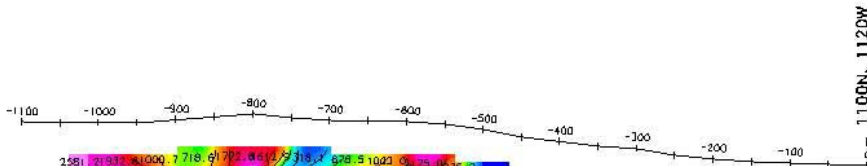
Resistivity: log base 10 ohm-metres  
 Chargeability: 4 milliseconds

**INSTRUMENTATION**

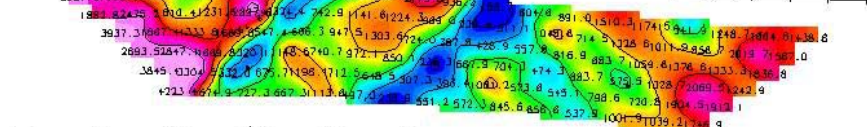
IP Receiver: BRGM IRIS ELREC 8  
 IP Transmitter: BRGM WP 4000  
 IP Generator: 6.5 kHz Honda

**IP SURVEY PARAMETERS**

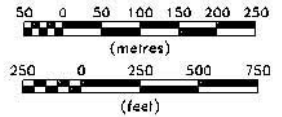
Survey Mode: Time Domain  
 Array: Dipole-Dipole  
 Dipole Length: 50 meters (164 feet)  
 Dipole separation: n=1 to n=12  
 Data Time: 240 milliseconds  
 Integration Time: 1600 milliseconds  
 Charge Cycle: 8 second square wave



APPARENT RESISTIVITY



APPARENT CHARGEABILITY (IP)



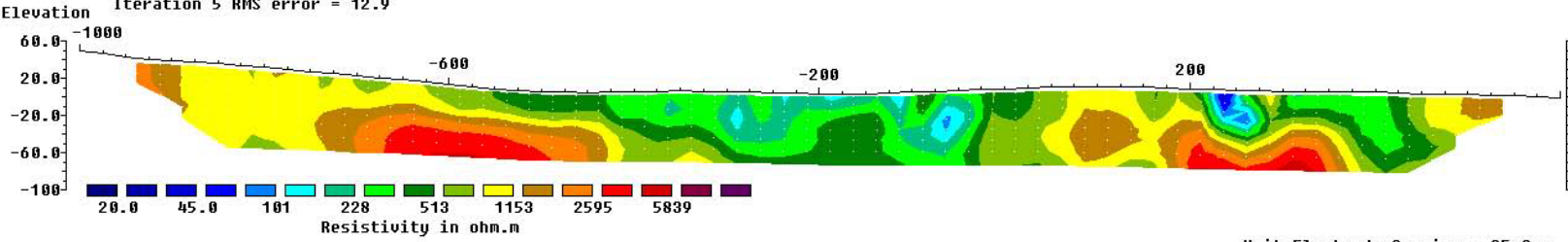
**GEOTRONICS CONSULTING INC**  
 SURREY BC.

Survey date July 2006

GEOTRONICS CONSULTING INC				
ALMO CAPITAL CORP				
MOORE PROPERTY				
NORTH BARRIERE LAKE AREA, KAMLOOPS MD, BC				
<b>IP &amp; RESISTIVITY PSEUDOSECTIONS</b>				
<b>WITH SELF POTENTIAL PROFILE</b>				
<b>LINE 1 W</b>				
Drawn by: DGM	Job No: 06-08	NTS: 82M/05	Date: July 06	Fig No: GP-14

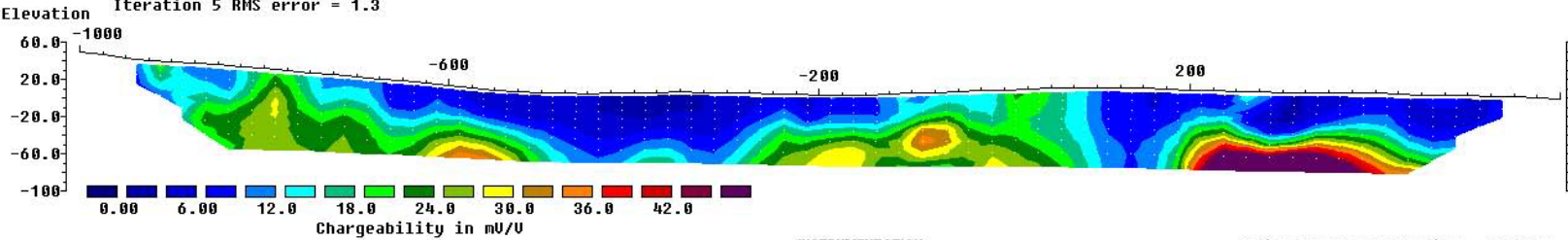
L100S.bin

Model resistivity with topography  
Iteration 5 RMS error = 12.9



Unit Electrode Spacing = 25.0 m.

Model IP with topography  
Iteration 5 RMS error = 1.3



Unit Electrode Spacing = 25.0 m.

Horizontal scale is 18.72 pixels per unit spacing  
Vertical exaggeration in model section display = 1.00  
First electrode is located at -1000.0 m.  
Last electrode is located at 600.0 m.

**INSTRUMENTATION**

IP Receiver BRGM IRIS ELREC 6  
IP Transmitter BRGM VIP 4000  
IP Generator 6.5 kWatt Honda

**IP SURVEY PARAMETERS**

Survey mode Time Domain  
Array Dipole-Dipole  
Dipole Length 50 meters  
Dipole Separation n=1 to n=12  
Delay Time 240 ms  
Integration Time 1800 ms  
Charge Cycle 8 second square wave  
Survey Date July 2006

GEOTRONICS CONSULTING INC.

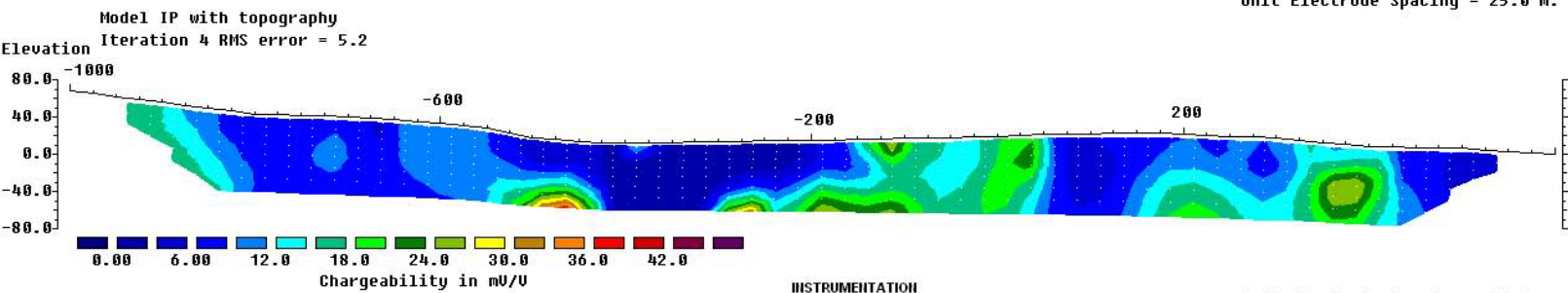
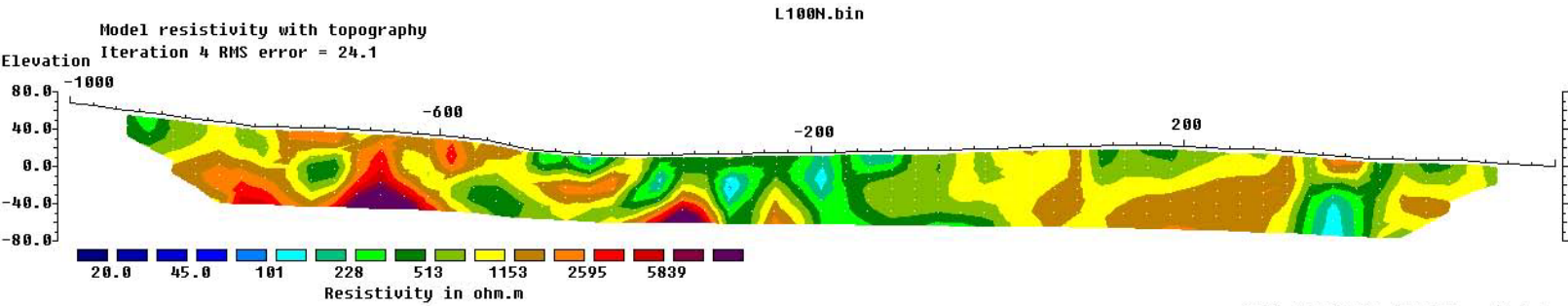
ALMO CAPITAL CORP

**THE MOORE PROPERTY**

NORTH BARRIERE LAKE AREA, KAMLOOPS M.D., B.C.

*IP and RESISTIVITY SURVEYS*  
GEOTOMO INVERSION  
**LINE 100S**

DONE BY:	JOB NO.:	NTS:	DATE:	FIG NO.:
DGM	06-08	82M/05	SEPT 06	GP-16



Horizontal scale is 18.73 pixels per unit spacing  
Vertical exaggeration in model section display = 1.00  
First electrode is located at -1000.0 m.  
Last electrode is located at 600.0 m.

**INSTRUMENTATION**

IP Receiver BRGM IRIS ELREC 6  
IP Transmitter BRGM VIP 4000  
IP Generator 6.5 kWatt Honda

**IP SURVEY PARAMETERS**

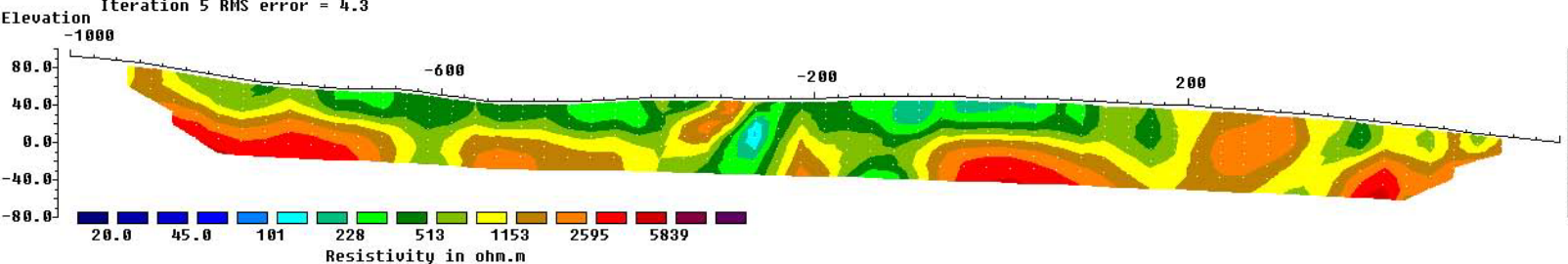
Survey mode Time Domain  
Array Dipole-Dipole  
Dipole Length 50 meters  
Dipole Separation n=1 to n=12  
Delay Time 240 ms  
Integration Time 1800 ms  
Charge Cycle 8 second square wave  
Survey Date July 2006

Unit Electrode Spacing = 25.0 m.

GEOTRONICS CONSULTING INC.				
ALMO CAPITAL CORP				
<b>THE MOORE PROPERTY</b>				
NORTH BARRIER LAKE AREA, KAMLOOPS M.D., B.C.				
<i>IP and RESISTIVITY SURVEYS</i>				
<i>GEOTOMO INVERSION</i>				
<b>LINE 100 N</b>				
DONE BY:	JOB NO.:	NTS:	DATE:	FIG NO.:
DGM	06-08	82M/05	SEPT 06	GP-17

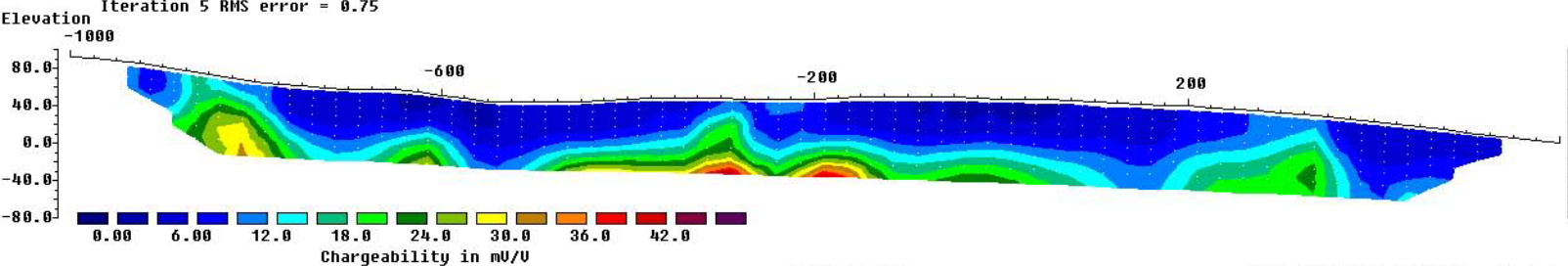
L300N.bin

Model resistivity with topography  
Iteration 5 RMS error = 4.3



Unit Electrode Spacing = 25.0 m.

Model IP with topography  
Iteration 5 RMS error = 0.75



Unit Electrode Spacing = 25.0 m.

Horizontal scale is 18.73 pixels per unit spacing  
Vertical exaggeration in model section display = 1.00  
First electrode is located at -1000.0 m.  
Last electrode is located at 600.0 m.

**INSTRUMENTATION**

IP Receiver BRGM IRIS ELREC 6  
IP Transmitter BRGM VIP 4000  
IP Generator 6.5 kWatt Honda

**IP SURVEY PARAMETERS**

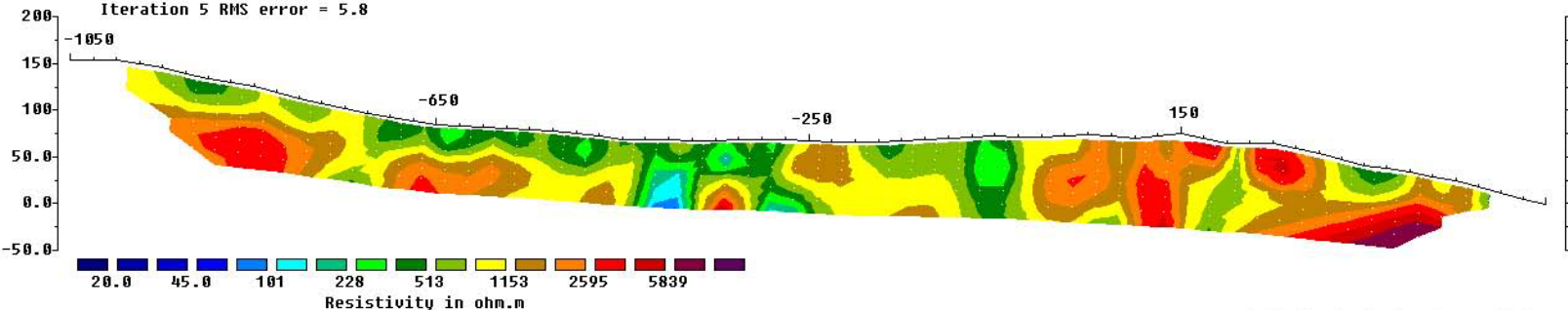
Survey mode Time Domain  
Array Dipole-Dipole  
Dipole Length 50 meters  
Dipole Separation n=1 to n=12  
Delay Time 240 ms  
Integration Time 1800 ms  
Charge Cycle 8 second square wave  
Survey Date July 2006

Unit Electrode Spacing = 25.0 m.

GEOTRONICS CONSULTING INC.				
ALMO CAPITAL CORP				
<b>THE MOORE PROPERTY</b>				
NORTH BARRIER LAKE AREA, KAMLOOPS M.D., B.C.				
<i>IP and RESISTIVITY SURVEYS</i>				
<i>GEOTOMO INVERSION</i>				
<i>LINE 300N</i>				
DONE BY:	JOB NO.:	NTS:	DATE:	FIG NO.:
DGM	06-08	82M/05	SEPT 06	GP-18

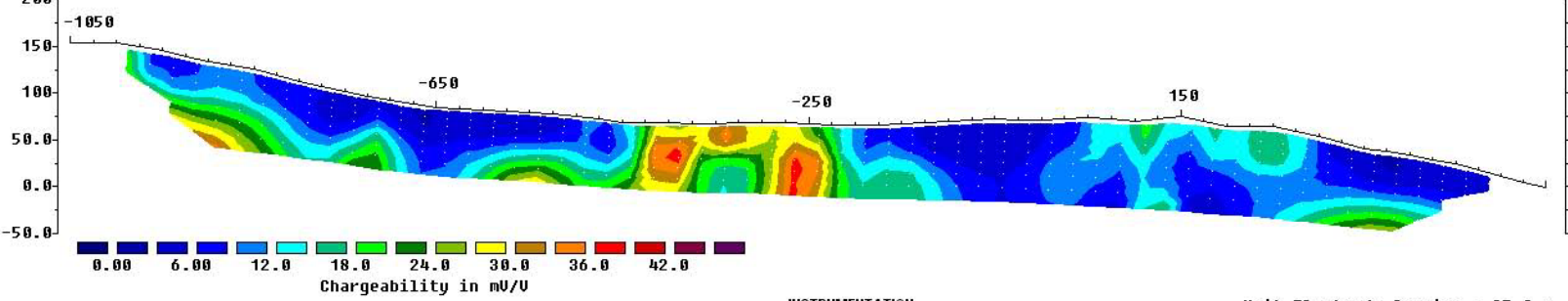
Elevation Model resistivity with topography  
Iteration 5 RMS error = 5.8

L500N.bin



Unit Electrode Spacing = 25.0 m.

Elevation Model IP with topography  
Iteration 5 RMS error = 1.2



Unit Electrode Spacing = 25.0 m.

Horizontal scale is 18.73 pixels per unit spacing  
Vertical exaggeration in model section display = 1.00  
First electrode is located at -1050.0 m.  
Last electrode is located at 550.0 m.

**INSTRUMENTATION**  
IP Receiver BRGM IRIS ELREC 6  
IP Transmitter BRGM VIP 4000  
IP Generator 6.5 kWatt Honda

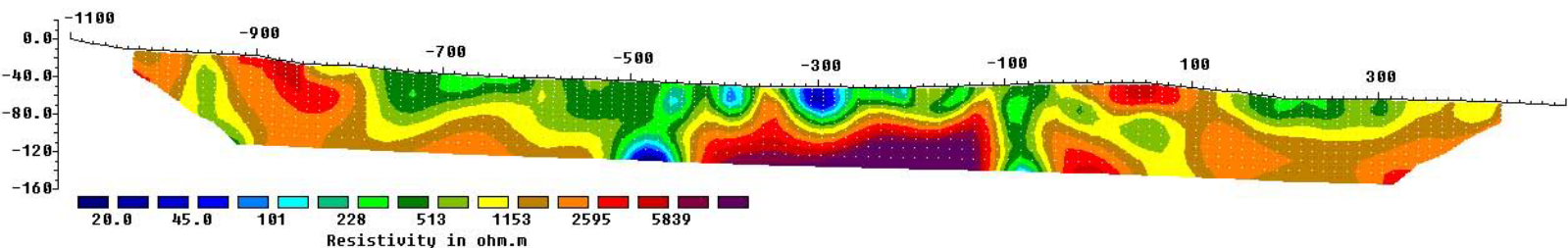
**IP SURVEY PARAMETERS**  
Survey mode Time Domain  
Array Dipole-Dipole  
Dipole Length 50 meters  
Dipole Separation n=1 to n=12  
Delay Time 240 ms  
Integration Time 1800 ms  
Charge Cycle 8 second square wave  
Survey Date July 2006

GEOTRONICS CONSULTING INC.				
ALMO CAPITAL CORP				
<b>THE MOORE PROPERTY</b>				
NORTH BARRIER LAKE AREA, KAMLOOPS M.D., B.C.				
<i>IP and RESISTIVITY SURVEYS</i>				
<i>GEOTOMO INVERSION</i>				
<b>LINE 500N</b>				
DONE BY:	JOB NO.:	NTS:	DATE:	FIG NO.:
DGM	06-08	82M05	SEPT 06	GP-19

L700N.bin

Model resistivity with topography

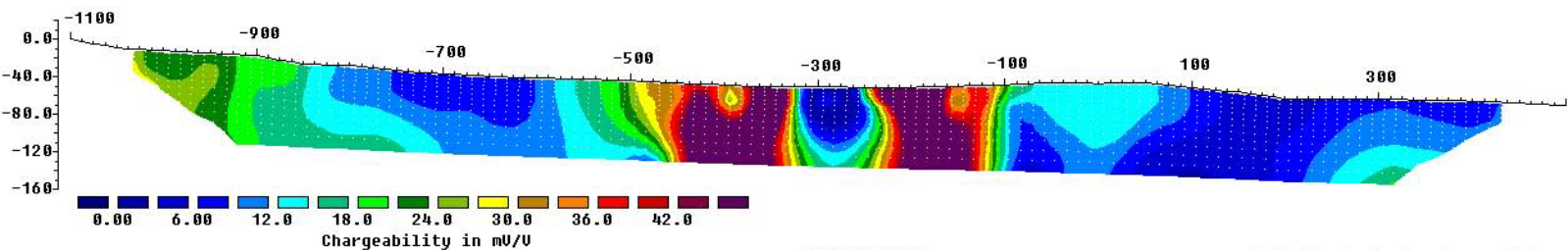
Elevation Iteration 5 RMS error = 17.0



Unit Electrode Spacing = 12.5 m.

Model IP with topography

Elevation Iteration 5 RMS error = 16.8



Horizontal scale is 9.37 pixels per unit spacing  
 Vertical exaggeration in model section display = 1.00  
 First electrode is located at -1100.0 m.  
 Last electrode is located at 500.0 m.

INSTRUMENTATION

IP Receiver BRGM IRIS ELREC 6  
 IP Transmitter BRGM VIP 4000  
 IP Generator 6.5 kWatt Honda

IP SURVEY PARAMETERS

Survey mode Time Domain  
 Array Dipole-Dipole  
 Dipole Length 50 meters  
 Dipole Separation n=1 to n=12  
 Delay Time 240 ms  
 Integration Time 1800 ms  
 Charge Cycle 8 second square wave  
 Survey Date July 2006

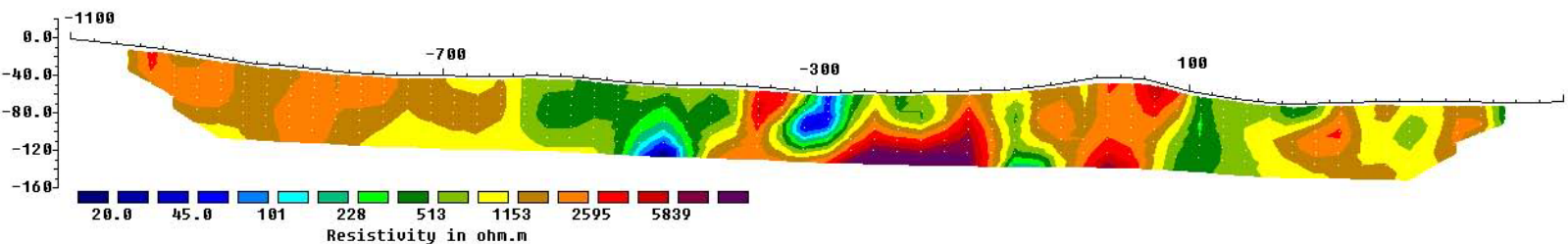
Unit Electrode Spacing = 12.5 m.

GEOTRONICS CONSULTING INC.				
ALMO CAPITAL CORP				
<b>THE MOORE PROPERTY</b>				
NORTH BARRIERE LAKE AREA, KAMLOOPS M.D., B.C.				
<i>IP and RESISTIVITY SURVEYS</i>				
<i>GEOTOMO INVERSION</i>				
<i>LINE 700N</i>				
DONE BY:	JOB NO.:	NTS:	DATE:	FIG NO.:
DGM	06-08	82M/05	SEPT 06	GP-20

L900N.bin

Model resistivity with topography

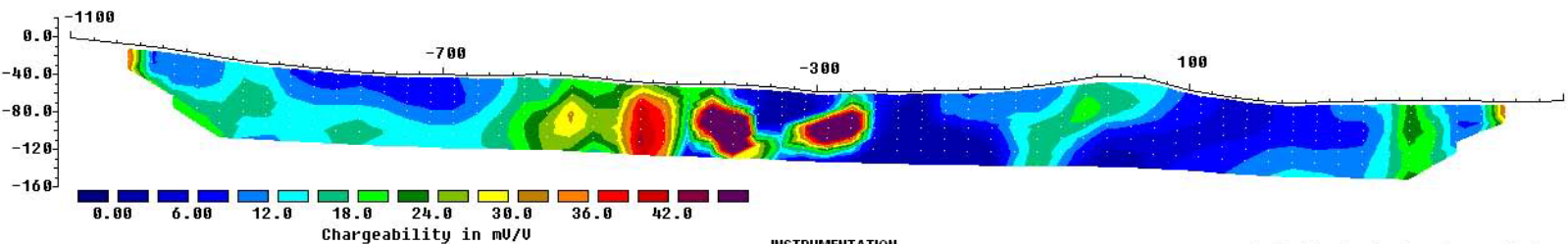
Elevation Iteration 5 RMS error = 23.0



Unit Electrode Spacing = 25.0 m.

Model IP with topography

Elevation Iteration 5 RMS error = 8.5



Unit Electrode Spacing = 25.0 m.

Horizontal scale is 18.73 pixels per unit spacing  
 Vertical exaggeration in model section display = 1.00  
 First electrode is located at -1100.0 m.  
 Last electrode is located at 500.0 m.

**INSTRUMENTATION**

IP Receiver BRGM IRIS ELREC 6  
 IP Transmitter BRGM VIP 4000  
 IP Generator 6.5 kWatt Honda

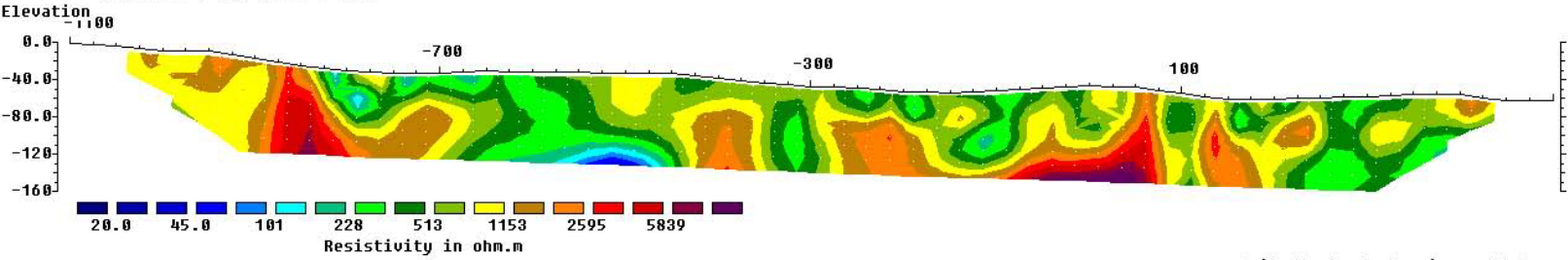
**IP SURVEY PARAMETERS**

Survey mode Time Domain  
 Array Dipole-Dipole  
 Dipole Length 50 meters  
 Dipole Separation n=1 to n=12  
 Delay Time 240 ms  
 Integration Time 1800 ms  
 Charge Cycle 8 second square wave  
 Survey Date July 2006

GEOPHYSICS CONSULTING INC.				
ALMO CAPITAL CORP				
<b>THE MOORE PROPERTY</b>				
NORTH BARRIER LAKE AREA, KAMLOOPS M.D., B.C.				
<i>IP and RESISTIVITY SURVEYS</i>				
<i>GEOTOMO INVERSION</i>				
<b>LINE 900N</b>				
DONE BY:	JOB NO.:	NTS:	DATE:	FIG NO.:
DGM	06-08	82M/05	SEPT 06	GP-21

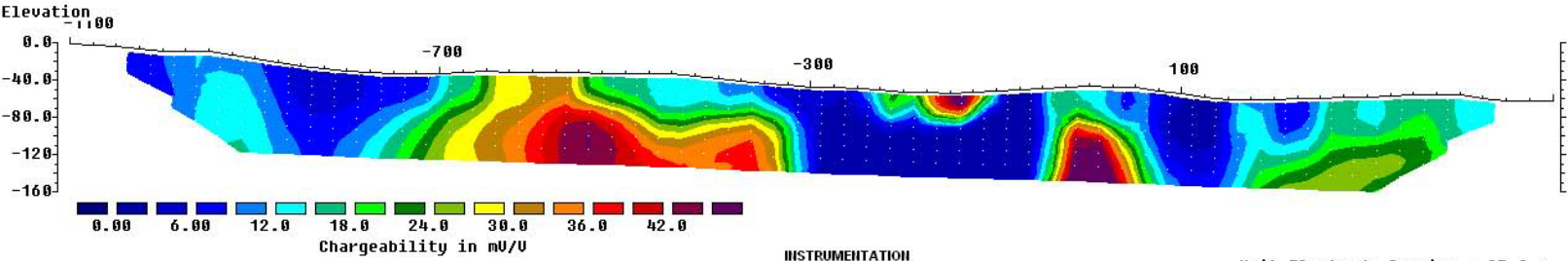
L1100N.bin

Model resistivity with topography  
Iteration 4 RMS error = 15.5



Unit Electrode Spacing = 25.0 m.

Model IP with topography  
Iteration 4 RMS error = 12.7



Unit Electrode Spacing = 25.0 m.

Horizontal scale is 18.73 pixels per unit spacing  
Vertical exaggeration in model section display = 1.00  
First electrode is located at -1100.0 m.  
Last electrode is located at 500.0 m.

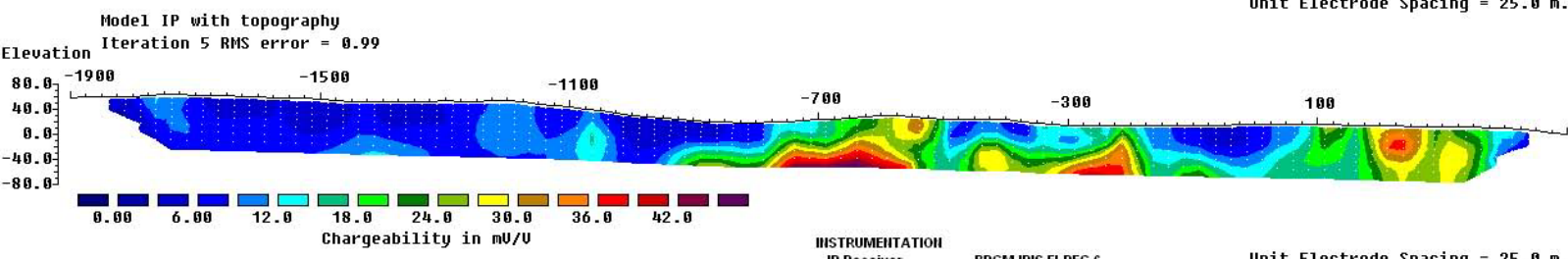
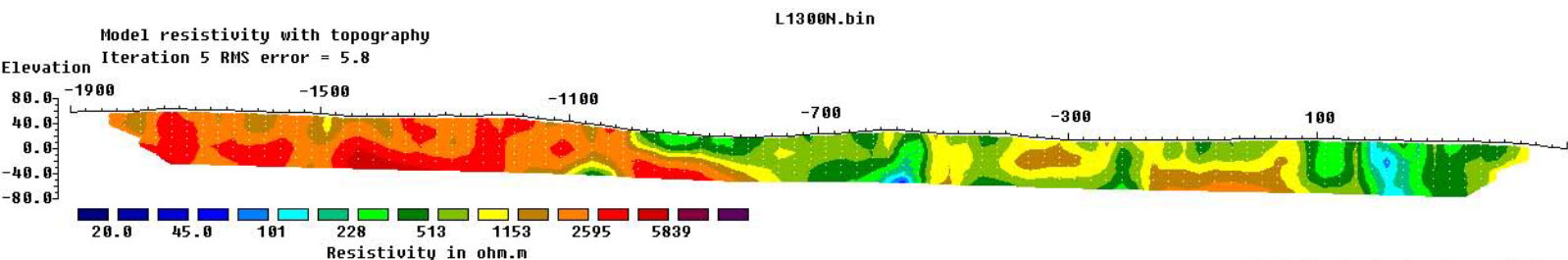
**INSTRUMENTATION**

IP Receiver BRGM IRIS ELREC 6  
IP Transmitter BRGM VIP 4000  
IP Generator 6.5 kWatt Honda

**IP SURVEY PARAMETERS**

Survey mode Time Domain  
Array Dipole-Dipole  
Dipole Length 50 meters  
Dipole Separation n=1 to n=12  
Delay Time 240 ms  
Integration Time 1800 ms  
Charge Cycle 8 second square wave  
Survey Date July 2006

GEOTRONICS CONSULTING INC.				
ALMO CAPITAL CORP				
<b>THE MOORE PROPERTY</b>				
NORTH BARRIER LAKE AREA, KAMLOOPS M.D., B.C.				
<i>IP and RESISTIVITY SURVEYS</i>				
<i>GEOTOMO INVERSION</i>				
<b>LINE 1100N</b>				
DONE BY:	JOB NO.:	NTS:	DATE:	FIG NO.:
DGM	06-08	82M/05	SEPT 06	GP-22



Horizontal scale is 12.49 pixels per unit spacing  
Vertical exaggeration in model section display = 1.00  
First electrode is located at -1900.0 m.  
Last electrode is located at 500.0 m.

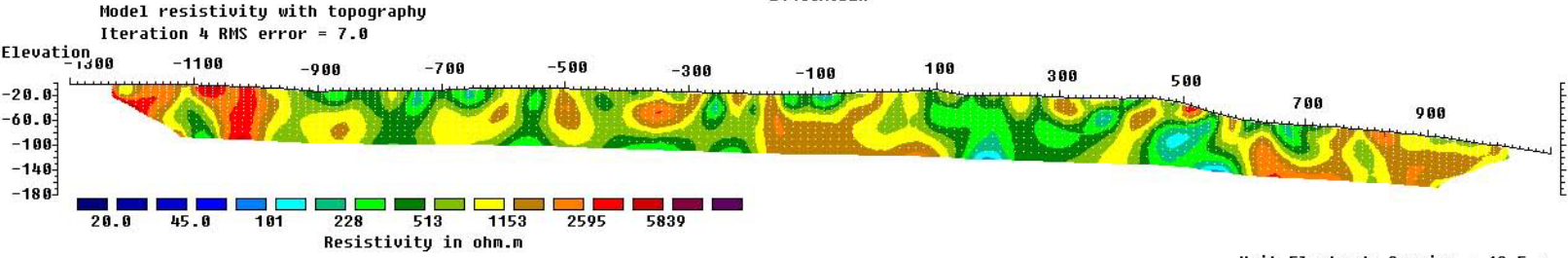
**INSTRUMENTATION**  
 IP Receiver BRGM IRIS ELREC 6  
 IP Transmitter BRGM VIP 4000  
 IP Generator 6.5 kWatt Honda

**IP SURVEY PARAMETERS**  
 Survey mode Time Domain  
 Array Dipole-Dipole  
 Dipole Length 50 meters  
 Dipole Separation n=1 to n=12  
 Delay Time 240 ms  
 Integration Time 1800 ms  
 Charge Cycle 8 second square wave  
 Survey Date July 2006

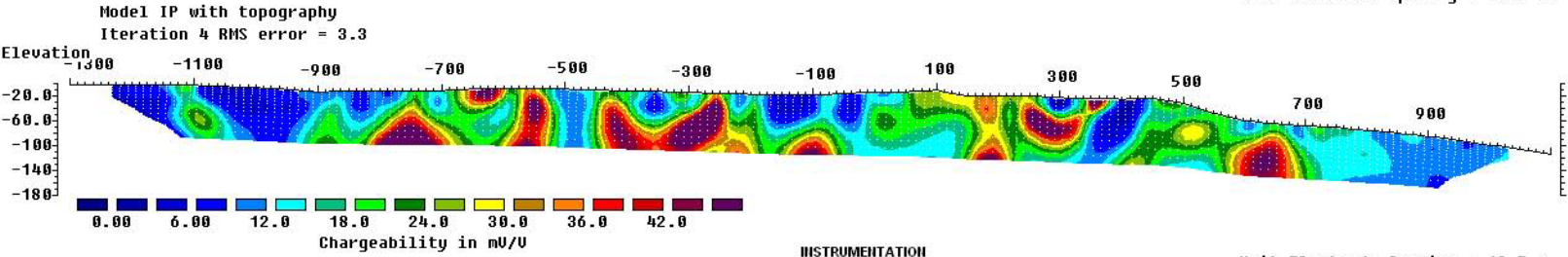
Unit Electrode Spacing = 25.0 m.

GЕOTRONICS CONSULTING INC.				
ALMO CAPITAL CORP				
<b>THE MOORE PROPERTY</b>				
NORTH BARRIERE LAKE AREA, KAMLOOPS M.D., B.C.				
<i>IP and RESISTIVITY SURVEYS</i>				
<i>GEOTOMO INVERSION</i>				
<b>LINE 1300N</b>				
DONE BY:	JOB NO.:	NTS:	DATE:	FIG NO.:
DGM	06-08	82M/05	SEPT 06	GP-23

L1400N.bin



Unit Electrode Spacing = 12.5 m.



Unit Electrode Spacing = 12.5 m.

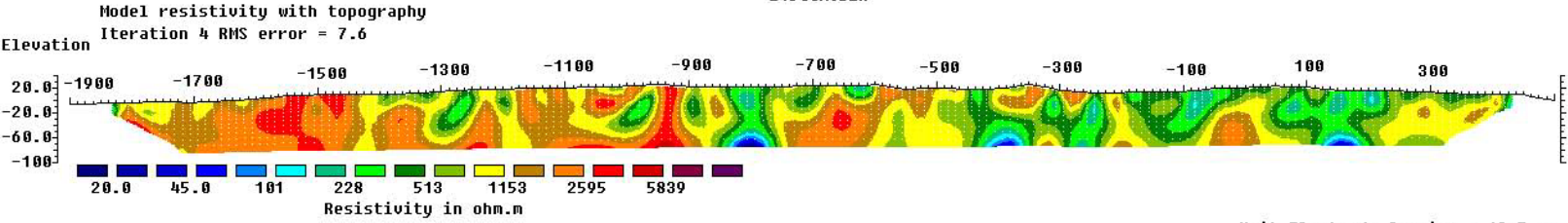
Horizontal scale is 6.24 pixels per unit spacing  
Vertical exaggeration in model section display = 1.00  
First electrode is located at -1300.0 m.  
Last electrode is located at 1100.0 m.

**INSTRUMENTATION**  
IP Receiver BRGM IRIS ELREC 6  
IP Transmitter BRGM VIP 4000  
IP Generator 6.5 kWatt Honda

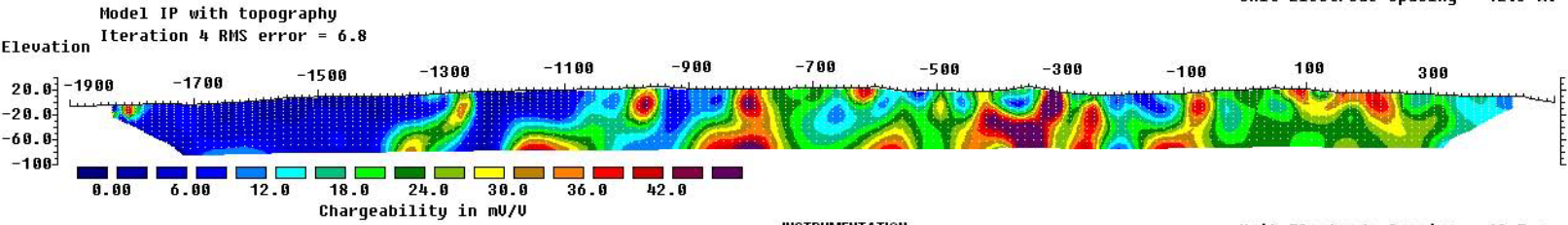
**IP SURVEY PARAMETERS**  
Survey mode Time Domain  
Array Dipole-Dipole  
Dipole Length 50 meters  
Dipole Separation n=1 to n=12  
Delay Time 240 ms  
Integration Time 1800 ms  
Charge Cycle 8 second square wave  
Survey Date July 2006

GEOTRONICS CONSULTING INC.			
ALMO CAPITAL CORP			
<b>THE MOORE PROPERTY</b>			
NORTH BARRIERE LAKE AREA, KAMLOOPS M.D., B.C.			
<i>IP and RESISTIVITY SURVEYS</i>			
GEOTOMO INVERSION			
<b>LINE 1400N</b>			
DONE BY:	JOB NO.:	NTS:	DATE:
DGM	06-08	82M/05	SEPT 06
			FIG NO.:
			GP-24

L1500N.bin



Unit Electrode Spacing = 12.5 m.



Unit Electrode Spacing = 12.5 m.

Horizontal scale is 6.24 pixels per unit spacing  
Vertical exaggeration in model section display = 1.00  
First electrode is located at -1900.0 m.  
Last electrode is located at 500.0 m.

**INSTRUMENTATION**

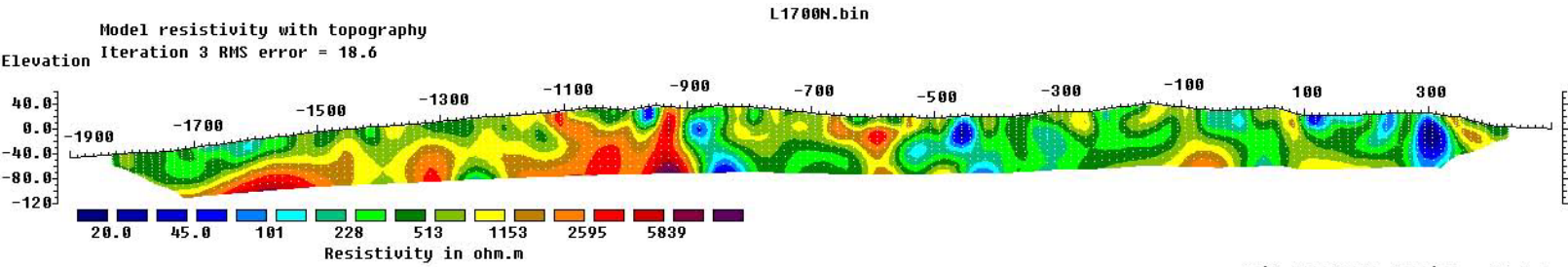
IP Receiver BRGM IRIS ELREC 6  
IP Transmitter BRGM VIP 4000  
IP Generator 6.5 kWatt Honda

**IP SURVEY PARAMETERS**

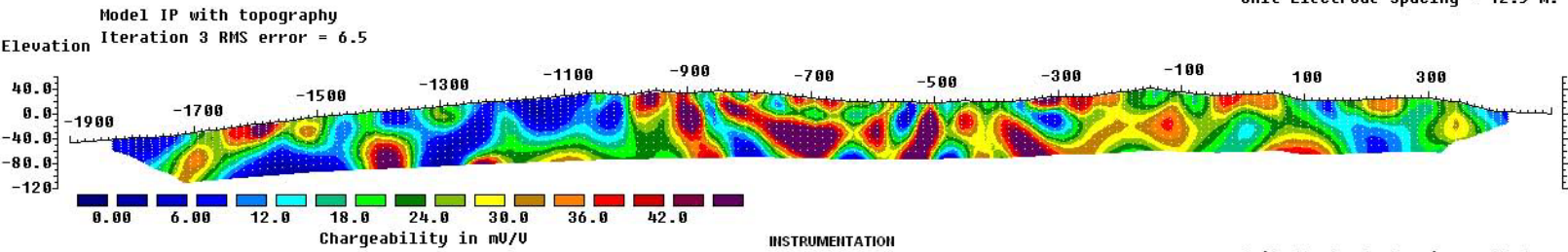
Survey mode Time Domain  
Array Dipole-Dipole  
Dipole Length 50 meters  
Dipole Separation n=1 to n=12  
Delay Time 240 ms  
Integration Time 1800 ms  
Charge Cycle 8 second square wave  
Survey Date July 2006

Unit Electrode Spacing = 12.5 m.

GEOTRONICS CONSULTING INC.				
ALMO CAPITAL CORP				
<b>THE MOORE PROPERTY</b>				
NORTH BARRIER LAKE AREA, KAMLOOPS M.D., B.C.				
<i>IP and RESISTIVITY SURVEYS</i>				
GEOTOMO INVERSION				
<b>LINE 1500N</b>				
DONE BY:	JOB NO.:	NTS:	DATE:	FIG NO.:
DGM	06-08	82M/05	SEPT 06	GP-25



Unit Electrode Spacing = 12.5 m.



Unit Electrode Spacing = 12.5 m.

Horizontal scale is 6.24 pixels per unit spacing  
Vertical exaggeration in model section display = 1.00  
First electrode is located at -1900.0 m.  
Last electrode is located at 500.0 m.

**INSTRUMENTATION**

IP Receiver BRGM IRIS ELREC 6  
IP Transmitter BRGM VIP 4000  
IP Generator 6.5 kWatt Honda

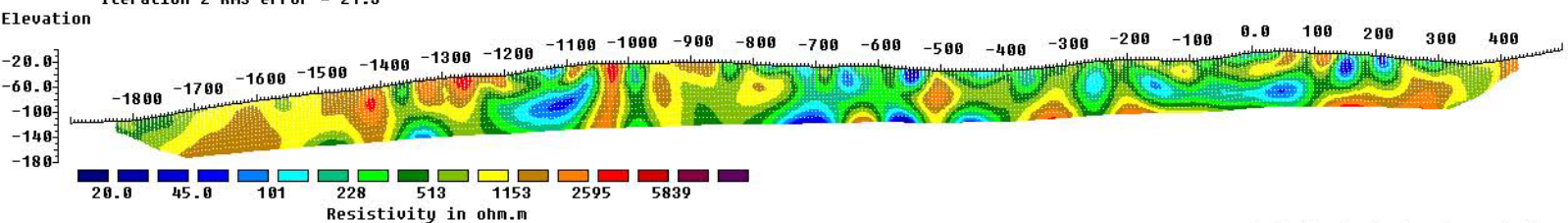
**IP SURVEY PARAMETERS**

Survey mode Time Domain  
Array Dipole-Dipole  
Dipole Length 50 meters  
Dipole Separation n=1 to n=12  
Delay Time 240 ms  
Integration Time 1800 ms  
Charge Cycle 8 second square wave  
Survey Date July 2006

GEOTRONICS CONSULTING INC.				
ALMO CAPITAL CORP				
<b>THE MOORE PROPERTY</b>				
NORTH BARRIERE LAKE AREA, KAMLOOPS M.D., B.C.				
<i>IP and RESISTIVITY SURVEYS</i>				
<i>GEOTOMO INVERSION</i>				
<b>LINE 1700N</b>				
DONE BY:	JOB NO.:	NTS:	DATE:	FIG NO.:
DGM	06-08	82M/05	SEPT 06	GP-26

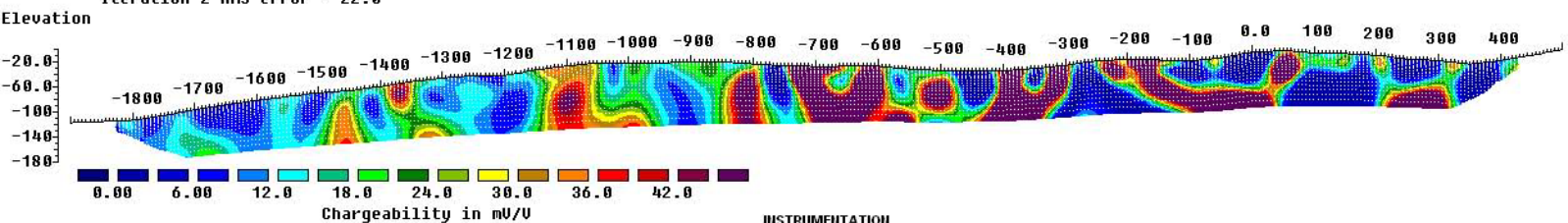
L1900N.bin

Model resistivity with topography  
Iteration 2 RMS error = 21.3



Unit Electrode Spacing = 6.25 m.

Model IP with topography  
Iteration 2 RMS error = 22.0



Unit Electrode Spacing = 6.25 m.

Horizontal scale is 3.12 pixels per unit spacing  
Vertical exaggeration in model section display = 1.00  
First electrode is located at -1900.0 m.  
Last electrode is located at 500.0 m.

**INSTRUMENTATION**

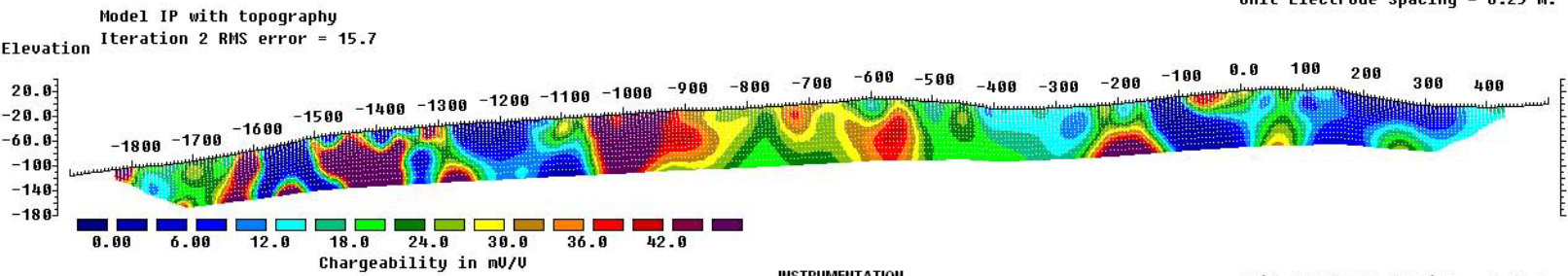
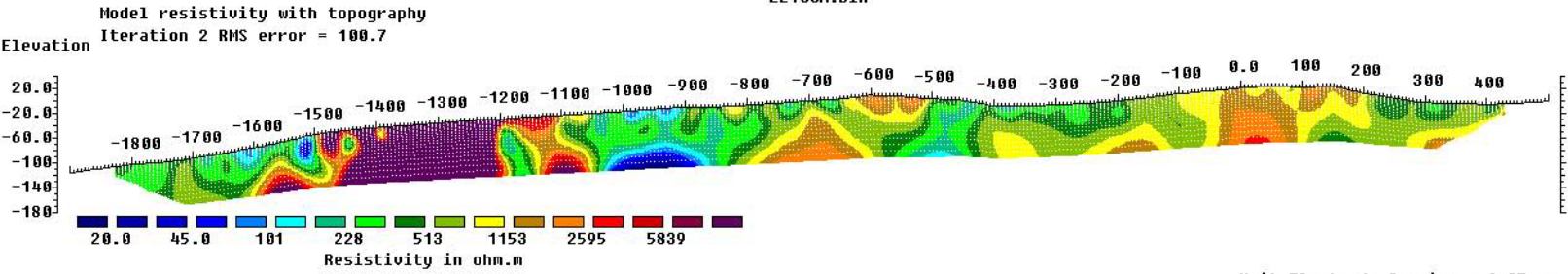
IP Receiver BRGM IRIS ELREC 6  
IP Transmitter BRGM VIP 4000  
IP Generator 6.5 kWatt Honda

**IP SURVEY PARAMETERS**

Survey mode Time Domain  
Array Dipole-Dipole  
Dipole Length 50 meters  
Dipole Separation n=1 to n=12  
Delay Time 240 ms  
Integration Time 1800 ms  
Charge Cycle 8 second square wave  
Survey Date July 2006

GEOTRONICS CONSULTING INC.				
ALMO CAPITAL CORP				
<b>THE MOORE PROPERTY</b>				
NORTH BARRIERE LAKE AREA, KAMLOOPS M.D., B.C.				
<i>IP and RESISTIVITY SURVEYS</i>				
<i>GEOTOMO INVERSION</i>				
<b>LINE 1900N</b>				
DONE BY:	JOB NO.:	NTS:	DATE:	FIG NO.:
DGM	06-08	82M/05	SEPT 06	GP-27

L2100N.bin



Horizontal scale is 3.12 pixels per unit spacing  
Vertical exaggeration in model section display = 1.00  
First electrode is located at -1900.0 m.  
Last electrode is located at 500.0 m.

**INSTRUMENTATION**

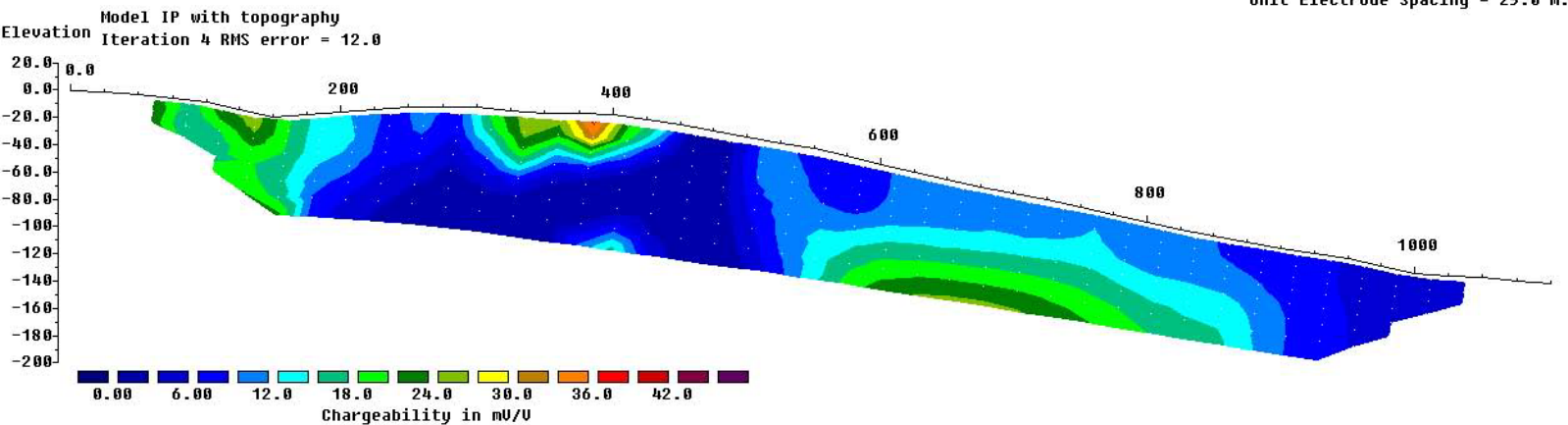
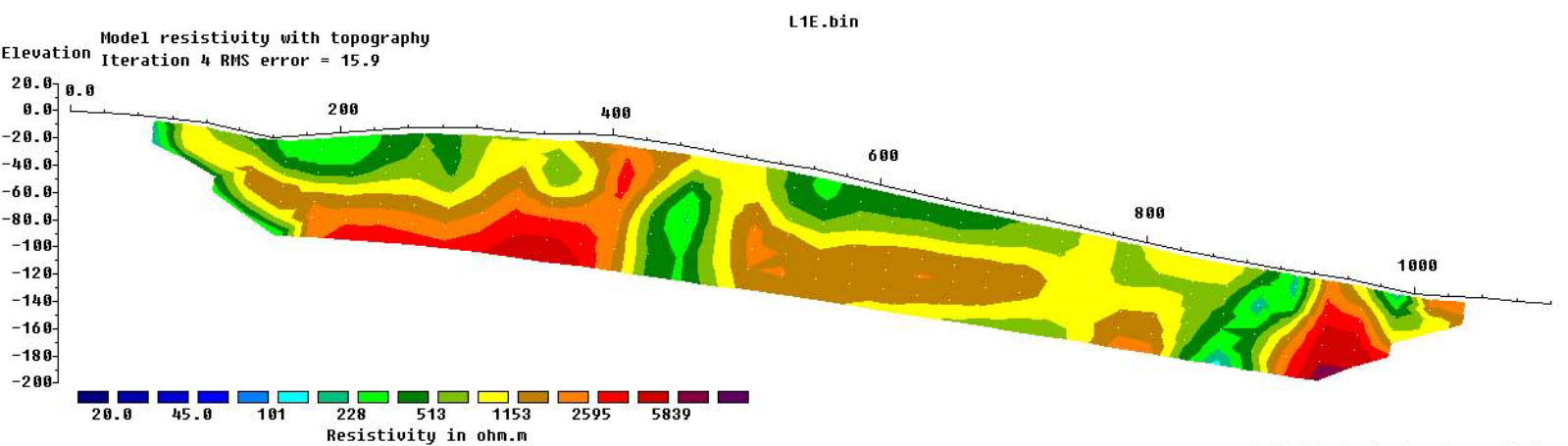
IP Receiver BRGM IRIS ELREC 6  
IP Transmitter BRGM VIP 4000  
IP Generator 6.5 kWatt Honda

**IP SURVEY PARAMETERS**

Survey mode Time Domain  
Array Dipole-Dipole  
Dipole Length 50 meters  
Dipole Separation n=1 to n=12  
Delay Time 240 ms  
Integration Time 1800 ms  
Charge Cycle 8 second square wave  
Survey Date July 2006

Unit Electrode Spacing = 6.25 m.

GEOTRONICS CONSULTING INC.				
ALMO CAPITAL CORP				
<b>THE MOORE PROPERTY</b>				
NORTH BARRIERE LAKE AREA, KAMLOOPS M.D., B.C.				
<i>IP and RESISTIVITY SURVEYS</i>				
GEOTOMO INVERSION				
<b>LINE 2100N</b>				
DONE BY:	JOB NO.:	NTS:	DATE:	FIG NO.:
DGM	06-08	82M/05	SEPT 06	GP-28



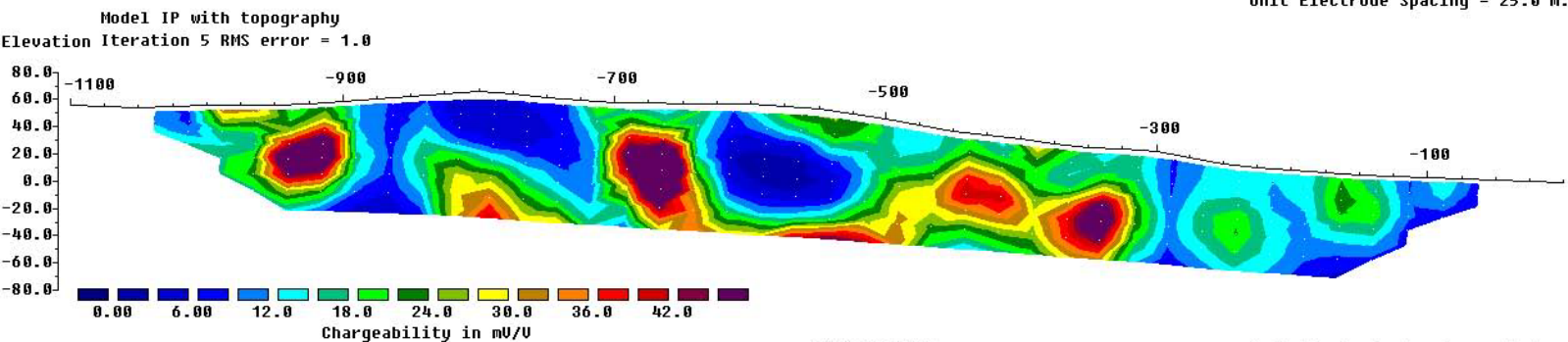
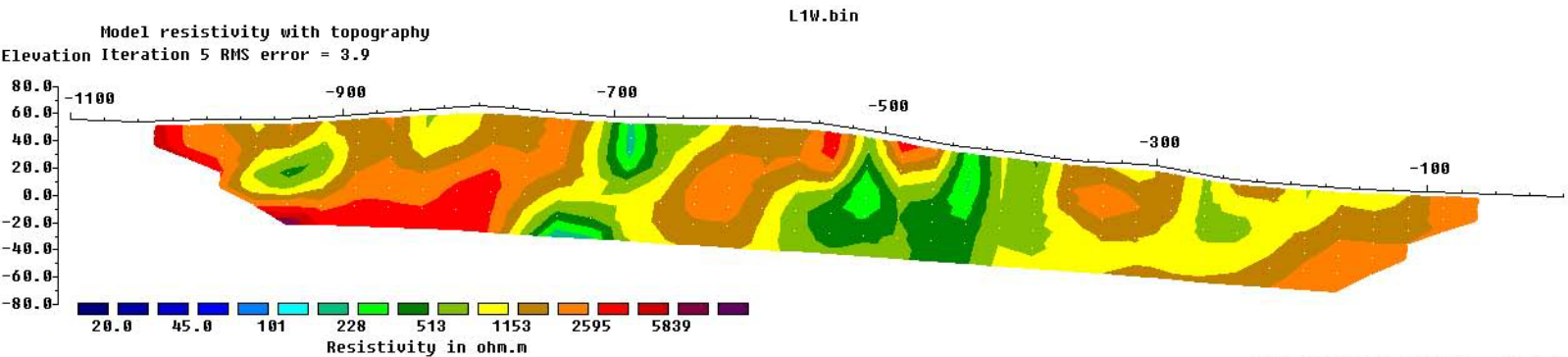
Horizontal scale is 27.25 pixels per unit spacing  
Vertical exaggeration in model section display = 1.00  
First electrode is located at 0.0 m.  
Last electrode is located at 1100.0 m.

**INSTRUMENTATION**  
 IP Receiver BRGM IRIS ELREC 6  
 IP Transmitter BRGM VIP 4000  
 IP Generator 6.5 kWatt Honda

**IP SURVEY PARAMETERS**  
 Survey mode Time Domain  
 Array Dipole-Dipole  
 Dipole Length 50 meters  
 Dipole Separation n=1 to n=12  
 Delay Time 240 ms  
 Integration Time 1800 ms  
 Charge Cycle 8 second square wave  
 Survey Date July 2006

Unit Electrode Spacing = 25.0 m.

GEOTRONICS CONSULTING INC.				
ALMO CAPITAL CORP				
<b>THE MOORE PROPERTY</b>				
NORTH BARRIERE LAKE AREA, KAMLOOPS M.D., B.C.				
<i>IP and RESISTIVITY SURVEYS</i>				
<i>GEOTOMO INVERSION</i>				
<b>LINE 1E</b>				
DONE BY:	JOB NO.:	NTS:	DATE:	FIG NO.:
DGM	06-08	82M/05	SEPT 06	GP-29



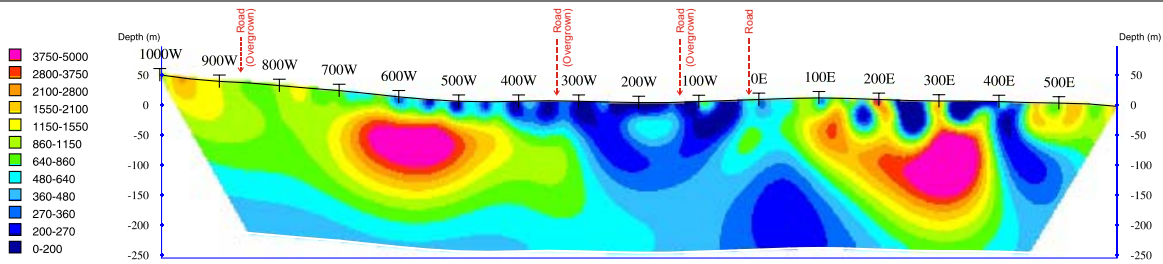
Horizontal scale is 27.25 pixels per unit spacing  
Vertical exaggeration in model section display = 1.00  
First electrode is located at -1100.0 m.  
Last electrode is located at 0.0 m.

**INSTRUMENTATION**  
 IP Receiver BRGM IRIS ELREC 6  
 IP Transmitter BRGM VIP 4000  
 IP Generator 6.5 kWatt Honda

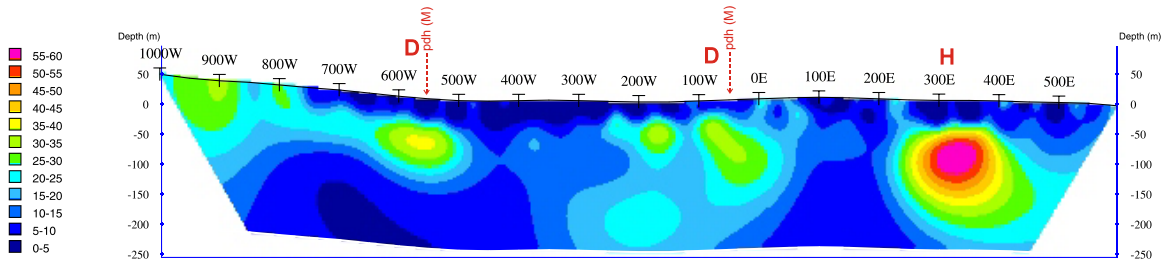
**IP SURVEY PARAMETERS**  
 Survey mode Time Domain  
 Array Dipole-Dipole  
 Dipole Length 50 meters  
 Dipole Separation n=1 to n=12  
 Delay Time 240 ms  
 Integration Time 1800 ms  
 Charge Cycle 8 second square wave  
 Survey Date July 2006

Unit Electrode Spacing = 25.0 m.

GEOTRONICS CONSULTING INC.				
ALMO CAPITAL CORP				
<b>THE MOORE PROPERTY</b>				
NORTH BARRIERE LAKE AREA, KAMLOOPS M.D., B.C.				
<i>IP and RESISTIVITY SURVEYS</i> GEOTOMO INVERSION <b>LINE 1W</b>				
DONE BY: DGM	JOB NO.: 06-08	NTS: 82M/05	DATE: SEPT 06	FIG NO.: GP-30



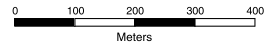
Interpreted Resistivity (Ohm-m)



Interpreted Chargeability (ms)

Survey Information

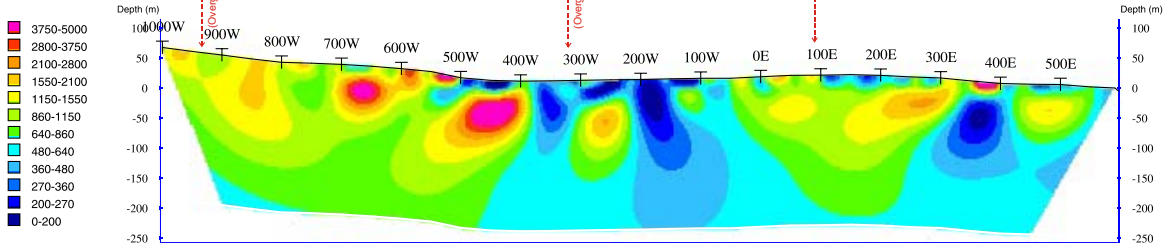
2D Dipole-Dipole Survey by: Geotronics Consulting Inc  
 2D inversion by: S.J.V. Consultants Ltd.  
 Processing Date: November, 2006  
 Mapping Date: December, 2006



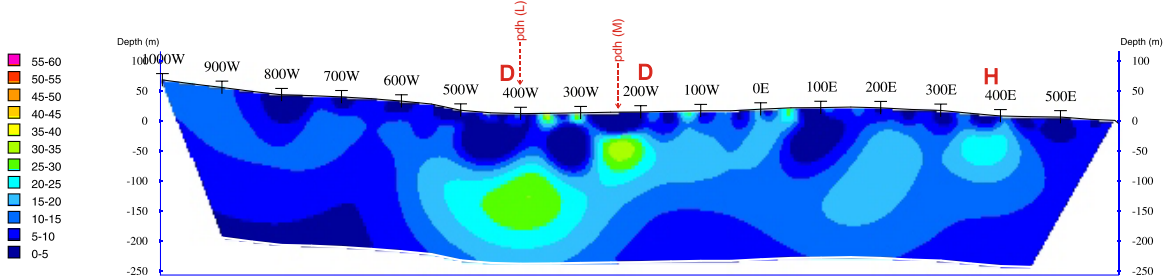
ALMO CAPITAL CORP.  
 The Moore Property  
 Barriere Area, Kamloops MD, BC

2D IP SURVEY  
 2D Cross Sections  
 False Color Contour Map

Line 100S

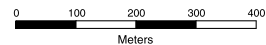


Interpreted Resistivity (Ohm-m)



Interpreted Chargeability (ms)

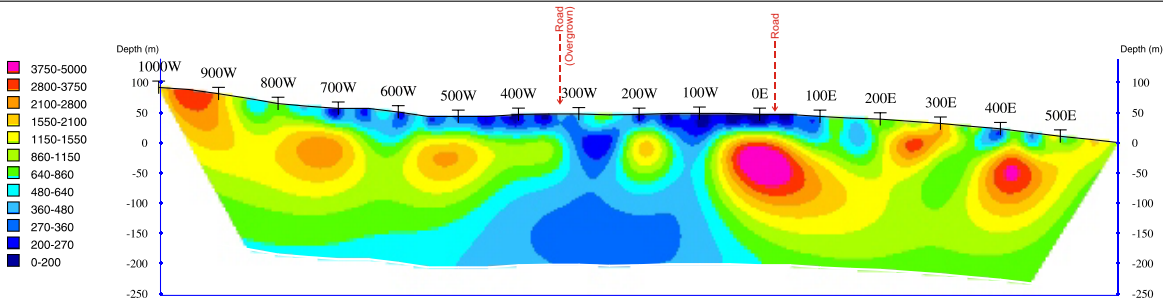
Survey Information  
 2D Dipole-Dipole Survey by: Geotronics Consulting Inc  
 2D inversion by: S.J.V. Consultants Ltd.  
 Processing Date: November, 2006  
 Mapping Date: December, 2006



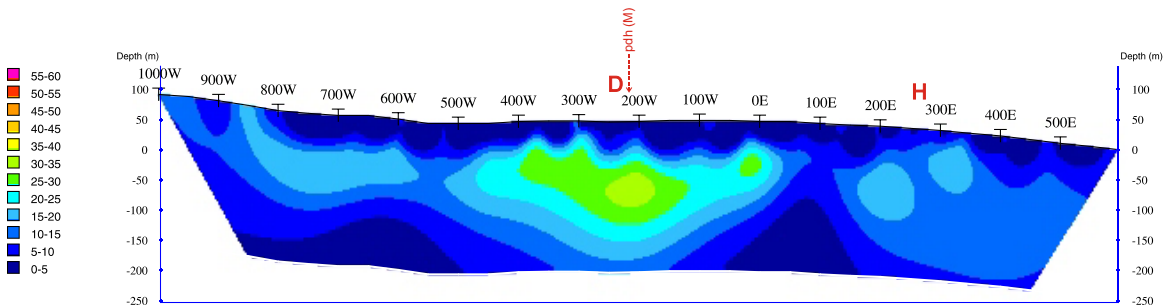
**ALMO CAPITAL CORP.**  
 The Moore Property  
 Barriere Area, Kamloops MD, BC

**2D IP SURVEY**  
 2D Cross Sections  
 False Color Contour Map

**Line 100N**



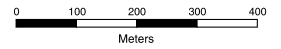
Interpreted Resistivity (Ohm-m)



Interpreted Chargeability (ms)

Survey Information

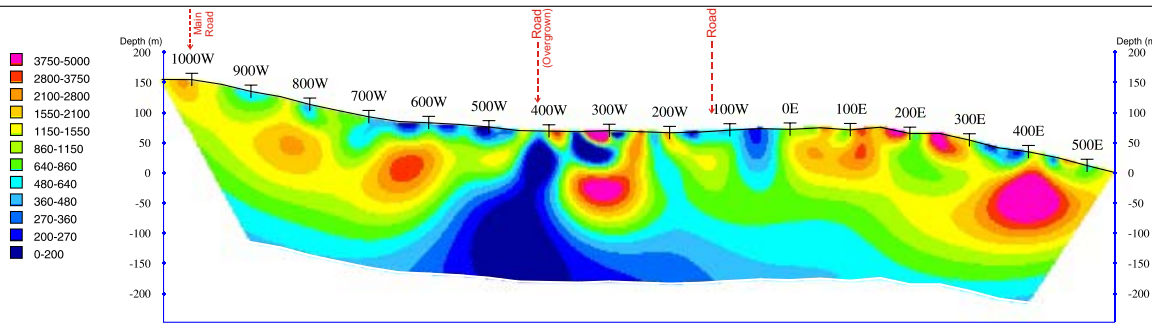
2D Dipole-Dipole Survey by: Geotronics Consulting Inc  
 2D inversion by: S.J.V. Consultants Ltd.  
 Processing Date: November, 2006  
 Mapping Date: December, 2006



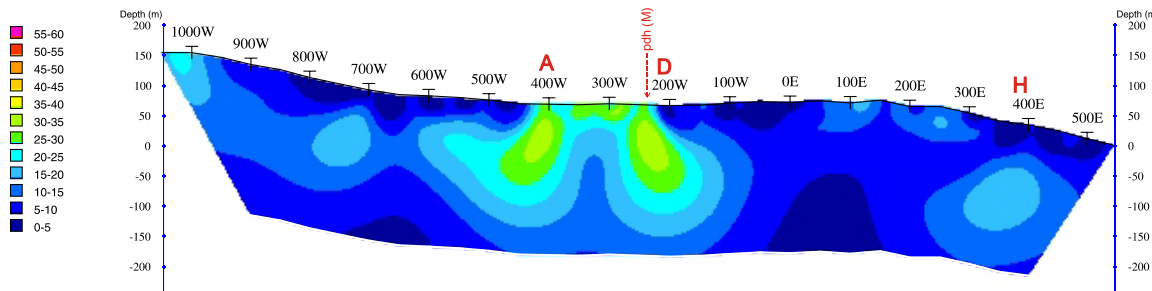
**ALMO CAPITAL CORP.**  
 The Moore Property  
 Barriere Area, Kamloops MD, BC

**2D IP SURVEY**  
 2D Cross Sections  
 False Color Contour Map

**Line 300N**

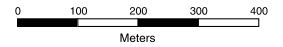


Interpreted Resistivity (Ohm-m)



Interpreted Chargeability (ms)

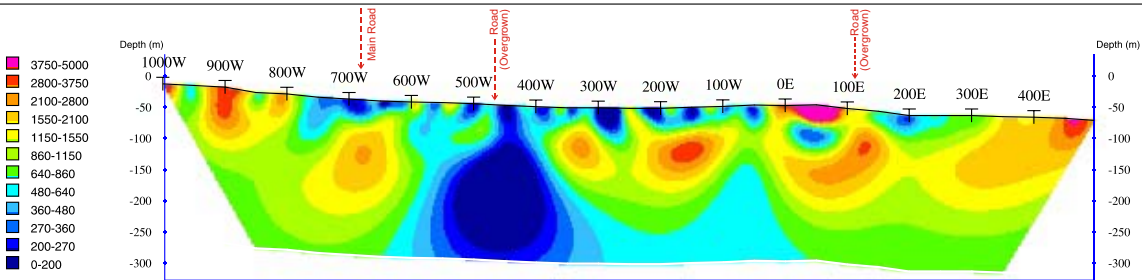
Survey Information  
 2D Dipole-Dipole Survey by: Geotronics Consulting Inc  
 2D inversion by: S.J.V. Consultants Ltd.  
 Processing Date: November, 2006  
 Mapping Date: December, 2006



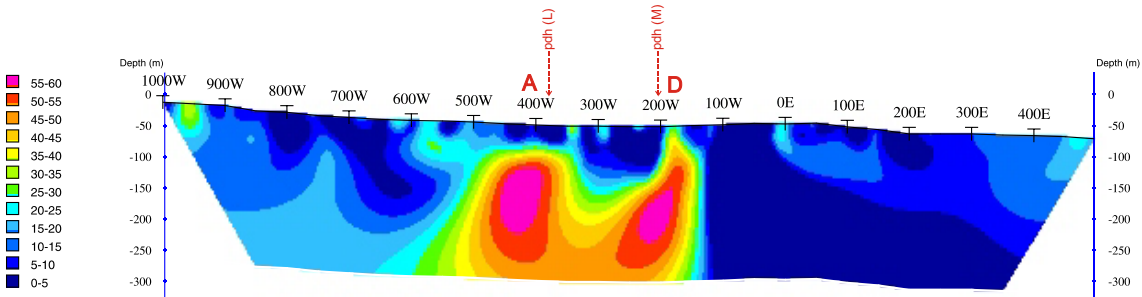
**ALMO CAPITAL CORP.**  
 The Moore Property  
 Barriere Area, Kamloops MD, BC

**2D IP SURVEY**  
 2D Cross Sections  
 False Color Contour Map

**Line 500N**

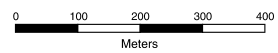


Interpreted Resistivity (Ohm-m)



Interpreted Chargeability (ms)

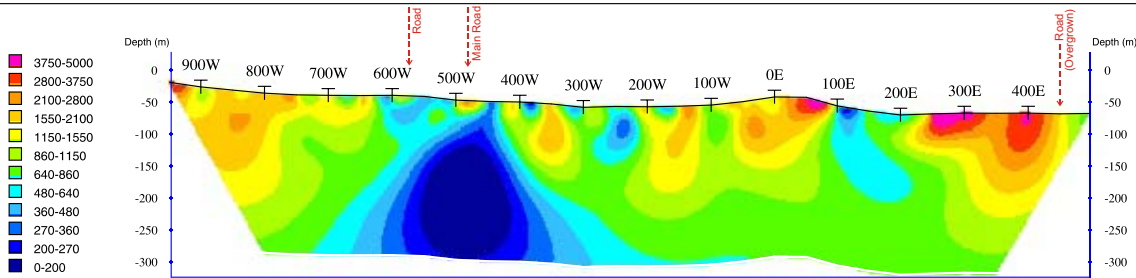
Survey Information  
 2D Dipole-Dipole Survey by: Geotronics Consulting Inc.  
 2D inversion by: S.J.V. Consultants Ltd.  
 Processing Date: November, 2006  
 Mapping Date: December, 2006



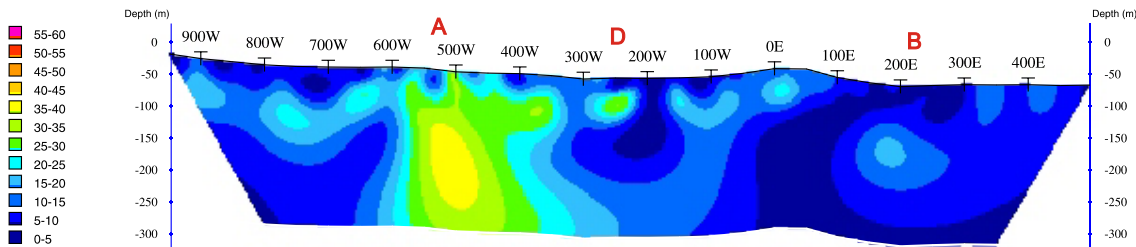
ALMO CAPITAL CORP.  
 The Moore Property  
 Barriere Area, Kamloops MD, BC

2D IP SURVEY  
 2D Cross Sections  
 False Color Contour Map

Line 700N



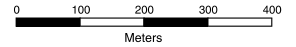
Interpreted Resistivity (Ohm-m)



Interpreted Chargeability (ms)

Survey Information

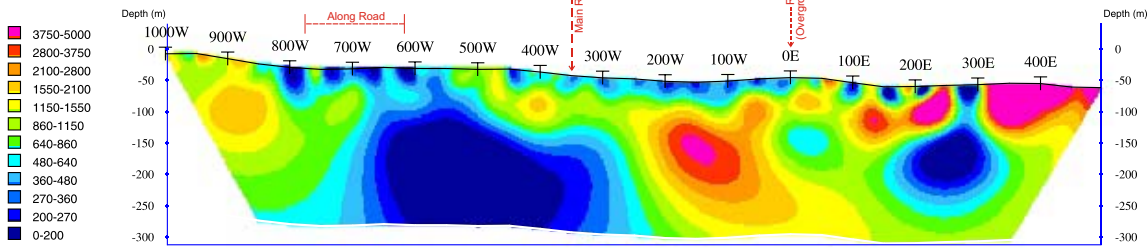
2D Dipole-Dipole Survey by: Geotronics Consulting Inc  
 2D inversion by: S.J.V. Consultants Ltd.  
 Processing Date: November, 2006  
 Mapping Date: December, 2006



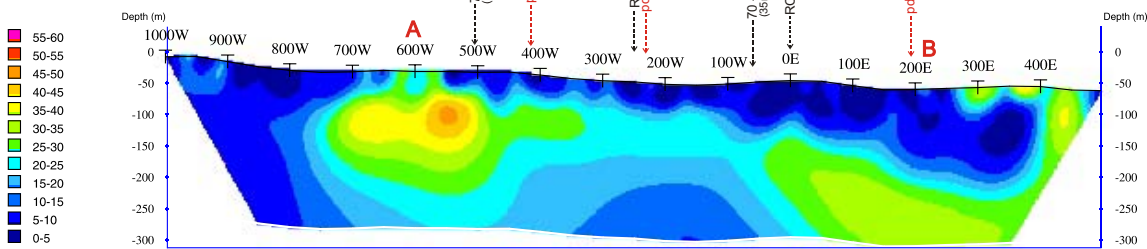
**ALMO CAPITAL CORP.**  
 The Moore Property  
 Barriere Area, Kamloops MD, BC

**2D IP SURVEY**  
 2D Cross Sections  
 False Color Contour Map

**Line 900N**

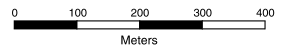


Interpreted Resistivity (Ohm-m)



Interpreted Chargeability (ms)

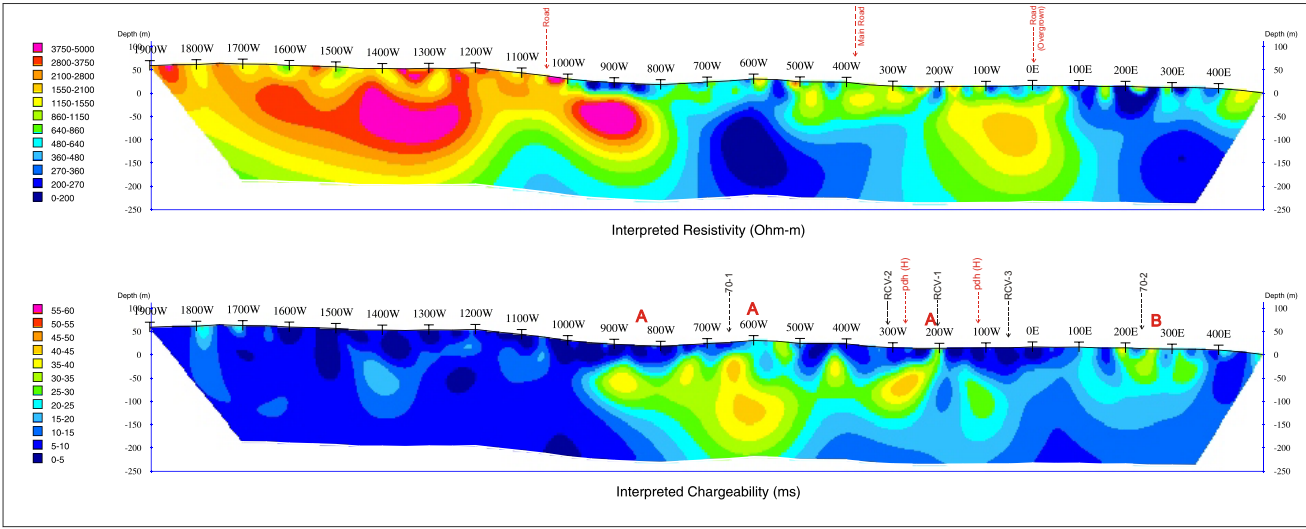
Survey Information  
 2D Dipole-Dipole Survey by: Geotronics Consulting Inc  
 2D inversion by: S.J.V. Consultants Ltd.  
 Processing Date: November, 2006  
 Mapping Date: December, 2006



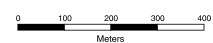
ALMO CAPITAL CORP.  
 The Moore Property  
 Barriere Area, Kamloops MD, BC

2D IP SURVEY  
 2D Cross Sections  
 False Color Contour Map

Line 1100N



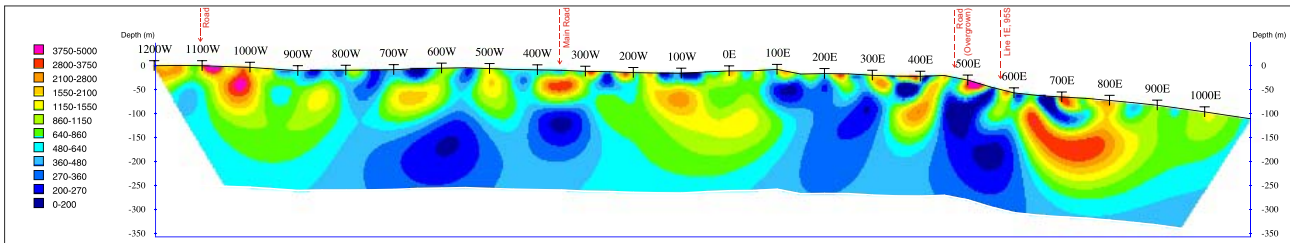
Survey Information  
 2D Dipole-Dipole Survey by: Geotronics Consulting Inc  
 2D Inversion by: S.J.V. Consultants Ltd.  
 Processing Date: November, 2006  
 Mapping Date: December, 2006



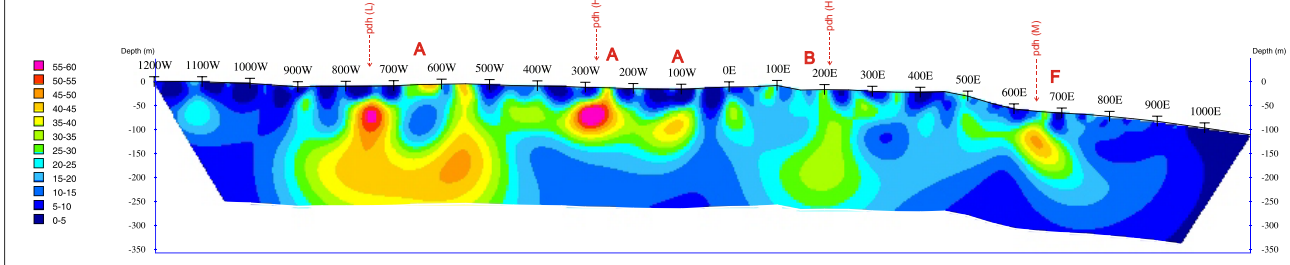
**ALMO CAPITAL CORP.**  
 The Moore Property  
 Barriere Area, Kamloops MD, BC

**2D IP SURVEY**  
 2D Cross Sections  
 False Color Contour Map

**Line 1300N**

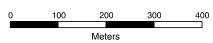


Interpreted Resistivity (Ohm-m)



Interpreted Chargeability (ms)

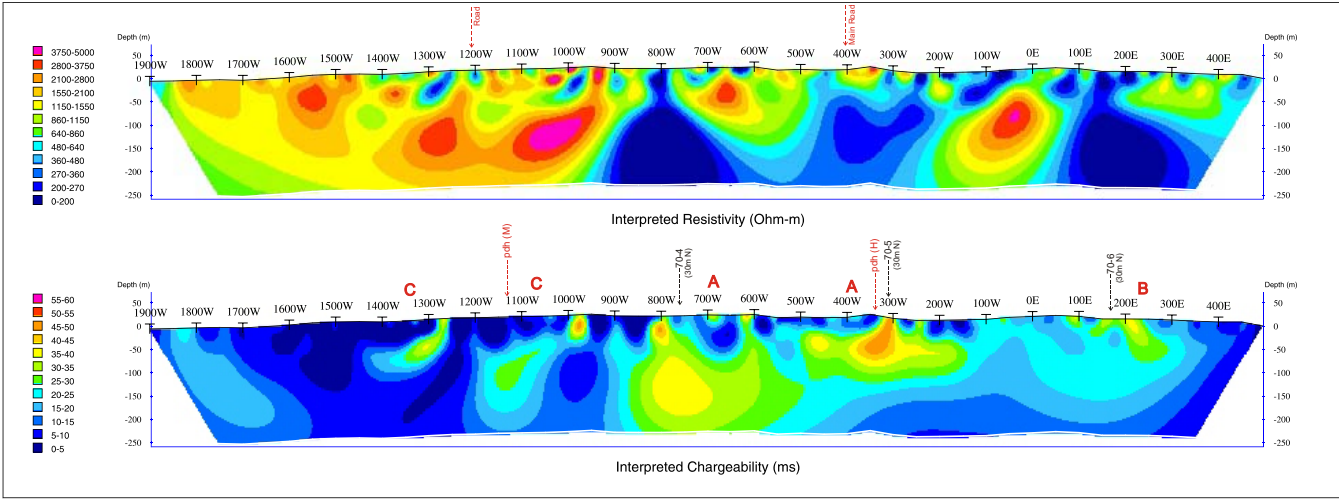
Survey Information  
 2D Dipole-Dipole Survey by: Geotronics Consulting Inc  
 2D inversion by: S.J.V. Consultants Ltd.  
 Processing Date: November, 2006  
 Mapping Date: December, 2006



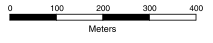
ALMO CAPITAL CORP.  
 The Moore Property  
 Barriere Area, Kamloops MD, BC

2D IP SURVEY  
 2D Cross Sections  
 False Color Contour Map

Line 1400N



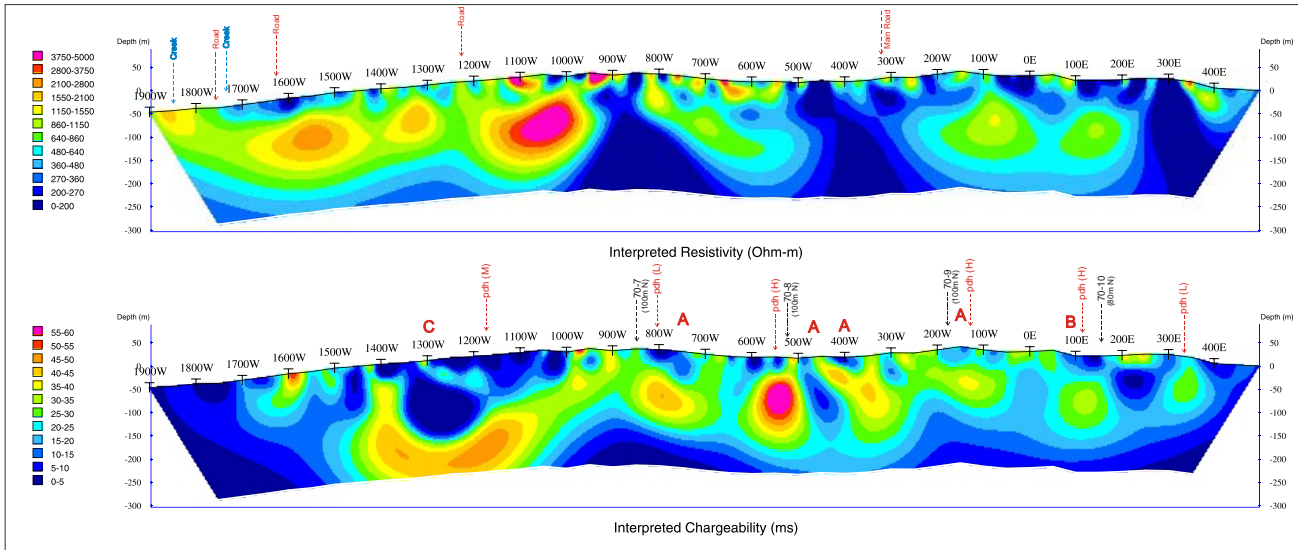
Survey Information  
 2D Dipole-Dipole Survey by: Geotronics Consulting Inc  
 2D Inversion by: S.J.V. Consultants Ltd.  
 Processing Date: November, 2006  
 Mapping Date: December, 2006



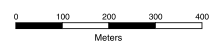
**ALMO CAPITAL CORP.**  
**The Moore Property**  
 Barriere Area, Kamloops MD, BC

**2D IP SURVEY**  
 2D Cross Sections  
 False Color Contour Map

**Line 1500N**



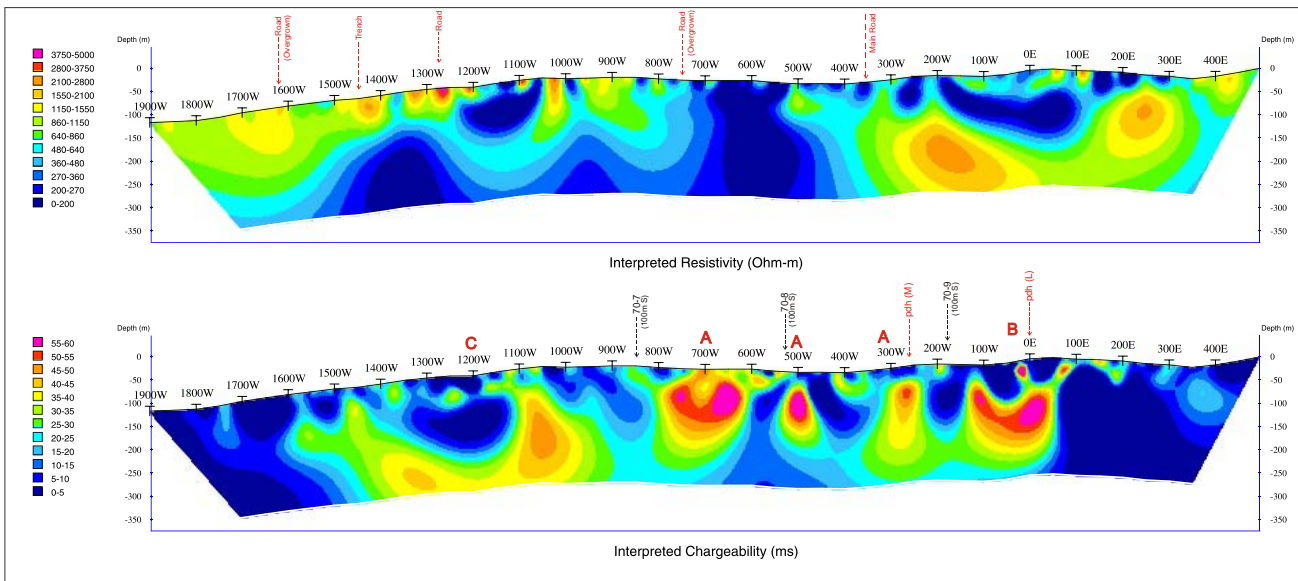
Survey Information  
 2D Dipole-Dipole Survey by: Geonetics Consulting Inc  
 2D Inversion by: S.J.V. Consultants Ltd.  
 Processing Date: November, 2006  
 Mapping Date: December, 2006



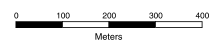
ALMO CAPITAL CORP.  
 The Moore Property  
 Barriere Area, Kamloops MD, BC

2D IP SURVEY  
 2D Cross Sections  
 False Color Contour Map

Line 1700N



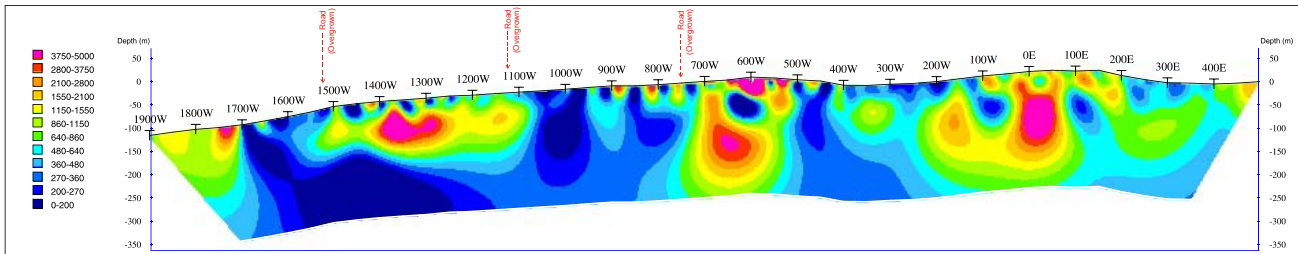
Survey Information  
 2D Dipole-Dipole Survey by: Geotronics Consulting Inc  
 2D Inversion by: S.J.V. Consultants Ltd.  
 Processing Date: November, 2006  
 Mapping Date: December, 2006



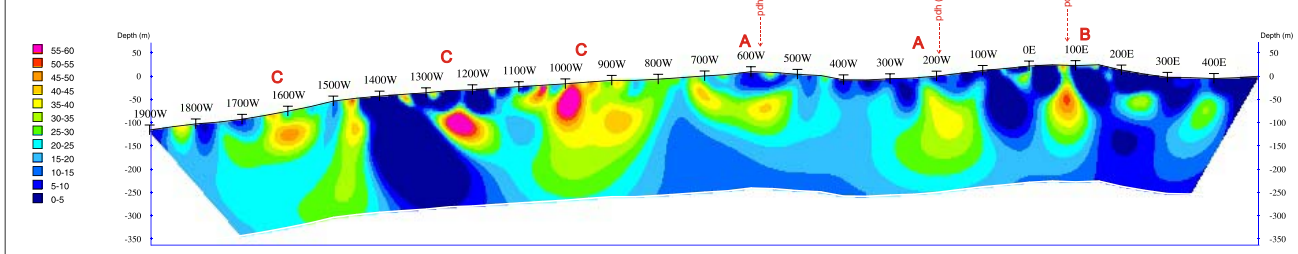
**ALMO CAPITAL CORP.**  
 The Moore Property  
 Barriere Area, Kamloops MD, BC

**2D IP SURVEY**  
 2D Cross Sections  
 False Color Contour Map

**Line 1900N**

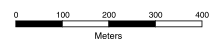


Interpreted Resistivity (Ohm-m)



Interpreted Chargeability (ms)

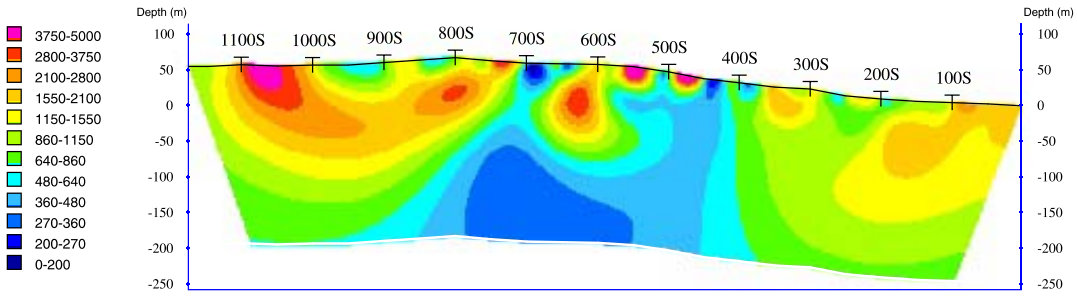
Survey Information  
 2D Dipole-Dipole Survey by: Geotronics Consulting Inc  
 2D Inversion by: S.J.V. Consultants Ltd.  
 Processing Date: November, 2006  
 Mapping Date: December, 2006



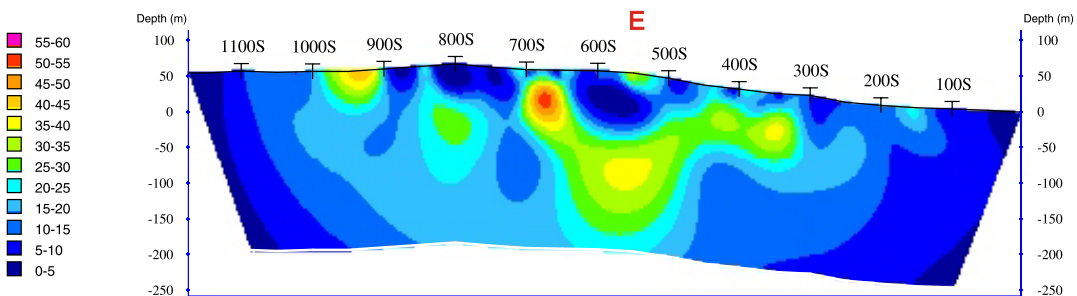
**ALMO CAPITAL CORP.**  
 The Moore Property  
 Barriere Area, Kamloops MD, BC

**2D IP SURVEY**  
 2D Cross Sections  
 False Color Contour Map

**Line 2100N**



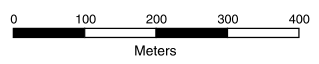
Interpreted Resistivity (Ohm-m)



Interpreted Chargeability (ms)

Survey Information

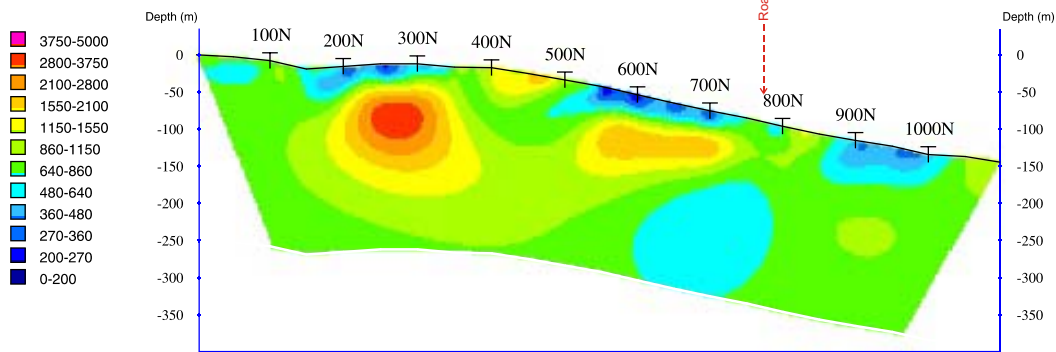
2D Dipole-Dipole Survey by: Geotronics Consulting Inc  
 2D inversion by: S.J.V. Consultants Ltd.  
 Processing Date: November, 2006  
 Mapping Date: December, 2006



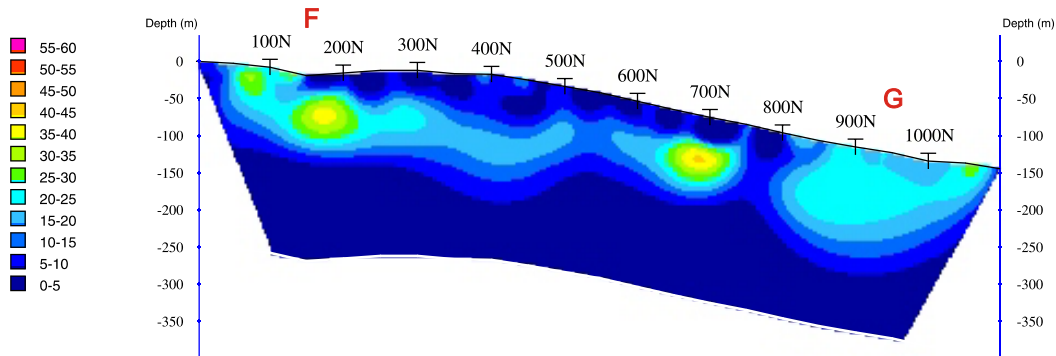
**ALMO CAPITAL CORP.**  
 The Moore Property  
 Barriere Area, Kamloops MD, BC

**2D IP SURVEY**  
 2D Cross Sections  
 False Color Contour Map

**Line 1W**



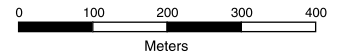
Interpreted Resistivity (Ohm-m)



Interpreted Chargeability (ms)

Survey Information

2D Dipole-Dipole Survey by: Geotronics Consulting Inc  
 2D inversion by: S.J.V. Consultants Ltd.  
 Processing Date: November, 2006  
 Mapping Date: December, 2006

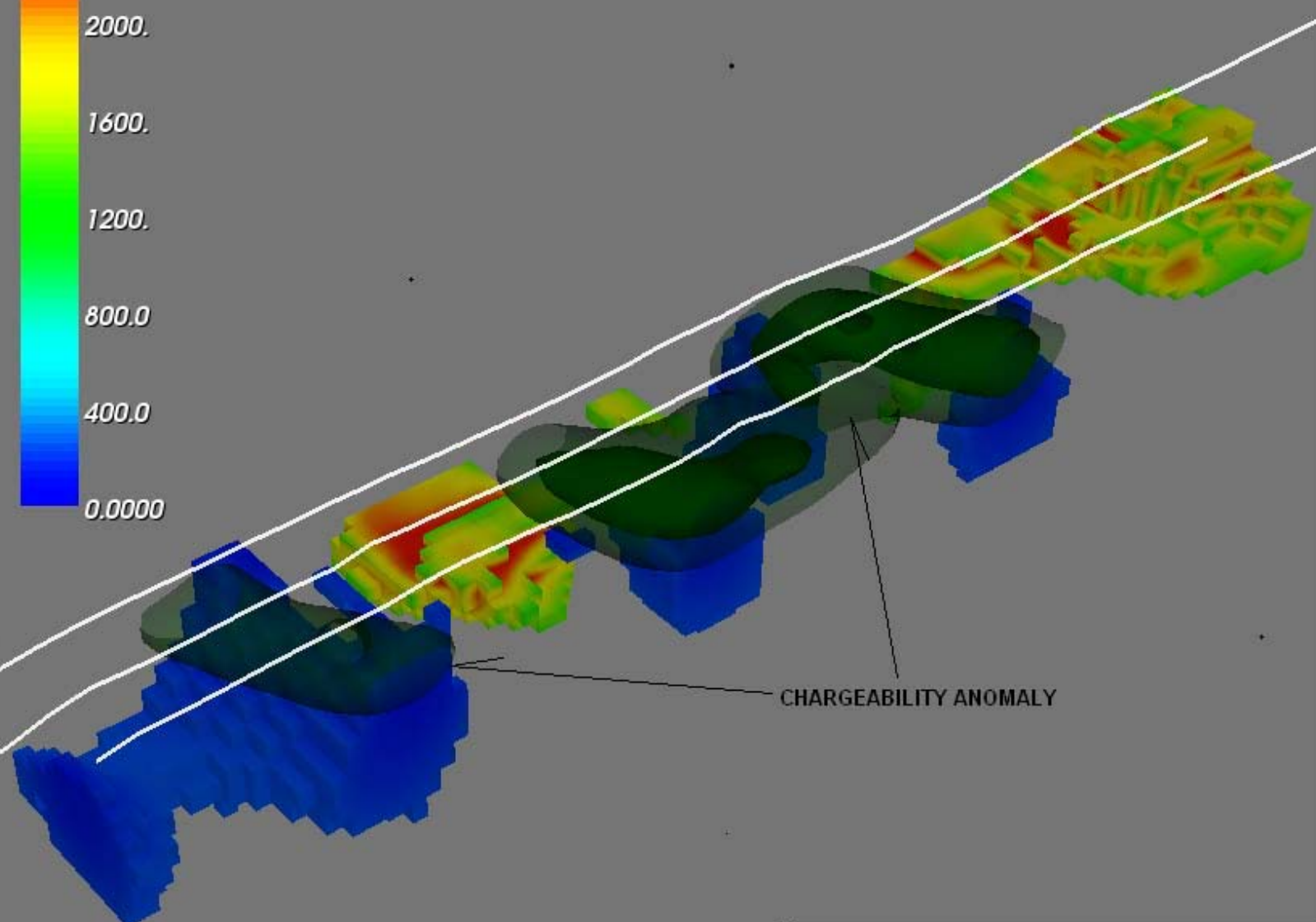


**ALMO CAPITAL CORP.**  
 The Moore Property  
 Barriere Area, Kamloops MD, BC

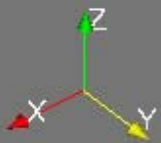
**2D IP SURVEY**  
 2D Cross Sections  
 False Color Contour Map

**Line 1E**

**Resistivity**



CHARGEABILITY ANOMALY



View from Northeast

Northern line is L1500N  
Southern line is L1300N

GEOIONICS CONSULTING INC.				
ALMO CAPITAL CORP				
<b>THE MOORE PROPERTY</b>				
NORTH BARRIERE LAKE AREA, KAMLOOPS M.D., B.C.				
<i>IP and RESISTIVITY SURVEYS</i>				
<i>UBC 3-D INVERSION</i>				
<i>LINES 1300N, 1400N, 1500N</i>				
DONE BY: SJ GEOPHYSICS	JOB NO.: 06-08	NTS: 82M/05	DATE: MAR 07	FIG NO.: GP-46

GEOTRONICS CONSULTING IIIC.

ALMO CAPITAL CORP

**THE MOORE PROPERTY**

NORTH BARRIERE LAKE AREA, KAMLOOPS M.D., B.C.

*IP and RESISTIVITY SURVEYS  
UBC 3-D INVERSION  
LINES 1300N, 1400N, 1500N*

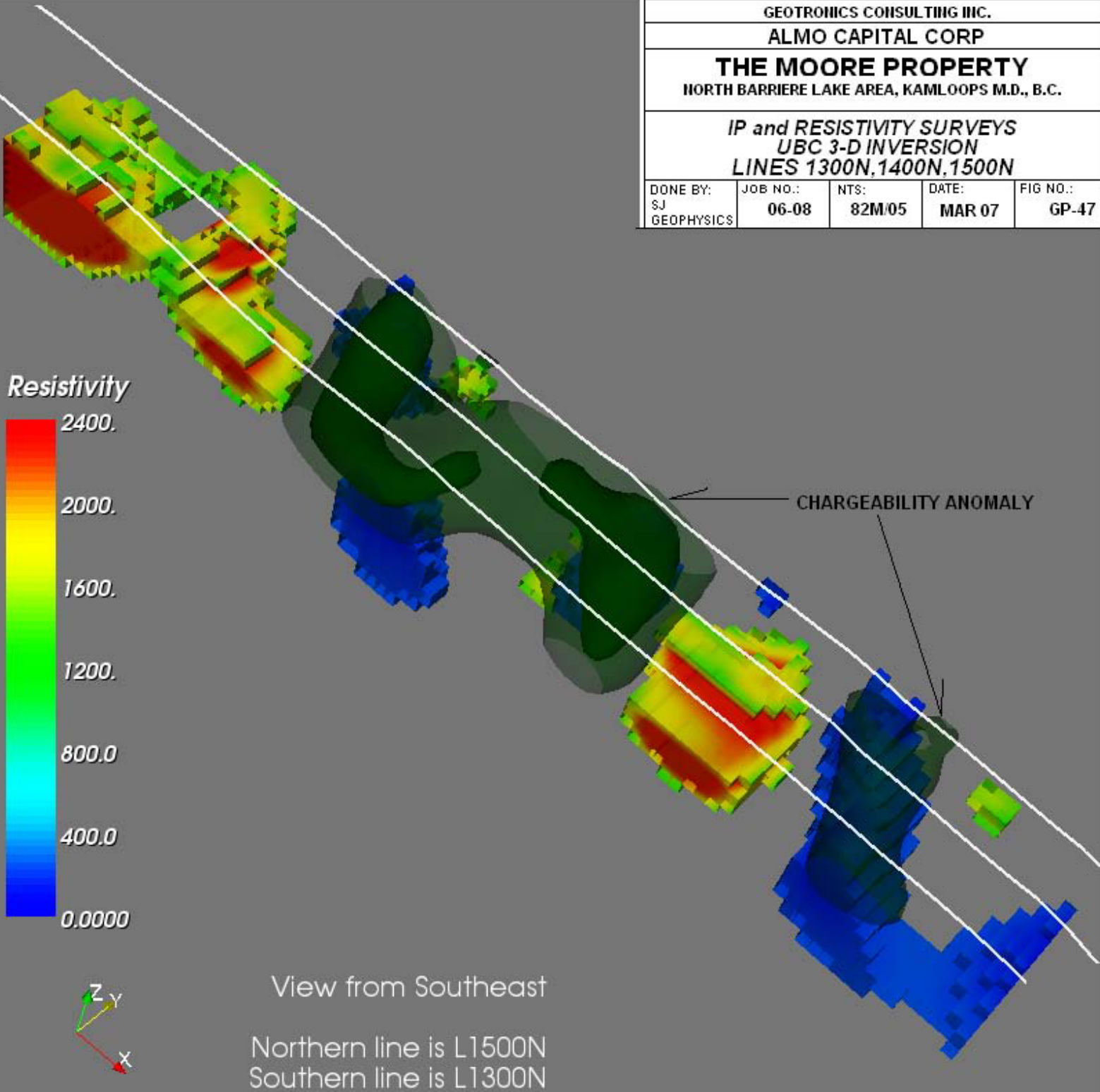
DONE BY:  
SJ  
GEOPHYSICS

JOB NO.:  
06-08

NTS:  
82M/05

DATE:  
MAR 07

FIG NO.:  
GP-47



GEOTRONICS CONSULTING INC.

ALMO CAPITAL CORP

### THE MOORE PROPERTY

NORTH BARRIERE LAKE AREA, KAMLOOPS M.D., B.C.

*IP and RESISTIVITY SURVEYS  
UBC 3-D INVERSION  
LINES 1300N, 1400N, 1500N*

DONE BY:  
SJ  
GEOPHYSICS

JOB NO.:  
06-08

NTS:  
82M/05

DATE:  
MAR 07

FIG NO.:  
GP-48

Resistivity



CHARGEABILITY ANOMALY

Plane view

Northern line is L1500N  
Southern line is L1300N

