

**TECHNICAL REPORT**  
**on the**  
**MOORE PROPERTY**

Kamloops Mining Division  
NTS 082M/05  
Latitude 51°19'23" North  
Longitude 119°46'59" West

**Owner:**  
Almo Capital Corp.  
603 East 30th Avenue  
Vancouver, British Columbia  
V5V 2V7

**Prepared by**  
David G. Mark, P.Geol.

August 15, 2012

## **TABLE OF CONTENTS**

<b>1</b>	<b>SUMMARY</b>	<b>1</b>
<b>2</b>	<b>INTRODUCTION</b>	<b>3</b>
<b>3</b>	<b>RELIANCE ON OTHER EXPERTS</b>	<b>4</b>
<b>4</b>	<b>PROPERTY DESCRIPTION AND LOCATION</b>	<b>5</b>
<b>5</b>	<b>ACCESSIBILITY, CLIMATE, LOCAL RESOURCES, INFRASTRUCTURE AND PHYSIOGRAPHY</b>	<b>6</b>
<b>6</b>	<b>HISTORY</b>	<b>7</b>
6.1	EXPLORATION by SCURRY RAINBOW OILS and JAMES GOURLEY and the MOORE BROTHERS	7
6.2	EXPLORATION by ROYAL CANADIAN VENTURES LTD	8
6.3	EXPLORATION by NORANDA EXPLORATION COMPANY and CRAIGMONT MINES LIMITED	9
6.4	EXPLORATION by WESTERN MINES LIMITED	10
6.5	EXPLORATION by KENNCO EXPLORATIONS (WESTERN) LIMITED	10
6.6	EXPLORATION by ESSO RESOURCS CANADA LIMITED	10
6.7	EXPLORATION by NORTHCOTE	11
6.8	ADON CLAIMS - SOUTHERN AREA	12
6.9	GEM CLAIMS	13
6.10	McLELLAN	14
6.11	WORK by AGATE BAY (1993)	15
6.12	WORK by VALLABH (1987 - 2001)	15
<b>7</b>	<b>GEOLOGICAL SETTING and MINERALIZATION</b>	<b>15</b>
7.1	REGIONAL GEOLOGY	15
7.2	PROPERTY GEOLOGY	16
7.3	MINERALIZATION	17
7.3.1	EBL (082M 051)	18
7.3.2	B&B (082M 110)	18
7.3.3	Ruth (082M 061)	18
7.3.4	NSM (082M 223) south of Barrier Lake	19
7.3.5	McLellan	19
<b>8</b>	<b>DEPOSIT TYPES</b>	<b>19</b>
8.1	TYPE 1 DEPOSITS	19

8.2	TYPE 2 DEPOSITS	20
8.3	TYPE 3 DEPOSITS	20
8.4	TYPE 4 DEPOSITS	20
8.5	TYPE 5 DEPOSITS	21
<b>9</b>	<b>EXPLORATION</b>	<b>21</b>
9.1	2006 WORK PROGRAM	21
9.1.1	IP (chargeability)	22
9.1.2	Resistivity	22
9.1.3	Self Potential	22
9.2	2006 GEOPHYSICAL PROGRAM RESULTS	22
9.2.1	Induced Polarization	22
9.2.2	Resistivity	25
9.2.3	Self Potential	25
9.2.4	3-D Inversion	25
<b>10</b>	<b>DRILLING</b>	<b>25</b>
10.1	2008-2010 DRILLING – EBL ZONE	26
<b>11</b>	<b>SAMPLE PREPARATION, ANALYSES AND SECURTIY</b>	<b>36</b>
<b>12</b>	<b>DATA VERIFICATON</b>	<b>38</b>
<b>13</b>	<b>MINERAL PROCESSING AND METALLURGICAL TESTING</b>	<b>38</b>
<b>14</b>	<b>MINERAL RESOURCE AND MINERAL RESERVE ESTIMATES</b>	<b>38</b>
<b>23</b>	<b>ADJACENT PROPERTIES</b>	<b>39</b>
23.1	HARPER CREEK (MINFILE 082M 009)	39
23.2	HOMESTAKE (MINFILE 082M 025)	40
23.3	REA GOLD (MINFILE 082M 191)	40
23.4	SAMATOSUM (MINFILE 082M 244)	41
<b>24</b>	<b>OTHER RELAVENT DATA AND INFORMATION</b>	<b>45</b>
<b>25</b>	<b>INTERPRETATION AND CONCLUSIONS</b>	<b>45</b>
<b>26</b>	<b>RECOMMENDATIONS</b>	<b>48</b>
26.1	Proposed Budget	48
<b>27</b>	<b>REFERENCES</b>	<b>49</b>
<b>28</b>	<b>DATE AND SIGNATURE PAGE</b>	<b>52</b>

**FIGURES****after page #**

---

Figure 1	Location Map .....	6
Figure 2	Tenure Map.....	6
Figure 3	Regional Setting Location Map .....	6
Figure 4	Historical Work Areas Map .....	7
Figure 5	Geology Map.....	15
Figure 6	IP Inversion Results and Proposed Drill Hole Map .....	21
Figure 7	Drill Hole Location Map .....	26
Figure 8	Mineral Occurrence Map .....	43

**TABLES****page #**

---

Table 1	Moore Property Tenure Information .....	5
Table 2	Summary of 2008-2010 Drill Holes . .....	28
Table 3	Summary of Lithology. ....	29
Table 4	Significant Drill Intersections .....	30
Table 5	Drillcore Sample and Analysis Data. ....	37
Table 6	Summary of Mineral Occurrences in the Moore Region. ....	43

**APPENDICES**

---

Appendix A Pertinent Maps and Diagrams from Bridge (2004)

## **1 SUMMARY**

The Moore property claim group of Almo Capital Corp is located in south-central British Columbia, within the Kamloops Mining District. These claims are centered about 27 km northeast of the town of Barriere, between East Barriere and North Barriere lakes.

The Moore property is situated within a belt of complexly deformed low-grade metamorphic rocks consisting mainly of Paleozoic metasedimentary and metavolcanic rocks of the Eagle Bay Assemblage and Fennel Formation. The belt occurs along the western margin of the Omineca Belt and is flanked on the east by high-grade metamorphic rocks of the Shuswap Complex and on the west by rocks of the Intermontane Belt. To the immediate north and east of the Moore property lies the margin of the Cretaceous Baldy batholith consisting of coarse grained biotite quartz monzonite.

The region contains numerous mineral showings and deposits that since the late 1800s have been the focus of intermittent, and at times, intense mineral exploration. Recent important nearby discoveries of volcanogenic massive sulphides within the region include the Harper Creek, Chu Chua, Rea, Samatosum and CC.

Starting in 1968, various parts of the area now covered by the Moore property tenure received significant documented exploration before Ram Vallabh (with others) acquired the property in 1987 and later formed Almo Capital Corp as operator. The main part of the area was originally staked as the EBL claims which later became the name associated with the main mineralized zone. Prior to 1987, significant soil geochemical and geophysical surveys were completed, including induced polarization (IP). In 1970, the area of disseminated copper-bearing sulphide mineralization on the Moore property (the EBL deposit) was drilled by widely spaced reverse circulation drillholes, with one hole intersecting 64.7 metres grading 0.352% copper with a higher grade intercept of 0.96% copper over 6.1 metres. Samples were not assayed for gold, silver or other elements. Historic drillhole 74-6, in the vicinity of the 1970 drilling, is reported to have intersected 4.3 metres of massive sulphide (from 29.56-33.83 metres) consisting of pyrite, pyrrhotite, and chalcopyrite.

Early Moore property work was directed toward finding porphyry copper mineralization and not the volcanogenic massive sulphide mineralization that was subsequently discovered in Eagle Bay strata, such as that found at the nearby Harper Creek deposit and very possibly like that which is found on the Moore property itself, in the EBL deposit.

The EBL deposit was originally thought to be a metamorphosed and remobilized disseminated pyrite-pyrrhotite-chalcopyrite deposit related to intrusions of Devonian orthogneiss, in other words a deformed porphyry copper deposit. The Harper Creek (082M 009) deposit, located about 24 km north of EBL, occurs in a similar geological

setting to that of the EBL deposit and with similar mineral deposit characteristics. The Harper Creek deposit contains a total Measured and Indicated Resource of 815 Mt at 0.29% Cu, 0.032 g/t Au and 1.3 g/t Ag. Exploration geologists on the Harper Creek deposit support a volcanogenic origin for that deposit and Hoy (1997) further suggests that the EBL and other similar deposits in the area may also be of volcanogenic origin.

Almo Capital Corp set out to confirm the documentation of the original historic mineralized zone - the EBL deposit. In 2006, they initiated induced polarization (IP) and resistivity surveys which encountered a strong response over much of the 2 km by 2 km survey area. Based on this work, Almo Capital conducted a drilling program from 2008-2010 totalling 6540.75 metres in 33 diamond-drillholes. Results corroborated the original historic findings that a significant mineralized zone or zones exist on the Moore property.

Noteworthy results from the Almo Capital drill program include DDH-08-04 which intersected 177.63 metres (from 47.77 to 225.6 metres depth) of 0.2% copper with a sub-interval of 10.75 metres (from 59.65-70.4) of 0.63% copper. A 6-metre sub-interval (from 59.65 to 65.65) assayed 0.9% copper and contained 4 metres of 10.5 g/t of silver and 2 metres of 0.5 g/t gold. Near the bottom of DDH-10-04A, an 18.29-metre intersection (from 195.07-213.36) graded 0.4% copper. Drilling indicates significant mineralization is open to depth and the IP anomaly is open to the north, off the grid.

The McLellan showing on the Moore property is a relatively unexplored chalcopyrite-rich massive sulphide zone reported to be 60 metres long and 10 to 20 cm thick. It is located just east of the 2006 IP grid survey area and well east of the 2008-2009 drilling. The McLellan region represents a possible volcanogenic massive sulphide target that was not tested by 2006 geophysics or 2008-2010 drilling.

A 1.3 million dollar exploration program, consisting of IP geophysical surveying and 5000 metres of diamond drilling, is recommended for the Moore property. Approximately 4500 metres of drilling should be focused on an EBL deposit area where previous drilling (DDH-08-04) yielded significant intersections and remains open to depth. Two holes totaling 500 metres are recommended to test the possible volcanogenic massive sulphides found at the McLellan showing.

## **2 INTRODUCTION**

In June 2011, Ram Vallabh, CEO & President of Almo Capital Corp requested that the author (David G. Mark, PGeo) complete a 43-101 compliant technical report on the Moore Property by reviewing and summarizing all relevant previous work and recommending an exploration program on qualified targets. The author is familiar with the geology and exploration history of the Barriere-Adams Plateau area and has worked on exploration programs in that vicinity.

The author has visited the Moore Property several times including the following:

1. He conducted the IP/resistivity survey in 2006 during the month of July.
2. He visited the property July 11<sup>th</sup> and 12<sup>th</sup>, 2008 in order to spot the first 10 drill holes.
3. He visited the property July 22<sup>nd</sup>, and 23<sup>rd</sup> to check on the drilling and to examine the drill core done to date.
4. He visited the property on July 12<sup>th</sup>, 2012 to examine the drill sites from 2008-2010.

This report was prepared in part from data generated by the 2006 exploration programs conducted by the author (Mark, 2007). The 2006 work was done over an area with significant known mineralization, previously defined by historical drilling, and was done in order to define high quality targets for the subsequent drilling that occurred from 2008-2010. The 2006 geophysical program is summarized in Section 9 (Exploration).

The author also relied on an internal Almo Capital report by David Bridge, PGeo (2004). This report was made public by being filed on Sedar on September 10, 2004 under the company's profile. Bridge conducted a thorough literature review of all pertinent reports pertaining to significant parts of the Moore property. While the author has relied heavily on Bridge's summary of historical work (Section 6), a full review of all original source documents was completed, and because property boundaries have been expanded since Bridge's report was completed, other referenced government assessment reports were reviewed for further documentation. The author deems the original published assessment work done on the property to be of reliable quality.

Based on the broad geophysical response and subsequent drilling that yielded lengthy mineralized intercepts with strong assay values and because of observed similarity to nearby volcanogenic deposits, it is concluded that the Moore property represents a legitimate exploration target with the potential to host an economically viable mineral deposit.

### **3 RELIANCE ON OTHER EXPERTS**

This Technical Report has been prepared by David G. Mark, P.Geol, for Almo Capital Corp. The author has relied, in part, on documents and assessment reports on file with the British Columbia Ministry of Energy, Mines and Petroleum Resources and geological literature in the public domain to describe past exploration work on the property and the geological setting and general mineralization of the property. These reports are cited and listed in Section 27 (References). Where appropriate, acknowledgement of sources is included in the text.

The 2008, 2009 and 2010 drill program on the Moore property was managed by Misters Amit Kumar and Uma Shankar, neither of whom are “qualified persons”, according to National Instrument 43-101 definition. Statements have been made to the author that Mr. Kumar and Mr. Shankar each earned M.Sc. degrees in Geological Science in 2008 from the University of Lucknow at Lucknow, India. Written declarations were given to the author by Mr. Kumar and Mr. Shankar stating that no direct or indirect ownership interest in the Moore property exists nor does either expect to receive any interest directly or indirectly in the property or securities of the issuer.

Section 10 (Drilling) was derived from information in a private company summary report by Mr. Kumar (2012) and from emails from Mr. Kumar that will form a compendium in the private report kept by the author. However, **the author laid out the plan for the 2008-2010 drill site locations based on the 2006 IP program which he supervised, and he was on the property in 2008 to offer limited supervision to Mister Kumar and Skankar for the physical laying out of drillsites.** The author has reviewed the 2008-2010 drill programs documentation and believes the programs were completed with a reasonable degree of due diligence in keeping with standard exploration practices, except those stated in Section 12 (Data Verification).

This report discusses exploration potential of the Moore Property, and recommendations for further exploration. These opinions and recommendations are intended to serve as guidance for future evaluation of the property and should not be interpreted as a guarantee of success.

For information pertaining to the ownership of all Moore property tenures by Mr. Ram Vallabh, who holds the titles on behalf of Almo Capital, and the arrangement of their legal relationship to Almo Capital, the author has relied on information provided by Mr. Ram Vallabh, the CEO and President of Almo Capital Corp. Further data found on the BC provincial government’s website - Mineral Titles Online was also relied upon. To the best of the author’s knowledge and experience the data is correct. However, the author disclaims responsibility for such information.

As of the date of the report, the author is not aware of any material fact or material change with respect to the subject matter of this technical report that is not reflected in this report, the omission to disclose which would make this report misleading.

#### **4 PROPERTY DESCRIPTION AND LOCATION**

The Moore Property is located in south-central British Columbia between North Barriere Lake and East Barriere Lake about 26 km northeast of the town of Barriere, B.C., which is about 60 km north of the city of Kamloops, British Columbia (Figure 1).

The Moore Property consists of 34 contiguous mineral claims held by Ram Vallabh covering an area of 2,399 hectares (Figure 2; Table 1). The property occurs within NTS map sheet 082M/05 (TRIM map sheets 082M021, 022, 031, 032) with its center at 51° 19' 23" north latitude and 119° 46' 59" west longitude. The property boundaries occur within UTM co-ordinates 302000 and 308000 east; and 5685000 and 5692000 north.

To the author's knowledge, all mineral claims in the Moore claim group are held in the name of Ram Vallabh on behalf of Almo Capital Corp. All Moore Property claims are located on crown land and the property has not been legally surveyed. The author is not aware of any other agreements or encumbrances to which the property is subject. The author is not aware of any environmental liabilities or planned or existing land use undertakings that would adversely affect development of mineral resources on the property. Exploration permits must be obtained from the British Columbia Ministry of Energy, Mines and Petroleum Resources prior to carrying out future exploration programs.

**TABLE 1. MOORE TENURE INFORMATION**

<b>Tenure Number</b>	<b>Claim Name</b>	<b>Expiry date</b>	<b>Area (ha)</b>
217448	RED FOX #3	July 02, 2018	25
217450	BAT #1	July 02, 2018	25
217451	BAT #2	July 02, 2018	25
217452	BAT #3	July 02, 2018	25
217453	BAT #4	July 02, 2018	25
217460	LYNX #2	July 02, 2018	25
378581	BHALU 3	July 05, 2018	25
378582	BHALU 4	July 05, 2018	25
378585	BHALU 7	July 05, 2018	25
395113	MOORE #3	July 07, 2018	225
395114	MOORE #4	July 07, 2018	25
395115	MOORE #5	July 07, 2018	25
517040	MOORE#8	July 07, 2020	80.782
517082	MOORE#9	July 12, 2020	121.173

Tenure Number	Claim Name	Expiry date	Area (ha)
517119	MOORE#10	July 12, 2020	80.8
517140	MOORE#11	July 12, 2020	60.597
517168	MOORE#12	July 12, 2020	80.804
517184	MOORE#13	July 12, 2020	60.614
518010	MOORE#16	July 19, 2020	60.614
525230	RV21	January 13, 2020	121.222
525244	RV22	January 13, 2020	60.619
525269	RV23	January 13, 2020	60.608
525283	RV24	January 13, 2020	60.597
525293	RV25	January 13, 2020	60.592
543640	AP#8	August 14, 2021	40.3908
543641	AP#9	August 14, 2021	80.8292
543643	AP#10	August 14, 2021	101.0229
552008	RV#1	August 14, 2021	80.7756
552009	RV#2	August 14, 2021	60.5756
552010	RV#3	August 14, 2021	60.5752
552011	RV#4	August 14, 2021	40.3833
558354	CUMO	August 14, 2021	343.5903
568236	BHALU 9	October 18, 2021	121.1931
568237	BHALU 10	October 18, 2021	60.6298
		<b>TOTAL</b>	<b>2398.9878</b>

## **5 ACCESSIBILITY, CLIMATE, LOCAL RESOURCES, INFRASTRUCTURE AND PHYSIOGRAPHY**

The Moore Property is accessed by gravel and paved roads from the town of Barriere, BC, approximately 26 kilometers to the southwest of the property (Figure 3). Barriere is the nearest population center to the Moore Property and is about 60 km north of the city of Kamloops, British Columbia. Access to the property is via the North Barriere Lake Road 24 kilometres to the Kozy Lake Forest Service Road at the east end of North Barriere Lake. The Kozy Lake road leads 25 kilometres to the ridge top where the claims are located. A major power line and railway line passes through Barriere.

The Moore Property (Figure 2) is located in the Shuswap Highlands in central British Columbia. The property spans a ridge between East and North Barriere lakes where the higher elevations consist of rolling hills with gentle slopes. The terrain drops steeply to the north down to North Barriere Lake and south down to East Barriere Lake. The elevation varies from 627 meters above sea level on East Barriere Lake and 640 meters

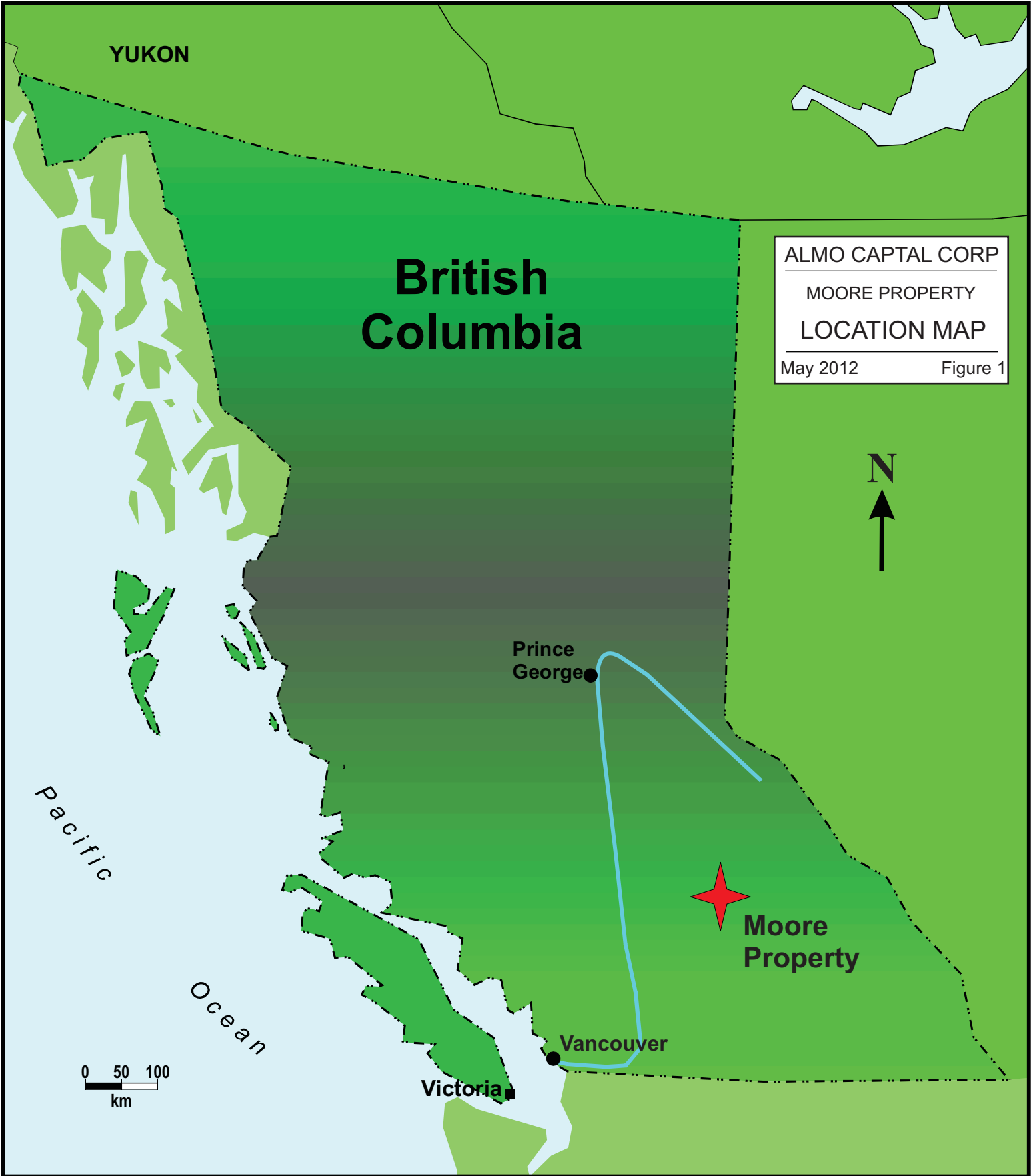

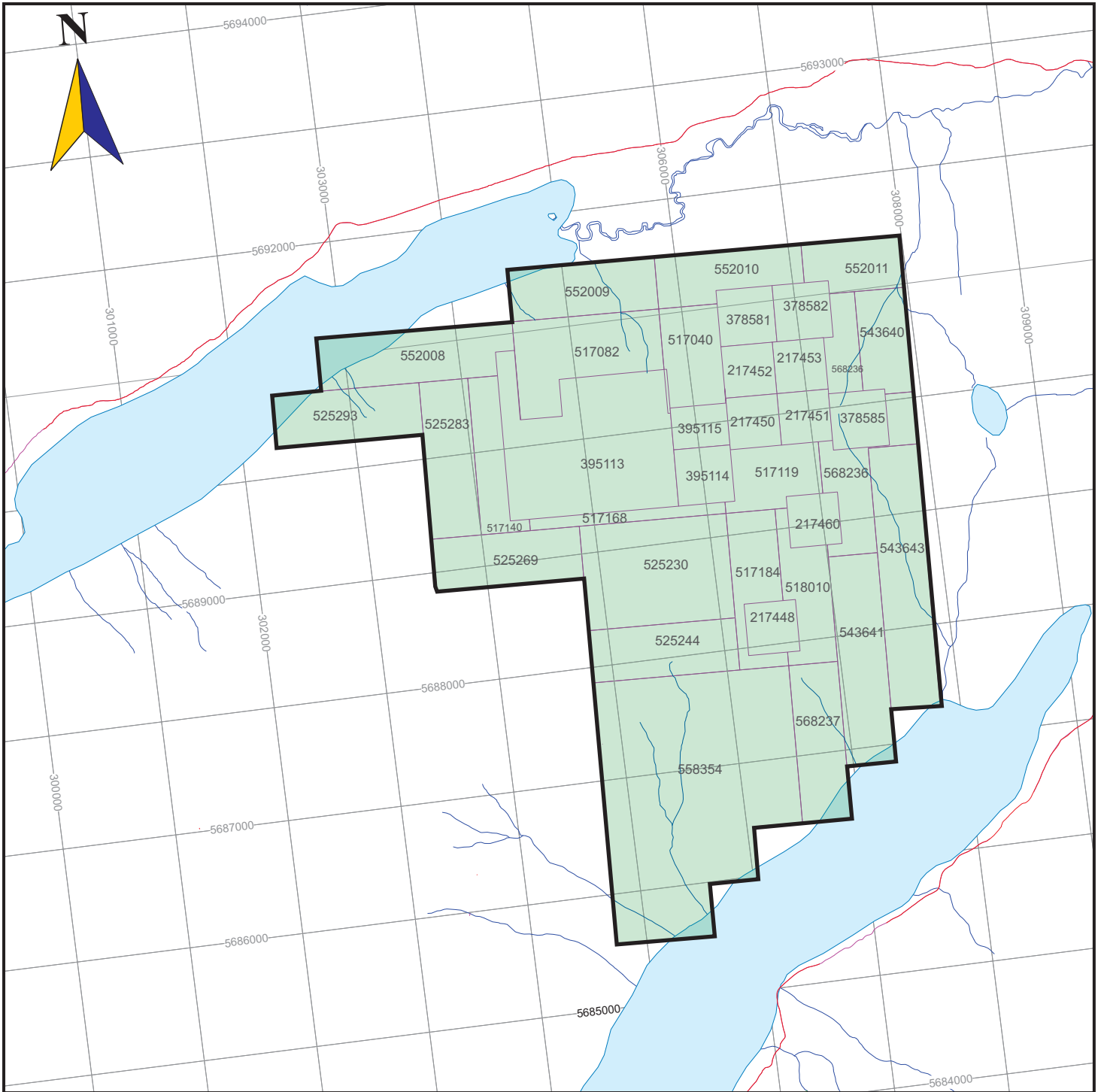

1:50000

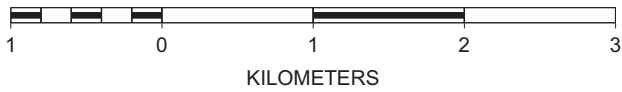

**ALMO CAPITAL CORP**  
**MOORE PROPERTY**  
**TENURE MAP**

May 2012

Figure 2

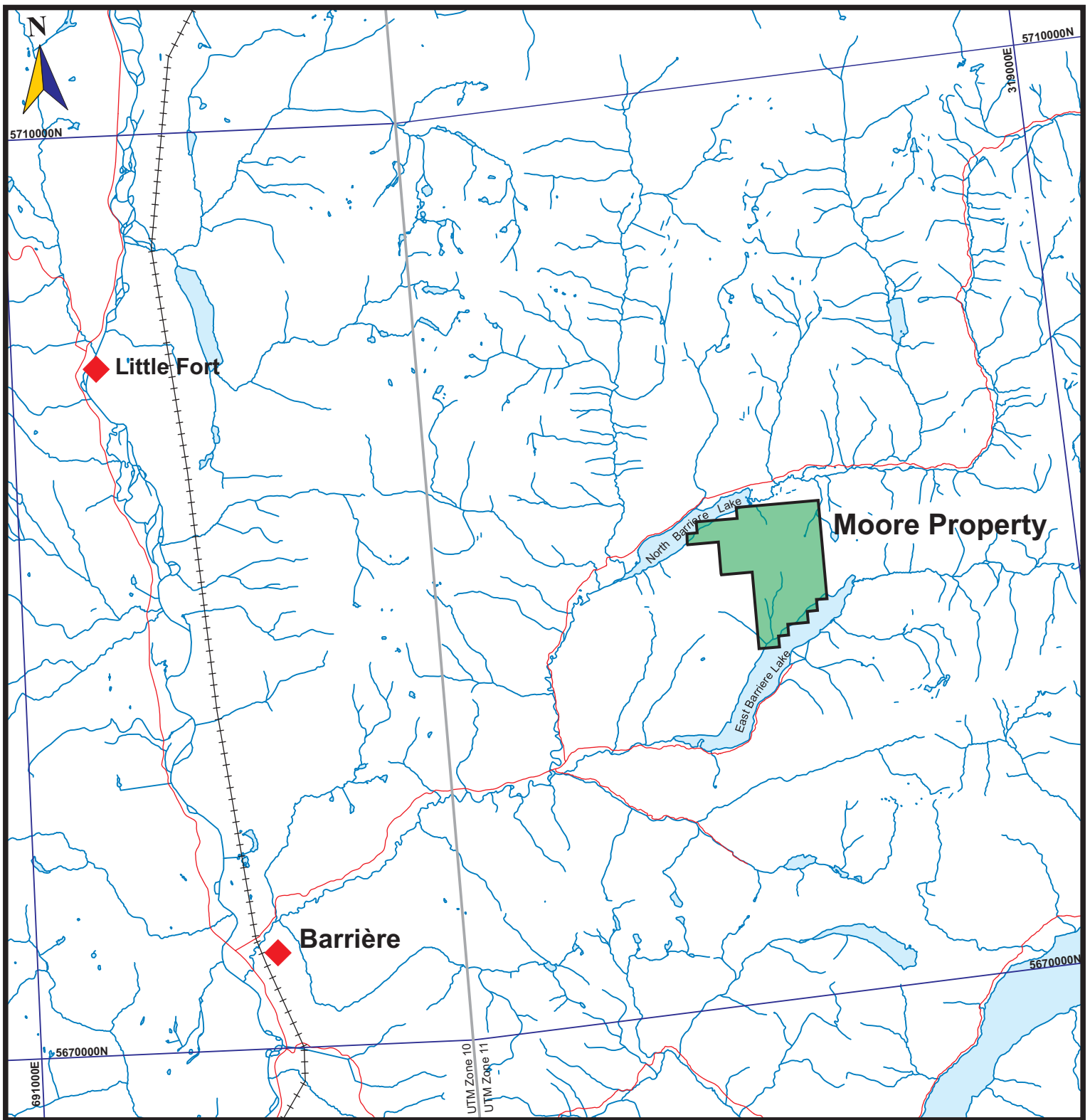

+++++ railway      ◆ town

— road

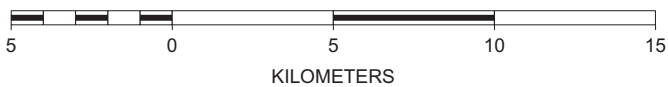

<b>Moore Property</b>	
<b>Regional Setting Map</b>	
Almo Capital Corp	
May 2012	Figure 3

on North Barriere Lake to about 1280 meters along the northeast trending ridge top. The relief is therefore almost 653 meters. There are few creeks within the property area and the main water sources would be the North Barriere and East Barriere lakes. There are a number of swamps within the centre of the claims that are often dry during summer months.

Portions of the property have been logged in the 1960s, 1980s and 1990s. These areas have been replanted with pine and fir. The remainder of the property consists of old growth stands of cedar, fir and hemlock with a large, central portion consisting of dense thickets of hemlock trees in an old burn. On the writer's recent visit to the property, he noted that the roads have been re-cleared by a logging company suggesting that logging may soon take place on the property.

The climate in the property area is typical of the south-central Interior with cold winters and warm to hot summers. Temperatures can reach 30°C in the summer months, with an average of 20°C whereas in winter they can drop to -35°C with an average of -15°C. Snowfall in winter months is moderate. Total annual precipitation is measured at 279.4 millimetres. Typically, the snow begins to accumulate in mid-October and melts in May. Field work can usually begin in May and continue through October and sometimes later.

## **6 HISTORY**

Much of the following is derived from the Canadian government National Mineral Inventory report 082M/5 Cu 1, and from Bridge, (2004) a professional geologist who summarized the early work on the Moore Property for Almo Capital Corp. The author of this report reviewed all original historical reports, added pertinent information where needed and expanded the review to include the larger tenure area that presently exists. Refer to Figure 4 for a generalized map plot of historic work areas and/or original claim boundaries referred to in this section. Appendix A includes pertinent historic maps and tables that provide background information for this section.

### **6.1 EXPLORATION BY SCURRY RAINBOW OILS AND JAMES GOURLEY AND THE MOORE BROTHERS**

Showings of copper-bearing float were discovered and staked in 1961 by James Gourley and brothers, Tom and George Moore, as a result of tracing float north from East Barriere Lake. They optioned the property to Barriere Lake Mines Ltd, who in 1966 sub-optioned it to Scurry Rainbow Oil of Calgary. Scurry Rainbow established 80 kilometres of grid over which they conducted a partial magnetometer and electromagnetic survey before dropping the option later that same year.

The claims lapsed and Gourley and the Moores restaked the showings in 1968 and 5 short packsack holes were reportedly drilled, though no locations or results are



available. The B&B claims, also owned by the Moores and Gourley, were included as part of the EBL Group a few years later and forms the northern section about 3.2 km east-west and about 1 km north-south. The claims, as documented in Assessment Report 2989 (Vollo, 1969) show the spread of the claims that include the EBL, REM, BRAD and B&B claims (Figure 4).

## **6.2 EXPLORATION BY ROYAL CANADIAN VENTURES LTD**

The Dynamic Group of Companies, operating in British Columbia in 1969 under the name of one of its members, Royal Canadian Ventures Ltd, optioned the property. Work in 1969, on the EBL, REM, and Brad groups totaling 108 claims, included a ground magnetometer survey over 19 line-kilometres, and a geochemical soil survey comprising 1500 samples. The magnetic data showed a north-northwesterly trend with a high relief area in the south which correlates to outcrops of pyrrhotite-magnetite-chalcopyrite zones in skarny amphibolite. The soil survey produced a pronounced copper anomaly with readings up to 2000 ppm, and covering an area of approximately 365 by 550 metres (Vollo, 1969). Bridge (2004) further reports in his summary that:

*“soil samples were also assayed for zinc, silver and molybdenum. Zinc values in the soil had a fairly uniform background of 50-60 ppm with an anomalous area - up to 900 ppm located immediately south of the large copper anomaly mentioned above. The zinc anomaly has been smeared in the south-southwest direction by glacial action and drainage. Silver values correlate well with copper anomalies in the soil.”*

Diamond drilling in 5 vertical AX holes totaling 670.5 metres was done at 122-metre (400-foot) centres on a broad geochemical anomaly approximately 2700 metres long by 600 metres wide. Relevant drill logs are not available but an assessment report by Thompson (1970) on the 1970 work also reported the highlights of the 1969 drilling and shows their locations on a property map; Hole EBL 69-1 assayed 0.30% copper over 36.89 meters; EBL 69-2 assayed 0.30% copper over 24.39 meters and EBL 69-4 assayed 0.44% copper over 18.90 meters. Two zones of low grade copper mineralization in highly chloritized rock were partially delineated as a result of the 1969 work.

In late 1969 Royal Canadian sub-optioned the property to Rayrock Mines Limited. Work in 1970 included geological mapping, an induced polarization (IP) survey over 41.9 kilometres (Baird, 1970), a geochemical soil survey (441 samples), and 888 metres of percussion drilling in 12 holes on EBL 27-32, 37, 40, and Rem 16 and 18 (Thompson, 1970). The soil samples were assayed for copper and molybdenum. Assays of the soil samples yielded 3 to 1750 ppm copper and 0.5 to 42 ppm molybdenum. Surveys had been directed towards finding a porphyry copper deposit. The most significant drill intersection averaged 0.35% copper over a core length of 64.6 metres. Based on the 1969 and 1970 drilling, a

substantial tonnage of low-grade copper mineralization was reported to have been “proven up” by Royal Canadian Ventures. This statement was derived from the Canadian government National Mineral Inventory report #82M/5 Cu1 which referenced Royal Canadian Ventures Annual Report for 1970. Rayrock subsequently dropped the option. Appendix A provides a map and table from Bridge (2004) that shows the 1969 and 1970 drill hole locations with assay highlights.

Geological mapping and magnetic and geochemical surveys were also completed by Royal Canadian Ventures in 1970 on the B&B claims (Vollo, 1970). Approximately 280 soils were collected over 18 kilometres of grid. Copper and zinc values were reported to be high in greenstone around feldspar porphyry and quartz porphyry dikes.

### **6.3 EXPLORATION BY NORANDA EXPLORATION COMPANY AND CRAIGMONT MINES LIMITED**

In 1971 Royal Canadian sub-optioned the property to Noranda Exploration Company, Limited. Work by Noranda included: a geochemical soil survey where 394 samples were analyzed for copper, zinc and molybdenum; an electromagnetic survey over 15.1 line-kilometres; a magnetometer survey over 27.7 line-kilometres covering the EBL, REM, and B&B groups; and 1973.5 meters of diamond drilling in 17 holes on REM 15, 18, EBL 29-32, and B&B 7, 12, 14 (BC Ministry of Mines, Geology, Exploration and Mining 1971). A large copper anomaly was outlined on the steep northerly dipping slope. A few scattered zinc values were roughly coincident with the copper anomaly. No attempt was made to determine gold and silver mineralization. Brynson et al., (1971), the authors of the assessment report filed on the 1971 work done by Noranda, did not report on the drilling and no further data on it is available.

Noranda gave up the option in 1971 and Pan Ocean Oil Corporation Limited acquired the assets of The Dynamic Group of Companies in the same year. Craigmont Mines Limited in 1972 sub-optioned from Pan Ocean the EBL, REM, BRAD, Snark, EL, NLSS, and B&B groups totalling 162 claims. Work by Craigmont during the year included induced polarization and resistivity surveys over 6.4 line-kilometres covering parts of the EBL, B&B, and NLSS groups (Hallop and Smith, 1972 and Figure 4). The survey outlined an approximately 1220 meter long by 122 meters wide induced polarization anomaly which was not examined in detail. Diamond drilling totalling 2106 metres in 17 holes was done on the EBL and B&B groups (BC Ministry of Mines, Geology, Exploration and Mining 1972). Pan Ocean gave up their option agreement with the original owners in 1973.

The author believes that it is likely that 17 holes drilled by Noranda in 1971 and the 17 by Craigmont in 1972 are the same and the duplication is some form of

reporting error. Regardless, Craigmont reports solely on the 1972 IP work in its assessment report (Halloy and Smith, 1972).

#### **6.4 EXPLORATION BY WESTERN MINES LIMITED**

Western Mines Limited optioned the property in 1973 and carried out airborne electromagnetic and magnetometer surveys over 129 line-kilometres covering part of the EBL group and all of the REM, BRAD, and Snark groups (Misener and Mullan, 1973). Two anomalies were discovered during the survey. Anomaly 1 was located approximately 1220 meters south of North Barriere Lake and it had weak to moderate conductivity over a strike length of 400 meters. Anomaly 2 is located 1.6 kilometers north of East Barriere Lake and it has a weak response with moderate conductivity. Further work by Western Mines in 1974 included geological mapping, a magnetometer survey over about 1.6 line-kilometres on EBL 16-18 and REM 1-6, and 886 metres of diamond drilling in 6 holes on EBL 16, 18, 32, and REM 5 (BC Ministry of Mines, Geology, Exploration and Mining 1974, page 97). This work failed to expand the known mineralization and the option was terminated. No assessment was filed on the drilling and no information on it is available.

#### **6.5 EXPLORATION BY KENNCO EXPLORATIONS (WESTERN) LIMITED**

In 1976, Kennco Explorations (Western) Limited acquired an option on the property from owners R. and C. Moore and J. Gourley. A geochemical soil survey (99 samples) was carried out over REM 5, 6, 15, 16 and EBL 16 (Gower and Stevenson, 1976). Sampling was done over known massive pyrrhotite-magnetite-chalcopyrite skarn mineralization. A total of 99 soils were collected and analyzed for copper, lead, zinc and silver. The soils yielded metal values of 19 to 930 ppm copper, 34 to 390 ppm zinc, 17 to 195 ppm lead and 0.7 to 5.8 ppm silver. The higher copper values in the soil roughly coincided with the suspected trend of the mineralization. Several high silver values (up to 5.8 ppm) were found in vicinity of the outcroppings of known skarn mineralization. The option was given up.

#### **6.6 EXPLORATION BY ESSO RESOURCES CANADA LIMITED**

In 1978, Esso Resources Canada Limited explored in the northwest part of the present Moore property on their Lesly and TG1 claims (Stewart, 1979 and (Figure 4)). The company conducted electromagnetic, magnetometer and soil surveys over 7.5 km of grid. A total of 313 soil samples were collected. A 92.5 metre AQ diamond drillhole was drilled northwards at 70 degrees dip. The best reported assay was 0.16% copper over 0.90 meters with no significant values for lead, zinc or silver.

## 6.7 EXPLORATION BY NORTHCOTE

Years 1981, 1982, 1983, 1985 and 1986

During 1981, George Moore was the claim owner of the property. K.E. Northcote reviewed the drill core of hole 74-6, presumably drilled by Western Mines Limited in 1974, but who failed to file assessment on the holes (Northcote 1981). Drill logs indicate 4.3 metres of massive sulphide (from 29.56-33.83 metres) consisting of pyrite, pyrrhotite and chalcopyrite. Northcote's map shows hole 74-6 to be found about midway between previous drillholes 70-5 and 70-6. During the winter of 1981/1982 the drill core stored on the property from previous drill programs was accidentally bulldozed and the core was spilled and made unusable.

Two days were spent by J. Gourlay and G. Moore prospecting on the claims in late 1981 with two samples (82-K-1 and 82-K-2) being assayed; Northcote completed petrographic examination of 17 thin sections and 9 polished thin sections of core and hand samples collected in 1981 (Northcote, 1982a). Altered quartz diorite float (82-K-1) assayed 0.10 oz/ton gold and 0.70% copper, 0.08% lead, 0.07% zinc, 0.02% nickel and 0.08 oz/ton. Another float sample of massive galena yielded 15.66 oz/ton silver, 32.63% lead, 0.08 oz/ton gold and 1.5% zinc. Later in 1982 he re-examined two old drill holes NE2 and NE8 from the property (See Appendix A (Bridge's Figure 6) of hole location) and collected 15 mineralized samples from the core and had them analyzed for gold, silver, lead and zinc (Northcote, 1982b). A sample of quartz and minor carbonate veins from NE2 at 51.8 meters assayed 55 ppb gold, 5.6 ppm silver and 178 ppm zinc. Other than what appears in Northcote (1982b), no other information is available on the NE drillholes.

During 1983, Northcote supervised a small hand trenching, blasting and sampling program at three sites along newly constructed logging roads (Figure 4) (Northcote, 1983). He also conducted a limited VLF-EM and magnetometer survey of the area. 16 chip samples were submitted for gold and silver assays which yielded modest gold and silver values.

In 1986, Northcote collected 17 soil samples and 16 rock samples along a road where George Moore had picked up a piece of mineralized float in 1981 that assayed 0.1 oz/t gold and 0.70% copper (Northcote, 1986). The soil samples yielded gold values of 1 to 19 ppb gold and 0.5 to 4.0 ppm silver and the rock samples assayed 1 to 137 ppb gold and 0.3 to 8.0 ppm silver. A sample of granular schist float composed of chlorite, biotite, and quartz with strongly disseminated pyrite and chalcopyrite assayed 137 ppb gold and 8.0 ppm silver.

## 6.8 ADON CLAIMS - SOUTHERN AREA

In 1983, a southwest portion of what is now covered by Moore tenures was restaked as the ADON claims by Whopper Holdings Ltd. Figure 4 shows the general outline of the Whopper ground. Titan Resources Ltd optioned the property in 1984 and worked on it through to 1986. Only some northeastern parts of the lapsed Adon Property are within the present Moore tenures.

In 1984, Titan conducted a reconnaissance soil sampling survey. Samples of the "B" horizon were taken along lines following the contours at intervals of approximately 100 metres. Silt samples were taken of all the major drainage systems traversed. A total of 569 soil and 53 silt samples were taken in all (Leishman and Dawson, 1984). On parts of the Adon property north of East Barriere Lake, it was reported that a large zone of northwesterly trending, roughly coincident anomalous copper, lead and zinc occurs, along with several clusters of silver values.

In 1985, Titan followed up with a gridded geochemical and magnetometer survey, of which more than half appears to be located on the southwest part of the area presently held by Almo Capital as the Moore Property (Yeager *et al.*, 1986). Geochemical soil sampling and geophysical EM-16 and magnetometer surveys were completed on portions of the grid, primarily on the Adon V claim. A total of 616 geochemical soil samples were collected from the 'Adon' grid. Lead and copper showed three broad and elongate anomalous zones trending across the sampled area. The first two anomalies are lead anomalies and, being located on the northwest portion of the grid, may be all or partly off the Moore property. The third anomaly is a strong north trending copper anomaly on the eastern half of the grid and appears to be wholly within the current Moore tenures. Occasional silver spot highs occur.

In 1986 Titan continued working on their Adon project with specific work on their Sobs grid south of East Barrier Lake and the Adon Grid north of East Barrier Lake. Geological mapping and prospecting was conducted on the ADON II and V, much of which occurred on the tenure held presently as the Moore Property. This work was conducted to search for the Ruth showing which is listed in the provincial database (MINFILE) and provided in Section 9 (Mineralization). The showing was not found and was deemed to have been mislocated in MINFILE. Several massive sulphide boulders, one of which was a breccia, were discovered in a major drainage while in search of the Ruth showing. The boulders found were extremely well oxidized and crumbly and therefore, could not have travelled far. The float consisted of massive pyrrhotite, pyrite and chalcopyrite with quartz and chlorite alteration. One possible source of the float was discovered on a logging road cut and was named the NSM showing.

In 1987, Runaway Resources Ltd was the operator of the same Adon tenure that Titan Resources previously held. Runaway conducted some 30 kilometers of IP surveying, 25 km of ground magnetometer and VLF-EM surveying and collected 498 soil samples; the work was divided between the Adon grid (on the present Moore tenures) and the Sob grid, south of East Barriere Lake and off the Moore Property. Runaway extended the Adon grid to the southeast in order to aid in extending the NSM showing, found in 1986.

White (1987 and 1988) quotes an unpublished company report from G.H. Rayner (1986), for Runaway Resources Ltd., on the Adon mineralization:

*“Mineralized exposure on the ADON grid consists primarily of the newly located NSM showing and related float occurrences. The rubble exposure of apparently strata-bound pyrrhotite-chalcopyrite mineralization bounded by quartz-sericite schist requires thorough trenching and sampling.”*

White (1987) provides a very general plot location for the NSM showing and the author of this report estimates a UTM coordinate location for it of: 306160E, 5687044N. See Section 7.3 (Mineralization) for more information on the NSM showing.

White (1987) reports on the 1987 geophysical program on the Adon grid and the NSM showing:

*“the showing occurs on the flank of a strong magnetic high which reaches some 1000 gammas above background. Directly coincident with this feature is an excellent VLF electromagnetic conductor some 300 meters long and a well defined anomalous chargeability zone of equal length. This zone is a high priority diamond drill target. The apparent resistivity data which is a function of near surface soil and rock physical characteristics shows a southeasterly trending apparent resistivity low associated with the showing”*

White (1988) comments further on the Adon grid and the 1987 soil survey:

*“Copper geochemical values were definitely anomalous with several stations giving assays of over 200 ppm above a background of 15 to 20 ppm. The high values are associated with good induced polarization chargeability responses. This confirms the extension of the NSM showing to the southeast.”*

## **6.9 GEM CLAIMS**

The GEM claims were located in order to explore for an extension to a strong VLF anomaly discovered on a claim owned by Larry Ovington. A small portion of the 1986 survey occurs on a small, relatively unexplored area of the present Moore tenures, along its western edge (Figure 4). Work consisted of laying out a string

and flag grid with 25-metre station spacing and lines 100 metres apart, for a total of 6.15 km. (Moraal, 1986). A VLF electromagnetic survey was completed. Strong VLF readings were obtained and three anomalous zones (conductors) on the GEM grid were outlined. Follow-up exploration was recommended but none is documented.

#### **6.10 McLELLAN**

The McLellan massive sulphide prospect occurs just east of the area that was part of the original Moore Property (Bridge, 2004) but was contained within the original EBL group boundaries (Figure 4). No previous history of work on the sulphide zone is known prior to 1989.

The McLellan massive sulphide prospect was located in 1989 by Mr. Alvin McLellan while building logging roads. Chalcopyrite grab samples taken in 1989 produced analyses of 8.65% and 4.25% copper, 34.24 g/t and 19.19 g/t silver, and minor gold, lead and zinc (Topham, 1991).

Work in 1990 by owner Rea Gold Corporation included 32.9 kilometres of cut grid and collection of 1053 soil samples. The soil geochemical survey outlines two mineralized areas, a lead-zinc zone with possible gold potential to the north, and a larger copper-barium zone to the south. The southern zone is open to the south, but appears to be truncated immediately north of the discovery showing.

Follow-up work in 1990 consisted of five trenches totalling 413 metres to investigate the southern zone (Goodall, 1991). The northern zone was not tested due to difficulty of access. The five trenches were excavated to depths of one to four metres. The program was designed to test the strike extent of a chalcopyrite-rich, massive sulphide zone exposed in a road cut on the now lapsed EB 4 claim as well as to explore for other mineralized zones near Kozy Lake. A total of 1600 cubic metres of overburden was removed. One hundred and fifty-three rock samples were collected.

The sulphide horizon was uncovered in Trench 4, fifty metres south of the discovery outcrop exposed in Trench 5 and coincides with foliated, copper-bearing schist in Trench 3. The zone was not exposed in Trench 2. The sulphide horizon was thought to be disappearing to the north and continuing southwards. Downdip dimensions are unknown and there is no apparent thickening of the horizon southwards along strike beyond Trench 4. The zone is reported to be 60 metres long and 10 to 20 cm thick, containing about 1% copper. Further exploration was recommended in order to further define its dimensions southward.

### **6.11 WORK BY AGATE BAY (1993)**

In 1993, an option agreement between Agate Bay Resources and Andrew Harmon was signed with respect to the Norr and Barr claims which had been located in the EBL showing area. However, Mr. Harmon had erroneously overstaked the northern part of the still-active Moore tenures, held by Ram Vallabh and investors. In 1993, Agate Bay carried out limited soil sampling and ground EM surveys in an attempt to locate the source of mineralized boulders (Assessment Report 23343). Some follow-up trenching was done but no assay results are known.

### **6.12 WORK BY VALLABH (1987 - 2001)**

In 1987, Mr. Ram Vallabh with other investors acquired the property from original owner (Mr Moore) for a reported sum of \$130,000. Some soil sampling and geological mapping was reported to have been carried out in 1987 and 1994 and a program of soil sampling and geological mapping was conducted in 2001 (Bridge, 2001). A sample from a mineralized outcrop containing quartz veins with oxidized chalcopyrite and pyrite assayed 0.472% copper.

The Moore tenures are held by Ram Vallabh on behalf of Almo Capital of which Mr. Vallabh is currently the CEO and President. Almo Capital Corp was formed in 1999 and is presently listed on the TSX Venture Exchange. Subsequent work on the Moore Tenures by Almo Capital Corp is discussed in Section 10 (Exploration) and Section 11 (Drilling).

## **7 GEOLOGICAL SETTING AND MINERALIZATION**

The Regional Geology (below) section is taken in whole from Schiarizza and Preto (1987) and the Property Geology is sourced from Bridge (2004), except where otherwise indicated.

### **7.1 REGIONAL GEOLOGY**

The map area covers complex low grade metamorphic rocks which lie along the western margin of the Omineca Belt; it is flanked by high-grade metamorphic rocks of the Shuswap Complex to the east and by rocks of the Intermontane Belt to the west. The area is underlain mainly by Paleozoic metasedimentary and metavolcanic rocks of the Eagle Bay Assemblage and Fennell Formation. Late Devonian granitic orthogneiss locally intrudes Eagle Bay rocks. The Paleozoic rocks are cut by mid-Cretaceous granodiorite and quartz monzonite of the Raft and Baldy batholiths, and by Early Tertiary quartz feldspar porphyry, basalt and lamprophyre dykes. They are locally overlain by Eocene sedimentary and volcanic rocks of the Kamloops Group and by Miocene plateau lavas.

# PROPERTY GEOLOGY

## MOORE PROPERTY

Almo Capital Corp.

Figure 5

1:50000

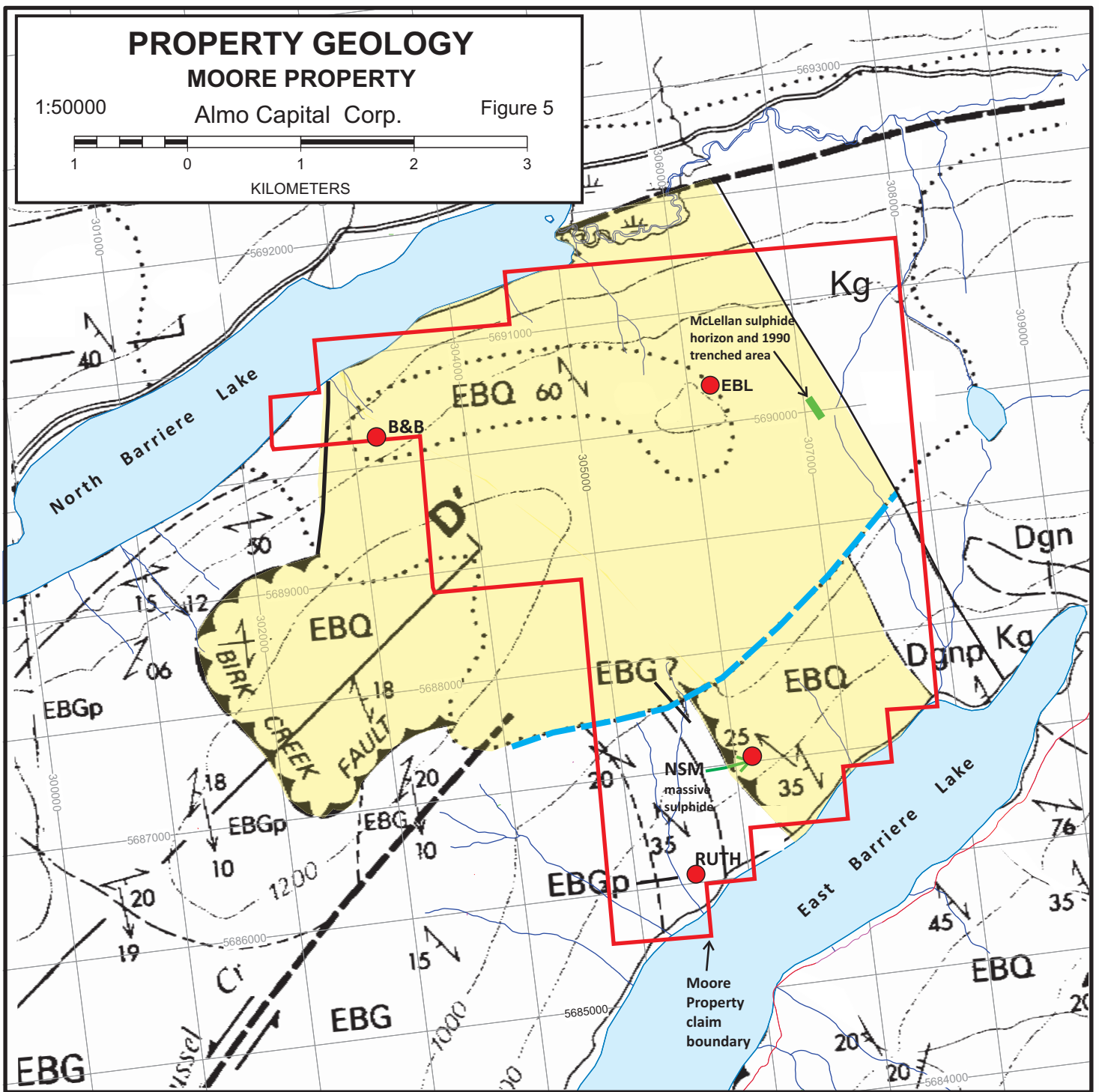
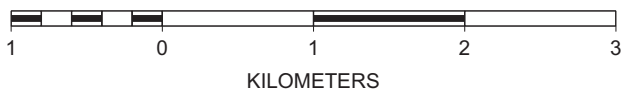

### Cretaceous

**Kg** Granite and granodiorite: Kgp - includes abundant pegmatite as well as foliated granitic rocks of possible older age

### Upper Proterozoic to Lower Cambrian (Eagle Bay Assemblage)

**EBQ** Light to dark grey quartzite, micaceous quartzite, grit, chortite-muscovite-quartz schist and phyllite; lesser amounts of calcareous phyllite, calc-silicate, schist, carbonate and green chlorite schist; eastern exposures include staurolite-garnet-mica schist and amphibolite; EBQl - limestone; EBQgn - includes orthogneiss of unit Dgn, as well as sericite-quartz phyllite derived from quartz porphyry dikes and sills

**EBG** Medium to dark green calcareous chlorite schist, fragmental schist and greenstone derived largely from mafic to intermediate volcanic and volcanoclastic rocks; lesser amounts of limestone and dolostone; minor amounts of quartzite, grit and light to dark grey phyllite; EBGp - dark grey phyllite, calcareous phyllite and limestone; minor amounts of rusty weathering carbonate-sericite-quartz phyllite (metatuff?);

### Late Devonian

**Dgn** Granite and granodiorite orthogneiss: Dgnp – includes sillimanite-bearing paragneiss

Geology base from Schiarizza and Preto (1987),  
modified from provincial website - MapPlace (2005) compilation

● Mineral Occurrence (MINFILE)

## 7.2 PROPERTY GEOLOGY

The property is mainly underlain by the rock unit EBQ which consists of micaceous quartzite, grit, phyllite and quartz mica schist (Schiarizza and Preto, 1987; Figure 5). Upper portions of this unit consist of chlorite schist, limestone, calcareous phyllite, calc-silicate schist and amphibolite. Unit EBQ rests upon orthogneiss exposed southeast, and it is bounded to the west by the northeast dipping Birk Creek thrust fault. Mineralization occurs in the Eagle Bay Assemblage.

The geology of the Moore Property is dominated by an interbedded package of green chlorite schist with schistose argillite and quartz sericite schist (Figure X map from Bridge. Small lenses of marble and skarn occur throughout the interbedded package. This package of rocks may represent bimodal volcanism in an aqueous environment. Towards the east and north of the center of the property the schistose rocks are replaced by biotite orthogneiss which underlies the schists. The metamorphic grade increases from greenschist in the west to amphibolite in the east. Notes from the examination of drill holes by Northcote (1981) indicate the schistose rocks are cut by foliated quartz diorite dykes.

Disseminated chalcopyrite, pyrite and pyrrhotite is seen in many outcrops within the property. Float with sulphide mineralization has also been found in many places. Massive copper sulphide mineralization is reported to occur along the shore of North Barriere Lake.

Two relatively undeformed quartz diorite stocks are exposed in the south-eastern part of the property where they host white quartz veins. These intrusions are thought to be related to the Cretaceous granodiorite Baldy batholith. Feldspar porphyry dykes have been identified in drill core and are thought to represent a dyke swarm from the Baldy batholith (Baird, 1970). Fine-grained basaltic dykes have been also observed in drill core and are thought to be Tertiary in age (Baird, 1970).

The structure of the interbedded schists is complex with many overturned isoclinal folds, and is not yet fully understood. The foliation generally strikes to the northwest with a 25 to 45 degree dip to the southwest. In the north - central part of the property the schists have a crenulation cleavage striking northeasterly.

### **Discussion**

Paul Schiarizza of the BC Geological Survey Branch who conducted original mapping in the region commented as to why Eagle Bay Assemblage rocks in the area of the Moore Property's EBL occurrence were assigned or reassigned from unit EBG (Preliminary Map 56) to the EBQ unit (personal communication, 2011). Schiarizza states that descriptions of old drillcore from the EBL property showed a *"similarity to rocks in the same structural panel on the north side of Baldy Batholith, near*

*the Harper Creek deposit where EBQ is overlain by felsic metavolcanic rocks and intruded by granodioritic orthogneiss and foliated quartz-feldspar porphyry dikes. Regionally, unit EBQ is mostly quartzites, phyllites and related metasedimentary rocks, but locally it has a fair bit of chloritic schist (mafic volcanics and/or metasediments)."*

Schiarrizza further stated that the rocks in the EBL deposit area fitted better with the EBQ unit because "in addition to chlorite schists, they also include phyllites of possible metasedimentary origin, are intruded by orthogneiss, as is the main belt of EBQ to the southeast, and include some felsic phyllites that might have a felsic volcanic origin (unit EBG does not contain much or any felsic volcanics, but EBQ includes sills and dikes of felsic volcanic origin and is overlain by felsic volcanic schists)."

### **7.3 MINERALIZATION**

David Bridge (PGeo) worked on the Moore Property in 2001 and later compiled a private company summary report. Pertinent maps and figures referenced by Bridge are found in Appendix X. It is Bridge (2004) that reports two styles of mineralization on the Moore Property: (i) Kuroko volcanogenic massive sulphide copper veins and (ii) skarn pyrrhotite - magnetite - chalcopyrite masses.

*"Kuroko style of mineralization has been intersected in drill holes in the Bat #1 to #4 and Red Fox #1 to #2 mineral claims and on surface in the Bat #2 mineral claim (Figures 7A and 7b (in Appendix A (pertinent maps from Bridge report)). The mineralization is hosted by chlorite schists and argillites as pyrite and/or pyrrhotite and/or chalcopyrite - quartz veins. The mineralization deepens towards the south. Minor amounts of gold occur with metamorphosed quartz diorite dykes intruding the chlorite schists. This mineralization has a possible strike length of 3200 meters and has up to 65 meters of apparent thickness which is open at depth.*

*Skarn mineralization is known to occur on the Lynx #1 to #4, Red Fox #3 to #4, Bhalu 9, Ram #10 to #15 and Moore 2 mineral claims. The skarn occurs in chloritic rock or chlorite schist with quartz, epidote, garnet injected by narrow quartz-rich dykes. The skarn is mineralized with pyrite, pyrrhotite, magnetite, chalcopyrite as scattered blebs, irregular wisps and disseminated to massive throughout the rock matrix. Massive magnetite outcrop has been identified within the property."*

While Bridge interprets the massive sulphide as Kuroko-type volcanogenic in origin, it should be noted that others, such as Schiarrizza, still lean toward a deformed, remobilized copper porphyry model. See Section 8 (Deposit Type) for further details.

The following 4 mineral occurrence descriptions (EBL, B&B, Ruth and Adon V) are taken from MINFILE, the BC provincial mineral occurrence database and represent

discrete areas of significant mineralization that were examined or explored in the recent past. See Figure 5 for a plot of these occurrences on the Moore property. Further information on mineralization can be found in Section 6 (History) and Section 11 (Drilling).

#### **7.3.1 EBL (082M 051)**

Pyrite, pyrrhotite and lesser chalcopyrite occur over a 2.7 kilometre north-northwest strike length as disseminations and massive zones along foliation planes, as fracture fillings and within quartz- calcite veins. This type of mineralization occurs within a variety of lithologies but is most abundant within chloritic schists. Pyrrhotite-pyrite-chalcopyrite-magnetite mineralization within garnet- epidote-chlorite-quartz skarn also occurs, associated with amphibole and limestone. Massive sulphide mineralization, up to a metre thick, occurs within a gossan zone 50 metres in length. Local foliation strikes north-northwest and dips 25 degrees westerly. Similar massive sulphide mineralization occurs over 4.3 metres in DDH 74-6, 1700 metres north-northwest of the gossan zone (Northcote, 1981). Several earlier, nearby drill holes intersected good copper mineralization, one of which assayed 0.35 per cent copper over 65 metres (Assessment Report 2989). This hole, P70-9, lies 250 metres north-northwest of DDH 74-6.

Mineralization on the EBL property is similar to that on the Harper Creek property, 20 kilometres north, on the north edge of the Baldy Batholith. (See Section 8 (Deposit Types (Type 2))). Recent mapping (Scharizza, 1986) indicates that the Harper Creek deposit occurs near the contact between a metasedimentary sequence, possible equivalent to unit EBQ and overlying felsic metavolcanic rocks of unit EBA. Both units are intruded by Devonian orthogneiss and quartz porphyry sills, which may relate to mineralization.

#### **7.3.2 B&B (082M 110)**

Pyrite, chalcopyrite and pyrrhotite mineralization is disseminated and semi-massive within felsic to intermediate metavolcanics and graphitic argillite. Mineralization occurs along the south shore of North Barriere Lake and was intersected in a drill hole 750 metres south east of the lake. The best intersection in the drill hole was 0.16 per cent copper over 1.5 metres at 82 metres depth (Assessment Report 7254).

#### **7.3.3 Ruth (082M 061)**

Scattered chalcopyrite, galena and sphalerite occurs in quartz veins within metasediments. A 76 centimetre drill core sample assayed 8.84 per cent zinc, 4.71 per cent lead, 0.17 per cent copper, 144 grams per tonne silver and 0.34 grams per tonne gold (Property File, Moore, 1966).

#### **7.3.4 NSM (082M 223) south of Barrier Lake**

At the NSM showing, approximately 15 metres of sulphide mineralization are exposed in a road cut. The zone is stratabound and bounded by a foliated quartz-sericite schist. The surface trace follows a 150 degree bearing with a moderate westerly dip. True width of zone would exceed 3 metres. Sulphides in order of abundance are pyrrhotite, pyrite, and chalcopyrite. The sulphides exhibit a fine-grained sugary texture and may be banded. Quartz and chlorite are the main gangue minerals with lesser amounts of garnet, magnetite and amphibole. The mineral assemblage described is indicative of skarn mineralization but workers on the showing in 1986 suggested a possible volcanic origin in light of the volcanogenic massive sulphide deposits in the area.

#### **7.3.5 McLellan**

The McLellan copper-silver massive sulphide occurrence is lumped with the EBL MINFILE description but was explored separately in 1989 and 1990. It is about 500 metres east of the EBL area and is described in the Section 6 (History).

### **8 DEPOSIT TYPES**

Schiarizza (personal communication, 2012) recently confirmed his opinion that the Moore property's EBL deposit is likely a metamorphosed and deformed porphyry copper deposit and should remain under the Type 2 deposit heading below, which also originally included the Harper Creek deposit. Hoy (1997) and the present owners of the Harper Creek deposit (Yellowhead Mining Inc), located north of EBL, support a volcanogenic-related origin for the Harper Creek deposit and Hoy further suggests that the EBL and other deposits in the area with similarities to the Harper Creek deposit, may therefore also be of volcanogenic origin.

The following paragraphs are taken in whole from Schiarrizza and Preto (1987) who summarized the deposit types found in the area. The reader is referred to the source document

([www.empr.gov.bc.ca/Mining/Geoscience/PublicationsCatalogue/Papers/Pages/1987-2.aspx](http://www.empr.gov.bc.ca/Mining/Geoscience/PublicationsCatalogue/Papers/Pages/1987-2.aspx)) and to the web-based provincial mineral deposit database (MINFILE) ([www.minfile.gov.bc.ca](http://www.minfile.gov.bc.ca)) for a discussion of map units and mineral occurrences referred to in this section.

#### **8.1 TYPE 1 DEPOSITS**

Type 1 deposits are **stratabound, massive to semimassive sulphides** containing mainly silver, lead and zinc. Most of them occur on Adams Plateau where they are hosted by a succession consisting of siliceous and graphitic phyllite, limestone and talc-silicate rocks (Unit EBGs) within the dominantly mafic volcanic package of (Lower Cambrian Unit EBG. Similar deposits occur in the vicinity of Mount

McClennan (Red Top 082M 044), Snow (082M 045) and Sunrise (082M 046) showings) within a lithologically similar succession of rocks in the upper part of Unit EBQ. The two mineralized intervals are tentatively correlated and are probably of early Cambrian age.

## 8.2 TYPE 2 DEPOSITS

Type 2 deposits consist mainly of **disseminated pyrite-pyrrhotite-chalcopyrite** mineralization. The Harper Creek (082M 009) deposit, with (Measured and Indicated resource at a 0.2% copper cut-off grade stands at 815Mt at 0.29% Cu, 0.032 g/t Au and 1.3 g/t Ag), is the main representative of this type of mineralization; similar mineralization occurs at the Lydia (082M 008), **EBL (082M 051)**, VM (082M 109) and VAV (082M 151) showings. These showings occur within the third Eagle Bay fault slice, in Unit EBA or underlying rocks of Unit EBQ. In all cases the mineralized rocks are intruded by Devonian orthogneiss of Unit Dgn. Although the mineralization has been remobilized during Mesozoic and Tertiary events it is probably Devonian in age and related to intrusion of the orthogneiss.

## 8.3 TYPE 3 DEPOSITS

Type 3 deposits comprise **polymetallic precious and base metal-bearing massive sulphides**, sometimes with barite, within Devono-Mississippian felsic to intermediate metavolcanic rocks of Units EBA and EBF. They include the Homestake (082M 025) occurrence and a number of smaller showings within the same belt between Johnson Creek and Squaam Bay; the Beca (082M 024) and Joe prospects on the southeast shore of Adams Lake; the Copper Cliff (082M 220), Rainbow (082M 221), CC (082M 059), May 082M 131), Broken Ridge (082M 130) and Harper (082M 060) properties in the Birk Creek area; and the recently discovered Rea deposit which occurs within Unit EBF southwest of Johnson Lake. The Fortuna showing, which is hosted by a felsic volcanic lens within Unit EBS metasediments near the junction of Fraser and Louis creeks, also appears to be of this type. There is potential for similar mineralization within Devonian felsic volcanic rocks of the Fennell Formation, but none has been discovered to date.

## 8.4 TYPE 4 DEPOSITS

Type 4 mineralization is represented by the Rexspar (082M 0021) and Bullion (082M 034) deposits. It comprises **uranium-thorium-bearing pyrite-fluorite replacements** associated with trachytic intrusive and extrusive rocks of Unit EBF, on the east side of Foghorn Creek.

## **8.5 TYPE 5 DEPOSITS**

Type 5 mineralization consists of massive cupriferous pyrite within oceanic basalts of the Fennell Formation. This type of mineralization is well represented only by the CC (092P 140) deposit within the upper Fennell Formation just east of Chu Chua Mountain. A small copper-magnetite showing (092P 101) in upper Fennell basalts on lower Newhykulston Creek may be of similar origin.

Most other deposits in the area are veins, although small pods of skarn mineralization occur locally near Cretaceous and Devonian granitic intrusions. The vein deposits contain mainly silver-lead-zinc mineralization, but the Windpass (092P 039), Sweet Home (092P 040) and Gold Hill (092P 041) prospects are gold-bearing veins, and molybdenum-bearing veins occur adjacent to the Baldy batholith at the Judy showings.

## **9 EXPLORATION**

The work discussed in this section is that conducted by Almo Capital Corp, other than drilling which is discussed in Section 10. All other work, including work by Ram Vallabh before 2006, is discussed in Section 6 (History).

The following paragraphs of Section 9 were derived in whole from an assessment report by the author (Mark, 2007) that reports on the 2006 geophysical work program. The reader is directed to the source document for all supporting data, including IP and Resistivity plots.

### **9.1 2006 WORK PROGRAM**

Induced polarization (IP) and resistivity surveys were carried out during June and July 2006 over a gridded area within the Moore Property. The work also included road clearing and line cutting. The main purpose of the geophysical surveys was to determine the response to the known mineralization and then to explore for extensions of the known mineralization as well as to locate new zones. A secondary purpose was to aid in the geological mapping for which resistivity surveys are especially useful. The IP and resistivity surveys were carried out using a BRGM Elrec 6 multi-channel receiver operating in the time-domain mode. The dipole length chosen was the 50-meter dipole read to six levels. The total amount of surveying carried out was 29.0 km along 15 lines. The results were plotted both in pseudosection, and contoured. Two different 2-D inversion interpretations were also carried out along each of the IP lines. The first inversion was a rapid least squares method produced by Geotomo Software and the second was the UBC method designed by the geophysics department and was carried out to gain greater depth. A plan map was drawn of the results. In addition, a test 3-D UBC inversion was carried out on lines 1300N, 1400N, and 1500N.

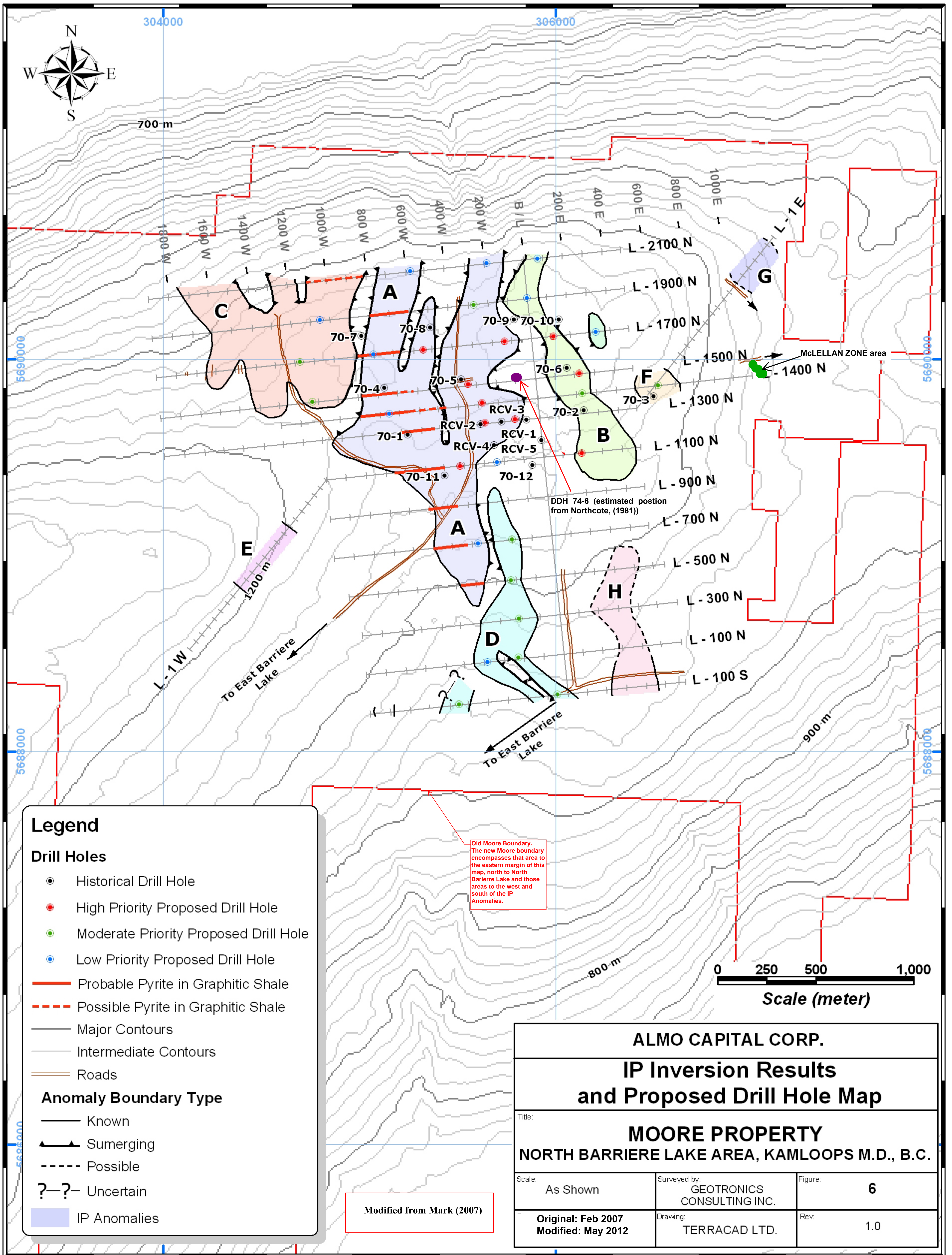

**Legend**

**Drill Holes**

- Historical Drill Hole
- High Priority Proposed Drill Hole
- Moderate Priority Proposed Drill Hole
- Low Priority Proposed Drill Hole

— Probable Pyrite in Graphitic Shale  
 - - - Possible Pyrite in Graphitic Shale

— Major Contours  
 - - - Intermediate Contours  
 — Roads

**Anomaly Boundary Type**

- Known
- Sumerging
- - - Possible
- ?-?- Uncertain

■ IP Anomalies

Modified from Mark (2007)

Old Moore Boundary. The new Moore boundary encompasses that area to the eastern margin of this map, north to North Barriere Lake and those areas to the west and south of the IP Anomalies.

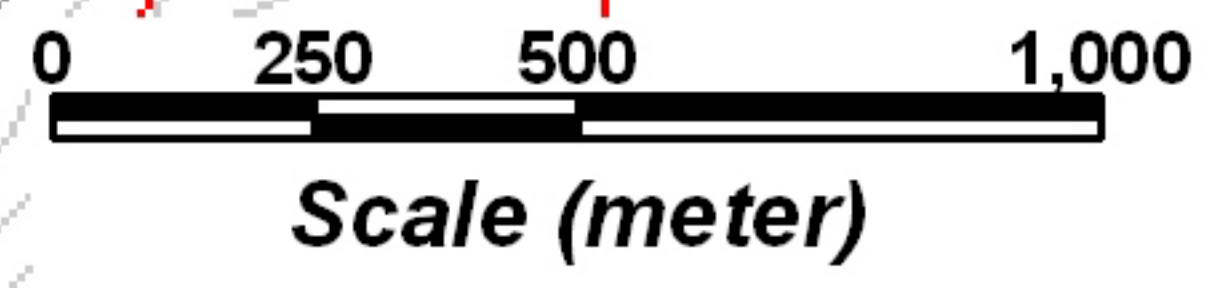

<b>ALMO CAPITAL CORP.</b>		
<b>IP Inversion Results and Proposed Drill Hole Map</b>		
Title:		
<b>MOORE PROPERTY</b>		
<b>NORTH BARRIERE LAKE AREA, KAMLOOPS M.D., B.C.</b>		
Scale:	Surveyed by:	Figure:
As Shown	GEOTRONICS CONSULTING INC.	6
Original: Feb 2007 Modified: May 2012	Drawing:	Rev.
	TERRACAD LTD.	1.0

### **9.1.1 IP (chargeability)**

The general purpose of IP is to respond to sulphide mineralization especially that which occurs as fracture-filling and/or disseminated. The strength of the IP anomaly is directly related to the surface area of the sulphides and thus fracture-filling and disseminated sulphides give a much higher anomalous reading than massive sulphides do. It was thus expected that the IP method would give the best results to the known mineralization on this property since it was expected that all the mineralization occurred as or was associated with disseminated or fracture-filling sulphides.

Moreover, an IP survey had been completed in 1970 within the present IP survey area of the property and thus IP was known to respond very well to the known mineralization. However, it was done at only one electrode separation, which was common at that time, and thus was limited in depth extent and gave little information on the shape of the causative sources. Therefore, the purpose of re-doing the IP survey was to explore to at least a depth of 200 meters and to more accurately delineate the location and shape of the causative sources. This was to be aided by carrying out an inversion interpretation on the data.

### **9.1.2 Resistivity**

The purpose of the resistivity surveying was to reflect the mineral zones by responding as lows to any geological structure and/or alteration, or as highs to silicification and/or calcification any of which may be associated with mineral zones. The resistivity method is particularly adept at mapping lithology since all rock types have their own resistivities, i.e., intrusives usually respond as resistivity highs and argillites usually respond as resistivity lows. Also, as indicated above, the resistivity method is particularly proficient at mapping geologic structure.

### **9.1.3 Self Potential**

Self potential, or SP, is essentially a by-product of carrying out IP/resistivity surveying. (It needs to be nulled out in order to measure the IP value.) Therefore it is not a prime exploration tool for this property. However, it is possible that it may respond to the mineralization and therefore prove to be quite useful. SP surveying usually has the best response to more massive sulphide mineralization such as vein-type.

## **9.2 2006 GEOPHYSICAL PROGRAM RESULTS**

### **9.2.1 Induced Polarization**

The IP survey, as interpreted by 2-D inversion, shows that much, if not most, of the survey area contains anomalous IP results. This indicates that much of the survey area contains sulphides. (Mark) has therefore attempted to sort out the

anomalous responses into eight different anomalous zones or anomalies and these have been labeled by the upper case letters, A to H, for ease of discussion.

However, there are two difficulties with categorizing the anomalous responses. Firstly, this has been done using the threshold IP value of 25 msec. But if the threshold limit is lowered to 20, a value that is anomalous within most IP survey areas, than most of the northern part of the survey area is anomalous and thus this would not be helpful in trying to understand how the mineralization occurs. Nevertheless, on parts of the property, a lower threshold value may be important, perhaps because of different geology. For this reason two of the anomalies are defined using the lower threshold value. Secondly, in some cases, it is difficult to determine the continuity of anomalies from one line to the other because of the 200-meter line separation. Thus (Mark) cautions the reader that as exploration continues on the property, and therefore, as knowledge is gained, the number, shape, as well as the characteristics of the anomalous zones may change.

**IP anomalous zone A** contains the main mineral zone as well as most of the historical drilling. This zone strikes northerly, is up to 950 meters wide, and has a minimum strike length of 1700 meters, being open to the north.

The correlation of the known drill results with the IP inversion results is excellent. That is, IP highs correlate directly with known mineralization, such as in hole 70-9. And where drill holes did not encounter mineralization, such as in hole 70-7, the IP inversion shows that the drill holes missed the target.

Most of A reflects pyrite, chalcopyrite, and other sulphides within a schist, or possibly a breccia (as indicated by float found within the area of the zone). However, part of the anomalous zone to the west appears to be reflecting pyrite within graphitic shale. This has a geophysical signature of a strong IP high correlating with a strong resistivity low. The graphitic shale appears to be extending from line 500N to 1900N, a distance of 1400 meters. It may also extend to line 2100N where it may be shifted to the west, possibly through faulting. The width varies from 120 meters to 250 meters.

**IP anomaly B** occurs to the east of 'A' and strikes north-northwesterly. It has a minimum strike length of 1100 meters, also being open to the north. Its width varies from 100 meters on line 1700N to 300 meters on line 1100N.

There are three historical drill holes within this zone, all encountering mineralization. However, within two of the holes, the mineralization tapers out and this agrees with the IP inversion results at these holes which also indicates that drilling to the east or to the west should have encountered a greater amount of mineralization

The IP inversion results at the southern end of B on line 1100N show a much bigger and deeper anomaly than along the rest of B to the north. It is possible, therefore, that this causative source on line 1100N is different from the rest of the causative source. However, it is considered to be a strong drilling target.

**IP anomalous zone C** occurs to the west of A. It probably strikes northerly, has a minimum strike length of 600 meters, and a width of up to 700 meters on line 1900N, or 1000 meters on line 2100N if the non-anomalous areas are included.

There are no known historical drill holes within C and thus the underlying rock-type is unknown except at 1300W on line 2100N. Outcropping of a gneissic rock with minor pyrite was noted.

**IP anomaly D** occurs to the east of and to the south of anomalous zone A. It strikes northerly, and has a minimum strike length of 1000 meters being open to the south. Its width varies from 80 meters on line 500N to 280 meters on line 300N. On lines 100N and 100S, it may split into two or three anomalies. The underlying geology is unknown. However, the correlating resistivity response is mostly a high and thus the host rock is probably schist.

**IP anomaly E** is a single line anomaly occurring on line 1W, having a width(?) of 380 meters, and correlating with a moderate resistivity response. It is therefore considered to be reflecting sulphides and thus is a target. However, before targets can be located for drilling purposes, additional IP surveying in this area would need to be carried out.

**IP anomaly F** occurs on line 1400N as well as on line 1E which crosses 1400N. It appears to be 200 meters wide and correlates with a resistivity high. It probably reflects sulphides, though whether they are of economic interest is unknown because of the unknown host rock-type.

**IP anomaly G** is also a one-line anomaly located on line 1E and having a line width of 270 meters. The underlying rock-type is also unknown but it correlates with a moderate resistivity response. This anomaly has a lower threshold of 20 msec but may be of economic interest.

**IP anomaly H** occurs within the southeast corner on the survey area striking northerly, and has a minimum strike length of 700 meters, being open to the south. This anomaly consists mostly of a moderate IP response of 20 msec, except on line 100S where the IP response is much stronger. In addition, it correlates with a strong resistivity high. From known geology in the area, this anomaly is probably reflecting pyrite within a granite host rock. It is therefore considered to be of low exploration interest.

### **9.2.2 Resistivity**

The results of the resistivity survey have mainly been discussed above with the IP results. However some of its main features are as follows:

A large resistivity high occurs within the northwestern part of the survey grid and may be reflecting highly siliceous shale as is known to occur on line 1300N. However, diorite and a gneissic rock-type are also known to occur to the north.

A resistivity high occurs within the southeastern part of the survey area and here very likely reflects granite.

### **9.2.3 Self Potential**

The self potential results, for the most part, are quite noisy. However, a few anomalies stand out and correlate quite well with IP highs indicating that the causative sources are sulphide bodies. Three of the more prominent ones are located at (700N, 960W), (1500N, 130E), and (1900N, 1100W). In addition, a strong SP anomaly occurs at (100S, 900W) but this one does not correlate with an IP high but rather with the boundary between a resistivity high and a resistivity low. Possibly the cause of the SP anomaly is related to a lithological contact. It is also possible that the causative source is a sulphide body, but with little associated disseminated sulphides that would otherwise give an IP high.

### **9.2.4 3-D Inversion**

The 3-D inversion of lines 1300N, 1400N, and 1500N agrees quite well with the 2-D inversion of the same lines. Its advantage, however, is that it shows the shape and continuity between the lines and thus can lead to more accurate location of drill targets.

## **10 DRILLING**

Result from the various programs prior to 2008, mainly in the 1970s, are poorly documented and in some cases not documented at all and are summarized in Section 6 (History). In general, this work is reported to have defined a 2.7 kilometre north-northwest striking zone containing pyrite, pyrrhotite and lesser chalcopyrite as disseminations and massive zones known as the EBL deposit. Some pre-2008 drillholes are plotted on Figure 6.

The 2006 IP and resistivity surveys completed on behalf of Almo Capital Corp and reported on in Section 9 (Exploration) were initiated in order to clarify the area of known, significant mineralization on the historic EBL property (now covered by the Moore property tenures) toward defining significant drill targets.

## 10.1 2008-2010 DRILLING – EBL ZONE

Based on the results and recommendations of the 2006 geophysics program, Almo Capital Corp carried out a multiphase diamond-drill program, previously laid out in detail by the author. In 2008, 2009 and 2010, Almo Capital drilled: 9 holes totaling 1910.43 metres; 8 holes totaling 1490.68 metres and 16 holes totalling 3139.64 metres, respectively. Total drilling by Almo Capital in these 3 years was 6540.75 metres in 33 holes (Table 2 and Figure 7).

Kumar (2012) reports that 2008-2010 drilling outlined a sulphide zone defined by an 800 by 1000 metre surface area that is underlain by metamorphosed andesite and felsic volcanic rocks of the Eagle Bay Assemblage.

The geologic succession cut by drilling on the EBL deposit has an average thickness of 220 meters and in general comprises a series of green-gray chlorite schist intercalated with white to grey sericite schist and cut by thin feldspar porphyry dikes. This succession was divided into 5 units based on various characteristics such as colour, grain size, metamorphic intensity and most importantly sulphide content. Table 3 provides a summary of these 5 units.

Copper+/-gold+/-silver+/-lead+/-zinc mineralization is hosted primarily in 3 of the 5 units – units 1, 3 and 5. Drill intersections show copper grades are typically less than 0.2 to 0.5% per cent with a few short intercepts ranging up to 1%. Sporadic silver values generally range in the order of 1-3 g/t with rare intersections ranging as high as 29 g/t. Gold typically ranges from 10 to 20 ppb with rare intersection assaying up to 386 ppb. Table 4 provides a summary of significant intersections.

Surface outcrop and drill core observation indicates that sulphide mineralization comprises pyrite, pyrrhotite and lesser chalcopyrite, along with minor amounts of bornite, galena and molybdenite. Magnetite also occurs.

Sulphides occur as:

- a. coatings on joints and fractures, 1-5 mm thick within banded, foliated chlorite carbonate mica schist. Strongly sheared fractures are developed locally due to crosscutting of thin carbonate veinlets from 0.5 to 1 cm thick. Fine to coarse grained quartz and carbonate veining contains patches of pyrite and disseminated pyrite.
- b. thin laminae from 1-5 mm thick consisting of thin irregular bands of pyrite along with lesser chalcopyrite and pyrrhotite. These are distributed along foliation planes of banded foliated chlorite mica carbonate schist.
- c. finely disseminated pyrite and chalcopyrite along foliation planes in strongly sheared chloritic, quartz-carbonate-mica schist with bluish grey quartz eyes.

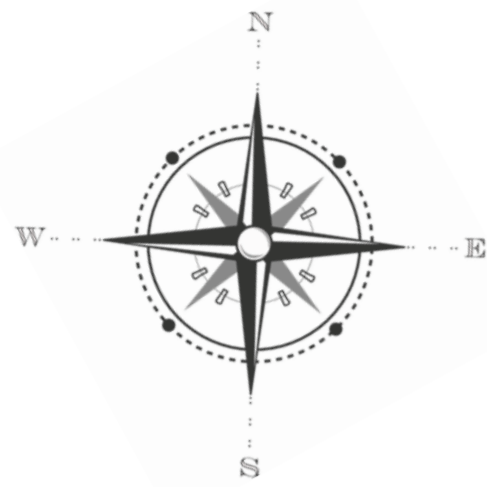

**Almo Capital Corp.  
Moore Mineral Property  
Drill Hole Location Map**

**LEGEND**

**Drill Holes**

- Historical Drill Holes
- Drill Holes Drilled in 2008
- Drill Holes Drilled in 2009
- Drill Holes Drilled in 2010

- Road
- UTM Grid Lines
- Claim Boundary
- IP Grid Lines

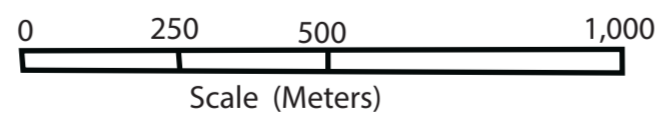
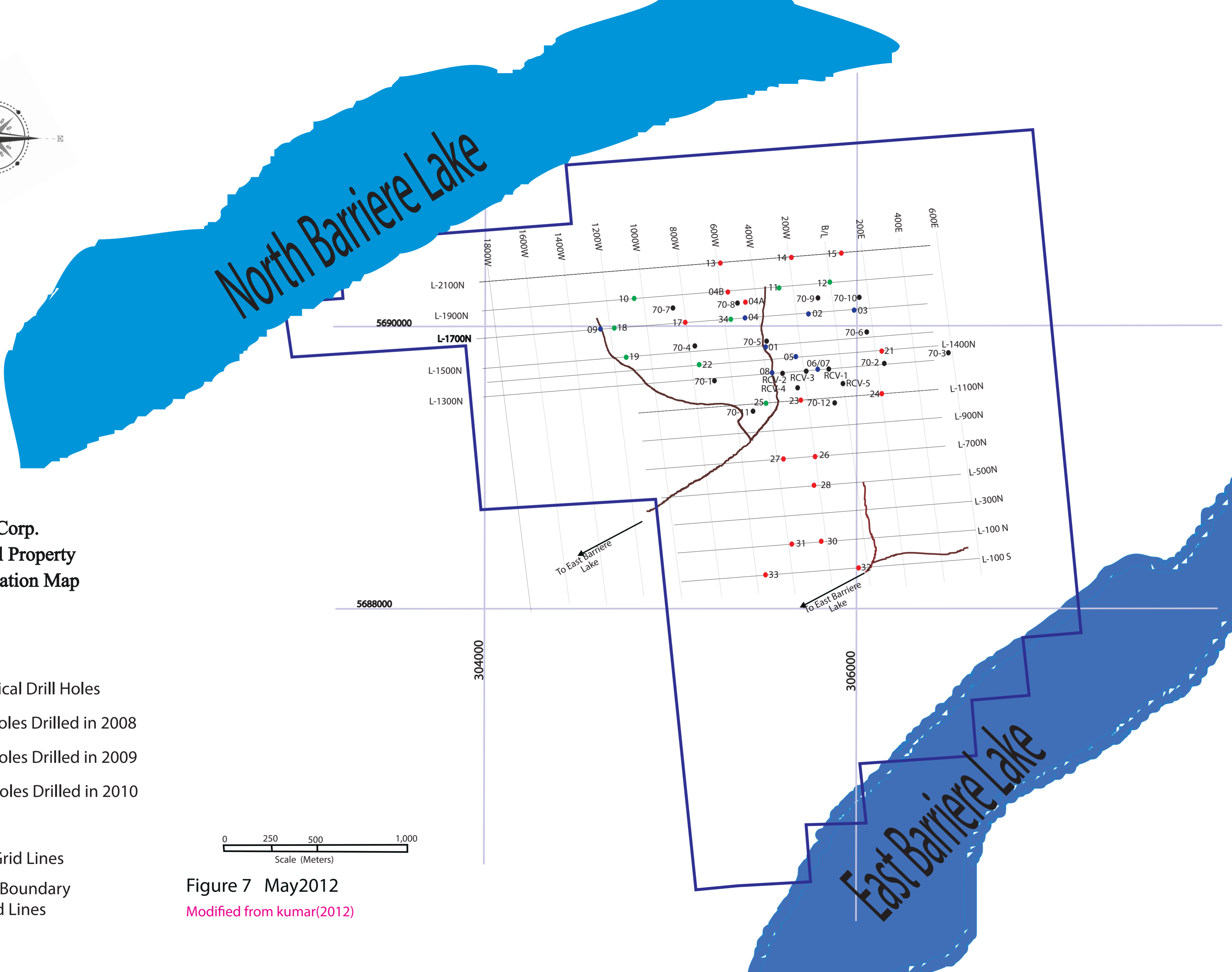

Figure 7 May2012

Modified from kumar(2012)



- d. 3 to 5 mm blebs, patches and specks of pyrite with lesser chalcopyrite in fractures and in 1-2 cm thick quartz-carbonate veins.
- e. strong, coarse-grained pyrite and chalcopyrite mineralization in quartz-rich zones within quartz phyric felsic volcanic protoliths.
- f. strongly silicified and bleached zones with disseminated pyrite-and trace chalcopyrite in siliceous bands.

Sulphide characteristics described in points a, b and c are more prominent in sheared chlorite carbonate mica schist that is more typical of rock units 1 to 3, whereas points d, e and f are more typical of silicified schist and feldspar porphyry of rock units 4 to 6.

Figure 7 shows the 2008-2009 drill locations with the 2006 IP grid lines discussed in Section 9 (Exploration). Kumar (2012) reports that holes drilled between Lines 1700N and 1900N show more consistent mineralization in rock units 1, 3, and 5 and are open to depth and; drillholes between lines 1500N and 1100N show mineralization in rock unit 3, 4, and 5 that are open to depth.

Drilling in 2008-2010 drilling reveals that chlorite schist becomes more compact, silicified and altered going in a north to south direction. Mineralization diminishes or ceases altogether as compositional banding dominates to the south, in contrast to schistose foliation found to the north. The proportion of copper content also diminishes southward, relative to pyrite and pyrrhotite which become more dominant.

The northwest area of the 2008-2010 drilling has produced the most significant results, indicated by assay results from holes 4, 4A and 4B and should be revisited and explored to deeper depths and over a wider area nearby.

**TABLE 2. SUMMARY OF 2008-2010 DRILLHOLES**

<b>Drill hole</b>	<b>Northing</b>	<b>Easting</b>	<b>Inclination</b>	<b>Azimuth</b>	<b>Length (m)</b>	<b>Elevation (m)</b>
DDH 08-01	5689822	305514	-60°	90°	225.71	1170.74
DDH-08-02	5690021	305704	-62°	90°	225.86	1173.78
DDH-08-03	5690027	305913	-54°	90°	225.56	1179.27
DDH-08-04	5690010	305396	-62°	270°	225.60	1178.05
DDH-10-04A	5690114	305359	-78°	270°	227.68	1175.61
DDH-10-04B	5690206	305280	-55°	270°	228.60	1171.35
DDH-08-05	5689723	305572	-58°	90°	196.60	1171.96
DDH-08-06	5689632	305710	-47°	270°	195.08	1171.96
DDH-08-07	5689632	305710	-52°	90°	195.69	1171.04
DDH-08-08	5689621	305532	-56°	270°	197.22	1170.43
DDH-08-09	5690007	304668	-65°	90°	223.11	1170.13
DDH 09-10	5690185	304800	-75°	90°	167.67	1167.08
DDH 09-11	5690215	305579	-90°		182.88	1180.49
DDH 09-12	5690226	305852	-82°	270°	167.64	1195.12
DDH-10-13	5690409	305291	-90°		179.83	1162.20
DDH-10-14	5690420	305678	-77°	90°	131.06	1159.15
DDH-10-15	5690424	305931	-90°		152.40	1178.97
DDH-10-17	5690019	305096	-68°	270°	198.12	1204.26
DDH 09-18	5689007	304782	-90°		195.08	1150.62
DDH 09-19	5689798	304782	-83°	90°	182.88	1152.14
DDH 10-21	5689723	306101	-85°	90°	198.12	1175.00
DDH 09-22	5689701	305153	-85°	90°	173.73	1174.70
DDH-10-23	5689442	305695	-50°	90°	188.88	1151.53
DDH-10-24	5689452	306119	-55°	270°	228.60	1143.91
DDH-09-25	5689462	305526	-70°	270°	195.00	1158.54
DDH-10-26	5689048	305733	-90°		227.07	1143.91
DDH-10-27	5689038	305569	-68°	270°	234.67	1143.61
DDH-10-28	5688851	305668	-75°	90°	197.80	1121.36
DDH-10-30	5688440	305744	-75°	270°	198.12	1068.02
DDH-10-31	5688427	305574	-90°		198.12	1067.71
DDH-10-32	5688293	305970	-65°	270°	167.69	1062.84
DDH-10-33	5688220	305430	-80°	270°	182.88	1064.06
DDH-09-34	5690015	305342	-90°		225.80	1124.41
<b>TOTAL</b>					<b><u>6,540.75</u></b>	

**TABLE 3. SUMMARY OF LITHOLOGY**

UNIT	Generalized Comments
<p>1. Green to green/grey chlorite –muscovite quartz schist. Moderate pyrite, pyrhotite, chalcopyrite (variably graphitic). The sand sized clastic grains are mainly light to medium grey quartz with relatively minor amounts of feldspar and blue quartz. Lenses of dark grey phyllite are also present. Disseminated and vein sulphides are locally common.</p>	<ul style="list-style-type: none"> <li>• Surface to 80 meters depth</li> <li>• Highly mineralized unit</li> </ul>
<p>2. White to white /grey sericite schist. Consists of mainly calcareous chlorite schist locally intercalated with carbonate horizons derived from mafic volcanic and volcanoclastic rocks. Low sulphides.</p>	<ul style="list-style-type: none"> <li>• 80 to 100 metres depth</li> <li>• 20 metre intersection</li> <li>• low sulphide content</li> </ul>
<p>3. Green to green /grey chlorite –muscovite quartz schist. The chloritic schist is medium to dark green, fine grained and well foliated, having a platy, splitting habit. Carbonate is intercalated throughout but is a subordinate component. The metasedimentary rocks consist largely of medium to dark grey graphitic and/or siliceous phyllite that grade to light to dark grey platy siltite and are very fine grained and platy</p>	<ul style="list-style-type: none"> <li>• 100-130 metres depth</li> <li>• 30 metre intersection</li> <li>• Moderately mineralized</li> </ul>
<p>4. White to white-grey micaceous quartzite, grit, phyllite and quartz mica schist accompanied by calcareous phyllite, calc-silicate schist and amphibole. This rock contains greenschist metamorphic mineral assemblages.</p>	<ul style="list-style-type: none"> <li>• 130-160 metres depth</li> <li>• 30 metre intersection</li> <li>• Low, rare mineralization</li> </ul>
<p>5. Pale green to grey green sericite phyllite that contains minor amounts of chlorite. Disseminated and vein sulphides are locally common. With malachite staining on foliation plane and in cross fractures.</p>	<ul style="list-style-type: none"> <li>• 160-220 metres depth (bottom not intersected)</li> <li>• Moderate sulphides</li> </ul>

**TABLE 4. SIGNIFICANT DRILL INTERSECTIONS\***

	<b>From (m)</b>	<b>To (m)</b>	<b>Interval (m)</b>	<b>Cu PPM</b>	<b>Ag PPM</b>	<b>Au PPB</b>	<b>Mo PPM</b>
<b>DDH 08-01</b>	13.87	16.92	3.05		1.80		10.00
	112.93	114.46	1.53	8066.00	1.30		3.50
	120.55	123.60	3.05	2102.50	6.70		5.00
	123.60	126.65	3.05	1130.10	4.60		3.00
	146.73	147.98	1.25	7666.60	2.80		2.00
	149.63	151.03	1.40	3670.80	1.20		1.40
<b>Drill hole</b>	<b>From (m)</b>	<b>To (m)</b>	<b>Interval (m)</b>	<b>Cu PPM</b>	<b>Ag PPM</b>	<b>Au PPB</b>	<b>Mo PPM</b>
DDH-08-02	6.50	16.50	10.00	2622.80	1.10		9.75
	39.92	43.62	3.70		1.9		2
	59.74	62.78	3.04				10.3
	65.83	67.36	1.53	1561	0.6		9.6
	74.98	84.13	9.05	2975.07	0.77		5.63
	116.13	120.70	4.75	10390.66	5.01		27.40
	130.00	131.50	1.50	1162.3			1.6
	163.37	166.42	3.05	1850.1	2.4		1.9
	190.80	192.30	1.50	1116.4			0.8
<b>Drill hole</b>	<b>From (m)</b>	<b>To (m)</b>	<b>Interval (m)</b>	<b>Cu PPM</b>	<b>Ag PPM</b>	<b>Au PPB</b>	
<b>DDH-08-03</b>	22.86	43.30	20.44	0.49		0.068	
	22.86	25.91	3.05	0.35	<2	0.011	
	25.91	28.96	3.05	0.192	<2	0.014	
	28.96	32.10	3.14	0.503	<2	0.029	
	32.10	35.06	2.96	0.265	<2	0.035	
	35.06	38.10	3.04	0.616	<2	0.065	
	38.10	41.15	3.05	0.797	<2	0.203	
	41.15	43.30	2.15	0.807	3	0.137	
<b>Drill hole</b>	<b>From (m)</b>	<b>To (m)</b>	<b>Interval (m)</b>	<b>Cu %</b>			
<b>DDH-08-04</b>	47.77	225.6	177.63	0.20			
	59.65	70.4	10.75	0.63			
	104.4	106.4	2	0.62			
	166.1	168.1	2	0.52			
	181.57	182.57	1	0.93			
	195.9	199.46	3.56	0.88			
	208.3	208.8	0.5	0.9			
	214.3	216.9	2.6	0.72			
<b>Drill hole</b>	<b>From (m)</b>	<b>To (m)</b>	<b>Interval (m)</b>		<b>Ag (g/t)</b>		
<b>DDH-08-04</b>	12.57	14.22	1.65		7.151515		
	33.63	34.63	1		6		
	59.65	63.65	4		10.5		
	122.4	125.1	2.7		8		
	178.3	181.57	3.27		8		
	199.46	201.83	2.37		8		
<b>Drill hole</b>	<b>From (m)</b>	<b>To(m)</b>	<b>Interval (m)</b>			<b>Au (g/t)</b>	
<b>DDH-08-04</b>	47.77	57.91	10.14			0.0623077	
	59.65	68.06	8.14			0.2050737	
	82.9	83.4	0.5			0.13	

Drill hole	FROM	TO	Interval (m)	Cu ppm		
DDH-10-04A	36.57	91.44	54.87	1895.6409		
	195.07	213.36	18.29	4074.74		
Drill hole	From (m)	To (m)	Interval (m)		Ag (ppm)	
DDH-10-04A	54.86	70.1	15.24		0.89954	
	73.15	82.29	9.14		0.7663	
	195.07	213.36	18.29		1.4005	
Drill hole	From (m)	To (m)	Interval (m)	Cu ppm	Ag (ppm)	
DDH-10-04B	18.28	27.43	9.15	3423.13	1.766	
	42.67	54.86	12.19	4361.95	2.013	
	48.6	51.82	3.22	7777.5	3.7	
	158.5	216.41	57.95	2554.66	0.8631	
	210.31	213.3	3.05	8121	2.6	
Drill hole	From (m)	To (m)	Interval (m)	Cu %	Ag (g/t)	Au (g/t)
DDH-08-05	18.29	19.82	1.53		7.0000	
	25.91	27.44	1.53		6.0000	
	56.38	60.96	4.56			0.0633
	62.49	65.53	3.04			0.0450
	67.06	68.58	1.52		6.0000	0.0200
	73.16	77.72	4.56			0.0533
	83.82	85.34	4.56			0.0466
	97.54	109.70	12.16	0.1714		0.0263
	103.62	105.14	1.52	0.2480	12.0000	0.0500
	115.82	120.91	5.09	0.2990		
	124.97	131.05	6.08	0.2552		
	129.53	131.05	1.52		8.0000	
	155.46	158.50	3.04		6.3250	
	161.55	164.59	3.04		5.5000	
	169.17	178.31	9.14	0.2340		
	176.79	178.31	1.52	0.3400	6.0000	
Drill hole	From (m)	To (m)	Interval (m)	Cu %	Ag (g/t)	Au (g/t)
DDH-08-06	9.15	12.20	3.05		11.00	
	15.24	18.30	3.06		9.00	
	38.10	39.63	1.53		6.00	
	112.78	114.30	1.52		7.00	
	156.98	158.50	1.52		7.00	
	169.17	170.69	1.52		8.00	
	172.22	173.74	1.52		7.00	
	181.36	182.88	1.52		7.00	
	36.58	38.10	1.52			0.0800
	64.01	71.63	7.62			0.0460
	86.87	96.02	9.15			0.0566
	97.28	102.11	4.83			0.0453
	156.98	185.93	28.95			0.0363
	188.98	190.50	1.52			0.3700

	36.58	38.10	1.52	0.33			
	52.30	56.39	4.09	0.31680			
	86.87	96.02	9.15	0.53200			
	97.28	102.11	4.83	0.3045			
	114.30	117.36	3.06	0.20500			
	128.02	132.58	4.56	0.20967			
	158.50	160.02	1.52	0.33400			
	166.12	174.26	8.14	0.26965			
	178.31	185.93	7.62	0.20354			
<b>Drill hole</b>	<b>From (m)</b>	<b>To (m)</b>	<b>Interval (m)</b>	<b>Cu ppm</b>	<b>Ag ppm</b>	<b>Au ppb</b>	<b>Mo ppm</b>
<b>DDH-08-07</b>	6.1	23.47	17.37	1210.06		18.817	5.580
	35.19	37.19	2.00	3420.00		27.700	29.000
	41.70	43.70	2.00	1362.90		12.700	29.000
	53.00	57.00	4.00	2234.20		27.200	11.600
	60.00	63.00	3.00	2135.00		85.700	13.300
	71.00	75.00	4.00	2276.40		29.500	10.700
	81.50	85.50	4.00	10000.00	3.1000	58.300	12.300
	93.00	95.00	2.00	2317.70		11.700	4.200
	111.00	114.00	3.00	593.80		7.300	13.500
	128.00	133.00	5.00	1029.80		9.000	3.700
	133.00	138.00	5.00	158.90		2.000	3.600
	146.00	150.00	4.00	2217.30		9.400	3.300
	150.00	155.00	5.00	1658.60		5.700	9.900
	155.00	160.00	5.00	803.70		2.200	2.000
	172.00	175.00	3.00	1399.80		23.400	1.900
	181.00	186.00	5.00	181.00		17.100	
	186.00	189.00	3.00	186.00		5.200	
<b>Drill hole</b>	<b>From (m)</b>	<b>To (m)</b>	<b>Interval (m)</b>	<b>Cu ppm</b>	<b>Ag ppm</b>	<b>Au ppb</b>	<b>Mo PPM</b>
<b>DDH-08-08</b>	66.14	67.67	1.53				57.6
	145.38	148.43	3.05		0.6		189.6
	180.44	183.48	3.04		4.3		4.8
	186.53	189.59	3.06	2635	5.9		8.3
<b>Drill hole</b>	<b>From (m)</b>	<b>To (m)</b>	<b>Interval (m)</b>	<b>Cu ppm</b>	<b>Ag ppm</b>	<b>Au ppb</b>	<b>Mo ppm</b>
<b>DDH-08-09</b>	148.31	151.18	2.87		1.7		28.9
<b>Drill hole</b>	<b>From (m)</b>	<b>To (m)</b>	<b>Interval (m)</b>	<b>Cu ppm</b>	<b>Ag ppm</b>	<b>Au ppb</b>	<b>Mo ppm</b>
<b>DDH 09-10</b>	6.20	20.20	18.00		0.25	2.37	1.37
	88.00	88.50	0.50	1278.70	0.60	46.10	0.70
	105.65	107.15	1.50		0.50	4.50	12.00
	108.90	113.80	4.93			2.76	4.14
	115.60	120.60	5.00			2.20	2.46
	131.50	136.50	5.00			1.68	7.00
<b>Drill hole</b>	<b>From (m)</b>	<b>To (m)</b>	<b>Interval (m)</b>	<b>Cu ppm</b>	<b>Ag ppm</b>	<b>Au ppb</b>	
<b>DDH 09-11</b>	6.10	32.30	26.20	4337.98	1.14	6.53	
	6.10	14.10	8.00	6732.45	1.68	11.35	
	66.10	72.10	6.00		1.16	7.63	
	121.70	125.70	4.00			7.35	

Drill hole	From (m)	To (m)	Interval (m)	Cu ppm	Ag ppm	Au ppb	Mo ppm
DDH-10-13	7.62	12.19	6.1	2966.1	1.35		
	48.76	51.81	3.05	3759.9	1.3		
	94.48	106.68	12.15	5903.8	2.1		
	113.00	116.50	3.5	6555.91	3.2		
Drill hole	From(m)	To(m)	Interval(m)	Cu ppm	Ag ppm	Au ppb	Mo ppm
DDH-10-14	82.29	85.34	3.05				1.1
	88.39	91.49	3.1				1.6
	102.00	103.60	1.6				2.9
Drill hole	From (m)	To (m)	Interval (m)	Cu ppm	Ag ppm	Au ppb	Mo ppm
DDH-10-15	66.60	68.80	2.00		2.10		
	91.44	94.48	3.44		4.30		
Drill hole	From (m)	To (m)	Interval (m)	Cu ppm	Ag ppm	Au ppb	Mo ppm
DDH-10-17	100.54	103.63	3.09	1079	1		1.6
	135.10	137.16	2.06		2.1		2.1
	176.78	178.78	2				7.9
Drill hole	From (m)	To (m)	Interval (m)	Cu ppm	Ag ppm	Au ppb	Mo ppm
DDH 09-18	38.10	59.63	25.05			35.9729	
	36.58	41.63	5.05				2.3463
	41.63	43.63	2		2.5		
	45.63	47.63	2			386.1	
	47.63	61.63	14				1.7285
	72.50	94.50	22.00			2.0727	
	72.50	90.50	18				1.1
	109.50	123.50	14.00			1.7714	1.9
	128.00	130.00	2				3.6
	150.45	151.45	1	2276.6	5.2	12.6	
Drill hole	From(m)	To (m)	Interval (m)	Cu ppm	Ag ppm	Au ppb	Mo ppm
DDH 09-19	30.50	32.50	2.00			1.30	
	36.00	37.25	1.25		0.70	11.10	
	50.00	51.50	1.50			2.70	
	55.70	57.70	2.00			1.20	
	63.00	69.00	6.00			2.63	14.30
Drill hole	From (m)	To (m)	Interval (m)	Cu ppm	Ag ppm	Au ppb	Mo ppm
DDH 10-21	6.10	12.20	6.10	1594.04			19.45
	19.84	21.84	2.00	4372.30	1.60		16.70
	33.00	47.72	14.72	2125.10			6.99
	54.30	70.10	15.80	2393.65			3.97
	116.75	119.25	2.50	2986.00	1.10		2.10
Drill hole	From (m)	To (m)	Interval (m)	Cu ppm	Ag ppm	Au ppb	Mo ppm
DDH 09-22	25.38	39.38	4.00			5.80	
	45.50	57.50	12.00			2.82	
	53.50	61.50	8.00				3.95

	139.40	141.40	2.00	1180.70	1.20	6.40	
<b>Drill hole</b>	<b>From (m)</b>	<b>To (m)</b>	<b>Interval (m)</b>	<b>Cu ppm</b>	<b>Ag ppm</b>	<b>Au ppb</b>	<b>Mo ppm</b>
DDH-10-23	76.20	79.25	3.05				15.50
	82.30	86.25	3.95	2056.10			11.20
	100.58	102.55	1.97	1864.50			18.90
	124.97	126.97	2.00	1666.90	0.60		18.20
	131.06	133.06	2.00	4035.30	0.90		21.10
	143.90	149.00	5.1				10.0411
	158.69	161.54	2.85	3552.70	0.60		13.00
	176.78	179.83	2.60	1173.80			6.10
<b>Drill hole</b>	<b>From (m)</b>	<b>To (m)</b>	<b>Interval (m)</b>	<b>Cu ppm</b>	<b>Ag ppm</b>	<b>Au ppb</b>	<b>Mo ppm</b>
DDH-10-24	21.33	23.35	2.02	252.9			8.6
	33.32	35.32	2	276.1			1.7
	43.7	44.70	1	1118.5			1.3
	53.10	56.10	3.00	2487.90			3.30
	60.25	64.85	5.60	1766.57			3.03
	73.90	77.30	3.40	2557.80			2.00
	90.25	93.25	3.00	1032.60	1.00		3.40
	93.25	96.00	2.75	1484.00			1.90
	100.80	101.80	1.00	2901.60	2.60		10.10
including	128.00	201.17	73.17	1203.82	2.92		3.23
	173.74	176.78	3.04	2395.20	1.00		4.00
	220.75	221.75	1.00	5710.20	3.00		
<b>Drill hole</b>	<b>From (m)</b>	<b>To (m)</b>	<b>Interval (m)</b>	<b>Cu ppm</b>	<b>Ag ppm</b>	<b>Au ppb</b>	<b>Mo ppm</b>
DDH-09-25	6.09	7.62	1.53			15.60	
	7.62	41.62	34.00			6.46	
	23.62	25.62	2.00		12.20	14.70	
	29.62	31.62	2.00				26.8
	71.62	73.62	2.00			13.60	
	83.62	85.62	2.00		1.40	15.70	
	121.62	127.62	6.00			43.73	
	121.62	123.62	2.00			105.10	
	151.62	153.62	2.00				11.2
	159.62	167.62	8.00	2548.25	0.73	13.30	34.43
<b>Drill hole</b>	<b>From (m)</b>	<b>To (m)</b>	<b>Interval (m)</b>	<b>Cu ppm</b>	<b>Ag ppm</b>	<b>Au ppb</b>	<b>Mo ppm</b>
DDH-10-26	12.19	16.24	4.05	2573.01			
	15.24	16.24	1.00				40.40
	18.29	26.38	8.09	2596.48			
	140.20	152.40	12.20				18.52
	152.40	155.40	3.00		1.10		
	190.45	192.10	1.63		1.90		532.60
<b>Drill hole</b>	<b>From (m)</b>	<b>To (m)</b>	<b>Interval (m)</b>	<b>Cu ppm</b>	<b>Ag ppm</b>	<b>Au ppb</b>	<b>Mo ppm</b>
DDH-10-27	72.10	73.15	1.05		29.20		
	215.00	218.90	3.90	2968.00			
<b>Drill hole</b>	<b>From (m)</b>	<b>To (m)</b>	<b>Interval (m)</b>	<b>Cu ppm</b>	<b>Ag ppm</b>	<b>Au ppb</b>	<b>Mo ppm</b>
DDH-10-28	64.00	93.40	29.40			32.40	

	79.24	85.34	6.10	1092.95	0.85	49.70	
	91.40	93.40	2.00	3448.80	1.30	11.40	
	99.00	100.50	1.50			70.50	
	113.50	115.50	2.00			62.70	
	115.50	117.00	1.50			79.70	
<b>Drill hole</b>	<b>From (m)</b>	<b>To (m)</b>	<b>Interval (m)</b>	<b>Cu ppm</b>	<b>Ag ppm</b>	<b>Au ppb</b>	<b>Mo ppm</b>
DDH-10-31	<b>From</b>	<b>To</b>	<b>Interval</b>				
	91.44	100.59	1.5				<b>22.33</b>
	<b>108.23</b>	<b>109.73</b>	<b>1.5</b>				<b>13.2</b>
<b>Drill hole</b>	<b>From (m)</b>	<b>To (m)</b>	<b>Interval (m)</b>	<b>Cu ppm</b>	<b>Ag ppm</b>	<b>Au ppb</b>	<b>Mo ppm</b>
DDH-09-34	67	75	8	3651	1.25	60.75	
	73	75	2	7121	1.8	80.8	
	78.1	80.6	2.5			25.44	
	128	137.5	9.5	2515.88	0.6105	7.878	

\*weighted averages where significant contiguous mineralization and/or where strong values warranted their inclusion

## **11 SAMPLE PREPARATION, ANALYSES AND SECURITY**

The objective of the drill sampling program was to compare mineralization from drill hole intervals described during the 1969-1970 drill program. In 2008, diamond-drilling was conducted by Stikine Contracting Ltd., 23064 50<sup>th</sup> Avenue, Langley, B.C. No acid dip testing was done in 2008. Core was trucked to Vancouver and core logging was carried out in a storage facility parking lot. In 2009 and 2010, diamond-drilling was conducted by Full force Drilling Ltd. of 6261 Miller Rd. Peachland, B.C. and core logging was performed on the Moore property during the field program. Acid dip testing was reported to have been carried out on the holes in 2009 and 2010. Drill core was safely transported to Vancouver by the drilling contractor and was kept in a safe location.

Drill core samples were prepared by M.Sc geology graduates, Amit Kumar and Uma Shankar at the private residence of Ram Vallabh in Vancouver. Drill core was longitudinally split by core splitter into equal sized pieces in an approximately straight line along the sampling line of the core.

Discrete sample sections consisting of half the split core were placed in sealed plastic bags and appropriately tagged for shipping. No QA/QC protocols were carried out during the drill core processing procedures by employees of Almo Capital Corp; that is, no inclusion of blanks, duplicates and standards were included with drill core samples to be delivered for laboratory analysis.

All the samples from 2008-2010 drill programs were, from time to time, shipped by company vehicle from work facilities at 603 East 30<sup>th</sup> Avenue, Vancouver to Acme Analytical Laboratories at 1020 Cordova Street East, Vancouver. Kumar (2012) reported that no evidence of tampering during preceding procedures was manifest.

All Chemical analysis was done by Acme Analytical Laboratories (Vancouver) Ltd. An ISO 9001:2008 accredited laboratory. Drill core samples were crushed and pulverized using sample preparation code P200 ( Dry (60°C) and pulverized only to 85% passing 200 mesh, per 250g) and R200–250 (Crush 1 kg to 80% passing 10 mesh, split 250g and pulverize to 85% passing 200 mesh) respectively. Holes were analyzed for various gold plus multi-element packages indicated in the table below. Code details are provided by Acme Labs at <http://acmelab.com/services/method-descriptions/rock-and-drill-core/>

After splitting and sampling, the drill core was transported to a locked storage facility (Maple Leaf Storage) at 33 Commercial Drive Vancouver, B.C. It was then later moved to 10759 141 Street, Surrey, B.C., where it is presently stored.

**TABLE 5: DRILLCORE SAMPLE AND ANALYSIS DATA**

Drill hole number	Job No.	Sample Id	No. of samples	Type of samples	Preparation Code	Analysis code
DDH-08-01	VAN 11003428	65751-65775	22	Drill core	R200-250	7AX1 Aqua regia digestion
DDH-08-02	VAN11001287.1	65358-65378	21	Drill core	R200-250	7AX1 Aqua regia digestion
DDH-08-04	VAN08011204.1	52101-52163	63	Drill core	R200	Group 6(Au+Ag) +G7AR
DDH-08-04	VAN09002981.2	51901-51958	58	Drill core	R200	Group 6(Au+Ag) +G7AR
DDH-10-04A	VAN11000596.1	65401-65459	59	Drill core	R200-250	1EX 4Acid digestion
DDH-10-04B	VAN10006853.1	65004-65039	48	Drill core	R200-250	1EX 4Acid digestion
DDH-10-04B	VAN10006853.2	65004-65039	26	Drill core	R200-250	7AX1 Aqua regia digestion
DDH-10-04B	VAN11000259.3	65007-65066	08	Drill core	R200-250	1EX 4Acid digestion +7AX1 Aqua
DDH-08-05	VAN09002980.2	582165-52200 52301-52390	126	Drill core	R200	Group 6(Au+Ag) +G7AR
DDH-08-06	VAN09002979.2	51959-52278	120	Drill core	R200	Group 6(Au+Ag) +G7AR
DDH-08-07	VAN10002072.1	52279-52300	26	Drill core	R200-250	1DX2 Aqua regia digestion
DDH-08-08	VAN11003863	65710-65729	29	Drill core	R200-250	7AX1 Aqua regia digestion
DDH-08-09	VAN11004062	65730-65746	17	Drill core	R200-250	7AX1 Aqua regia digestion
DDH-09-10	VAN10000831.1	65228-65250	23	Drill core	R200-250	1DX2 Aqua regia digestion
DDH-09-10	VAN10000831.2	65235-65237	3	Drill core	R200-250	G601 Fire Assay fusion Au by ICP-ES
DDH-09-11	VAN10001390.1	65301-65327	27	Drill core	R200-250	1DX2 Aqua regia digestion
DDH-09-11	VAN10001390.2	65301-65318	18	Drill core	R200-250	7AX1 Aqua regia digestion
DDH-10-13	VAN11000202.1	65073-65095	23	Drill core	R200-250	1EX 4Acid digestion
DDH-10-13	VAN11000202.2	65073-65095	08	Drill core	R200-250	7AX1 Aqua regia digestion
DDH-10-14	VAN11003168	65096-65098	3	Drill core	R200-250	7AX1 Aqua regia digestion
DDH-10-15	VAN11003170	65644-65646	3	Drill core	R200-250	7AX1 Aqua regia digestion
DDH-10-17	VAN11004328	65379-65396	18	Drill core	R200-250	7AX1 Aqua regia digestion
DDH-10-13	VAN11000202.1	65073-65095	23	Drill core	R200-250	1EX 4Acid digestion
DDH-10-13	VAN11000202.2	65073-65095	08	Drill core	R200-250	7AX1 Aqua regia digestion
DDH-10-14	VAN11003168	65096-65098	3	Drill core	R200-250	7AX1 Aqua regia digestion
DDH-10-15	VAN11003170	65644-65646	3	Drill core	R200-250	7AX1 Aqua regia digestion
DDH-10-17	VAN11004328	65379-65396	18	Drill core	R200-250	7AX1 Aqua regia digestion
DDH-09-18	VAN10000830.1	65193-65227	35	Drill core	R200-250	1DX2 Aqua regia digestion
DDH-09-18	VAN10000830.2	65193-65227	04	Drill core	R200-250	G601 Fire Assay fusion Au by ICP-ES
DDH-09-19	VAN10000832.1	65251-65263	13	Drill core	R200-250	1DX2 Aqua regia digestion
DDH-09-19	VAN10000832.2	65252	1	Drill core	R200-250	G601 Fire Assay fusion Au by ICP-ES
DDH-10-21	VAN11001196.1	65515-65540	26	Drill Core	R200-250	7AX1 Aqua regia digestion
DDH-09-22	VAN11003347	65328-65353	26	Drill core	R200-250	1DX2 Aqua regia digestion
DDH-10-23	VAN11003347	65677-65688	12	Drill core	R200-250	7AX1 Aqua regia digestion
DDH-10-24	VAN11003190	65571-65614	44	Drill core	R200-250	7AX1 Aqua regia digestion
DDH-09-25	VAN10000833.1	65101-65192	92	Drill core	R200-250	1DX2 Aqua regia digestion
DDH-09-25	VAN10000833.2	65173-65182	10	Drill core	R200-250	G601 Fire Assay fusion Au by ICP-ES
DDH-09-25	VAN10000833.3	65173-65182	10	Drill core	R200-250	7AX1 Aqua regia digestion +Group 6(Au)
DDH-10-26	VAN11003198	65620-65643	24	Drill core	R200-250	7AX1 Aqua regia digestion
DDH-10-27	VAN11000959.1	65475-65514	40	Drill core	R200-250	7AX1 Aqua regia digestion
DDH-10-28	VAN11003199	65551-65570	20	Drill Core	R200-250	7AX1 Aqua regia digestion
DDH-10-31	VAN11003171	65651-65676	26	Drill core	R200-250	7AX1 Aqua regia digestion
DDH-09-34	VAN10001046.1	65264-65300	37	Drill core	R200-250	1DX2 Aqua regia digestion
DDH-09-34	VAN10001046.2	65264-65300	23	Drill core	R200-250	7AX1 Aqua regia digestion
DDH-09-34	VAN10001046.2	65264-65300	12	Drill core	R200-250	G601 Fire Assay fusion Au by ICP-ES

## **12 DATA VERIFICATION**

The author was directly involved with the 2006 geophysical program, details of which are included in Section 9 (Exploration). The author was involved with the 2008-2010 drill program only to the degree outlined in Sections 2 and 3. To the degree stated, the author cannot directly verify the data collection and observations that occurred during that time.

Drill data used in the preparation of this report was generated by Almo Capital Corp and its employees Amit Kumar and Uma Shankar, neither of whom meets the definition of “qualified persons” as defined by National Instrument 43-101. Both Kumar and Shankar earned M.Sc. degrees in Geological Science in 2008 from the University of Lucknow at Lucknow, India.

No QA/QC procedures were carried out during the drill core processing activities by the employees of Almo Capital Corp; that is, no inclusion of blanks, duplicates or standards were included with drill core samples delivered to Acme Analytical Laboratories of Vancouver for analysis.

Further, Mr Kumar has stated that no core recovery (CR) measurements and calculations were carried out on the core, though notes were made on the drill logs indicating areas of core loss. As well, no rock quality definition (RQD) measurements and calculations were done.

As part of their own Quality Assurance/Quality Control protocol, Acme Analytical Laboratories included blanks, duplicates and standards in their analytical stream to verify precision and reproducibility.

While it would have been desirable for the introduction of appropriate QA/QC protocols from the onset of the drill program in 2008, the data confirms what was historically known of the drilled area and discussed in Section 6 (History), and that the work was carried out to a good standard of competency and completion. Generally, the results indicate that the assay data are accurate, precise and free from contamination.

## **13 MINERAL PROCESSING AND METALLURGICAL TESTING**

The author of this Technical Report is not aware of any mineral processing and/or metallurgical testing analyses that have been carried out on the subject property or of any metallurgical problems that would adversely affect development.

## **14 MINERAL RESOURCE AND MINERAL RESERVE ESTIMATES**

No mineral resource or mineral reserve estimates were calculated on the property.

## **23 ADJACENT PROPERTIES**

The following mineral occurrence descriptions are taken in whole or in part from MINFILE (the BC government mineral occurrence database). They represent significant volcanogenic massive sulphide deposits occurring in a nearby, similar geological setting to that of the EBL deposit on the Moore property and may point to a common genesis.

The Harper Creek, Homestake, Rea Gold and Samatosum deposits are all classified as Noranda/Kuroko volcanogenic massive sulphide deposits. In particular, the Harper Creek occurrence has been cited by government geologists (Hoy, 1997) for its similar characteristics to the EBL deposit, as discussed in Sections 8 (Deposit Type) and 25 (Interpretation and Conclusions). Figure 8 and Table 2 provide information on these and other occurrences in the vicinity of the Moore property.

The author has relied on BC government website for the information in following occurrences and did not verify the information. These summaries are not necessarily indicative of the mineralization on the property that is the subject of this technical report

### **23.1 HARPER CREEK (MINFILE 082M 009)**

The Harper Creek deposit lies 3500 metres north of the Cretaceous Baldy batholith within metavolcanics and metasediments of the Lower Cambrian and older(?) to Mississippian Eagle Bay Formation. Copper mineralization is confined to tabular-shaped zones within light silvery grey quartz-sericite phyllites, with lesser amounts of green chloritic phyllite, dark grey carbonaceous phyllite and light grey sericitic quartzite. These rocks locally include thin horizons of quartz-feldspathic orthogneiss.

Chalcopyrite occurs as disseminations and patches along foliations, in steeply dipping, northerly striking fractures, within quartz and quartz-carbonate veins and with massive pyrite-pyrrhotite. Sphalerite, galena, arsenopyrite, molybdenite, tetrahedrite, tennantite, bornite and cubanite are present in minor quantities. Magnetite occurs locally as massive lenses containing minor chalcopyrite. The main mineralized zone is about 1800 metres long, has a local thickness of 100 metres and has been explored downdip for 600 metres. A north-northeast trending, southeast dipping fault cuts the zone midway.

Yellowhead Mining Inc announcement on February 16, 2012 of its updated resource estimate showed that its program of infill and step out drilling expanded the resource by 47%. The Measured and Indicated resource at a 0.2% copper cut-off grade stands at 815Mt at 0.29% Cu, 0.032 g/t Au and 1.3 g/t Ag. A further 80.17Mt at 0.30% Cu, 0.033 g/t Au and 1.4 g/t Ag are estimated in the Inferred resource category. The deposit remains open along strike to the east and west, down dip to the north, up section to the south and at depth. The Company plans



to continue step out drilling to expand the existing resource and to identify new deposits within our mineral tenures

### **23.2 HOMESTAKE (MINFILE 082M 025)**

The Homestake deposit is hosted by quartz-talc-sericite schists, sericite-quartz phyllite and sericite-chlorite-quartz phyllite derived from felsic to intermediate volcanic rocks (Unit EBA) of the Lower Cambrian and older(?) to Mississippian Eagle Bay Formation. The rocks are overlain by intermediate to felsic volcanic and volcanoclastic rocks (Unit EBF). Several barite lenses with variable amounts of sulphides occur near the top of a bleached, rusty-yellowish weathered zone of pyritic sericite-quartz schist interpreted to be a highly altered, felsic tuff.

The main mineralized areas occur as two tabular horizons separated by 4 to 5 metres of schist. The largest, called the "barite bluff", is 5 to 6 metres wide on surface and contains most of the sulphides. A lower horizon, 1 to 2 metres thick, is banded with only minor sulphides. Underground, the barite-sulphide lenses have been traced several hundred metres. The main horizon, consisting of massive to banded barite, metallic minerals and quartz-sericite, are cut by veins and lenses of quartz. The metallic minerals include tetrahedrite, galena, sphalerite, pyrite, chalcopyrite, argentite, native silver and trace ruby silver and native gold.

A total of 6962 tonnes was mined in 6 years from 1926 to 1941 from which 8,750,829 grams silver, 1259 grams gold, 203,310 kilograms zinc, 141,295 kilograms lead and 9,138 kilograms of copper 20,146 pounds were recovered. Probable reserves are 249,906 tonnes grading 226.6 grams per tonne silver, 36.7 per cent barite, 0.28 per cent copper, 1.24 per cent lead, 2.19 per cent zinc and 0.58 grams per tonne gold (Statement of Material Facts 06/06/86, Kamad Silver Company Ltd.).

### **23.3 REA GOLD (MINFILE 082M 191)**

Rea Gold deposit is hosted by chloritic phyllites, quartz-sericite schists and chert derived from predominantly mafic with minor intermediate to felsic volcanic and volcanoclastic rocks (Unit EBF) of the Lower Cambrian and older(?) to Mississippian Eagle Bay Formation (Map 56). The rocks are underlain by sericitic phyllites, derived from felsic to intermediate volcanics (Unit EBA).

Two massive sulphide lenses, 250 metres apart and at about the same stratigraphic level, occur at the stratigraphic top of a silicified tuff and exhalative chert sequence that lies above a thicker sequence of mafic ash, crystal and lapilli tuffs. Both lenses are stratigraphically overlain by a thin sequence of mafic tuff which grades up into argillites, wackes and grits. The southern lens is "capped" by a layer of massive barite.

The massive sulphides are underlain by a footwall feeder and alteration zone, characterized by intense silicification, pervasive pyrite and sericite development. As the stratigraphic succession is inverted, the "footwall alteration zone" or "stockwork feeder zone" forms the structural hanging wall of the sulphide lenses.

Mineralization within the sulphide lenses include pyrite, sphalerite, galena, arsenopyrite, chalcopyrite and tetrahedrite- tennantite. The sulphides range from fine-grained, massive with a faint breccia texture, to medium-grained and banded. Gold and silver is associated with the massive sulphides and barite.

The northern lens (L100 lens) or Discovery lens, has a surface strike length of about 50 metres, a width of about 4 metres, and a down dip projection of at least 120 metres. The lens strikes 140 degrees and dips 50-60 degrees north eastward. Measured geological reserves are estimated at 242,849 tonnes grading 6.51 grams per tonne gold, 73.37 grams per tonne silver, 2.14 per cent lead, 2.24 per cent zinc and 0.52 per cent copper (George Cross News Letter #8, 1987).

The southern lens (L98 lens) has a surface strike length of 75 metres and a downdip extension of at least 80 metres. Massive sulphide widths to 8 metres have been intersected by drilling. The southern lens contains measured geological reserves of 133,536 tonnes grading 61.71 grams per tonne silver, 5.41 grams per tonne gold, 0.69 per cent copper, 2.4 per cent lead and 2.4 per cent zinc (Northern Miner - November 30, 1987).

Indicated reserves for the northern and southern lenses are 376,000 tonnes grading 0.33 per cent copper, 2.2 per cent lead, 2.3 per cent zinc, 6.1 grams per tonne gold and 69.4 grams per tonne silver (George Cross News Letter No.8, 1987; Northern Miner November 30, 1987).

#### **23.4 SAMATOSUM (MINFILE 082M 244)**

The Samatosum deposit is located in structurally complex metasedimentary and metavolcanic rocks of the Paleozoic (Lower Cambrian and older(?) to Mississippian) Eagle Bay Assemblage (Formation). The assemblage has a complex deformational history involving multiple stages of thrust faulting and folding during the Jura-Cretaceous which produced strongly foliated and overturned rocks trending northwest and dipping northeast.

The generalized ore stratigraphy reveals the apparent stratabound nature of the orebody within the hanging wall portion of the heavily strained and highly altered Mine Series rocks which consist of a zone of more mixed sediments and mafic volcanics, with minor felsic to intermediate volcanics. The orebody lies near the interface of altered mixed sediments and predominantly altered argillites/wackes. Original terms such as "sericitic tuffs" for the mixed sediments, and "muddy tuffs"

for the altered argillite/wackes are now largely out of favour as it is really alteration products that one sees rather than original lithologies.

The mixed sedimentary unit (SERT) is characterized by a strong yellow to white sericitic content, interbedded with up to 30 per cent cherty/quartz lenses. The altered argillites (MUT) are characterized by light silvery grey muscovite and sericite. They may also often locally contain up to 60 per cent very fine-grained pyrite and host low grade values of base and precious metals. Both units represent altered lithologies; their protoliths were probably variations of an original argillite/wacke/tuff sequence. Both the SERT and MUT lie structurally below a thick unit of chloritic mafic volcanics, which in the deposit area are most commonly tuffaceous to lapilli in texture; but with an occasional pillowed component.

The Samatosum deposit is an early, highly deformed quartz vein system containing massive to disseminated components of tetrahedrite, sphalerite, galena and chalcopyrite hosted in structurally complex wallrocks. The upper portion of the orebody is tabular, averages about 5 metres in thickness, and has a northwesterly strike length of about 500 metres and dips at an average of 30 degrees northeasterly for 100-150 metres. The principal ore-related gangue minerals are quartz (30 per cent), dolomite (19 per cent) and pyrite (11 per cent). Sericite and muscovite are by far the dominant alteration minerals in the Mine Series rocks and are thought to be a deformational product of the original ore-related alteration. Other significant alteration in the deposit area includes: silicification or silica flooding of portions of wallrock surrounding the orebody.

Mine stripping began in March 1989; ore production and milling began in May 1989; shipments began in June 1989. Mining ceased in July 1992 and milling ceased in September 1992. The mine operation reported a total 554,873 tonnes milled from which was recovered 429,356,776 grams silver, 639,118 grams gold 9,538,263 kilograms zinc, 5,069,127 kilograms lead and 3,678,016 kilograms copper.

**TABLE 6. SUMMARY OF MINERAL OCCURRENCES\* IN THE MOORE REGION**

MINFILE #.	Names	Status	Commodities	Deposit Type	Easting	Northing	Zone
082M 008	FH	Prospect	CU, AG	Noranda/Kuroko VMS	297593	5712091	11
082M 009	<b>HARPER CREEK</b>	Developed Prospect	CU, AG, AU, TI, ZN, PB, MO	Noranda/Kuroko VMS	304511	5711356	11
082M 010	BEX ZONE	Prospect	CU		309745	5686106	11
082M 020	TWIN MOUNTAIN	Prospect	PB, ZN, AG, CU, AU, BA	Noranda/Kuroko VMS	305623	5667859	11
082M 025	<b>HOMESTAKE</b>	Past Producer	AG, PB, ZN, AU, CU, BA, MI	Noranda/Kuroko VMS	301989	5665987	11
082M 026	BIRMOLY	Showing	MO	Porphyry Mo (Low F)	294640	5696279	11
082M 029	FOGHORN	Past Producer	AG, PB, ZN, CU, AU		295139	5713427	11
082M 030	SHAMROCK	Showing	PB, AG, AU		297469	5713798	11
082M 040	CHIDGRIN	Showing	AG, PB, ZN, CU, AU	Polymetallic Vein	295158	5713890	11
082M 041	KELLY'S	Showing	PB, ZN	Polymetallic Vein	295661	5712014	11
082M 048	FOGGY 11	Prospect	CU, PB, ZN, AG	Sedex Zn-Pb-Ag	299364	5712949	11
082M 049	GRIZZLY	Showing	CU, AG, ZN, MO, AU	Polymetallic Vein	308293	5686160	11
082M 050	RENNING	Showing	AG, ZN, CU, PB	Polymetallic Vein	307592	5685568	11
082M 051	<b>EBL</b>	Prospect	CU, PB, ZN, AG, AU, MO	Noranda/Kuroko VMS	306799	5690237	11
082M 052	H	Showing	MO	Porphyry	301187	5695401	11
082M 057	ROSE	Showing	ZN	Polymetallic Vein Sedex Zn-Pb-Ag	311766	5667167	11
082M 058	KAJUN	Showing	AG, PB, ZN, CU, AU	Polymetallic Vein	304557	5682281	11
082M 059	<b>CC</b>	Showing	ZN, PB, AG, CU	Noranda/Kuroko VMS	297681	5689971	11
082M 060	HARPER	Prospect	CU, ZN, PB, AG, AU	Noranda/Kuroko VMS	300849	5691703	11
082M 061	<b>RUTH</b>	Showing	AG, PB, ZN, CU, AU	Polymetallic Vein	305473	5685957	11
082M 062	BAR-BARRIERE	Showing	MO	Porphyry Mo (Low F)	300704	5697894	11
082M 063	SITTING BULL	Showing	CU, AG, AU	Polymetallic Vein Noranda/Kuroko VMS	299121	5692080	11
082M 064	NORTH STAR (NORTH)	Showing	PB, ZN, AG, CU	Polymetallic Vein	291428	5693471	11
082M 065	ENERGITE	Past Producer	PB, AG, ZN, CU, AU	Polymetallic Vein	291603	5693000	11
082M 066	WHITE ROCK (L.4023)	Showing	PB, AG, ZN, CU, AU	Polymetallic Vein	297752	5686875	11
082M 067	ANACONDA	Showing	CU, PB, ZN, AG, AU	Noranda/Kuroko VMS	296732	5690473	11
082M 069	SILVER MINERAL	Showing	AG, PB, AU	Polymetallic Vein	297716	5685949	11
082M 070	FORTUNA 2	Showing	PB, ZN, CU, AG, AU	Polymetallic Vein	293767	5693840	11
082M 071	KUNO	Showing	PB, AG, AU	Polymetallic Vein	294977	5695028	11
082M 072	FORTUNA 1	Showing	PB, AG, ZN, CU, AU	Polymetallic Vein	295252	5692233	11

082M 073	KUNIGUNDE	Showing	PB, AG	Polymetallic Vein	297321	5695553	11
082M 074	MAFALDA	Showing	PB, AG	Polymetallic Vein	297346	5696171	11
082M 076	AX	Showing	PB, CU	Sedex Zn-Pb-Ag Polymetallic Vein	306103	5676964	11
082M 107	STAKE	Showing	PB, ZN	Polymetallic Vein	299364	5668563	11
082M 108	FOGGY 3	Prospect	AG, PB, ZN, CU, AU	Noranda/Kuroko VMS Polymetallic Vein	294350	5712995	11
082M 109	VM	Showing	CU	Polymetallic Vein	310461	5710512	11
082M 110	<b>B &amp; B</b>	Showing	CU	Noranda/Kuroko VMS	303123	5690377	11
082M 112	VAL	Showing	MO	Porphyry Mo (Low F-type)	300015	5695138	11
082M 114	HILLTOP	Prospect	CU		316602	5706884	11
082M 115	HILLTOP 9	Showing	CU	Cu skarn	318248	5707042	11
082M 117	FENNELL ZONE	Showing	CU, AU, MO, NI		309033	5685205	11
082M 127	NSP	Showing	CU		317275	5685213	11
082M 130	BROKEN RIDGE	Showing	CU, PB, ZN, AG	Noranda/Kuroko VMS	299108	5691771	11
082M 131	MAY	Showing	CU, PB, ZN, AG	Noranda/Kuroko VMS	298703	5691323	11
082M 133	SIN	Showing	CU	Noranda/Kuroko VMS	313749	5710699	11
082M 134	KEYSTONE	Showing	CU		295225	5710794	11
082M 135	SAN	Past Producer	AG, PB, AU, ZN, CU	Polymetallic Vein	309043	5693245	11
082M 181	ADAMS LAKE	Showing	LS	Limestone	312704	5666205	11
082M 191	<b>REA GOLD</b>	Developed Prospect	AG, ZN, PB, AU, CU	Noranda/Kuroko VMS	302727	5669980	11
082M 194	JOSEPH	Prospect	AG, PB, ZN, CU, BA, AU	Noranda/Kuroko VMS	292442	5713537	11
082M 218	CHIP - DIXIE	Showing	CU, ZN, AU	Noranda/Kuroko VMS	291330	5681565	11
082M 219	PERCY	Showing	CU, AG, AU, PB, ZN	Noranda/Kuroko VMS	297573	5692141	11
082M 220	COPPER CLIFF	Showing	CU, PB, ZN, AG	Noranda/Kuroko VMS	296520	5690017	11
082M 221	RAINBOW	Showing	CU, PB, ZN, AG	Noranda/Kuroko VMS	296798	5689697	11
082M 222	CAD	Showing	ZN, PB, AG	Polymetallic Vein	300299	5687549	11
082M 223	<b>NSM (ADON V)</b>	Showing	PB, ZN, AG, CU, AU	Polymetallic Vein	306488	5687156	11
082M 238	KITTY	Showing	AG, MO, PB, WO		295388	5700425	11
082M 244	<b>SAMATOSUM</b>	Past Producer	AG, AU, ZN, PB, CU, SB	Noranda/Kuroko VMS Polymetallic Vein	303492	5669641	11
082M 272	LUCKY-J	Showing	GT	Crystalline flake graphite	310331	5692486	11
082M 274	E-D 1	Showing	AU, CU, BI, WO, ZN	Sulphide manto Au	291756	5694850	11
082M 275	LUCKY BEAR	Showing	WO, BI, ZN, AU	Intrusion-related Au pyrrhotite veins	314393	5688542	11
082M 276	TWIN 3	Prospect	AU, AG, ZN, PB, CU	Noranda/Kuroko VMS	304286	5668528	11
082M 277	K-7	Developed Prospect	AG, AU, ZN, PB, CU	Noranda/Kuroko VMS Polymetallic Vein	303223	5669218	11
092P 012	MILL	Showing	AU	Epithermal Au-Ag Hot spring Au-Ag	695220	5688613	10
092P 017	MONA	Showing	AU, AG	Au-quartz veins	692905	5683700	10
092P 030	LISA	Showing	AU, AG, PB, CU	Au-quartz veins	695713	5684858	10
092P 036	JUDY 4	Showing	MO	Porphyry Cu +/- Mo	705732	5707183	10

092P 037	JUDY 11	Showing	MO, CU	Porphyry Cu +/- Mo	705893	5705581	10
092P 038	LINE	Showing	CU, ZN, PB	Polymetallic Vein	705082	5706043	10
092P 039	WINDPASS	Past Producer	AU, CU, BI, AG	Polymetallic Vein	702502	5703003	10
092P 040	SWEET HOME (L.3844)	Past Producer	AU, CU, BI	Polymetallic Vein	702241	5702186	10
092P 041	GOLD HILL	Prospect	AU, AG, PB, CU, ZN	Polymetallic Vein	701414	5699617	10
092P 042	QUEEN BESS	Past Producer	PB, ZN, AG	Polymetallic Vein	698431	5715058	10
092P 043	GOLDEN LOON PLATINUM	Showing	PT, PD, AU, CR	Ultramafic Associated	691688	5700077	10
092P 045	DIXON CREEK PLACER	Past Producer	AU	Surficial placers	702154	5674994	10
092P 046	BARRIERE RIVER PLACER	Past Producer	AU	Surficial placers	706187	5677660	10
092P 051	MOUNT ARMOUR	Showing	CU, ZN	Noranda/Kuroko VMS	702520	5671606	10
092P 053	CHU CHUA COAL	Past Producer	CL	Sub-bituminous coal Bituminous coal	700217	5689208	10
092P 054	LOUIS CREEK PLACER	Past Producer	AU	Surficial placers	702615	5668208	10
092P 055	EAKIN CREEK PLACER	Past Producer	AU	Surficial placers	692820	5703893	10
092P 076	GOLDEN LOON 7	Showing	AU, AG, CU, PB	Au-quartz veins	691897	5700177	10
092P 081	LOUIS CREEK	Showing	GY	Bedded gypsum	701622	5670210	10
092P 094	GOLDEN LOON 6	Showing	AU, AG, PB	Au-quartz veins	691685	5699118	10
092P 101	CM	Prospect	CU, ZN, AU, AG	Cyprus massive sulphide Cu (Zn)	701074	5688128	10
092P 102	FISHTRAP CREEK	Showing	CU, NI	Flood Basalt-Associated Ni-Cu	691019	5671290	10
092P 123	MOE	Showing	MO	Porphyry Mo (Low F)	708303	5700049	10
092P 140	CHU CHUA	Developed Prospect	CU, ZN, AG, AU, CO, TC, MA, PB, MO	Cyprus VMS Cu (Zn)	704469	5696274	10
092P 148	JOSEPH CREEK	Showing	AE, GS	Jasper	697311	5705179	10
092P 149	BARRIERE RIVER	Showing	RO, GS	Surficial placers Rhodonite	704574	5677163	10
092P 159	BARRIERE	Developed Prospect	FD	Feldspar-quartz pegmatite	692248	5675356	10
092P 160	SC	Showing	AG, AU	Noranda/Kuroko VMS	708882	5686833	10
092P 165	OLIE	Showing	CU, AU	Au-quartz veins Porphyry	691117	5705000	10
092P 174	HONEYMOON	Prospect	AU, AG, CU, PB, ZN	Polymetallic Vein	704521	5713259	10
092P 187	MCCARTHY	Prospect	CU, AU	Cyprus VMS Cu (Zn)	701261	5712757	10

\*from MINFILE, the BC government mineral occurrence database.

## **24 OTHER RELEVANT DATA AND INFORMATION**

No other data or information are relevant for this report.

## **25 INTERPRETATION AND CONCLUSIONS**

In general, mineralization at the EBL deposit consists of disseminated pyrite, pyrrhotite and lesser chalcopyrite in a dominantly chlorite schist unit. Massive sulphides have

been observed with one historical drillhole intersecting over 4 metres (DDH 74.6). Government studies of the area by Schiarizza and Preto (1987) and by Hoy (1997) have noted the similar style and geological setting of the Moore property (EBL) to that of the significant Harper Creek deposit some 24 kilometres to the north, where disseminated sulphides and associated massive sulphides are also observed. The Harper Creek deposit is interpreted to be a volcanogenic sulphide deposits and Hoy (1997) further suggests that the disseminated sulphide “deposits” found in the area, such as the EBL deposit on the Moore property may be of similar character. However, because of the close spatial association of quartz feldspar orthogneiss units (subvolcanic intrusions), Schiarizza (personal communication, 2012) still considers them more likely to be deformed and metamorphosed porphyry copper deposits.

The 2006 IP survey encountered a strong response over much of the survey area within the Moore property. The response consisted of eight anomalous zones labeled A to G with A to D considered of significant size to warrant being drilled in a follow up drill program that occurred in 2008, 2009 and 2010 (Figure 6).

Anomalous zone A contains the main part of the EBL deposit where much of the historical drilling occurred and where most of the 2008-2010 drilling was completed. The A zone, as defined by the IP survey is up to 950 metre wide and has a northerly strike length of at least 1700 metres. In 2008, DDH-08-04 intersected 177.63 metres (from 47.77 to 225.6 metres depth) of 0.2% copper with a sub-interval of 10.75 metres (from 59.65-70.4) of 0.63% copper. A 6 metre sub-interval (from 59.65 to 65.65) assayed 0.9% copper and contained 4 metres of 10.5 g/t of silver and 2 metres of 0.5 g/t gold. Overall precious metal values from all 2008-2009 drillholes can be characterized as sporadic. Several other drillholes in Anomalous zone A contained significant mineralized intersections. Near the bottom of DDH-10-04A, an 18.29-metre intersection (from 195.07-213.36) graded 0.4% copper. Drilling indicates significant mineralization is open to depth.

Anomaly B, occurring just east of Anomaly A, strikes north-northwesterly, having a width of 300 metres and a minimum length of 1100 metres, being open to the north. Hole 08-03 intersected 20.44 metres of 0.49% copper and 0.068 g/t gold from 22.86 to 43.30 metres and holes 10-21 and 10-24 yielded significant sulphide-bearing intersections with copper and minor silver and gold values. Hole 10-24 intersected 1 metre of 0.57% copper near the bottom of the hole indicating that mineralization is open to depth.

A 1970 reverse circulation drillhole (P-70-9), located just east of Anomaly A and just west of Anomaly B contained 64.7 meters grading 0.352% copper with a higher grade intercept of 0.96% copper over 6.1 meters. Hole 74-6, 250 metres south-southeast of Hold 70-9, intersected about 4.3 metres of massive sulphide (from 29.56-33.83 metres) consisting of pyrite, pyrrhotite and chalcopyrite (Northcote, 1981). This may represent a volcanogenic horizon.

Anomalous zone C occurs within the northwest corner of the survey area strikes northerly with a minimum strike length of 600 meters. Its width is up to 700 meters. No historical drilling is known to have been done in this area. Drilling in 2008 and 2009 (DDH-08-09, DDH-09-18, DDH-09-19 and DDH-09-10) yielded some weak, sporadic precious metal values and copper values but was in general lacking in significant results.

Anomaly D occurs within the southern part of the grid area to the south and east of anomalous zone A. It strikes northerly with a minimum strike length of 1000 metre being open to the south and having a width of up to 280 meters. Anomaly D was tested by drillhole DDH-10-28, which had significant results for copper over narrow intersections and elevated values in gold and should be explored to deeper depths.

The McLellan chalcopyrite-rich massive sulphide zone discussed in Section 6 (History), is reported to be 60 metres long and 10 to 20 cm thick (Figure 6). It is located just east of the east end of IP grid line 1400N. Historical soil geochemical surveys outlined two mineralized areas, a lead-zinc zone with possible gold potential to the north, and a larger copper-barium zone to the south. The McLellan region represents a possible volcanogenic massive sulphide target that was not tested by 2006 geophysics or 2008-2010 drilling. The copper-barium soil anomaly in this area is of interest due to the volcanogenic massive sulphide deposit affinity of barite and its implication for Moore property deposit-type classification.

The A and B IP zones on the EBL deposit are the most attractive exploration targets on the property, based on the results of significant intercepts from 2008-2010 drilling. Four subsurface 'units' have been defined based on metamorphism, mineralization style and intensity, as well as lithology. Deeper, systematic drilling needs to be done in areas where previous drilling such as holes 08-03, 08-04 and 10-04A yielded important results. At least one hole to 500 metres below surface would show how mineralization and grades vary with depth and give a better idea of its ultimate size potential. The A, B and C IP zones have not been fully constrained at their northern extent and the mineralized zone may extend north. Further drilling must also be done in order to test mineralization towards the marginal limits of the IP anomalies.

The Moore property mineralization has a documented similarity to the Harper Creek deposit, to the north, where an extensive volcanogenic sulphide system has recently been found to contain a total Measured and Indicated Resource of 815Mt at 0.29% Cu, 0.032 g/t Au and 1.3 g/t Ag. Given this important, nearby development and the recent corroboration of significant widespread mineralization on Moore property further exploration is warranted.

## 26 RECOMMENDATIONS

Sixteen holes averaging 250 metres in length and one 500 metres in length are recommended in on IP Anomalous zone A and B, specifically in the area of previous drilled holes DDH 08-04 and DDH-10-4A that intersected significant mineralization which is open to depth. Drilling should be conducted on 100-metre centres about the two holes, drilled east and west from the same setup. Holes should be drilled at an inclination of 70 degrees. One vertical hole between the hole 04 and 04A should be drilled to 500 metres to show how mineralization and grades vary with depth and give a better idea of its ultimate size potential.

The 2006 IP geophysical lines should be extended east at least 1 km to cover the area of the massive sulphide McLellan zone and Hole 74-6 that contained over 4 metres of massive iron and copper sulphide mineralization. An extension of IP to the north of Anomaly A and B is warranted if topography permits. Line extension include at least two 3km east-west lines to the north of Line 2100N and 1 km extensions to all lines from 900 to 2100N, for a total of 14 km of IP line.

Two holes should be drilled in the McLellan and historical Hole 74-6 massive sulphide vicinity. Records of this hole indicate 4 metres of copper bearing massive sulphides, but no assays were published. Actual drill sites will depend upon local terrain, since local topography is rugged and boggy.

It is also recommended that NSM and B&B showing areas, that may represent volcanogenic massive sulphides on the Moore property, receive on-site geological assessment towards their development as secondary targets.

### 26.1 PROPOSED BUDGET

The following assumptions are used for planning purposes and the cost estimates:

2 geologist and 3 person crew and 1 cook for 60 days in a drive-in camp.

Item	Description	Amount (\$Cdn)
Personnel	Geologists and core processing crew	120,000
Room, Board and camp costs (crew and drill crew)	\$150/day/man for approx 7 men	60,000
Induced Polarization/ground magnetics surveys		70,000
Diamond Drilling (all in)	5000 metres @ \$150/metre	750,000
Geochemical analyses		100,000
Logistic, travel and support etc.		10,000
Compilation, Interpretation and Report		20,000
Contingency (~15%)		170,000
<b>Total Estimated Cost</b>		<b><u>1,300,000</u></b>

The total budget for the recommended work program on the Moore property is \$1,300,000

In the author's opinion, the proposed recommendations are warranted as outlined, and could be completed within a single field season.

## **27 REFERENCES**

Baird, J.G. (1970): Report on an Induced Polarization Survey, for Royal Canadian Ventures Ltd; *British Columbia Ministry of Energy and Mines*, Assessment Report 2680, 10 pages.

Bridge, D.J. (2001): Geological and Geochemical Report on the Moore Property, for Ram Vallabh; *British Columbia Ministry of Energy and Mines*, Assessment Report 26597.

Bridge, D.J. (2004): Summary Report on the Moore Base and Precious Metal Property, Kamloops Mining Division, Central British Columbia, for Almo Capital Corp., Company report by David Bridge (M.Sc, P.Geo), dated August 25, 2004 filed on Sedar on September 10, 2004 under Almo Capital's Profile.

Brynelson, B.O., Knauer, J.D. and Reinertson, L.C. (1971): Combined Geochemical and Geophysical Report on the REM 10, 12, 14, 15, 17, 18, EBL 13, 21-31, 37, 38, 50, 55A, 56A, 57-61, B&B 1-2, N Lake S Shore 1 & 2, for Noranda Exploration Company ; *British Columbia Ministry of Energy and Mines*, Assessment Report 3431, 12 pages.

Caulfield, D.A. and Ikona, C.K. (1987): 1986 Summary Report on the Adon Project, for Titan Resources Ltd.; *British Columbia Ministry of Energy and Mines*, Assessment Report 15483

Goodall, G.N. (1991): Report on a Trenching Program on the McLellan Property, for Rea Gold Corporation; *British Columbia Ministry of Energy and Mines*, Assessment Report 21605, 26 pages.

Gower, S.C. and Stevenson, R.W., (1976): Report on Soil Geochemical Survey, Barriere Lake IV Claim Group, for Kennco Explorations (Western) Limited; *British Columbia Ministry of Energy and Mines*, Assessment Report 5973, 18 pages.

Hallof, P.G. and Smith, P.K., 1972. Report on the Induced Polarization and Resistivity Survey on the B&B Claim Group, Barriere Area, for Cragimont Mines Limited; *British Columbia Ministry of Energy and Mines*, Assessment Report 3884, 11 pages.

Hoy, Trygve (1997): Harper Creek: A Volcanogenic Sulphide Deposit Within the Eagle Bay Assemblage, Kootenay Terrane, Southern British Columbia (082M/12); *British Columbia Ministry of Energy and Mine*, Geological Fieldwork 1996, Paper 1997-1

Kumar, A. (2012): Summary Report on 2008, 2009 and 2011 Drilling, Moore Property, Private Company Report for Almo Capital Corp.

Leishman, D.A. and Dawson, J.M. (1984): Geochemical and Geological Report on the Adon Property, for Titan Resources Ltd; *British Columbia Ministry of Energy and Mines*, Assessment Report 13334.

Mark, David G. (2007): Geophysical Report on I.P. and Resistivity Surveys over the Moore Mining Property, for Almo Capital Corp; *British Columbia Ministry of Energy and Mines*, Assessment Report 28579.

Misener, D.J., and Mullan, A.W. (1973): Report on the Combined Airborne Magnetic and Electromagnetic Survey on the EBL and Kajun Claim Groups, for Western Mines Limited; *British Columbia Ministry of Energy and Mines*, Assessment Report 4685, 15 pages.

Moraal, D. (1986): Grid and Sabre VLF Survey, Gem Group, for Larry Ovington; *British Columbia Ministry of Energy and Mines*, Assessment Report 15347, 18 pages.

Northcote, K.E. (1981): Geological Report on EBL - REM Claims; Assessment Report 9203, 24 pages.

Northcote, K.E. (1982a): Geological Report on EBL - REM Claims; *British Columbia Ministry of Energy and Mines*, Assessment Report 10435, 20 pages.

Northcote, K.E. (1982b): Geological Report on EBL - REM Claims; *British Columbia Ministry of Energy and Mines*, Assessment Report 10584, 31 pages.

Northcote, K.E. (1983): Geological Geophysical Report on EBL - REM Claim Group, East Barriere Lake, Kamloops M.D.; *British Columbia Ministry of Energy and Mines*, Assessment Report 11386, 13 pages.

Northcote, K.E. (1986): Rock and Soil Geochemistry Program, EBL Claim Group; *British Columbia Ministry of Energy and Mines*, Assessment Report 14950, 22 pages.

Preto, V. A. and Schiarizza, P. (1984): Geology of the Adams Plateau-Clearwater Area; *British Columbia Ministry of Energy and Mines*, Preliminary Map 56.

Schiarizza, P. and Preto, V.A. (1987): Geology of the Adams Plateau - Clearwater - Vavenby Area, *British Columbia Ministry of Energy and Mines*, Paper 1987-2, 88 pages.

Stewart, A. (1979): Geochemical, Geophysical and Diamond Drilling Report on the Lesly and LG 1 Claims, for Esso Resources Canada Limited; *British Columbia Ministry of Energy and Mines*, Assessment Report 7254.

Thompson, I.S. (1970): Geological, Geophysical, Geochemical and Drilling Report on the 82 M/5 EBL Group, for Royal Canadian Ventures Ltd, *British Columbia Ministry of Energy and Mines*, Assessment Report 2989, 21 pages.

Topham, S.L. (1991): Geochemical Report on the McLellan Property, for Rea Gold Corporation; *British Columbia Ministry of Energy and Mines*, Assessment Report 21047

Vollo, N.B. (1969): Geophysical and Geochemical Report on the 82M/5 EBL Group, for Royal Canadian Ventures Ltd; *British Columbia Ministry of Energy and Mines*, Assessment Report 2369, 14 pages.

Vollo, N.B. (1970): Geological, Geophysical and Geochemical Report on the 82M/5 B&B Group, for Royal Canadian Ventures Ltd; *British Columbia Ministry of Energy and Mines*, Assessment Report 2679, 11 pages.

Vallabh, R. (2010): Summary Report on Moore Property, Diamond Drilling Program, for Almo Capital Corp, private, unpublished company report dated December, 2010.

Walker, T. (1994): Assessment Report on the Norr Property, for Agate Bay Resources Ltd.; *British Columbia Ministry of Energy and Mines*, Assessment Report 23343, 31 pages.

White, G.E., (1987): Geophysical Report on Induced Polarization, Magnetometer and VLF Electromagnetic Surveys - Adon and Sob Claims, for Runaway Resources Ltd., *British Columbia Ministry of Energy and Mines*, Assessment Report 16939A.

White, G.E., (1988): Geochemical Report on Adon and Sob Claims, for Runaway Resources Ltd., *British Columbia Ministry of Energy and Mines*, Assessment Report 16939B.

Yeager, D., Darney, R. and Ikona, C.K. (1986): Geochemical and Geological Report on the Adon Property, for Titan Resources Ltd; *British Columbia Ministry of Energy and Mines*, Assessment Report 14392.

## **28 DATE AND SIGNATURE PAGE**

I, David Mark, P.Ge, as the author of the report entitled "Technical Report on the Moore Property" do hereby certify that:

- 1) I am a self-employed consulting geophysicist residing at 6204 125<sup>th</sup>, Street, Surrey, B.C., V3X 2E1.
- 2) I graduated with a Bachelor of Science degree in Geological Sciences from the University of British Columbia, Vancouver, British Columbia in 1968.
- 3) I am registered as a Professional Geoscientist with the Association of Professional Engineers and Geoscientists of the Province of British Columbia (license #20608), in good standing since 1993.
- 4) I have worked continuously as a geophysicist for forty four years since my graduation from university.
- 5) I have read the definition of "qualified person" set out in National Instrument 43-101 ("NI 43-101") and certify that by reason of my education, affiliation with a professional association (as defined in NI 43-10 1) and past relevant work experience, I fulfill the requirements to be a "qualified person" for the purposes of NI 43-101.
- 6) I am responsible for all the sections of the report entitled "Technical Report on the Moore Property" dated May 25<sup>th</sup>, 2012, of which I am the author. I ran the 2006 exploration program on the Moore Property consisting of an IP/resistivity survey during the month of July and I initiated the drilling program in July of 2008. I also visited the Moore property on July 12<sup>th</sup>, 2012 in order to examine the drill hole locations.
- 7) I am not aware of any material fact or material change with respect to the subject matter of the Technical Report that is not reflected in the Technical Report, the omission to disclose of which makes the Technical Report misleading.
- 8) I am independent of the issuer applying the tests set out in section 1.5 of National Instrument 43-101. I have no interest in the property nor do I expect to receive any interest in this property or any other owned by the issuer.
- 9) I have read National Instrument 43-101 and Form 43-101F1, and the Technical Report has been prepared in compliance with that instrument and form.
- 10) I consent to the filing of the Technical Report with any stock exchange and other regulatory authority and any publication by them, including electronic publication in the public company files on their websites accessible by the public, of the Technical Report.

Dated this 15<sup>th</sup> day of August 2012 at Surrey, British Columbia.



David G. Mark, P.Ge.



## **APPENDIX A**

### **Pertinent Maps and Diagrams From David Bridge (2004) On Moore Property History**

NORTH BARRIERE LAKE

FENNEL CREEK

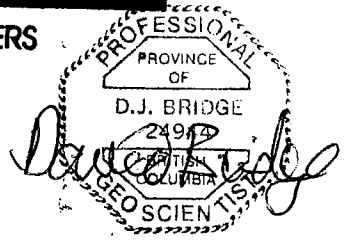
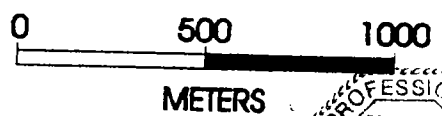
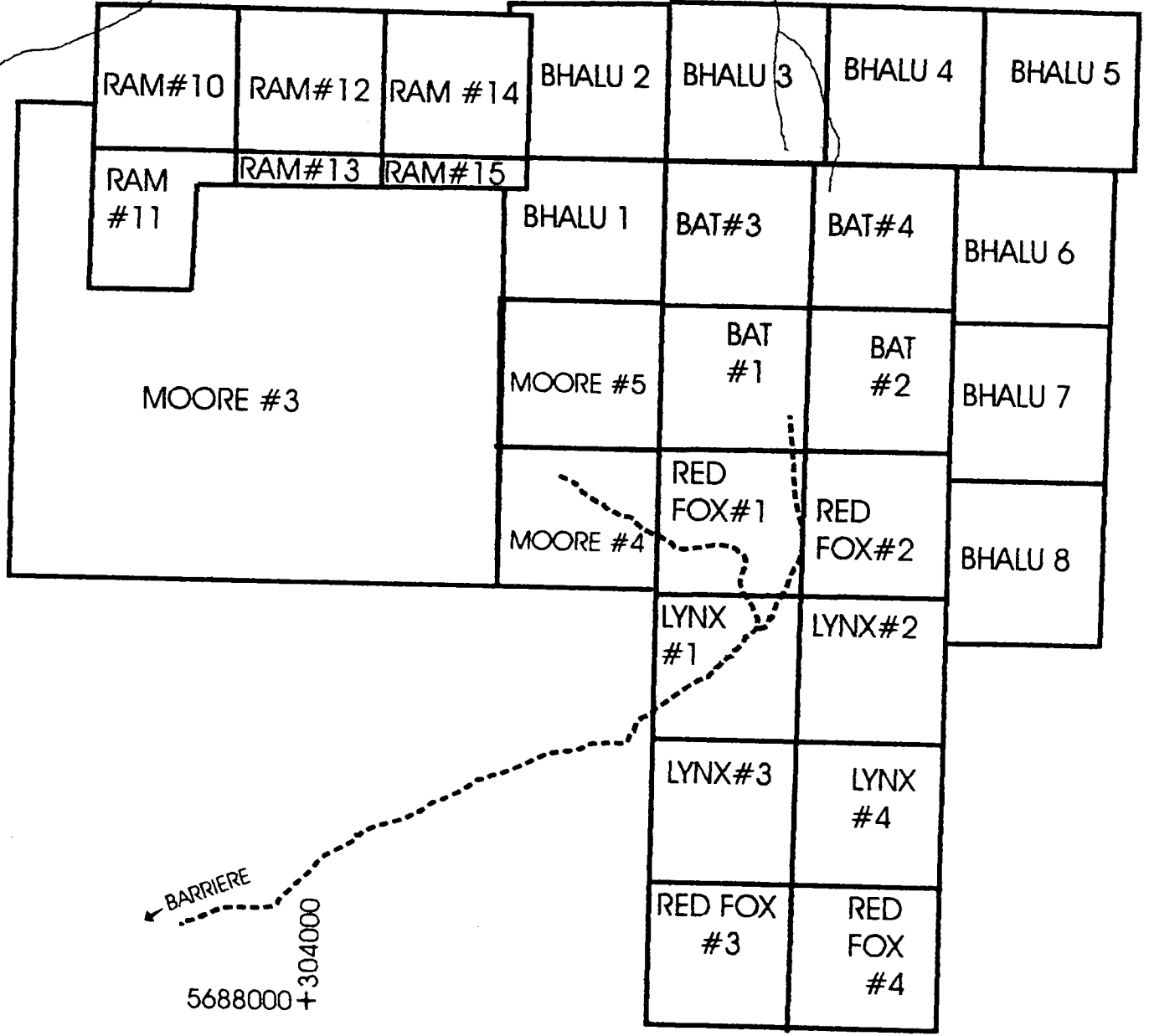

<b>MOORE PROPERTY</b>	
KAMLOOPS MINING DIVISION	82M05W
<b>CLAIM MAP OF THE MOORE PROPERTY</b>	
DRAWN BY DJB DATE AUGUST, 2004	FIGURE 2

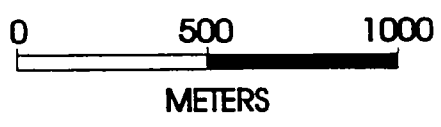
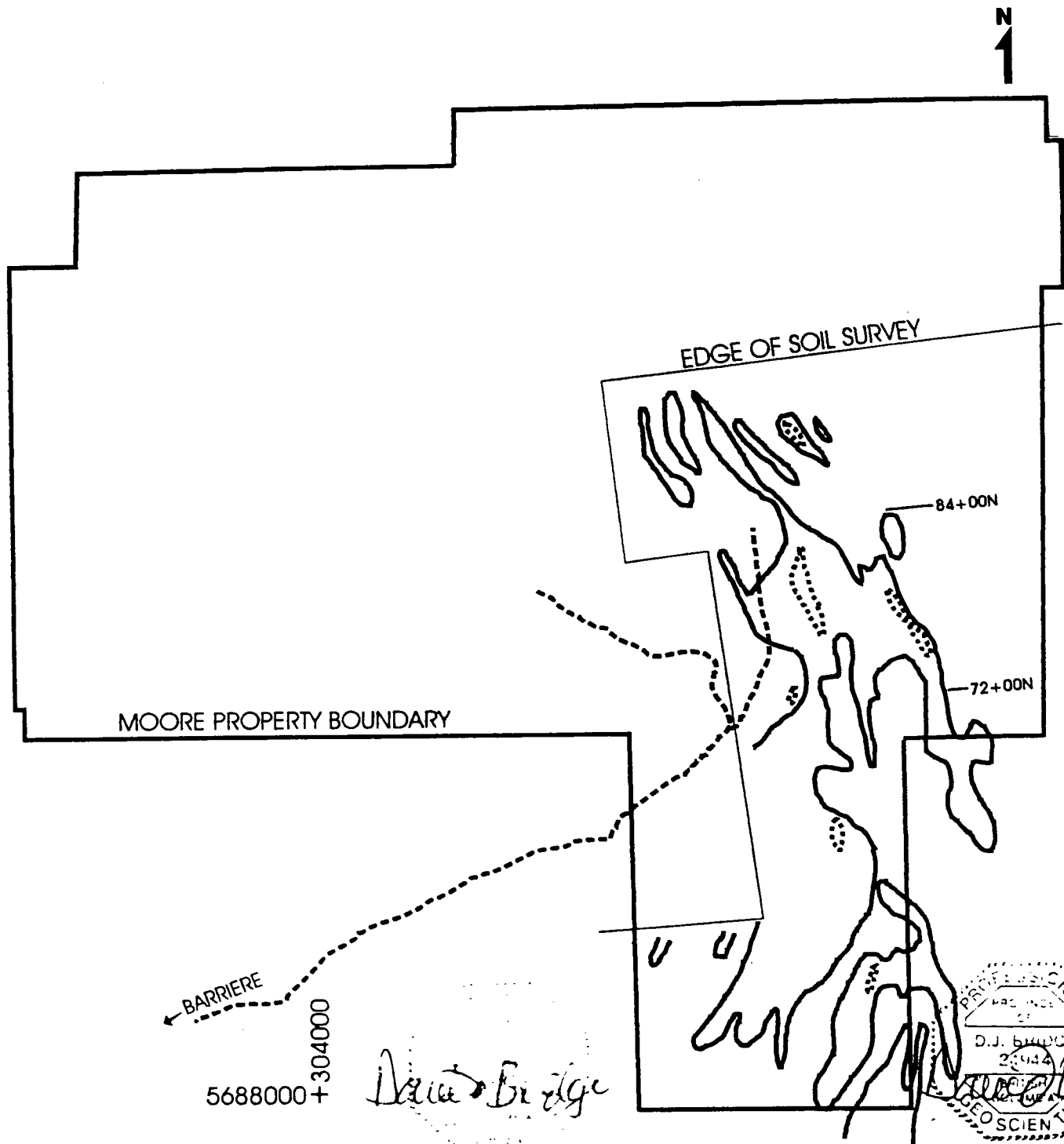

- 200 PPM COPPER CONTOUR
- ..... 1000 PPM COPPER CONTOUR

<b>MOORE PROPERTY</b>	
KAMLOOPS MINING DIVISION	82M05W
<b>COPPER SOIL CONTOURS FOR THE MOORE PROPERTY (MODIFIED FROM VOLLO (1969))</b>	
DRAWN BY DJB DATE APRIL 2002	FIGURE 4

NORTH BARRIERE LAKE

FENNEL CREEK

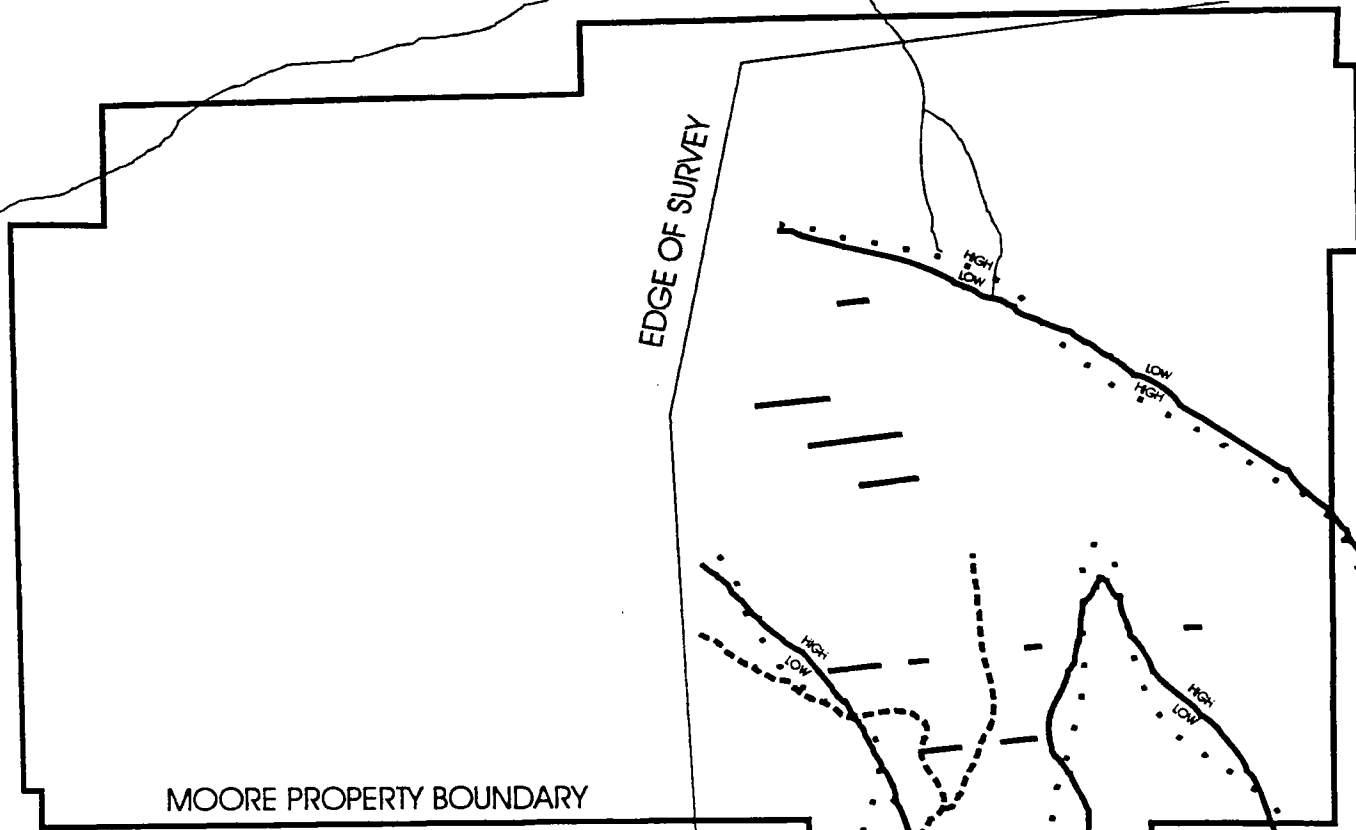



MOORE PROPERTY BOUNDARY

← BARRIERE  
5688000 + 304000

*David Bridg*  
PROFESSIONAL  
GEOLOGIST  
PROVINCE OF  
BRITISH COLUMBIA

*David Bridg*  
PROFESSIONAL  
GEOLOGIST  
PROVINCE OF  
BRITISH COLUMBIA

-  CHARGEABILITY CONTACT (APPROX. 20 MILLISECONDS)
-  RESISTIVITY CONTACT (APPROX. 500 OHM-METERS)
-  INTERPRETED NEAREST SURFACE LOCATION OF SOME RELATIVELY CONFINED BODIES OF INCREASED CHARGEABILITY



<b>MOORE PROPERTY</b>	
KAMLOOPS MINING DIVISION	82M05W
<b>INDUCED POLARIZATION SURVEY OF THE MOORE PROPERTY (MODIFIED FROM BAIRD (1970))</b>	
DRAWN BY DJB DATE APRIL 2002	FIGURE 5

Royal Canadian Ventures Ltd. drilled 12 percussion holes totaling 889 meters (Thompson, 1970). The drilling was done by H.N. Horning Percussion Drilling Ltd. of Kamloops using Atlas Copco Equipment. Figure 6 shows the location of the drill holes and figures 7A and 7B shows some results of the drilling. Most of the drill holes were vertical. Figures 7A and 7B show that some of the drill holes ended in mineralization or had significant intervals of copper mineralization near the end of the drill holes. These areas warrant follow up drilling with the core assayed for copper, gold, silver, lead and zinc. Drill core of previous work is not available. The following intervals are mineralized and they are listed in Table 2.

Table 2. Mineralized intervals from percussion holes on the Moore Property.

Hole	Footage (meters)	Length (meters)	% Copper
P-70-2	21.3-36.6	15.3	0.190
	42.7-70.1	27.4	0.180
P-70-5	39.6-64.0	24.4	0.275
	incl. 54.9-61.0	6.1	0.435
	64.0-89.9 (end)	25.9	0.103
P-70-6	2.4 - 36.6	34.2	0.282
	(including) 21.3-33.5	12.2	0.410
	54.9 - 67.1 (end)	12.2	0.180
P-70-8	54.9 - 67.1	12.2	0.360
	54.9 - 76.2	21.3	0.177
P-70-9	2.4 - 30.5	28.1	0.375
	30.5 - 48.8	18.3	0.116
	48.8 - 67.1	18.3	0.586
	(including) 48.8 - 54.9	6.1	0.960
	2.4 - 67.1	64.7	0.352
P-70-10	9.1 - 15.2	6.1	0.195
NE2	30.5 - 76.2	45.7	0.35
NE8	42.7 - 48.8	6.1	0.89

NORTH BARRIERE LAKE

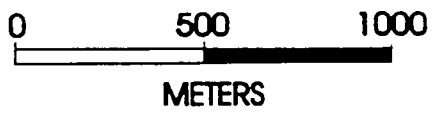
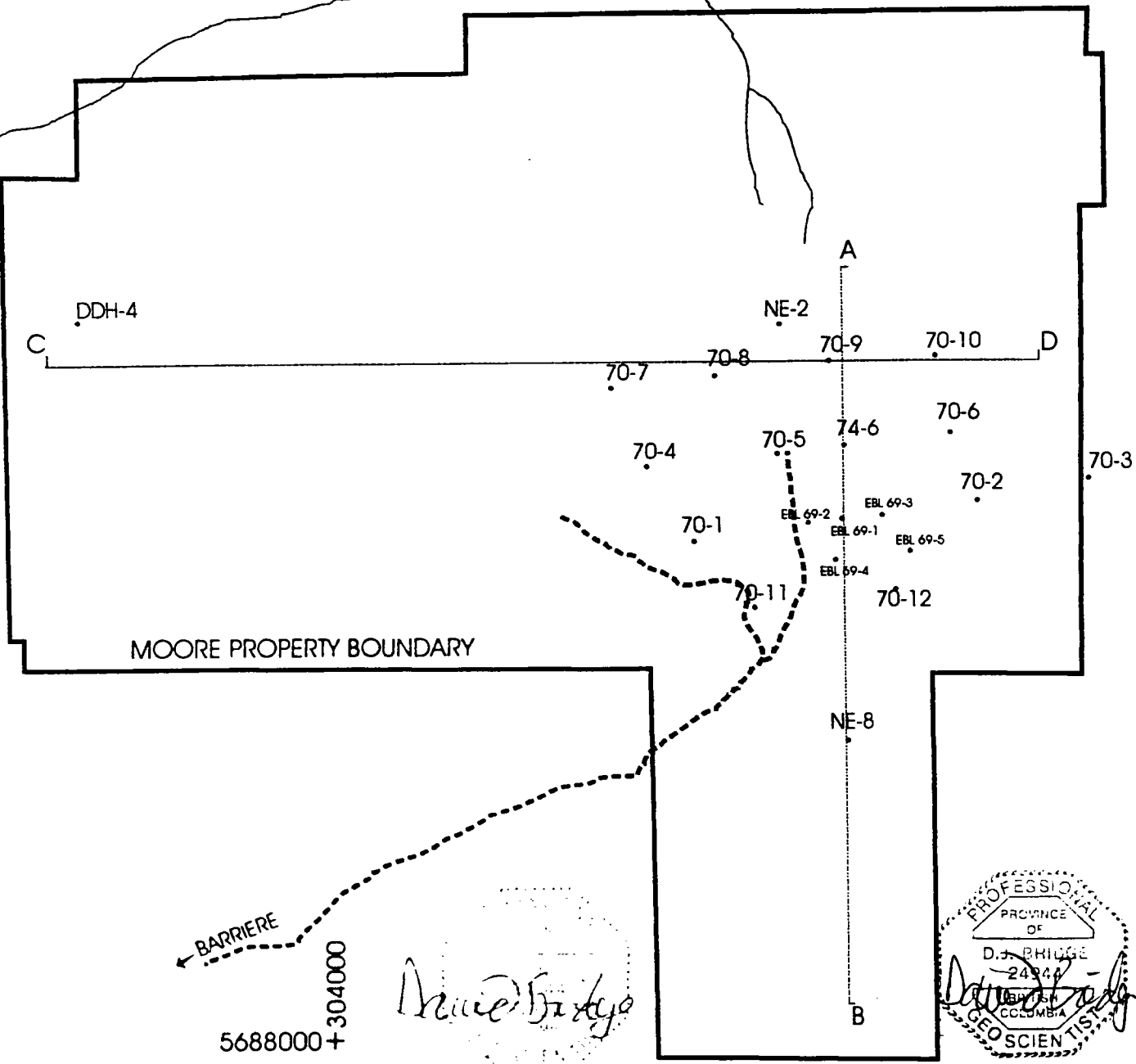

● DRILL HOLE

— CROSS SECTION

<b>MOORE PROPERTY</b>	
KAMLOOPS MINING DIVISION	82M05W
MAP SHOWING LOCATION OF DRILL HOLES AND CROSS SECTIONS 'A-B' AND 'C-D' DESCRIBED IN THIS REPORT	
DRAWN BY DJB DATE APRIL, 2002	FIGURE 6

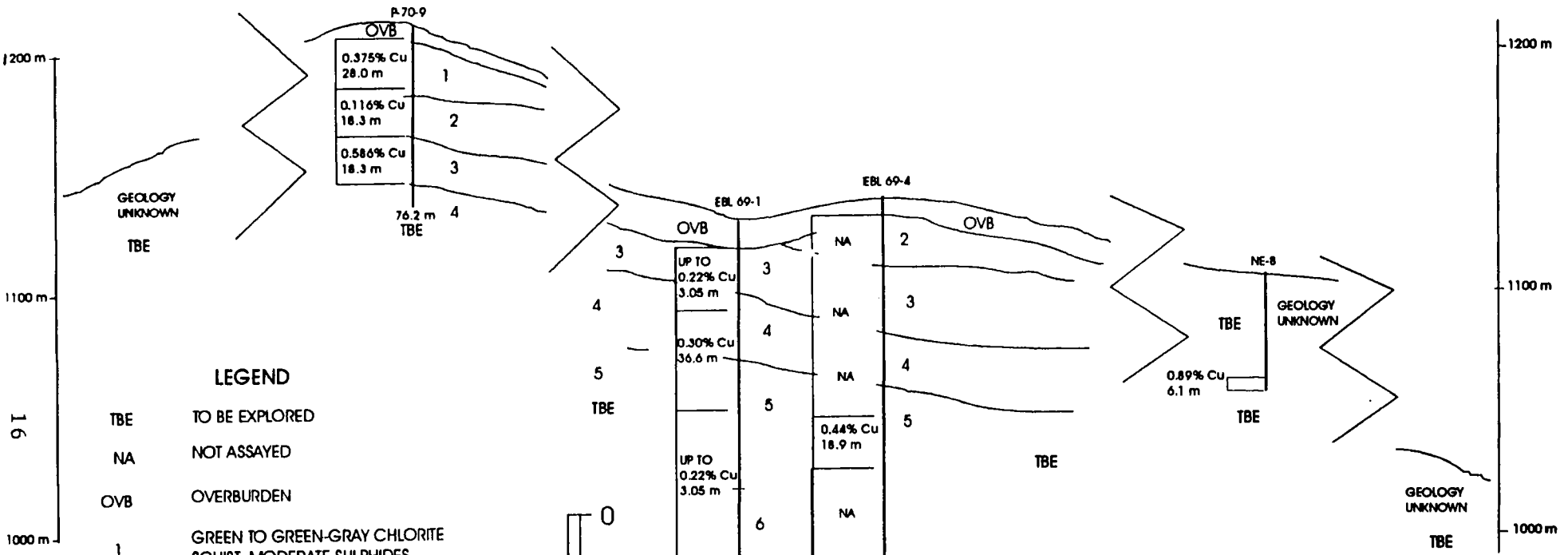

**LEGEND**

- TBE TO BE EXPLORED
- NA NOT ASSAYED
- OVB OVERBURDEN
- 1 GREEN TO GREEN-GRAY CHLORITE SCHIST. MODERATE SULPHIDES
- 2 WHITE TO WHITE/GRAY SERICITE SCHIST. LOW SULPHIDES (VARIABLY GRAPHITIC)
- 3 GREEN OR GREEN/GRAY CHLORITE SCHIST. MODERATE SULPHIDES
- 4 WHITE/GRAY SERICITE SCHIST TO GREEN/GRAY CHLORITE SCHIST MODERATE TO STRONG MINERALIZATION
- 5 GREEN/GRAY CHLORITE SCHIST - ARGILLITE
- 6 CHLORITE AND SERICITE SCHIST

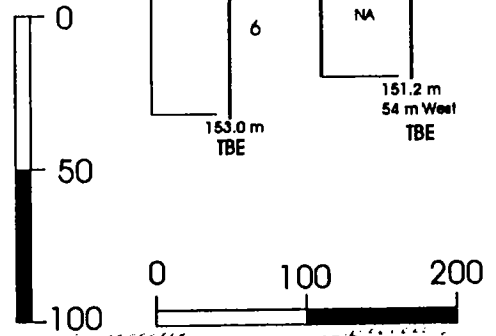

**MOORE PROPERTY**

KAMLOOPS MINING DIVISION      82M05W

---

**CROSS SECTION 'A-B' SHOWING SURROUNDING AREAS TO KNOWN COPPER MINERALIZATION TO BE FURTHER EXPLORED (MODIFIED FROM THOMPSON P. Eng (1970))**

---

DRAWN BY DJB      DATE APRIL 2002      FIGURE 7A

PROFESSIONAL GEOLOGIST  
 PROVINCE OF BRITISH COLUMBIA  
 D.J. BRIDGE  
 24744  
 VICTORIA, BRITISH COLUMBIA

*D.J. Bridge*

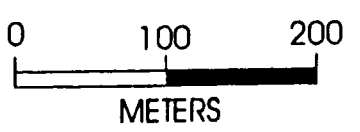
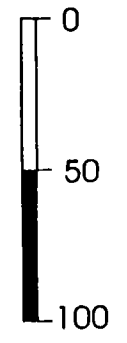
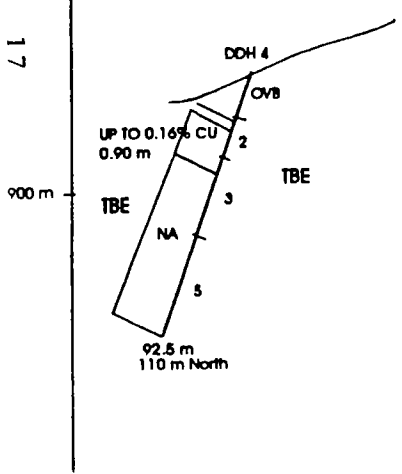
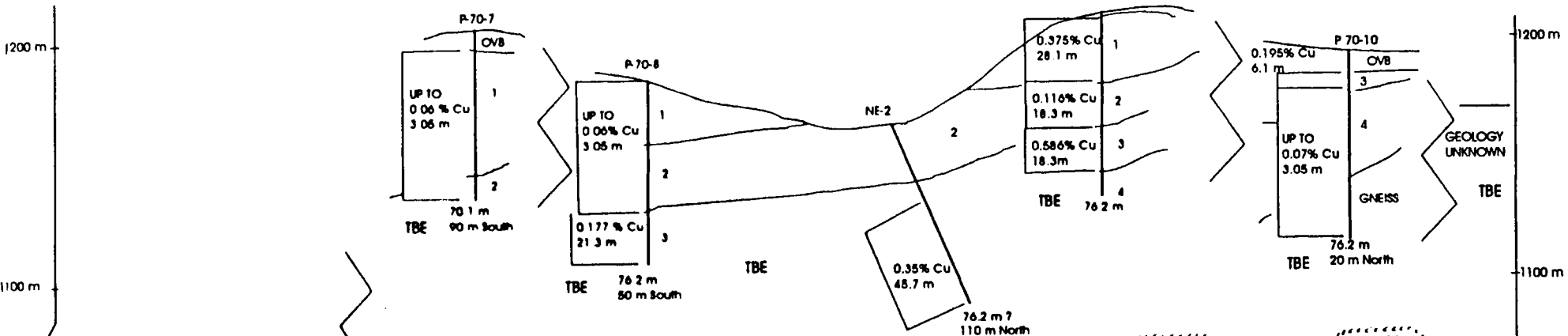

**LEGEND**

- TBE TO BE EXPLORED
- NA NOT ASSAYED
- OVB OVERBURDEN
- 1 GREEN TO GREEN-GRAY CHLORITE SCHIST. MODERATE SULPHIDES
- 2 WHITE TO WHITE/GRAY SERICITE SCHIST. LOW SULPHIDES (VARIABLY GRAPHITIC)
- 3 GREEN OR GREEN/GRAY CHLORITE SCHIST. MODERATE SULPHIDES
- 4 WHITE/GRAY SERICITE SCHIST TO GREEN/GRAY CHLORITE SCHIST MODERATE TO STRONG MINERALIZATION
- 5 GREEN/GRAY CHLORITE SCHIST - ARGILLITE
- 6 CHLORITE AND SERICITE SCHIST

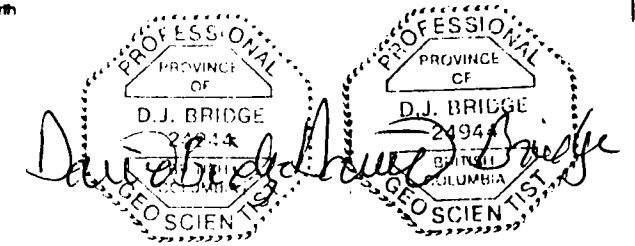

**MOORE PROPERTY**

KAMLOOPS MINING DIVISION      82M05W

---

**CROSS SECTION 'C-D' SHOWING SURROUNDING AREAS TO KNOWN COPPER MINERALIZATION TO BE FURTHER EXPLORED (MODIFIED FROM THOMPSON P. Eng (1970))**

---

DRAWN BY DJB      DATE APRIL 2002

FIGURE 7B



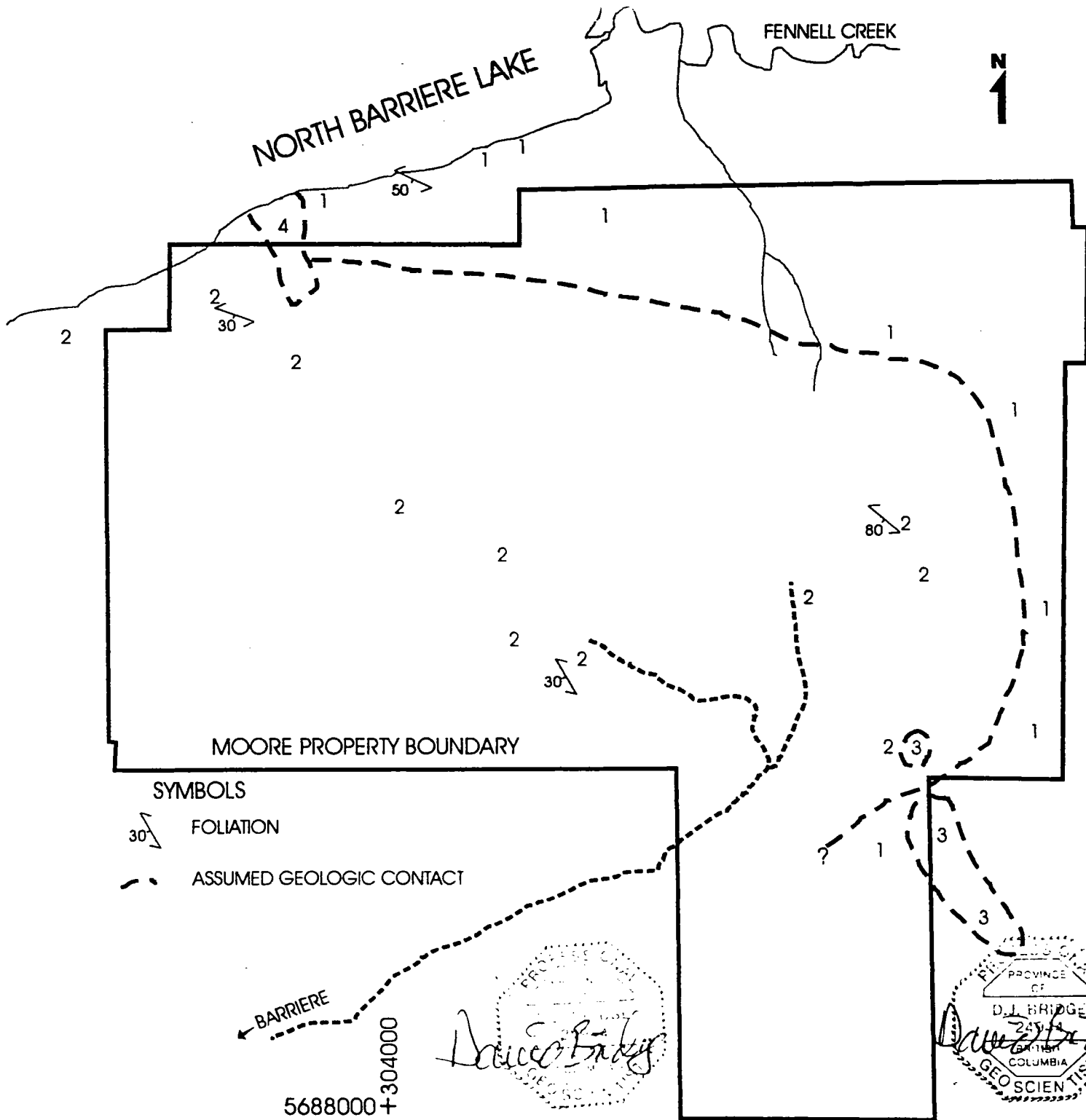

SYMBOLS

30° FOLIATION

- - - ASSUMED GEOLOGIC CONTACT

LEGEND

- 1 ORTHOGNEISS
- 2 INTERBEDDED SEQUENCE OF CHLORITE SCHIST, QUARTZ - SERICITE SCHIST, ARGILLITE, MARBLE
- 3 QUARTZ DIORITE
- 4 FELDSPAR PORPHYRY

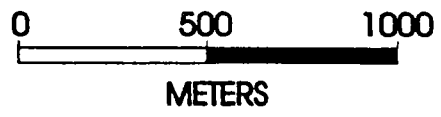

<b>MOORE PROPERTY</b>	
KAMLOOPS MINING DIVISION	82M05W
<b>PROPERTY GEOLOGY MAP OF THE MOORE PROPERTY</b>	
DRAWN BY DJB DATE APRIL 2002	FIGURE 9