



CHEER TIME

CHEER TIME ENTERPRISE CO.,LTD.

Company Profile

2018,Dec.

<http://www.cheer-time.com>



## CHEER TIME ENTERPRISE CO.,LTD.

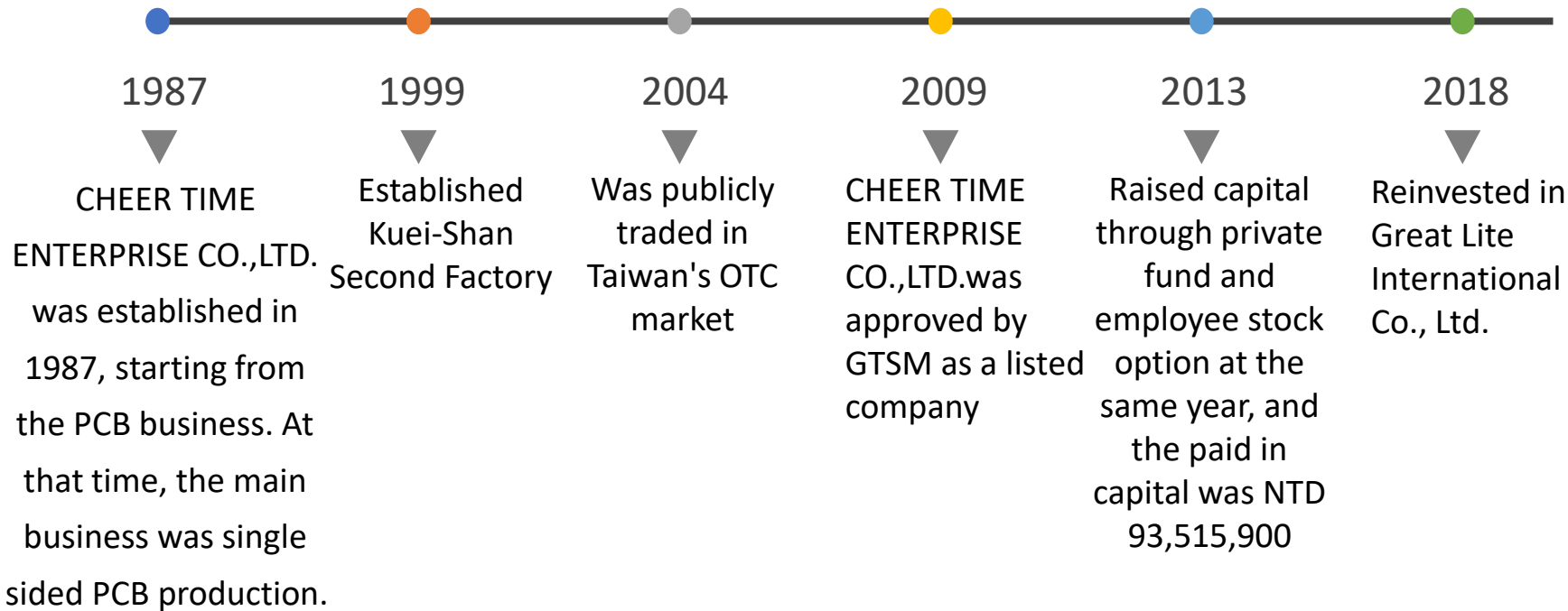



# Enterprise Overview

Strategic Alliance

Cheer Time  
&  
Great Lite



2016

2017

2018



Professional management Team

# Worldwide Organization





# Location



- **GL Taipei Head Office**  
Sales/Service/purchasing/R & D Center
- **GL Shanghai Branch**  
Sales/Service Center
- **GL Chengdu Branch**  
Sales/Service/R & D Center
- **GL Vietnam Branch**  
Sales/Service Center
- **GL Cambodia Branch**  
Sales/Service Center/ Southeast Asia showroom(2,400m<sup>2</sup>)
- **GL Singapore Branch**  
Sales/Service Center
- **GL Malaysia**  
Sales/Service Center

# Our Business Coverage

Educational Institution

Finance

Public Construction

Manufacture



Retail / Services

Entertainment

Medical



# CORE TECHNOLOGIES



## Unique Compressing Technique

Storage cost saving.



## Extremely lightweight video streaming

Reduce 80-90% of 1080p RTSP streaming bandwidth



## Ultra-high picture quality

Small compressed video size but keep its high resolution and quality.



## Big Data Applications

To build massive databases capable to share real-time data to cloud users.



## AI Algorithm Technology

Advance AI algorithm to build good environment for developing innovative services.



## Video Streaming Integration platform

Modular design platform that integrated variety industry application for user easy implantation



# Partners



CMS,VMS



Body Camera



Access control



IP Camera



NVR



LED Wall



# Product Family



GL professional camera system



Video compression

VCT / VCA real-Time compression



VSP cloud storage



SVMS



HGIS

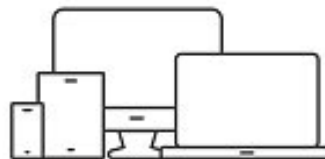
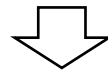

Access devices





**GL IP CAMERA**  
**Professional camera products**

# IP Camera Product Series

Dome style



Box style



Bullet style

- Bullet and box style are general applicable for indoor and outdoor installation. Dome style mostly used in indoor environment.
- Quick Reference Guide can help you in model selection.



# IP Camera Features



Product  
Feature

- Start Light, Fixed lens, Auto focus and auto iris lens selectable.
- Smart IR LED light for low light environment
- Support POE, easy implementation.
- Support H.264 / H.265 high efficiency compression.



AI Feature

- Object count, Area motion detection, Line crossing warning message input and output
- Facial detection and tracing
- Facial recognition ( with special shoulder & head comparison feature to increase accuracy)
- Both capture and recognition models are available.

# Camera Product Applications



City real-time monitoring



Risk management



AI analytics



Emergency management system



Medical and elderly care



Retailing application

VCG/VCT



# VCG | VCT

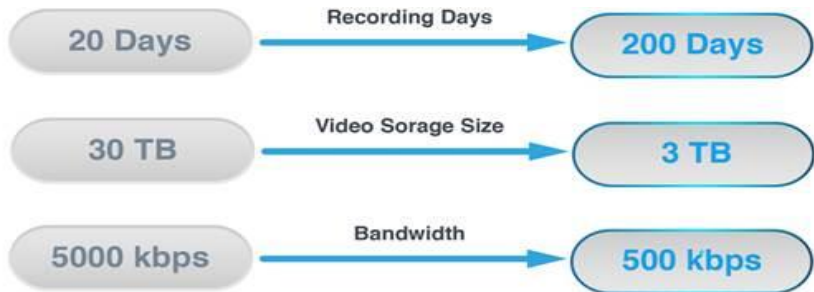

- Supported Video Format**
- 4K(3840x2160/ 4096x2160)
  - 1080p(1920x1080)
  - H.264/ H.265/ MJPEG

- Benefits**
- Storage cost saving
  - High resolution video with lower bandwidth
  - Efficient storage



# KEY Features

Support local or remote video storage saving.

Support 1ch/4ch ONVIF IP Cam input/output.

Support 3G/4G real-time transmitting. (Optional)

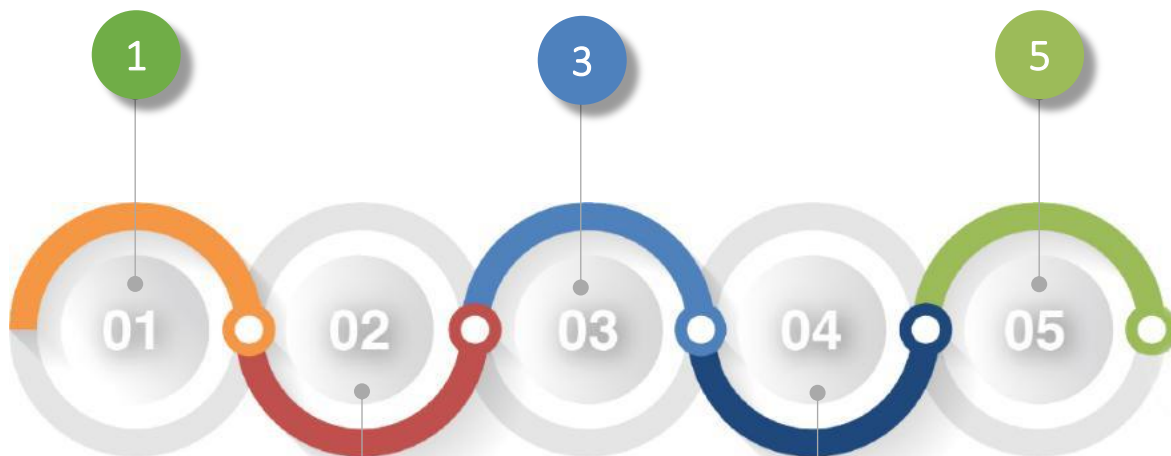

Low bandwidth transmitting with high quality.

Video (up to 4K) compression up to 90%, saving storage & data transmitting cost.

# Stream Bandwidth Comparison

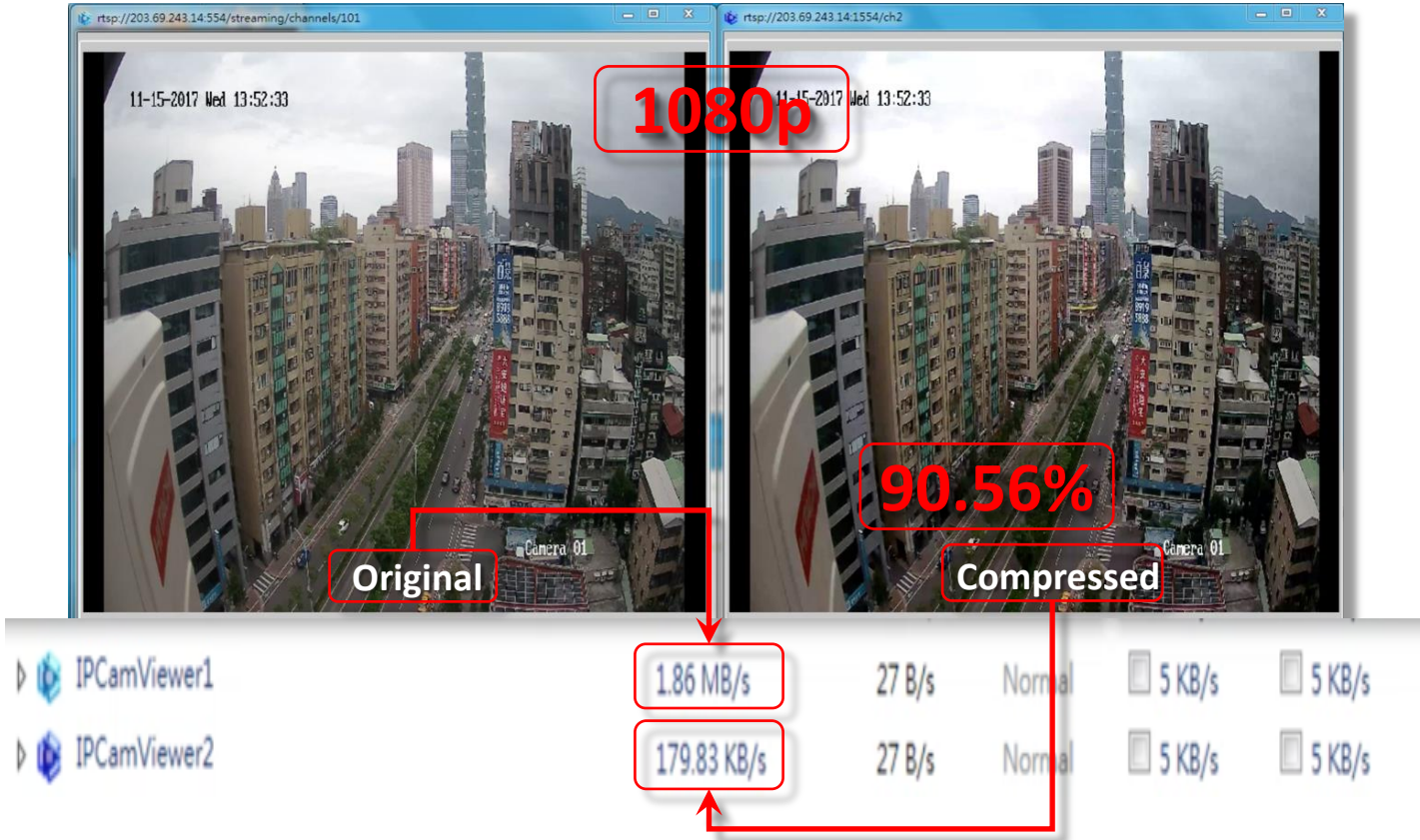



# VCP PoE SWITCH

- Video Compression PoE Switch

# VCP\_PoE SWITCH Features

Support for multiple camera systems

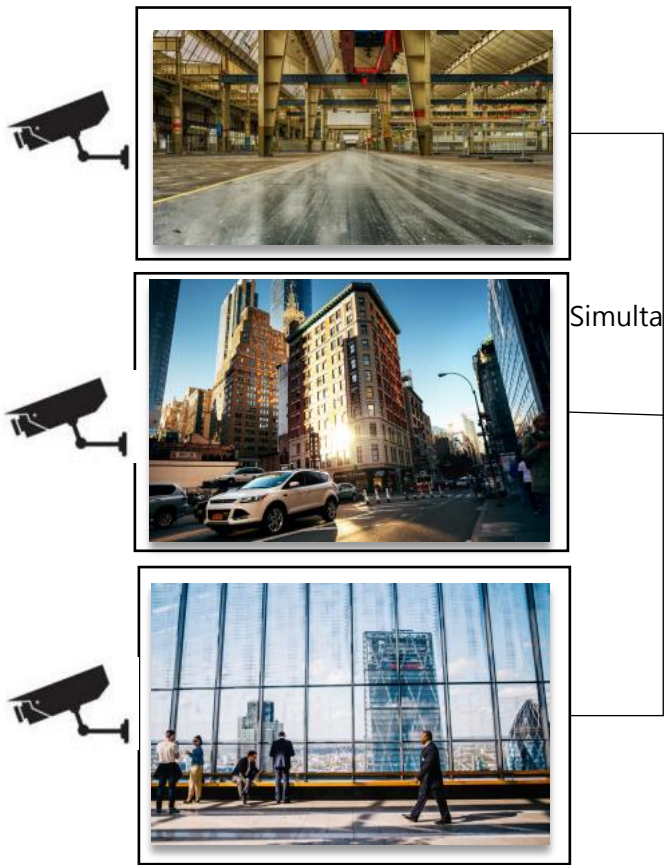

Storage space saving  
Simultaneously processing of video compression through PoE Switch



\*support 8/16/24 port IPCamera

HD multi-screen real-time monitoring



Reducing troubleshooting time



Stable operation and energy-saving effect  
at the same time

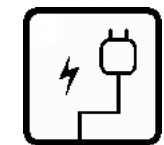



# AR-VMS

Augmented Reality Video Management Platform



## High quality multi-screen

Capable to display 144 images at the same time.  
4K, High frame rate camera supported



## Video playback

Random date/ time selection



## Intelligent analytics

Face recognition/ License Plate Recognition

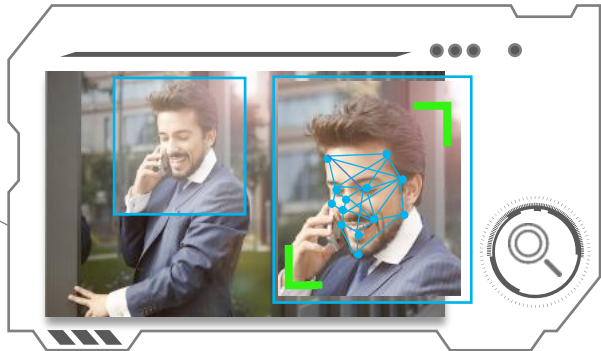

## Manage Features



Dynamic Privacy Mask area / User level Management

Video download encryption/video security mechanism

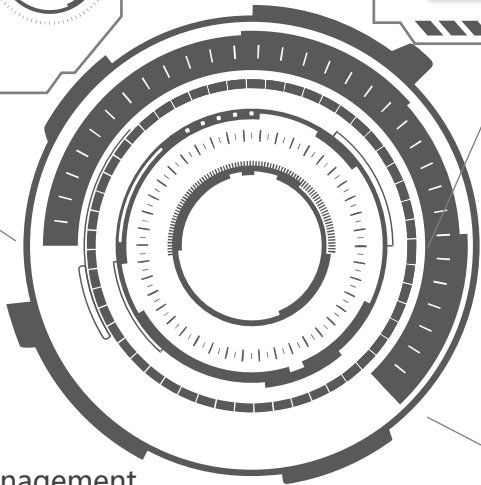



# AR-VMS Applications

SCENARIO



Highly sensitive areas



Forbidden Zone



Factories

BENEFITS

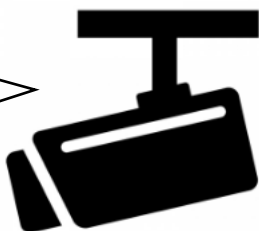

HD video recording



Storage space saving with high compression rate



Less maintenance works



# HGIS

Integrated video command and dispatch platform

# HGIS Features

AI analytics alerts



Search/ Dynamic tracking/ Precise positioning

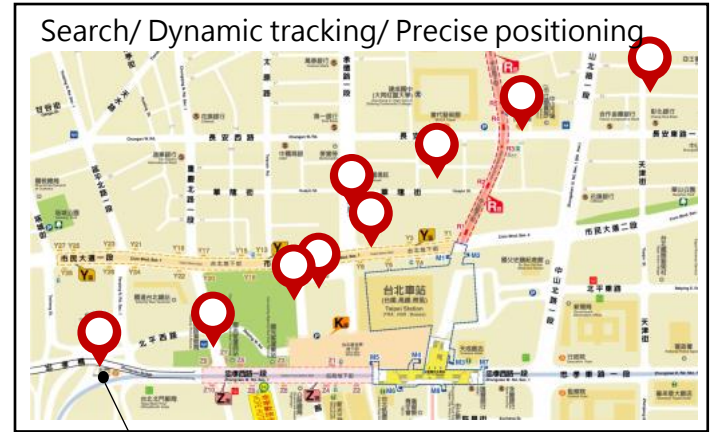

25°2'51"N 121°31'1"E Monitoring & Navigation

# HGIS Scenarios

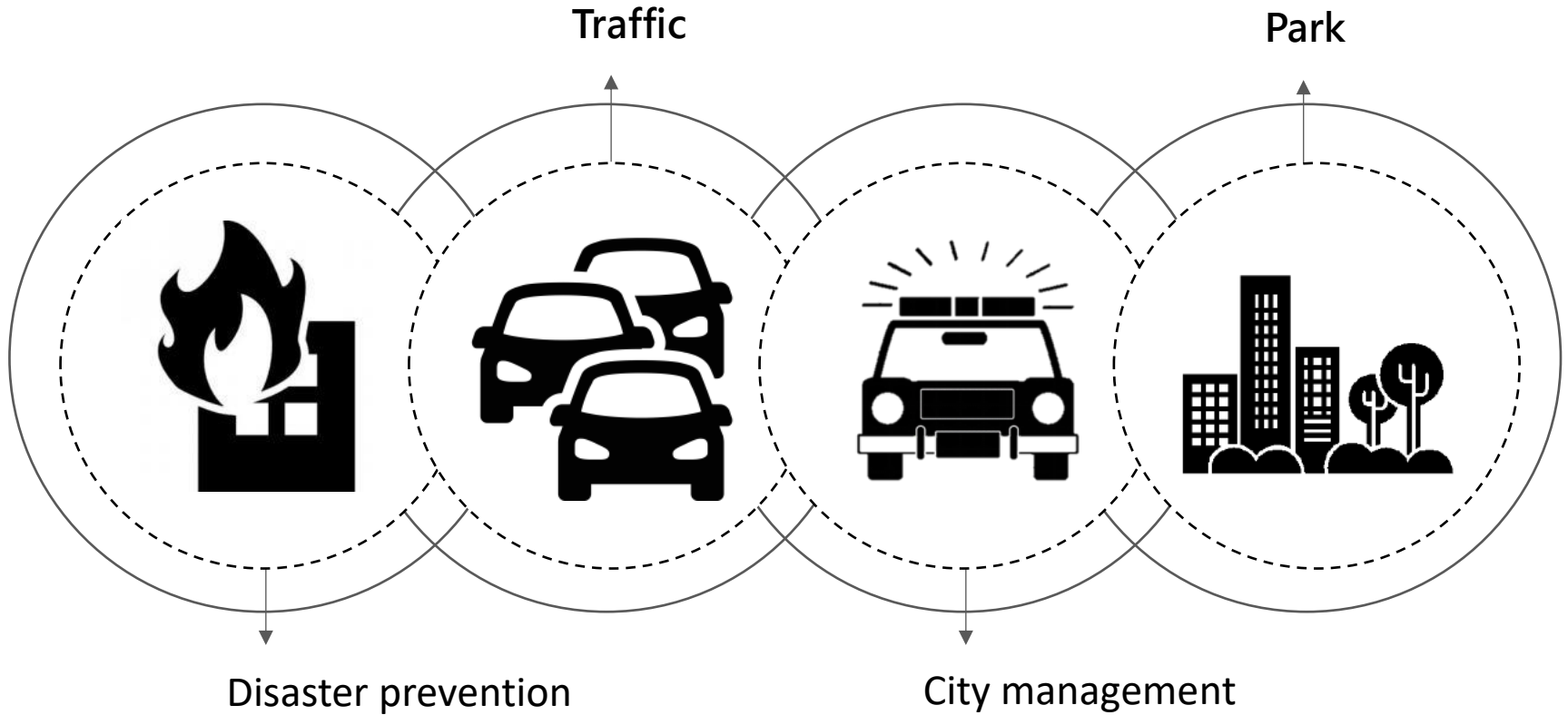

**\*Support third party data link with composite display function.**



**GL VSP Solution**  
**VSP - Video Stream Platform**



# VSP-Video Stream Platform



**Web**  
 Device/Account Manage/  
 AI/ Live View/  
 Video Playback/ Statistics



**APP**



**PC**

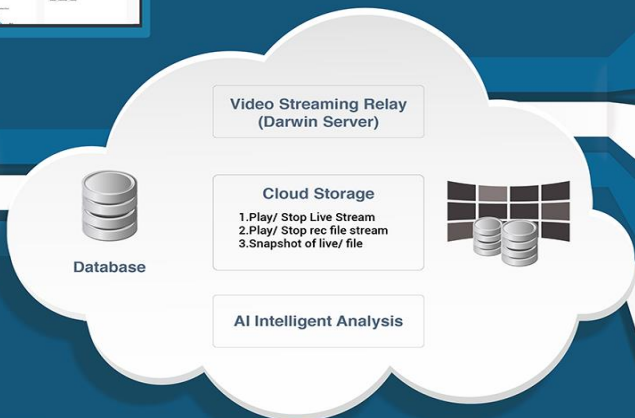
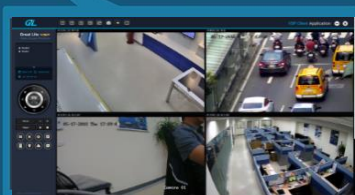

**VCG**  
 Handshake/Connect status/  
 VCG Camera list/  
 Camera disconnect/  
 VCG disconnect



**VXR-4**



**IP Camera**  
 Box/ Dome/ Bullet



**InfoCiti**  
 AI(Age/Gender)  
 AD Play  
 Information





# Great Lite brand name Q4'2018~Q2'2019 Product Roadmap





# Great Lite brand name Product Roadmap

	Q4'2018	Q1'2019	Q2'2019	ID Appearance
<b>GL IPCamera Series</b>	HD x4 Capture+Recognition x3 Capturex1 Economic x2	HD_trial-produce Capture+Recognition_trial-produce Economic_trial-produce	HD_mass produce Capture+Recognition_mass produce Economic_mass produce	
<b>GL Compression Series</b>	VCG(Windows) VCT(Linux) VCT-ARM-1 VCT-ARM-2 VCP(PoE Switch)	VCT-ARM-1 mass produce VCT-ARM-2 mass produce VCP@EVT+DVT	VCP@PVT+ mass produce VCP@ mass produce	
<b>GL System Integration</b>	InfoCiti AR-VMS AR-GIS VCA(with Dongle)	InfoCiti mass produce AR-VMS release AR-GIS release VCA_alpha+beta	VCA RTM+GA Release	



# PoE Switch with compression

original video

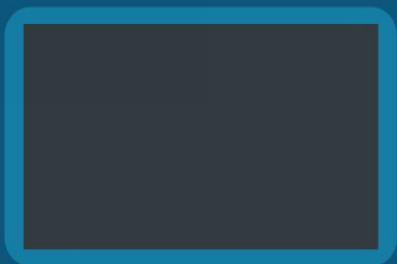

compressed video

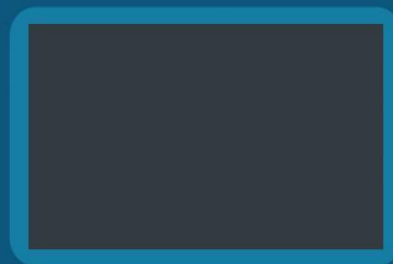

IP Camera  
Box/ Dome/ Bullet

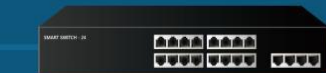

PoE Switch with compression



Internet

PC

Desktop computer/ Notebook



PC

Desktop computer/ Notebook





Corporate Vision

Be a World Class Professional Video Total  
Solution Provider



# Performance

Unit: NTD

Item	Q3 / 2018	Q3 / 2017	Q1~Q3 / 2018	Q1~Q3 / 2017
Sales Revenue	106,551	123,064	353,574	368,928
COGS	(98,231)	(105,581)	(313,944)	(312,796)
Gross Profit	8,320	17,483	39,630	56,132
GP %	8%	14%	11%	15%
Expenses	31,254	24,958	87,895	74,026
Profit / (Loss)	(22,934)	(7,475)	(48,265)	(17,894)
non-operating revenue and expenses	2,100	2,963	12,159	14,972
Income before Tax	(19,296)	(4,512)	(36,356)	(2,922)
EPS ( NTD)	(0.20)	(0.05)	(0.38)	(0.02)



# IPCamera 系列

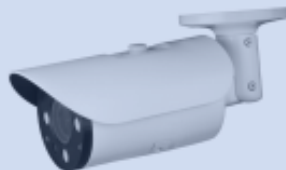

- 目標計數、區域檢測、越界檢測、報警輸入輸出
- 人臉智能分析、軌跡追蹤
- 人臉比對(背部也可比對)
- 具備人臉抓拍及辨識功能
- 全系列支援H.265格式
- 全系列支援PoE供電
- 符合CE及FCC認證



# NVR 系列



- 4路即時網路視頻接入, 小1U機箱NVR
- H.265、H.264雙碼流解碼, 嵌入式Linux操作系統
- 支援同步錄影、遠程監看、備份
- 支援VGA/HDMI同步輸出, 支援2160P高清預覽
- 支援預覽與回放圖像電子放大
- 標準ONVIF、RTSP協議
- 抓拍警報、警報郵件發送功能
- 支援DDNS、EMAIL、UPNP、NTP、P2P等功能
- 支援WEB、手機監看、客戶端、CMS監控
- 支援4路標準PoE供電

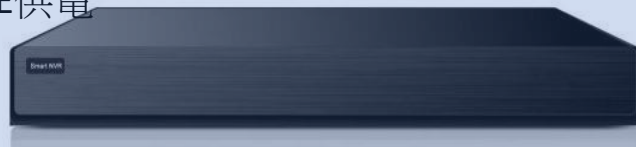



# Compression 壓縮系列

VCT(T1)  
ARM架構  
第三方算法

VCG  
INTEL架構  
Windows IoT  
第三方算法

VCT-ARM-1  
ARM架構  
Linux  
第三方算法

VCT-ARM-2  
ARM架構  
Linux  
自研發算法

VCT-ARM-V5  
ARM架構  
Linux  
自研發算法



IPCamera  
USB web Cam  
SDI port  
HDMI port  
4K

IPCamera  
1080P  
30fps  
H.264  
H.265  
1 Channel

IPCamera  
1080P  
30fps  
H.264  
4 Channel

IPCamera  
USB web Cam  
720P  
15fps  
H.264  
1 Channel

IPCamera  
USB web Cam  
720P  
15fps  
H.264  
2 Channel

1080P  
30fps  
H.264  
H.265  
4 Channel